

F.A.U. RTE.	SECTION	COUNTY	TOTAL SHEETS	SHEET NO.
3794	10-00040-00-RS	KENDALL	13	6
CONTRACT NO. 63496				

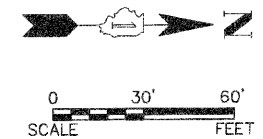

**LEGEND**

- RESURFACING
- CLASS D PATCHES
- HOT-MIX ASPHALT SURFACE REMOVAL - BUTT JOINT
- CURB & GUTTER REMOVAL AND REPLACEMENT
- EXISTING CONCRETE SIDEWALK TO REMAIN IN PLACE
- EXISTING HOT-MIX ASPHALT BIKE PATH TO REMAIN IN PLACE
- SIDEWALK REMOVAL AND REPLACEMENT

**NOTE:**

1. THE CALL OUT "SIDEWALK REMOVAL AND REPLACEMENT" SHALL BE COMPOSED OF THE FOLLOWING PAY ITEMS:
  - A. SIDEWALK REMOVAL
  - B. PORTLAND CEMENT CONCRETE SIDEWALK, 5 INCH

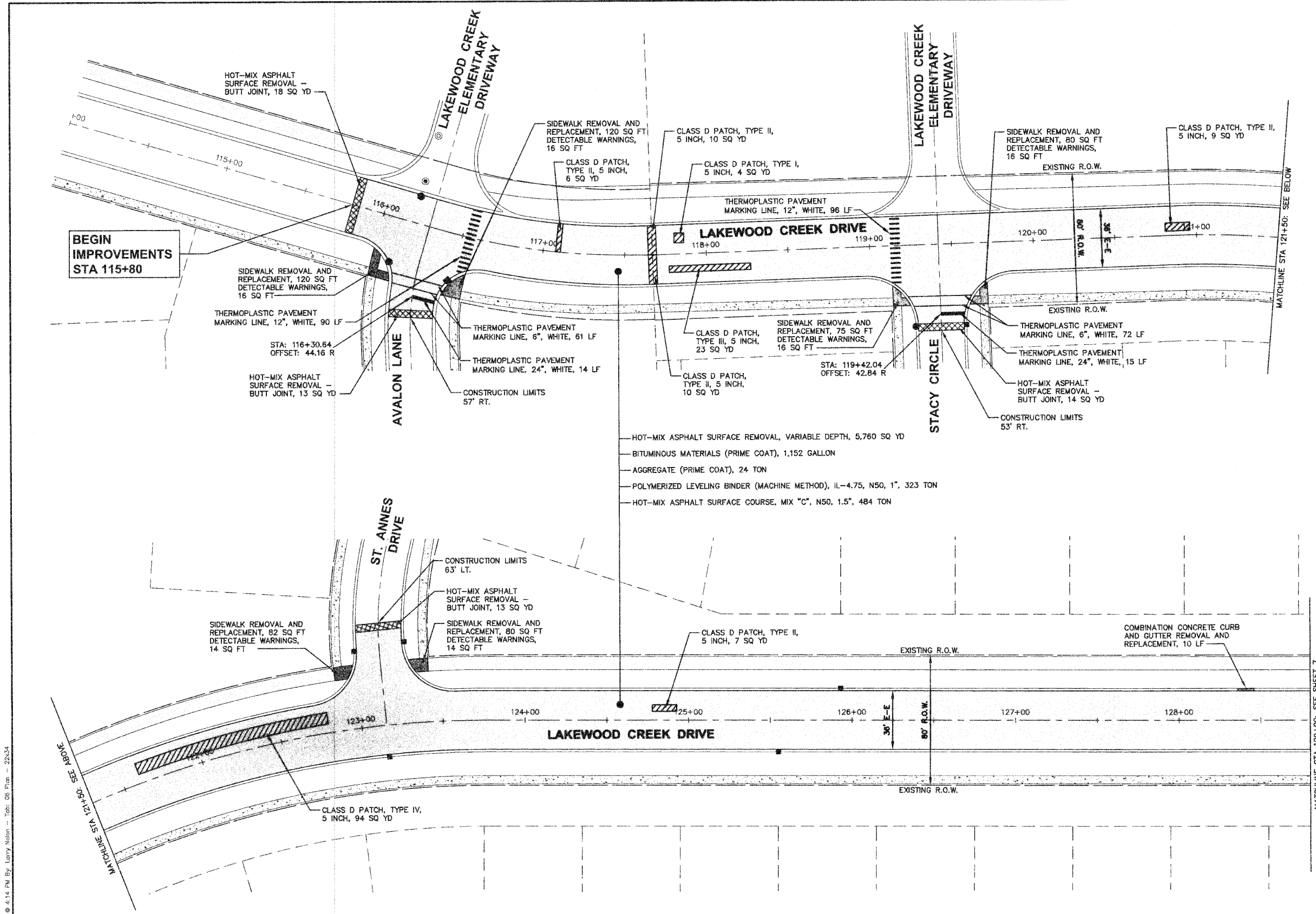
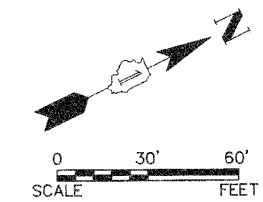

COPYRIGHT © 2010 ENGINEERING ENTERPRISES, INC.

**Engineering Enterprises, Inc.**  
 CONSULTING ENGINEERS  
 52 Wheeler Road  
 Sugar Grove, Illinois 60554  
 630.466.6700 / www.eeiweb.com

**VILLAGE OF MONTGOMERY**

NO.	DATE	REVISIONS

**LAKWOOD CREEK DRIVE  
 LAPP IMPROVEMENTS**

**PLAN, CONSTRUCTION  
 NOTES, AND DETAILS**

DATE:	JUNE 2010
PROJECT NO.:	M00930
FILE:	M00930-PLAN
SHEET	<b>6</b> OF <b>13</b>

Plotted: June 8, 2010 @ 4:14 PM By: Larry Nelson -- Tab: 06 Plan -- 22x34  
 Path: \\sbsrhp01\m00930\DWG\DWG\_FINAL\_ENG\M00930-PLAN