

F.A.U. RTE.	SECTION	COUNTY	TOTAL SHEETS	SHEET NO.
3794	10-00046-00-RS	KENDALL	13	8
CONTRACT NO. 63496				

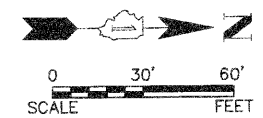

LEGEND

- RESURFACING
- CLASS D PATCHES
- HOT-MIX ASPHALT SURFACE REMOVAL - BUTT JOINT
- CURB & GUTTER REMOVAL AND REPLACEMENT
- EXISTING CONCRETE SIDEWALK TO REMAIN IN PLACE
- EXISTING HOT-MIX ASPHALT BIKE PATH TO REMAIN IN PLACE
- SIDEWALK REMOVAL AND REPLACEMENT

- NOTE:**
- THE CALL OUT "SIDEWALK REMOVAL AND REPLACEMENT" SHALL BE COMPOSED OF THE FOLLOWING PAY ITEMS:
 - A. SIDEWALK REMOVAL
 - B. PORTLAND CEMENT CONCRETE SIDEWALK, 5 INCH

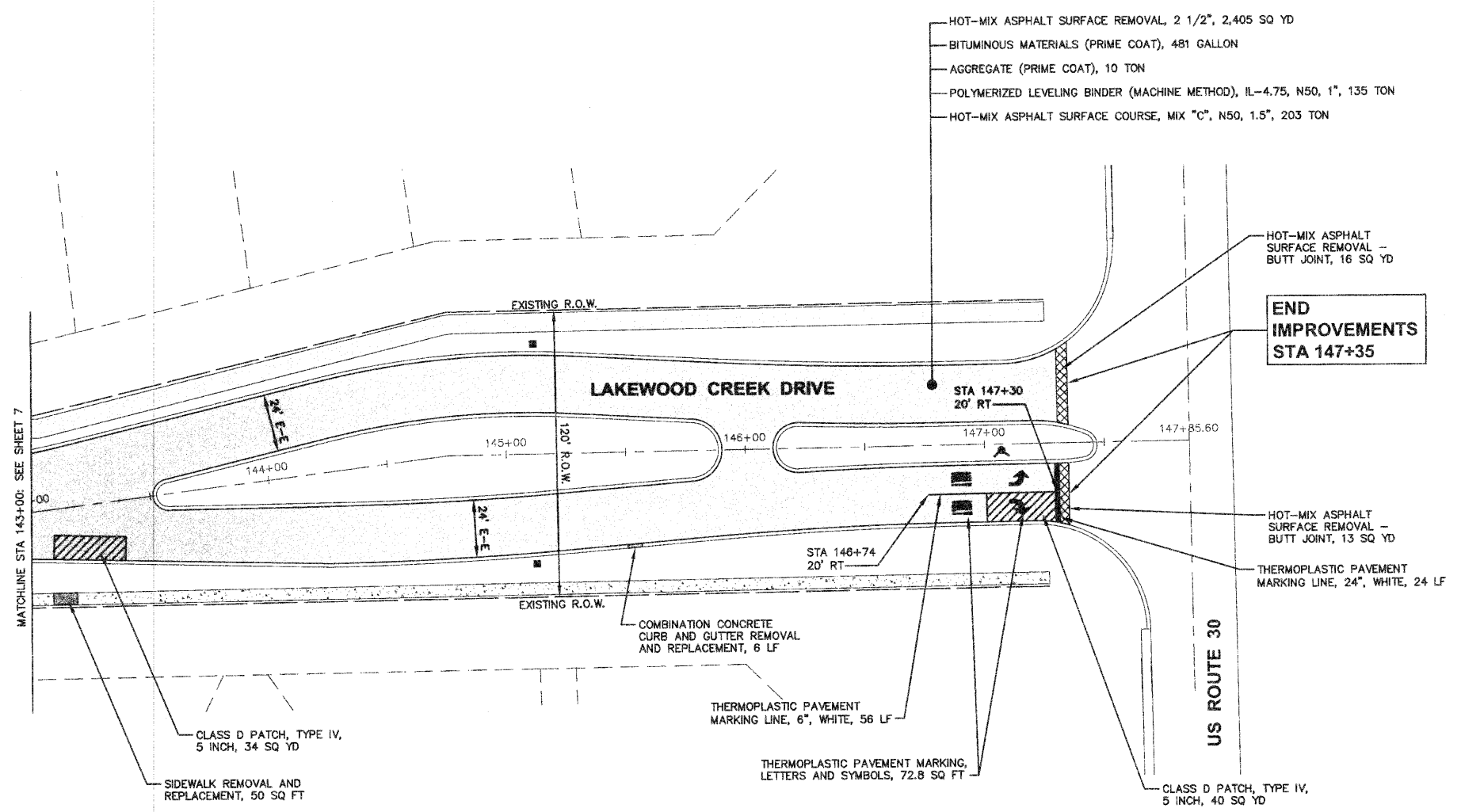

- HOT-MIX ASPHALT SURFACE REMOVAL, 2 1/2", 2,405 SQ YD
- BITUMINOUS MATERIALS (PRIME COAT), 481 GALLON
- AGGREGATE (PRIME COAT), 10 TON
- POLYMERIZED LEVELING BINDER (MACHINE METHOD), IL-4.75, N50, 1", 135 TON
- HOT-MIX ASPHALT SURFACE COURSE, MIX "C", N50, 1.5", 203 TON

Plotted: June 8, 2010 @ 4:14 PM By: Larry Nelson - Tab: DB Plan - 22a34
 COPYRIGHT © 2010 ENGINEERING ENTERPRISES, INC.

Engineering Enterprises, Inc.
 CONSULTING ENGINEERS
 52 Wheeler Road
 Sugar Grove, Illinois 60554
 630.466.6700 / www.eetweb.com

VILLAGE OF MONTGOMERY

NO.	DATE	REVISIONS

**LAKWOOD CREEK DRIVE
LAPP IMPROVEMENTS**

**PLAN, CONSTRUCTION
NOTES, AND DETAILS**

DATE:	JUNE 2010
PROJECT NO:	M00930
FILE:	M00930-PLAN
SHEET	8 OF 13

Path: \\S03R\PROJ\00930\DWG\DWG_FINAL_ENG\M00930-PLAN