

- LEGEND**
- REMOVAL
 - PROP DEPRESSED CURB & DETECTABLE WARNINGS
 - EXIST STORM SEWER
 - EXIST VALVE VAULT
 - EXIST VALVE BOX
 - STRUCTURE TO BE REMOVED
 - INLET TO BE FILLED, SPECIAL
 - STRUCTURE TO BE CLEANED
 - TREE REMOVAL

IMPROVEMENT BEGINS STA. 150+40.0

A1 STA. 152+93.93, 12.2' RT.
VALVE VAULT TO BE ADJUSTED
EX. RIM = 704.01
PR. RIM = 704.62

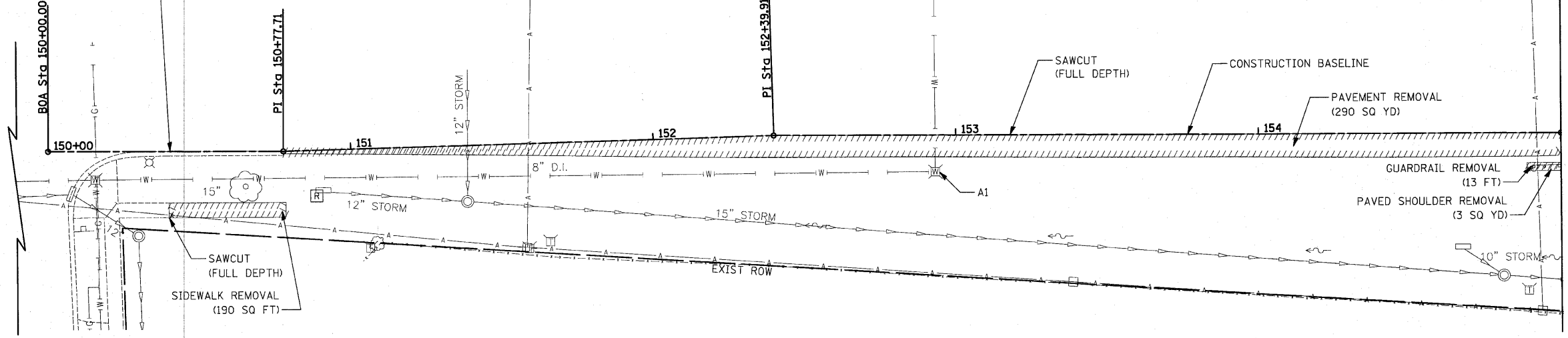

MATCH LINE STA. 155+00
SEE SHEET NO. 9

EXISTING MILL ROAD

① 28' - STORM SEW CL B 1, 12"
@ 10.96%
TBF = 1.2 CU YD

IMPROVEMENT BEGINS STA. 150+40.0

- ① STA. 150+90.95, 15.9' RT.
FLUSH INLET BOX FOR MEDIAN
STANDARD 542546
RIM = 696.32
INV = 694.40 (12" N)
- ② STA. 153+11.21, 0' RT.
CB TC T11V F & G
RIM = 705.77
INV = 703.02 (12" E)
- ③ STA. 153+11.21, 32.1' RT
METAL END SECTION, 12"
STONE RIPRAP, CLASS A3
W/ FILTER FABRIC (2 SQ YD)
INV = 699.95

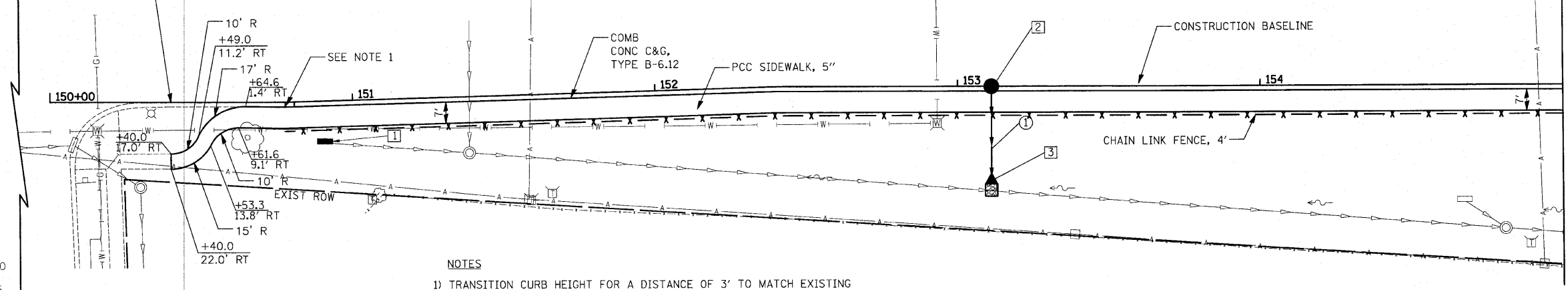

MATCH LINE STA. 155+00
SEE SHEET NO. 9

PROPOSED MILL ROAD

NOTES
1) TRANSITION CURB HEIGHT FOR A DISTANCE OF 3' TO MATCH EXISTING

HORIZ.: 20
VERT.: 5

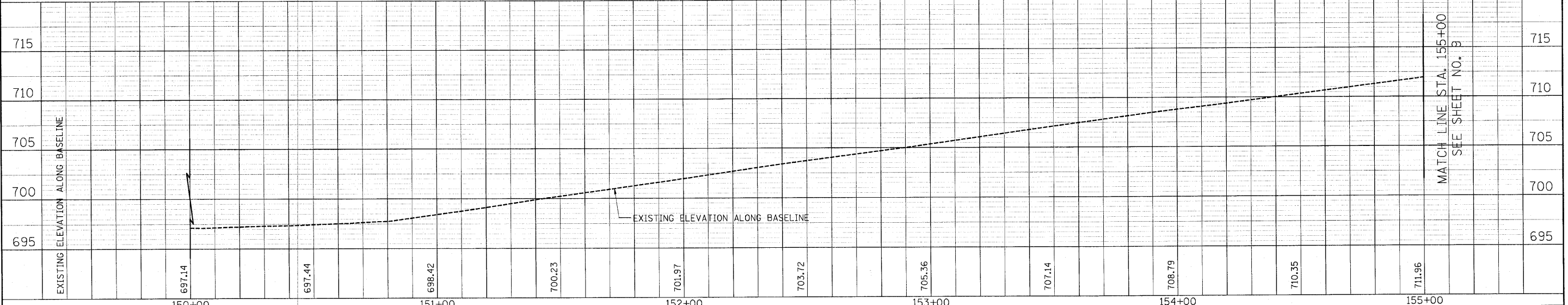

MATCH LINE STA. 155+00
SEE SHEET NO. 9

695

DESIGNED - JAT	REVISED -
DRAWN - JAT	REVISED -
CHECKED - RTM	REVISED -
DATE - 7/1/2010	REVISED -

STATE OF ILLINOIS
DEPARTMENT OF TRANSPORTATION

ROADWAY PLAN AND UTILITIES - MILL ROAD

SCALE: 1" = 20'
SHEET NO. 1 OF 5 SHEETS
STA. 150+00 TO STA. 155+00

F.A.U. RTE.	SECTION	COUNTY	TOTAL SHEETS	SHEET NO.
2625	07-00097-00-SW	DUPAGE	31	8
CONTRACT NO. 63502				
FED. ROAD DIST. NO. 1 ILLINOIS FED. AID PROJECT				