

MATCH LINE STA. 155+00
SEE SHEET NO. 8

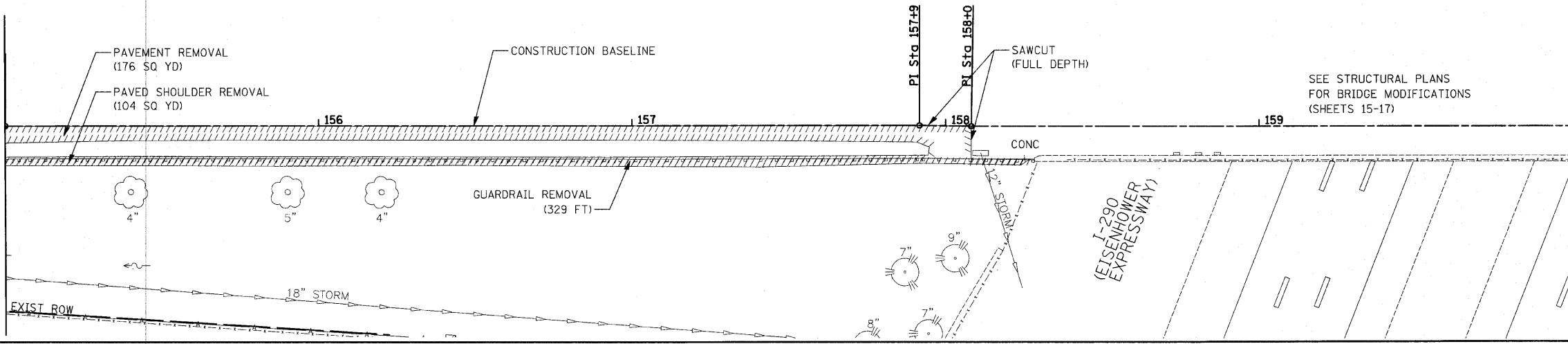

MATCH LINE STA. 160+00
SEE SHEET NO. 10

EXISTING MILL ROAD

- ② 43' - STORM SEW CL B 1, 12" @ 20.35%
TBF = 1.2 CU YD
- ③ 61' - STORM SEW CL B 1, 12" @ 18.21%
TBF = 1.2 CU YD

- ④ STA. 155+61.21, 0' RT.
CB TC T11V F & G
RIM = 713.79
INV = 711.04 (12" E)
- ⑤ STA. 155+61.21, 46.8' RT.
METAL END SECTION, 12"
STONE RIPRAP, CLASS A3
W/ FILTER FABRIC (2 SQ YD)
INV = 702.29
- ⑥ STA. 157+64.54, 0.0' RT.
CB TC T11V F & G
RIM = 717.96
INV = 713.96 (12" E)
- ⑦ STA. 157+64.54, 61.7' RT.
METAL END SECTION, 12"
STONE RIPRAP, CLASS A3
W/ FILTER FABRIC (2 SQ YD)
INV = 702.85

MATCH LINE STA. 155+00
SEE SHEET NO. 8

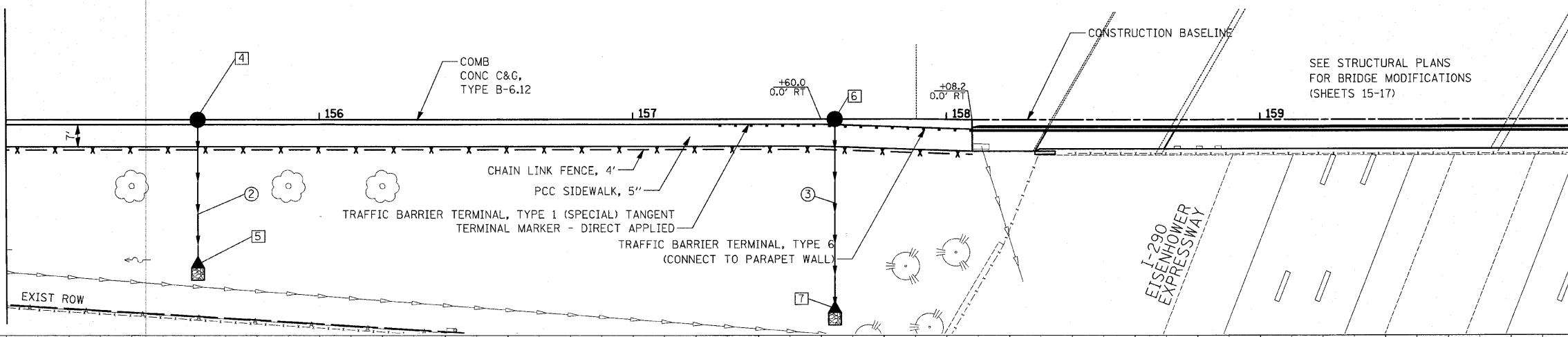

MATCH LINE STA. 160+00
SEE SHEET NO. 10

PROPOSED MILL ROAD

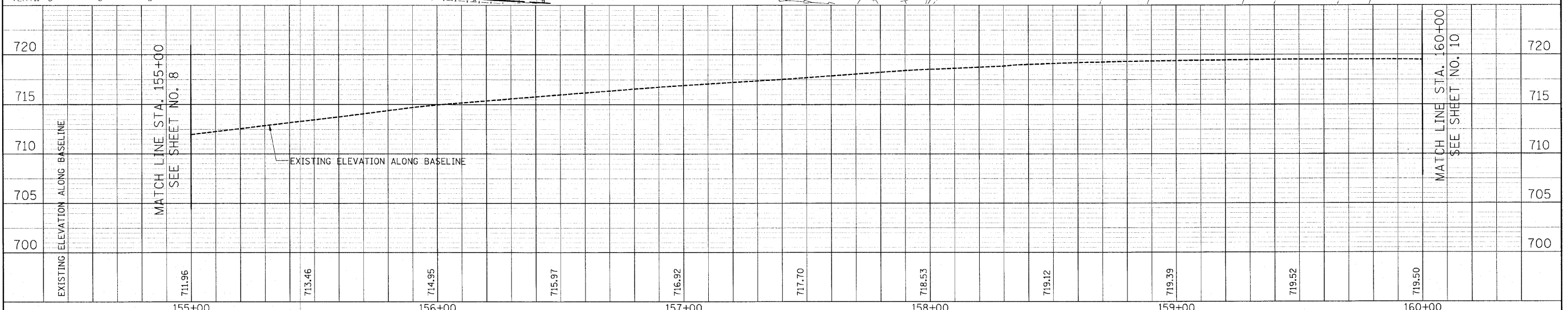
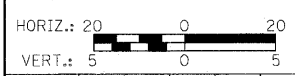

DATE	
BY	
SUPERVISOR	
DESIGNED	
CHECKED	
IN CHARGE	
NO. OF SHEETS	
NO. OF SHEETS CHECKED	
NO. OF SHEETS NOT CHECKED	
NO. OF SHEETS NOT CHECKED	

DATE	
BY	
SUPERVISOR	
DESIGNED	
CHECKED	
IN CHARGE	
NO. OF SHEETS	
NO. OF SHEETS CHECKED	
NO. OF SHEETS NOT CHECKED	
NO. OF SHEETS NOT CHECKED	

DESIGNED - JAT	REVISED -
DRAWN - JAT	REVISED -
CHECKED - RTM	REVISED -
DATE - 7/1/2010	REVISED -

STATE OF ILLINOIS
DEPARTMENT OF TRANSPORTATION

ROADWAY PLAN AND UTILITIES - MILL ROAD

SCALE: 1" = 20'
SHEET NO. 2 OF 5 SHEETS
STA. 155+00 TO STA. 160+00

F.A.U. RTE.	SECTION	COUNTY	TOTAL SHEETS	SHEET NO.
2625	07-00097-00-SW	DUPAGE	31	9
CONTRACT NO. 63502				
FED. ROAD DIST. NO. 1 ILLINOIS FED. AID PROJECT				