

PLAN	SURVEYED	BY	DATE
	PLANNED		
	DESIGNED		
	DRAWN		
	CHECKED		
	NOTED		
	FILE NAME		

PROFILE	SURVEYED	BY	DATE
	PLANNED		
	DESIGNED		
	DRAWN		
	CHECKED		
	NOTED		
	FILE NAME		

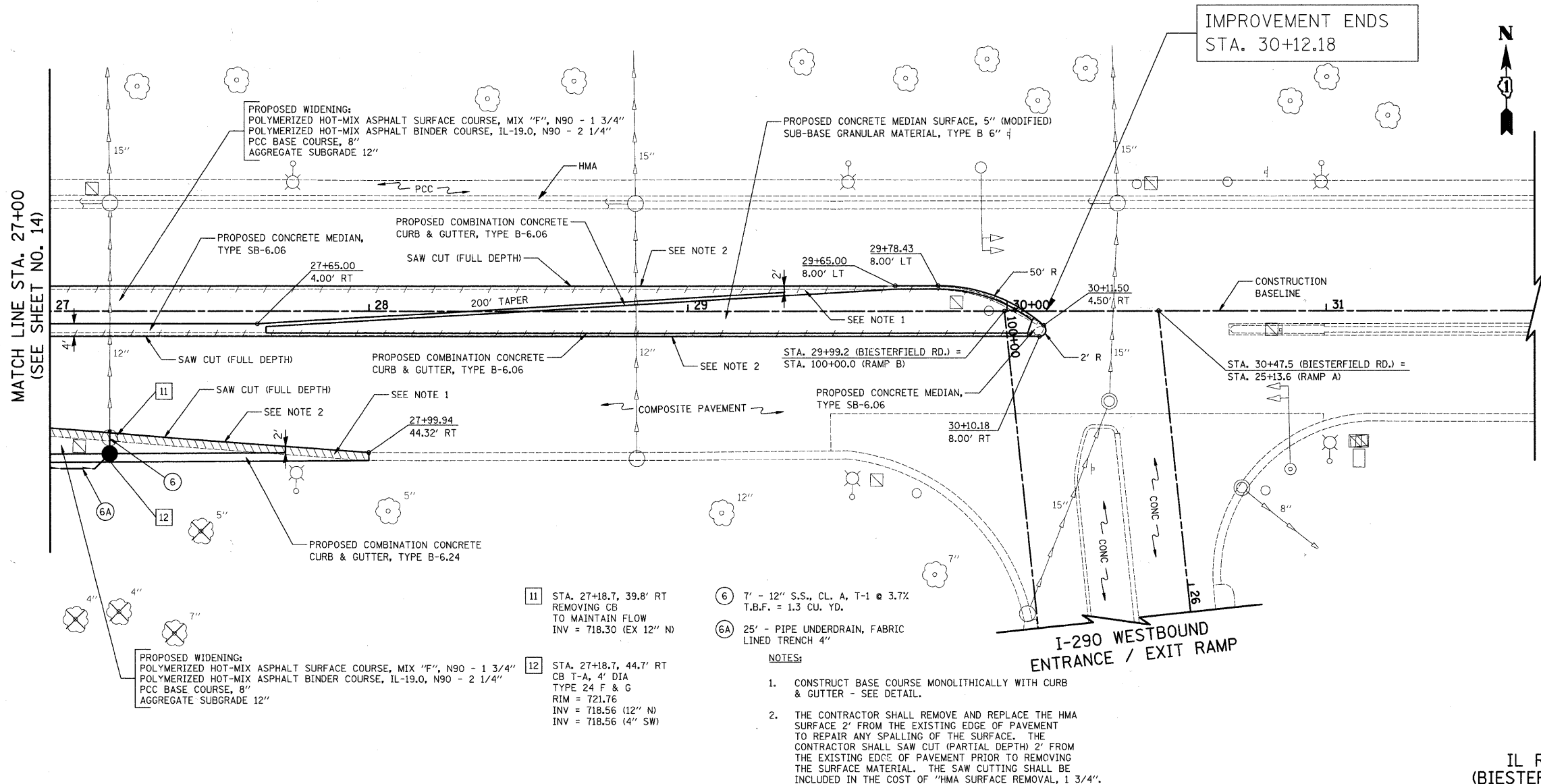

- 11 STA. 27+18.7, 39.8' RT
REMOVING CB
TO MAINTAIN FLOW
INV = 718.30 (EX 12" N)
- 12 STA. 27+18.7, 44.7' RT
CB T-A, 4' DIA
TYPE 24 F & G
RIM = 721.76
INV = 718.56 (12" N)
INV = 718.56 (4" SW)
- 6 7' - 12" S.S., CL. A, T-1 @ 3.7%
T.B.F. = 1.3 CU. YD.
- 6A 25' - PIPE UNDERDRAIN, FABRIC
LINED TRENCH 4"

- NOTES:
- CONSTRUCT BASE COURSE MONOLITHICALLY WITH CURB & GUTTER - SEE DETAIL.
 - THE CONTRACTOR SHALL REMOVE AND REPLACE THE HMA SURFACE 2" FROM THE EXISTING EDGE OF PAVEMENT TO REPAIR ANY SPALLING OF THE SURFACE. THE CONTRACTOR SHALL SAW CUT (PARTIAL DEPTH) 2" FROM THE EXISTING EDGE OF PAVEMENT PRIOR TO REMOVING THE SURFACE MATERIAL. THE SAW CUTTING SHALL BE INCLUDED IN THE COST OF "HMA SURFACE REMOVAL, 1 3/4".

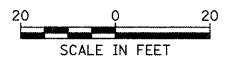

IL ROUTE 53
(BIESTERFIELD ROAD)

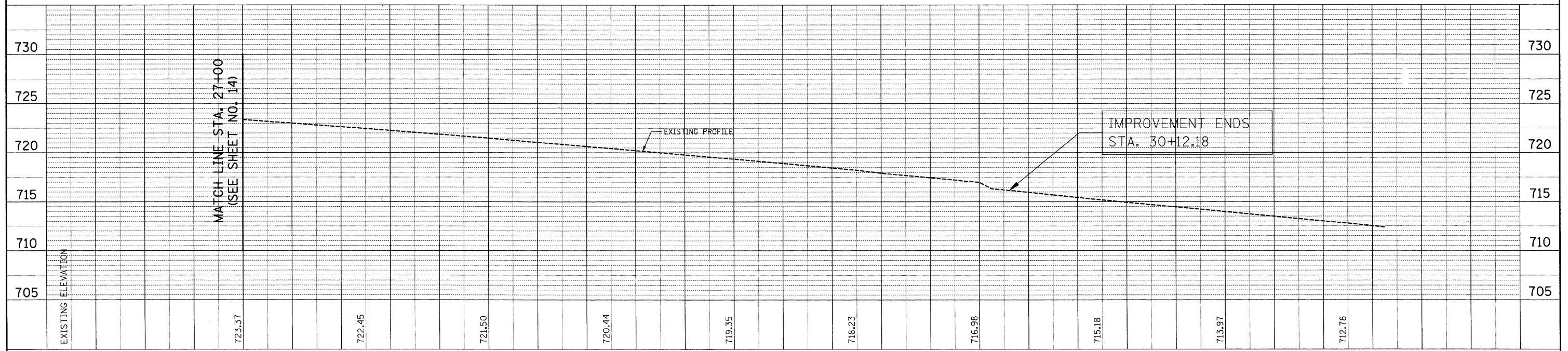

FILE NAME = ... \2349\cod\sheet\2349_D&U_04.dgn	USER NAME = djk	DESIGNED - BLG	REVISED -	STATE OF ILLINOIS DEPARTMENT OF TRANSPORTATION	IL ROUTE 53 (BIESTERFIELD ROAD) @ I-290 PLAN AND PROFILE	F.A.U. RTE. 1339	SECTION 09-00054-0J-CH	COUNTY COOK	TOTAL SHEETS 88	SHEET NO. 15	
PLOT SCALE = 20,0000' / IN.	CHECKED - DJK	DRAWN - BLG	REVISED -			SCALE: 1" = 20'	SHEET NO. 4 OF 6 SHEETS	STA. 27+00.0 TO STA. 30+12.18	FED. ROAD DIST. NO. 1	ILLINOIS FED. AID PROJECT	ARA-M-9003(569)
PLOT DATE = 7/7/2010	DATE - 07-07-10	CHECKED - DJK	REVISED -			CONTRACT NO. 63505					
		DATE - 07-07-10	REVISED -								