

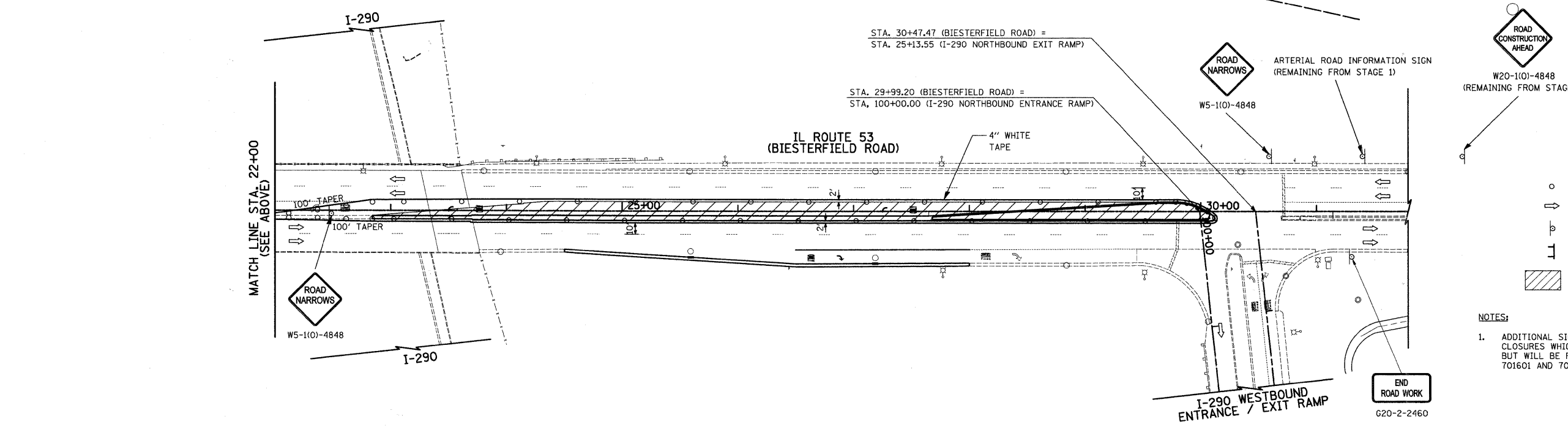

PLAN	REVIEWED	DATE
	BY	
	NOTED	
	DATE	
	NO.	

PROFILE	REVIEWED	DATE
	BY	
	NOTED	
	DATE	
	NO.	

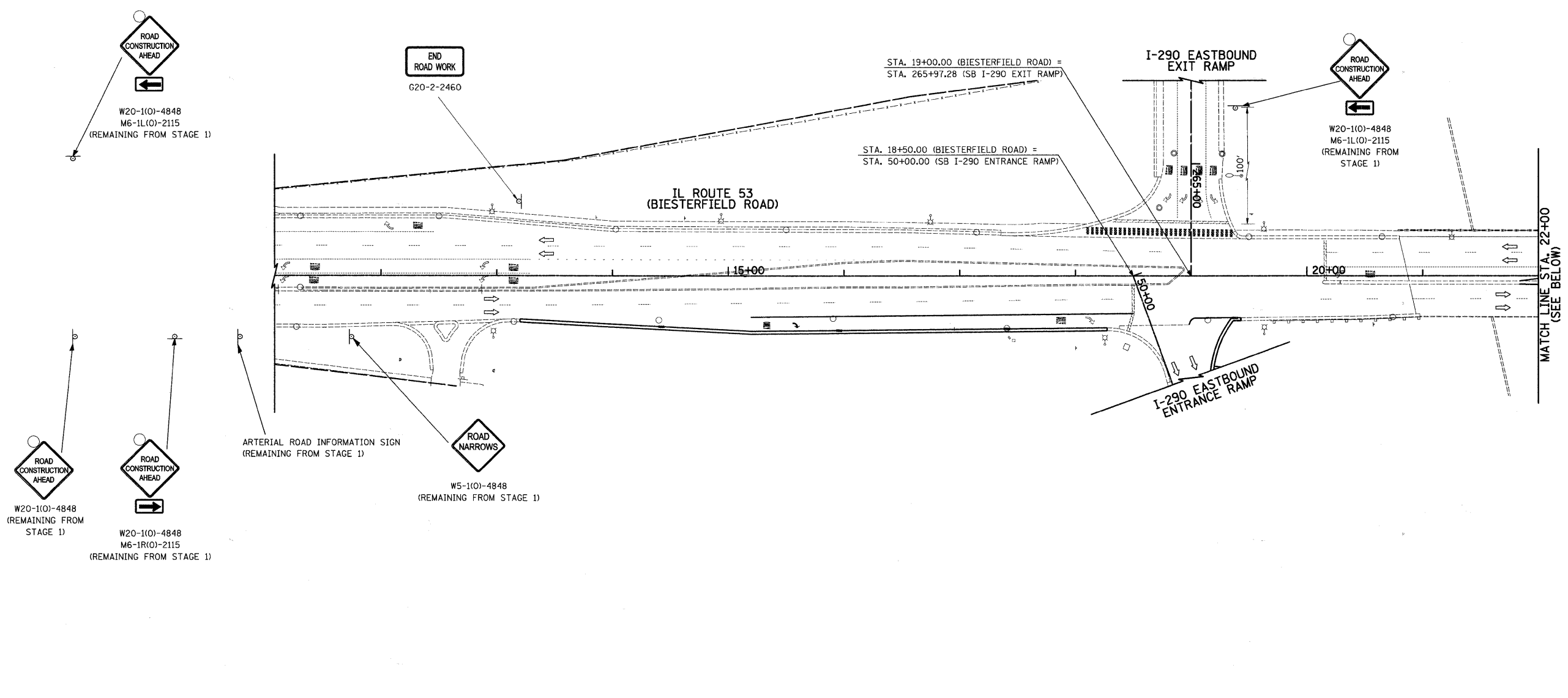

- LEGEND**
- DRUM
 - ⇨ DIRECTION OF TRAFFIC
 - ⊕ TEMPORARY TRAFFIC SIGN ON PERMANENT SUPPORT
 - ⊥ TYPE III BARRICADE
 - ▨ WORK ZONE

NOTES:

- ADDITIONAL SIGNS SHALL BE REQUIRED FOR LANE CLOSURES WHICH ARE NOT SHOWN ON THE PLANS BUT WILL BE REQUIRED AS PER IDOT STANDARD 701601 AND 701701.

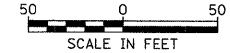

FILE NAME = ...oad\sheet\2349_MOT_02_1.Ldgn

USER NAME = djk
 PLOT SCALE = 50,0000 "/ IN.
 PLOT DATE = 7/7/2010

DESIGNED - BLG
 DRAWN - BLG
 CHECKED - DJK
 DATE - 07-07-10

REVISED -
 REVISED -
 REVISED -
 REVISED -

**STATE OF ILLINOIS
 DEPARTMENT OF TRANSPORTATION**

**IL ROUTE 53 (BIESTERFIELD ROAD) @ I-290
 MAINTENANCE OF TRAFFIC - STAGE 2**

SHEET NO. 4 OF 4 SHEETS

F.A.U. RTE.	SECTION	COUNTY	TOTAL SHEETS	SHEET NO.
1339	09-00054-00-CH	COOK	88	21

CONTRACT NO. 63505

FED. ROAD DIST. NO. 1 ILLINOIS FED. AID PROJECT ARA-M-9003669