

- LEGEND**
- WORK ZONE
 - DIRECTION OF TRAFFIC
 - DRUMS WITH MONO-DIRECTIONAL STEADY BURNING LIGHTS @ 50' CENTERS, 25' CENTERS ALONG TAPERS
 - IMPACT ATTENUATOR, TEMPORARY (NON-REDIRECTIVE)
 - TEMPORARY CONCRETE BARRIER

TEMPORARY CONCRETE BARRIER	
NORMAL POSTED SPEED	TAPER RATIO
40 MPH & ABOVE	12:1
BELOW & 40 MPH	8:1

END WORK ZONE SPEED LIMIT
G20-1103(O)-3660
STA 1345+00

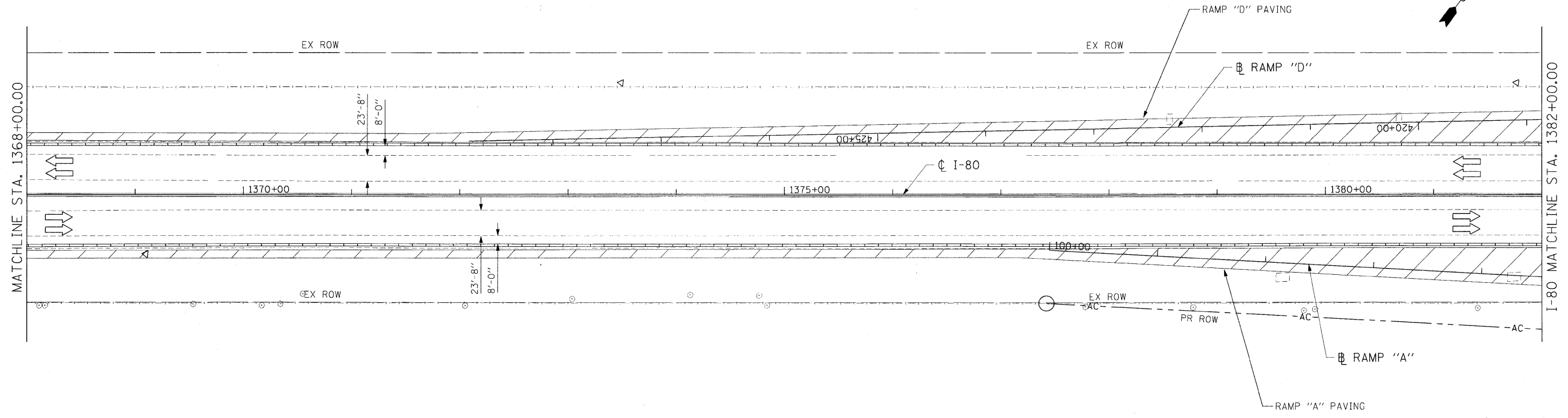
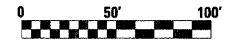
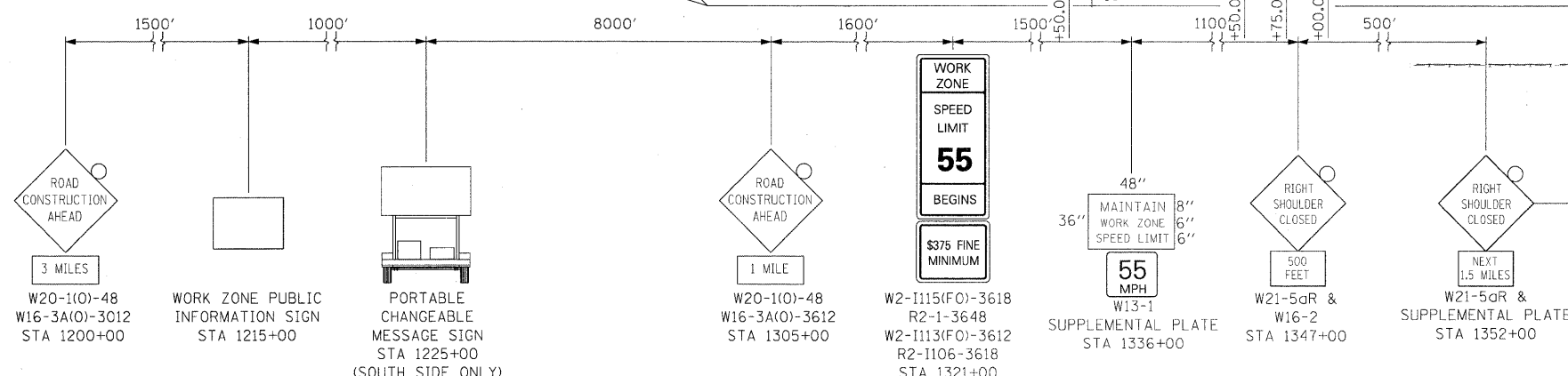

FILE NAME = t:\1812\CADD Sheets\0366408-shr-staging.dgn	USER NAME = .USER.	DESIGNED - JPW	REVISED -	STATE OF ILLINOIS DEPARTMENT OF TRANSPORTATION	MAINTENANCE OF TRAFFIC I-80 STAGE 2		F.A.U. RTE. =	SECTION = (32,47-4) HBK-4 & GIN	COUNTY = GRUNDY	TOTAL SHEETS = 351	SHEET NO. = 80	
PLOT SCALE = #SCALE#	CHECKED - AKK	REVISIONS	REVISIONS		SCALE: 1"=50'	SHEET NO. 80 OF 351 SHEETS	STA. 1358+00.00 TO STA. 1382+00.00	CONTRACT NO. 66408				
PLOT DATE = 5/20/2010	DATE - 5/20/2010	REVISIONS	REVISIONS		ILLINOIS FED. AID PROJECT							
<p style="text-align: right;">• FAI 80 & FAS 297 / FAU 392</p>												