

Bench Mark: B.M. #1409 chiseled square on S.E. wingwall of F.A.I. Route 80 bridge over Collins Run, S.N. 032-0104, Elev. 546.22.
 Existing Structure: S.N. 032-0058 built 1959 as F.A.S. Route 1259, Section (32,47)-4 at Station 1397+24.83 (I-80).
 Structure consists of four spans with 42" PPC beams and 7" reinforced concrete deck supported by pile-bent abutments and multi column piers. Pile bent abutments supported by concrete piles, wingwalls supported by timber piles and multi column piers supported by spread foundations. 244'-9" back-to-back abutment. 30'-0" out-to-out deck. Structure to be removed.
 Brisbin Road to be closed and traffic detoured during construction.

STATE OF ILLINOIS
 DEPARTMENT OF TRANSPORTATION

No Salvage

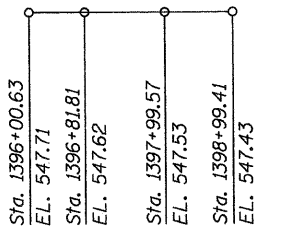
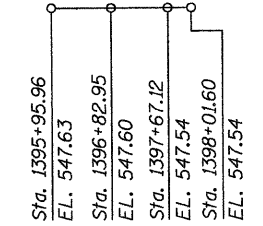
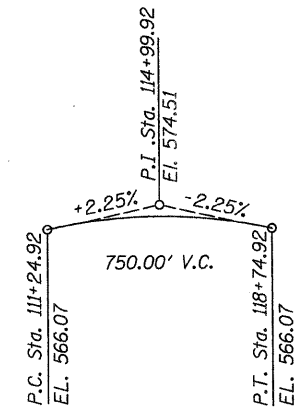
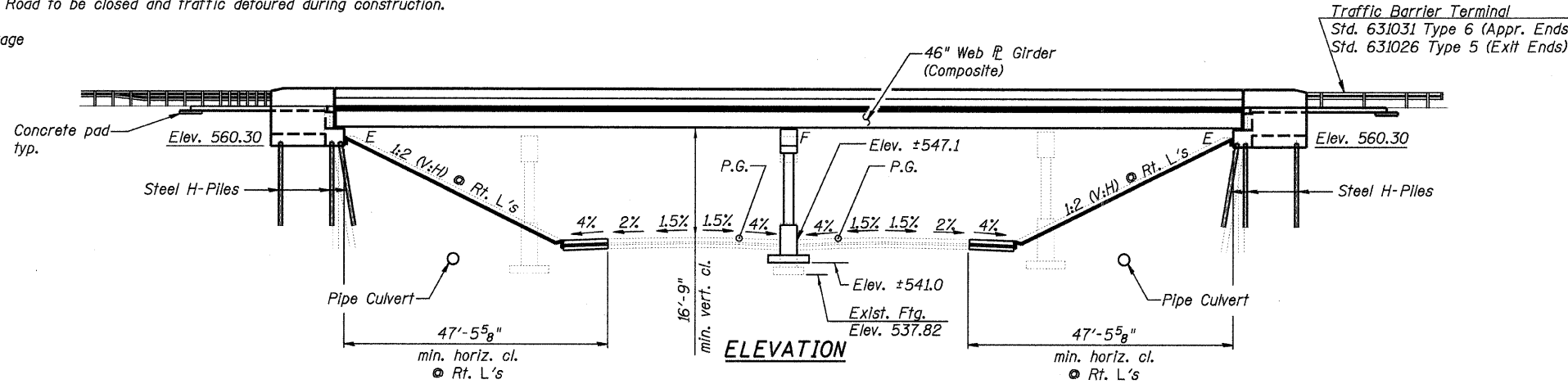

STATION 114+99.92
 BUILT 20 BY
 STATE OF ILLINOIS
 F.A.U. RT. 401 SEC (32, 47-4) HBK-4
 LOADING HL-93
 STRUCTURE NO. 032-0115

NAME PLATE
 See Std. 515001

LOADING HL-93
 Allow 50#/sq. ft. for future wearing surface.

DESIGN STRESSES
FIELD UNITS
 $f'_c = 3,500$ psi
 $f_y = 60,000$ psi (Reinforcement)
 $f_y = 36,000$ psi (M270 Grade 36)
 $f_y = 50,000$ psi (M270 Grade 50)

DESIGN SPECIFICATIONS
 AASHTO LRFD Bridge Design Specifications, 4th Edition with 2008 and 2009 Interims

SEISMIC DATA
 Seismic Performance Category (SPZ) = 1
 Design Spectral Acceleration at 1.0 sec. (SD1) = 0.070g
 Design Spectral Acceleration at 0.2 sec. (SDs) = 0.132g
 Soil Site Class = C

APPROVED
 FOR STRUCTURAL ADEQUACY ONLY
 Robert E. Anderson
 ENGINEER OF BRIDGES AND STRUCTURES

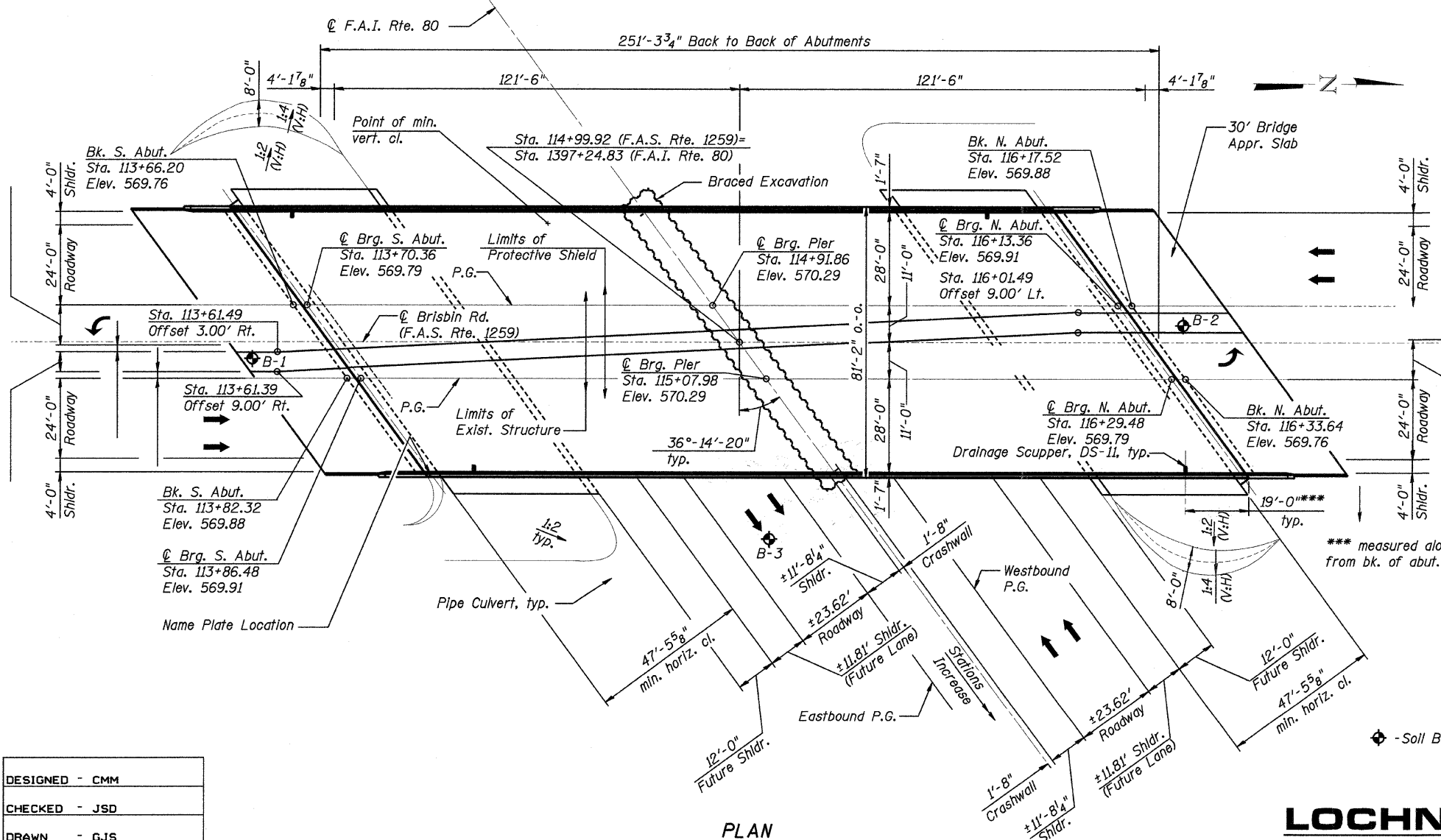
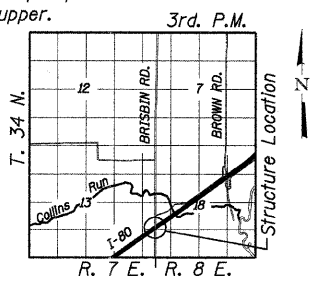

DESIGNED - CMM
CHECKED - JSD
DRAWN - GJS
CHECKED - JSD

LOCHNER
 H.W. LOCHNER, INC.
 CONSULTING ENGINEERS & PLANNERS
 20 NORTH WACKER DRIVE SUITE 1200
 CHICAGO, IL 60606

SHEET NO. 1 OF 31 SHEETS	RTE.	SECTION	COUNTY	TOTAL SHEETS	SHEET NO.
	*	(32,47-4) HBK-4 & (G)N	GRUNDY	351	283
CONTRACT NO. 66408					
FED. ROAD DIST. NO.		ILLINOIS	FED. AID PROJECT		
* FAI 80 & FAS 297 / FAU 392					

GENERAL PLAN AND ELEVATION
BRISBIN ROAD OVER I-80
 F.A.U. RT. 401 - SEC. (32, 47-4) HBK-4
 GRUNDY COUNTY
 STATION 114+99.92
 STRUCTURE NO. 032-0115

T:\2608-Bris\Struct\dgn\0320058-66408-001-GP01.dgn