

STATE OF ILLINOIS
DEPARTMENT OF TRANSPORTATION

* Order a(E) bars full length.
Cut to fit skew and use remainder
of bars in opposite end.

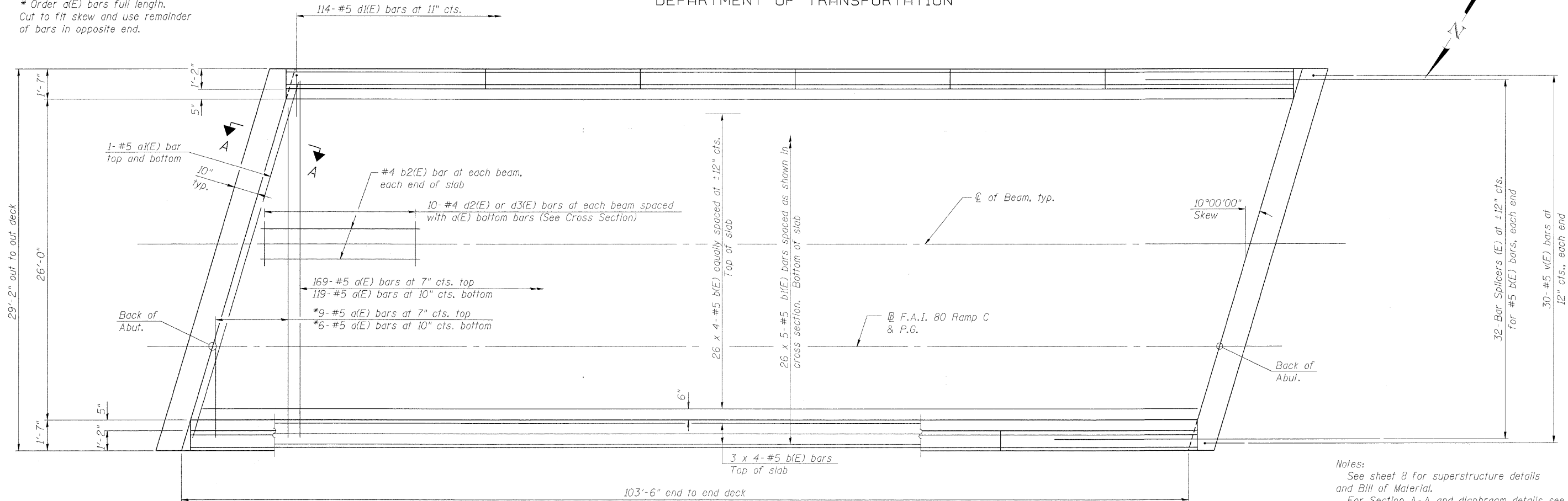

PLAN

Notes:
See sheet 8 for superstructure details
and Bill of Material.
For Section A-A and diaphragm details see
sheet 7.
Bars indicated thus 20 x 3-#5 etc. indicates
20 lines of bars with 3 lengths per line.
See sheet 8 for parapet reinforcement.

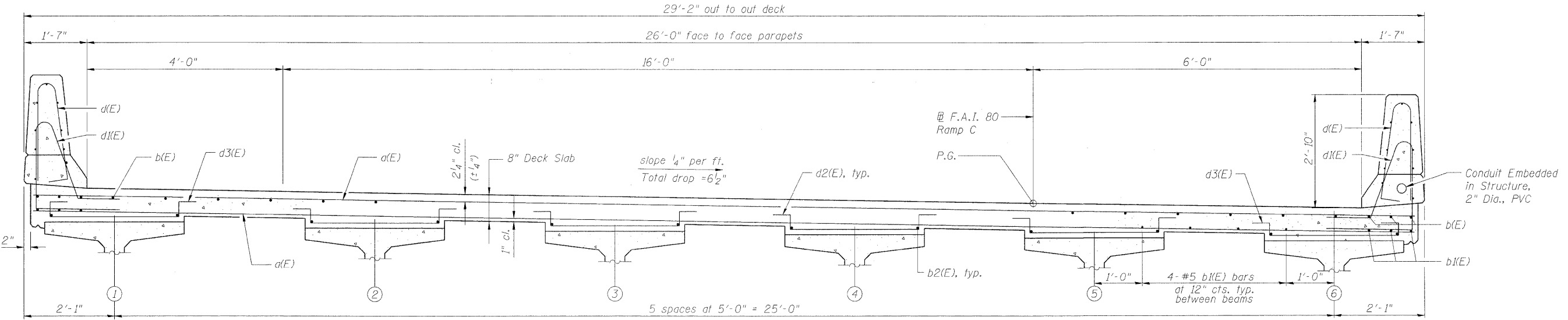

CROSS SECTION
(Looking West)

DECK PLAN AND CROSS SECTION
STRUCTURE NO. 032-0118

DESIGNED -	LJB
CHECKED -	CMM
DRAWN -	GJS
CHECKED -	CMM

MINIMUM BAR LAPS
#5 bar = 3'-3"

LOCHNER
H.W. LOCHNER, INC.
CONSULTING ENGINEERS & PLANNERS
20 NORTH WACKER DRIVE SUITE 1200
CHICAGO, IL 60606

SHEET NO. 6 OF 19 SHEETS	RTE.	SECTION	COUNTY	TOTAL SHEETS	SHEET NO.
	*	(32,47-4) HBK-4 & G(N)	GRUNDY	351	338
CONTRACT NO. 66408					
FED. ROAD DIST. NO. ILLINOIS FED. AID PROJECT					

* FAI 80 & FAS 297 / FAU 392

t:\1812\struct\dgn\0320118-66408-006-DP01.dgn