

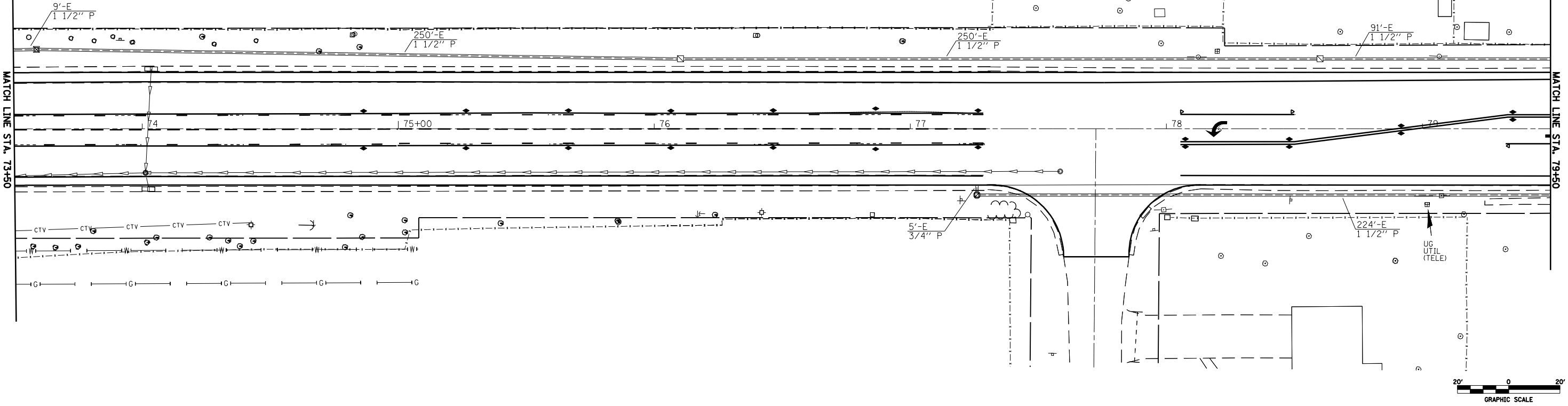

TRAFFIC SIGNAL CONDUITS SHOWN ARE BASED ON HISTORICAL DATA--CONTRACTOR SHOULD VERIFY ACTUAL LENGTHS PRIOR TO PULLING WIRE OR CABLE

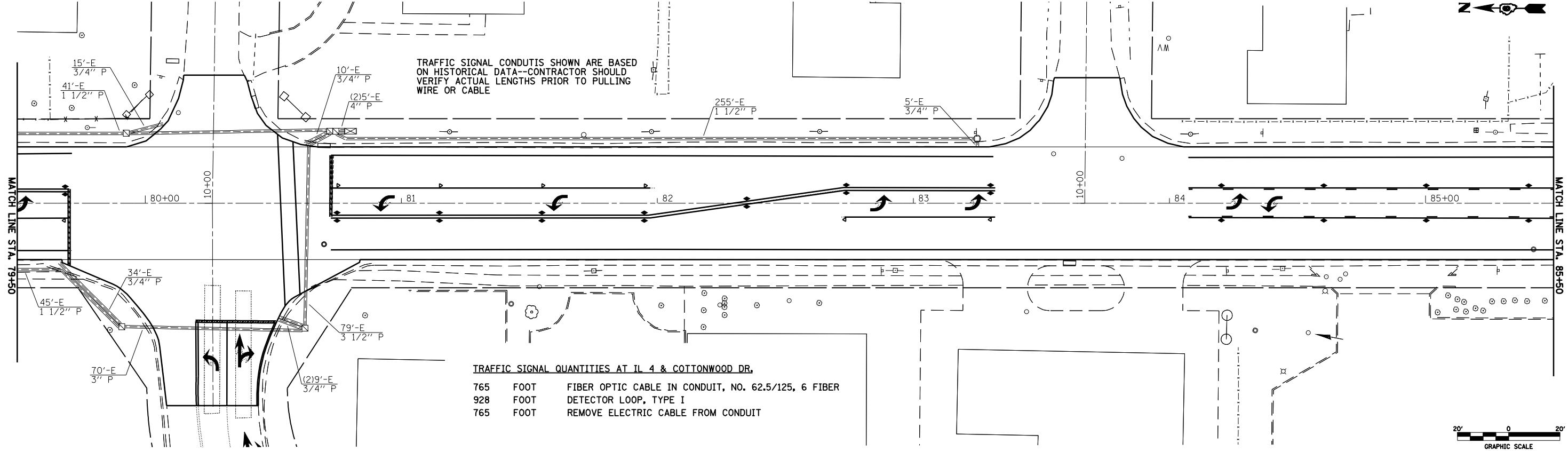

TRAFFIC SIGNAL CONDUITS SHOWN ARE BASED ON HISTORICAL DATA--CONTRACTOR SHOULD VERIFY ACTUAL LENGTHS PRIOR TO PULLING WIRE OR CABLE



**TRAFFIC SIGNAL QUANTITIES AT IL 4 & COTTONWOOD DR.**

765	FOOT	FIBER OPTIC CABLE IN CONDUIT, NO. 62.5/125, 6 FIBER
928	FOOT	DETECTOR LOOP, TYPE I
765	FOOT	REMOVE ELECTRIC CABLE FROM CONDUIT

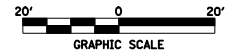

FILE NAME =  
 USER NAME = laughlinr1  
 DESIGNED -  
 DRAWN -  
 PLOT SCALE = 40.0000 ' / IN.  
 PLOT DATE = Jun-28-2010 11:00:18AM

DESIGNED -  
 DRAWN -  
 CHECKED -  
 DATE -

REVISED -  
 REVISED -  
 REVISED -  
 REVISED -

**STATE OF ILLINOIS  
 DEPARTMENT OF TRANSPORTATION**

**PROPOSED PLAN  
 IL 4 / MAIN ST. & TEAL DR.**

SCALE: 1" = 20'    SHEET NO. 3 OF 10 SHEETS    STA.    TO STA.

F.A.P. RTE.	SECTION	COUNTY	TOTAL SHEETS	SHEET NO.
662	HRS-10,B-2)	SANGAMON	84	37
CONTRACT NO. 72A73				
ILLINOIS FED. AID PROJECT				