

F.A.P. RTE.	SECTION	COUNTY	TOTAL SHEETS	SHEET NO.
554	(18G) CR	PIKE	4	1
FED. ROAD DIST. NO.	ILLINOIS	CONTRACT NO. 72D79		

STATE OF ILLINOIS
DEPARTMENT OF TRANSPORTATION
DIVISION OF HIGHWAYS

PROPOSED CONTRACT MAINTENANCE

FOR INDEX OF SHEETS, SEE SHEET NO. 2

FAP 554 (IL 107)
SECTION (18G) I

PIKE COUNTY

D-96-014-10

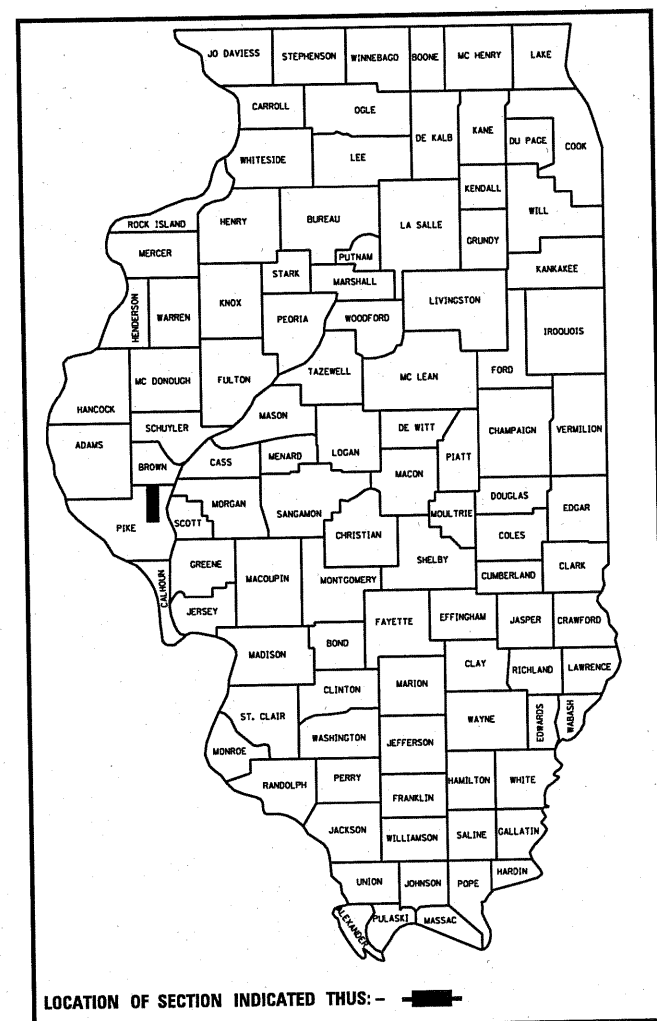

C-96-014-10

R 3 W

BEGIN PROJECT
STA. 539 + 10

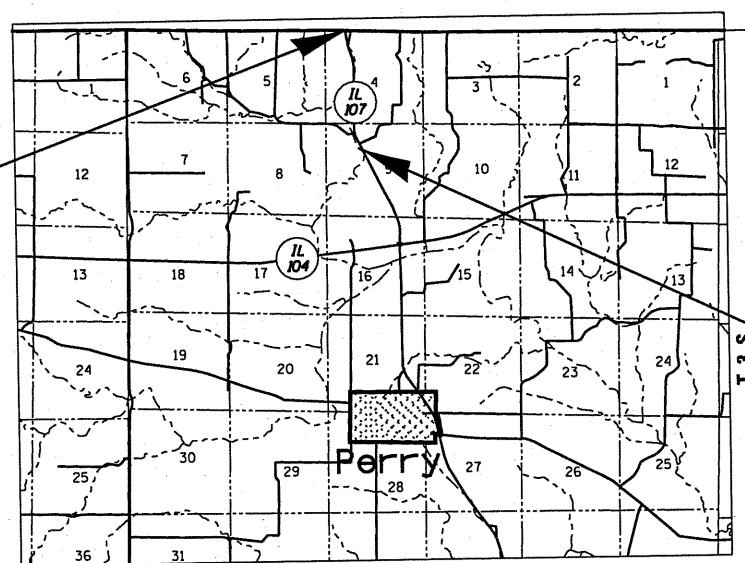

END PROJECT
STA. 600 + 90

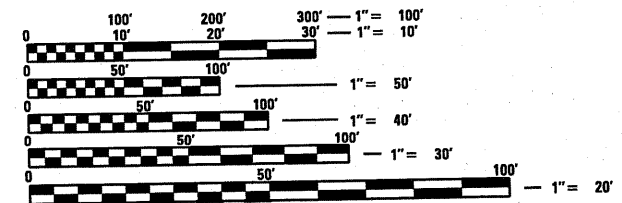

FULL SIZE PLANS HAVE BEEN PREPARED USING STANDARD ENGINEERING SCALES. REDUCED SIZED PLANS WILL NOT CONFORM TO STANDARD SCALES. IN MAKING MEASUREMENTS ON REDUCED PLANS, THE ABOVE SCALES MAY BE USED.

J.U.L.I.E.
JOINT UTILITY LOCATION INFORMATION FOR EXCAVATION
1-800-892-0123
OR 811

PLAN AND CONTRACT TECHNICIAN
TIMOTHY SHARP (217)782-7743

CONTRACT NO. 72D79

GROSS LENGTH = 6,180.00 FT. = 1.170 MILE

STATE OF ILLINOIS
DEPARTMENT OF TRANSPORTATION
DIVISION OF HIGHWAYS

SUBMITTED July 1 20 10
Reg. 2 Smith
DEPUTY DIRECTOR OF HIGHWAYS, REGION ENGINEER

Aug 13 20 10
Scott E. Still P.E. IBC
ACTING ENGINEER OF DESIGN AND ENVIRONMENT

Aug 13 20 10
Christine M. Reed
DIRECTOR OF HIGHWAYS, CHIEF ENGINEER

PRINTED BY THE AUTHORITY
OF THE STATE OF ILLINOIS

INDEX

- 1 COVER
- 2 INDEX/STANDARDS/SIGNATURES
- 3 QUANTITIES
- 4 SCHEDULES

STANDARDS

- 701001-02
- 701006-03
- 701901-01

STATE OF ILLINOIS DEPARTMENT OF TRANSPORTATION DIVISION OF HIGHWAYS DISTRICT 6	
EXAMINED <u>6/29</u> 20 <u>10</u>	<u><i>Chris Walker</i></u> ENGINEER OF OPERATIONS
EXAMINED <u>JUNE 14</u> 20 <u>10</u>	<u><i>Jimmy Ford</i></u> ENGINEER OF PROJECT IMPLEMENTATION
EXAMINED <u>JUN 17</u> 20 <u>10</u>	<u><i>2RMLI</i></u> ENGINEER OF PROGRAM DEVELOPMENT

INDEX/STANDARDS/SIGNATURES
FAP 554 (IL 107)
SECTION (18G) I
PIKE COUNTY

INSERTION CULVERT LINER SCHEDULE

STATION	EXIST. C.M.P. SIZE	LENGTH	20" DIA. LINER LENGTH	24" DIA. LINER LENGTH	63" DIA. LINER LENGTH
539+10	30"	48 FT		48 FT	
540+85	30"	53 FT		53 FT	
546+40	30"	97 FT		97 FT	
547+95	30"	67 FT		67 FT	
568+78	24"	75 FT	67 FT		
584+21	30"	55 FT		55 FT	
597+52	72"	51 FT			51 FT
600+90	30"	37 FT		37 FT	
TOTALS			67 FT	357 FT	51 FT

NOTES:
STATIONS ARE APPROXIMATE.

SCHEDULES
FAP 554 (IL 107)
SECTION (18G) I
PIKE COUNTY