

NOTE:  
SEE INTERSECTION  
DETAIL SHEETS FOR  
DETAILS

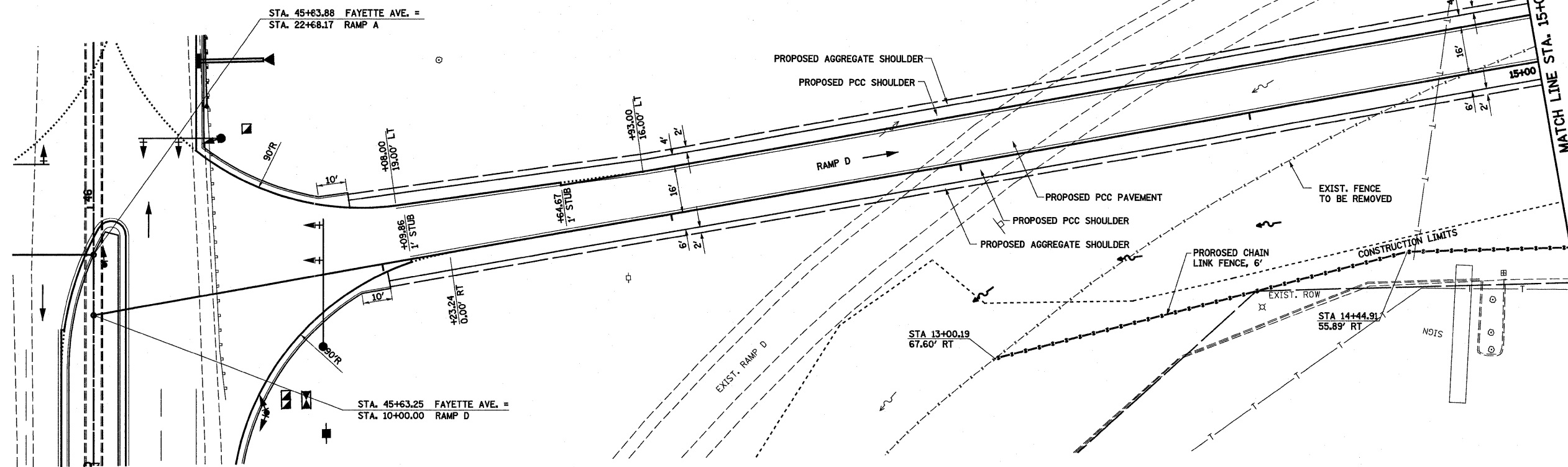

DATE	
BY	
REVISION	
NO.	
PLAN	
NO.	
NO.	
NO.	
NO.	
NO.	

DATE	
BY	
REVISION	
NO.	
PROFILE	
NO.	
NO.	
NO.	
NO.	
NO.	

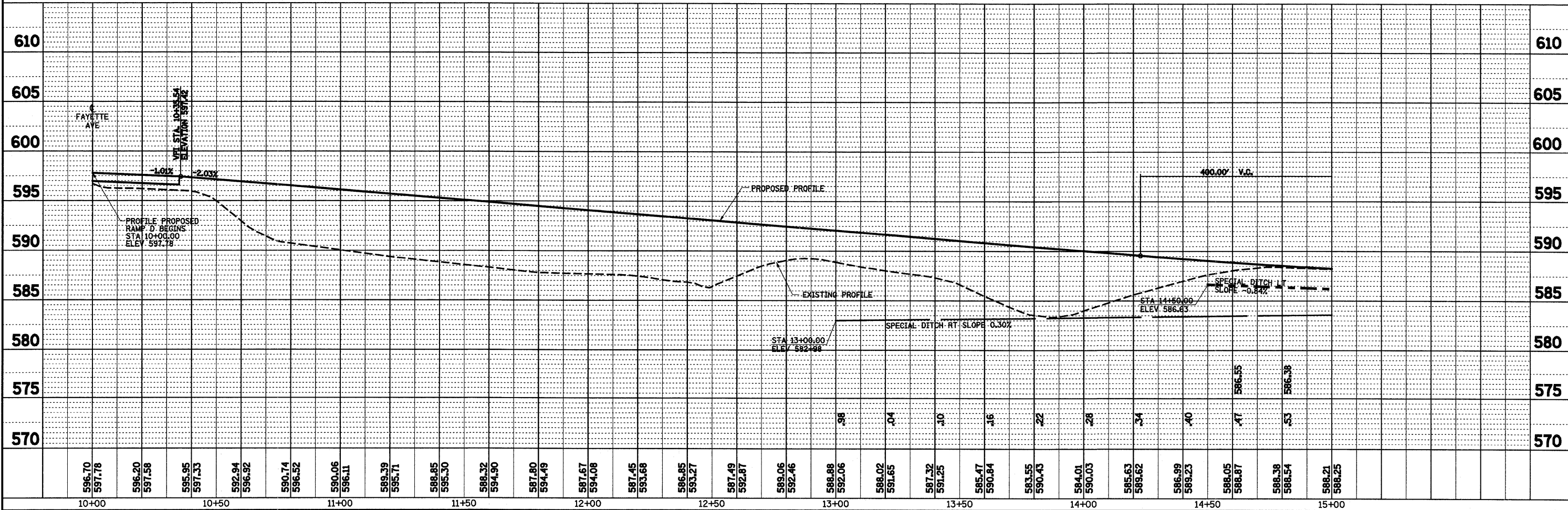

FILE NAME =	USER NAME = paul	DESIGNED - JWS	REVISED -
		DRAWN - PDB	REVISED -
		CHECKED - BRM	REVISED -
		DATE - 11-16-07	REVISED -
<b>STATE OF ILLINOIS DEPARTMENT OF TRANSPORTATION</b>			
<b>PLAN AND PROFILE, RAMP D, FAYETTE AVENUE</b>			
SCALE: 1"=20'	SHEET NO. 11 OF 12 SHEETS	STA. 10+00.00 TO STA. 15+00.00	F.A.I. RTE. 57/70
		SECTION (25-3)I-6	
		COUNTY EFFINGHAM	
		TOTAL SHEETS 839	
		SHEET NO. 68	
CONTRACT NO. 74293			
FED. ROAD DIST. NO. ILLINOIS FED. AID PROJECT			