

DATE: \_\_\_\_\_  
 BY: \_\_\_\_\_  
 CHECKED: \_\_\_\_\_  
 ALIGNED: \_\_\_\_\_  
 PLAN: \_\_\_\_\_  
 NO. \_\_\_\_\_

DATE: \_\_\_\_\_  
 BY: \_\_\_\_\_  
 CHECKED: \_\_\_\_\_  
 GRADES: \_\_\_\_\_  
 PROFILE: \_\_\_\_\_  
 NO. \_\_\_\_\_

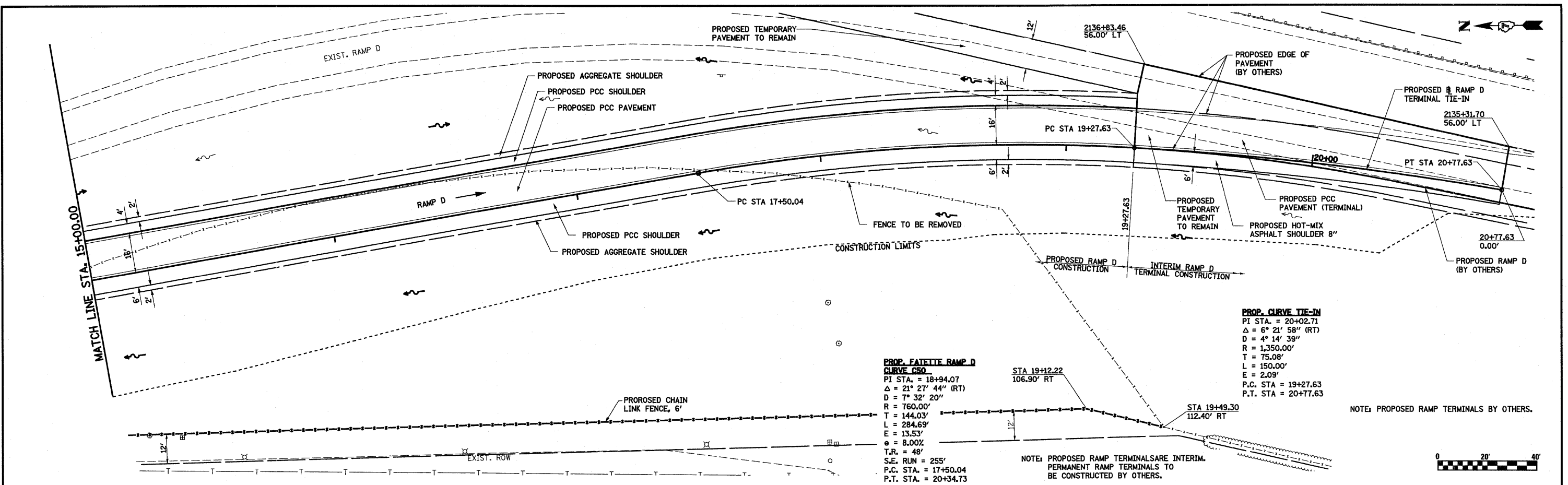

**PROP. FATTE RAMP D CURVE CSO**  
 PI STA. = 18+94.07  
 $\Delta$  = 21° 27' 44" (RT)  
 D = 7° 32' 20"  
 R = 760.00'  
 T = 144.03'  
 L = 284.69'  
 E = 13.53'  
 $e$  = 8.00%  
 T.R. = 48'  
 S.E. RUN = 255'  
 P.C. STA. = 17+50.04  
 P.T. STA. = 20+34.73

**PROP. CURVE TIE-IN**  
 PI STA. = 20+02.71  
 $\Delta$  = 6° 21' 58" (RT)  
 D = 4° 14' 39"  
 R = 1,350.00'  
 T = 75.08'  
 L = 150.00'  
 E = 2.09'  
 P.C. STA. = 19+27.63  
 P.T. STA. = 20+17.63

NOTE: PROPOSED RAMP TERMINALS BY OTHERS.

NOTE: PROPOSED RAMP TERMINALS ARE INTERIM. PERMANENT RAMP TERMINALS TO BE CONSTRUCTED BY OTHERS.

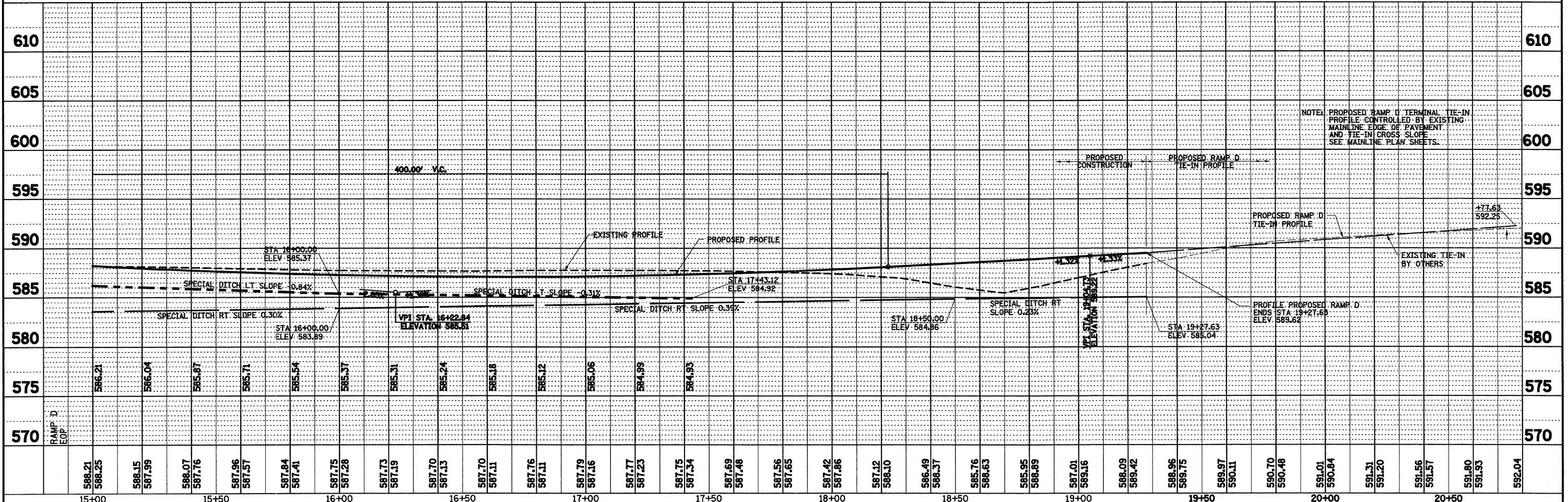
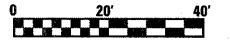

FILE NAME =	USER NAME = paul	DESIGNED - JWS	REVISED -	STATE OF ILLINOIS DEPARTMENT OF TRANSPORTATION				PLAN AND PROFILE, RAMP D, FAYETTE AVENUE				F.A.I. RTE.	SECTION	COUNTY	TOTAL SHEETS	SHEET NO.	
5:\Projects\100-1007-57-70.dwg\1007-57-70.dwg		DRAWN - PDB	REVISED -									57/70	(25-3)I-6	EFFINGHAM	839	69	
PLOT SCALE = 40.0000' / IN.		CHECKED - BRM	REVISED -	SCALE: 1"=20'				SHEET NO. 12 OF 12 SHEETS				STA. 15+00.00 TO STA. 20+50.00				CONTRACT NO. 74293	
PLOT DATE = 6/24/2010		DATE - 11-16-07	REVISED -														