

TYPICAL APPLICATION  
STAGE 3

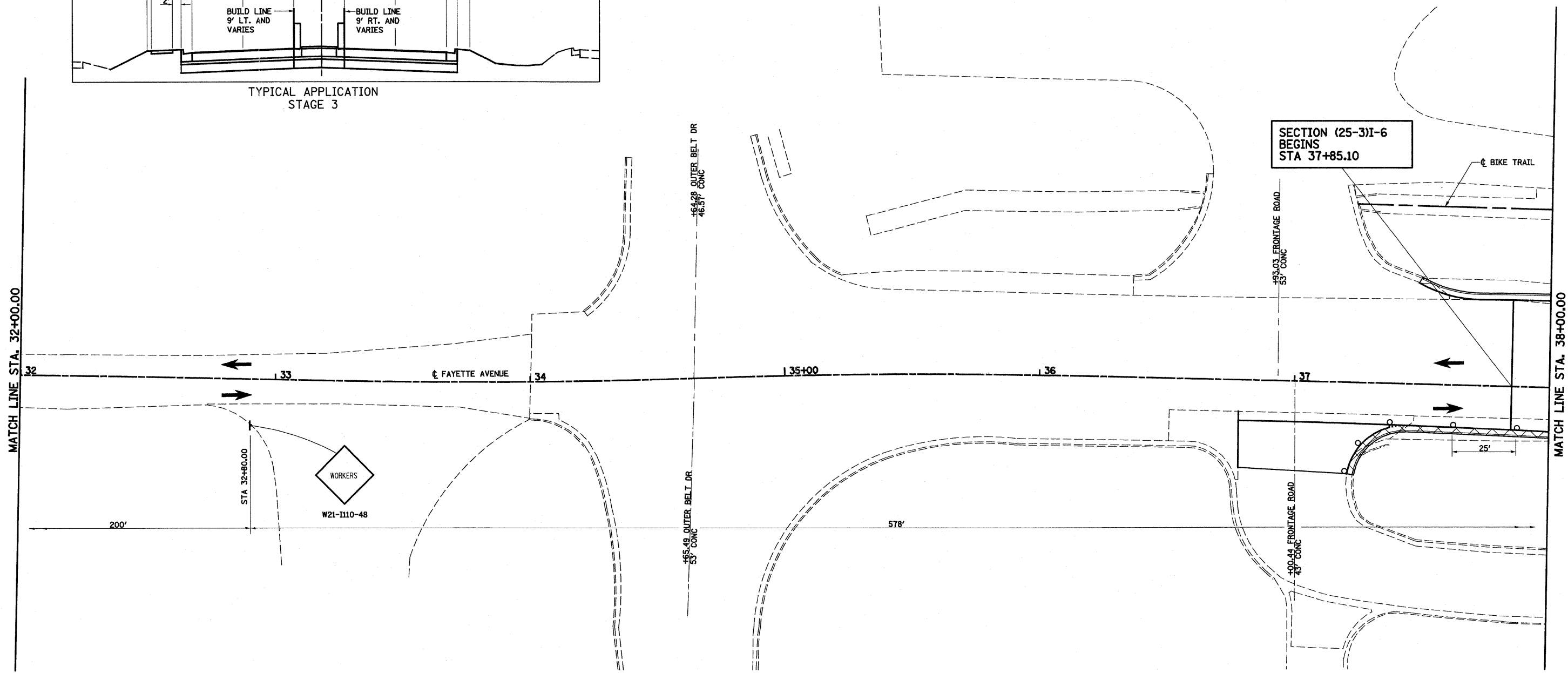

**LEGEND**

- |  |                                |  |   |
|--|--------------------------------|--|---|
|  | WORK AREA THIS STAGE           |  | DIRECTION OF TRAFFIC  |
|  | TEMPORARY PCC PAVEMENT         |  | TYPE II BARRICADES OR DRUMS WITH MONO-DIRECTIONAL STEADY BURNING LIGHTS UNLESS OTHER WISE NOTED |
|  | TEMPORARY HOT-MIX ASPHALT RAMP |  | VERTICAL PANEL  |
|  | SIGN                           |  | TYPE III BARRICADES   |

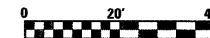

FILE NAME =	USER NAME = paul	DESIGNED - JWS	REVISED -	<b>STATE OF ILLINOIS DEPARTMENT OF TRANSPORTATION</b>	<b>MAINTENANCE OF TRAFFIC, STAGE 3, FAYETTE AVENUE</b>	F.A.I. RTE.	SECTION	COUNTY	TOTAL SHEETS	SHEET NO.	
S:\Projects\403-00072.51-70\dgn\Fayette\MotFay_53.dgn		DRAWN - PDB	REVISED -			57/70	(25-3)I-6	EFFINGHAM	839	135	
PLOT SCALE = 40.0000' / IN.		CHECKED - BRM	REVISED -			<b>CONTRACT NO. 74293</b>					
PLOT DATE = 6/24/2010		DATE - 11-16-07	REVISED -			SCALE: 1"=20'    SHEET NO. 3 OF 11 SHEETS    STA. 32+00.00 TO STA. 38+00.00    FED. ROAD DIST. NO.    ILLINOIS FED. AID PROJECT					