

NORTHWEST QUADRANT - RAMP B					
POINT	ELEVATION	NORTHING	EASTING	ROADWAY STATION	ROADWAY OFFSET
FAYETTE					
150	599.90	893,688.75	917,871.14	53+63.76	-35.00
151	599.37	893,696.80	917,877.10	53+69.54	-43.18
FAYETTE RAMP B					
152	599.06	893,705.47	917,882.13	10+59.12	-35.92
153	598.76	893,714.64	917,886.16	10+67.56	-30.52
154	598.46	893,724.20	917,889.14	10+76.54	-26.10
155	598.17	893,734.03	917,891.05	10+85.96	-22.71

NORTHEAST QUADRANT - RAMP B					
POINT	ELEVATION	NORTHING	EASTING	ROADWAY STATION	ROADWAY OFFSET
FAYETTE					
156	597.72	893,699.69	917,980.00	54+72.36	-48.23
157	597.84	893,702.09	917,970.30	54+62.61	-50.42
158	597.92	893,705.55	917,960.92	54+53.16	-53.68
159	597.95	893,710.03	917,951.98	54+62.61	-50.42
160	597.94	893,715.47	917,943.59	54+72.36	-48.23
FAYETTE RAMP B					
161	597.75	893,721.82	917,935.85	10+67.01	19.68
162	597.73	893,728.98	917,928.87	10+75.16	13.88
163	597.65	893,736.87	917,922.72	10+83.91	9.03
164	597.52	893,745.40	917,917.49	10+93.14	5.17
165	597.35	893,754.45	917,913.24	1+02.74	2.35

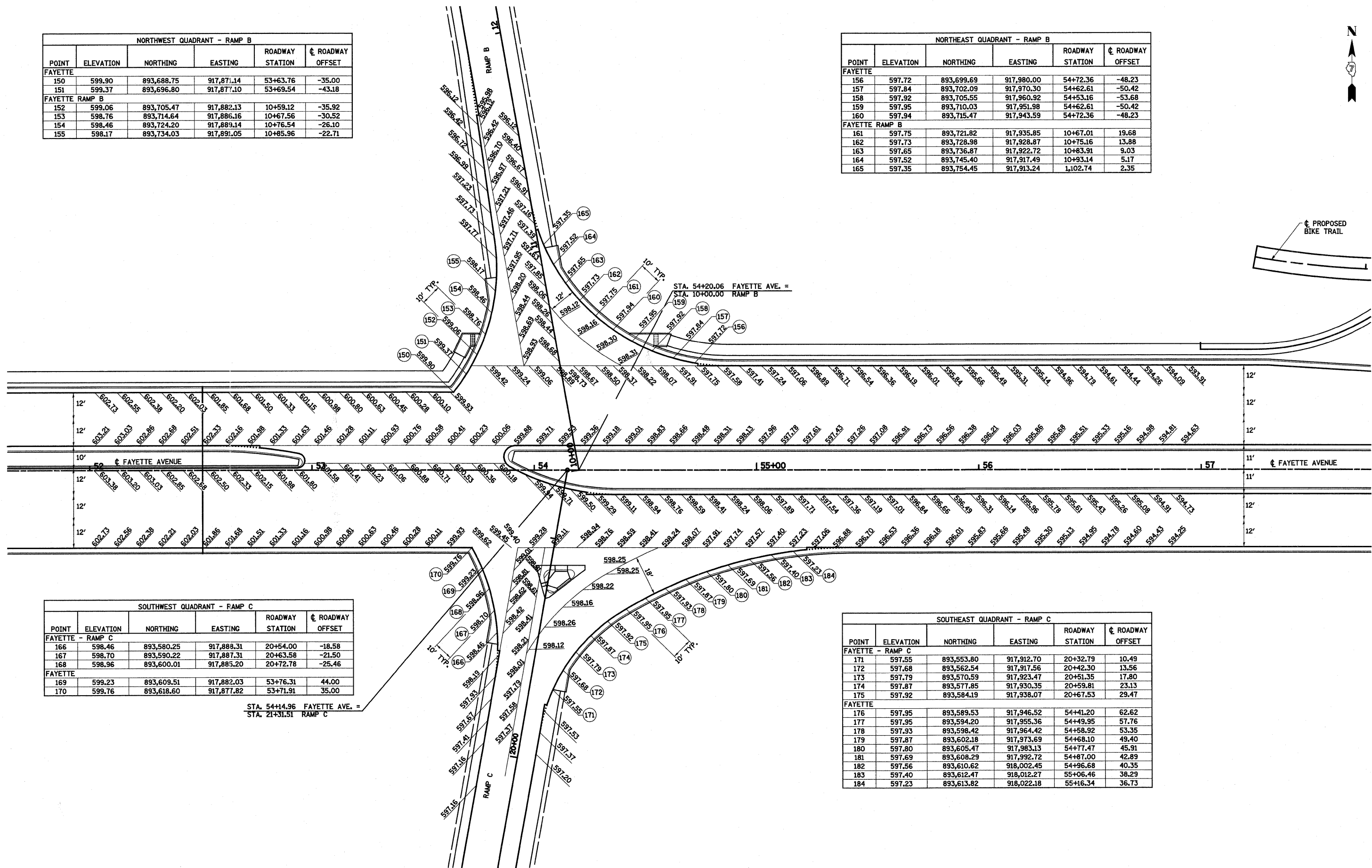

SOUTHWEST QUADRANT - RAMP C					
POINT	ELEVATION	NORTHING	EASTING	ROADWAY STATION	ROADWAY OFFSET
FAYETTE - RAMP C					
166	598.46	893,580.25	917,888.31	20+54.00	-18.58
167	598.70	893,590.22	917,887.31	20+63.58	-21.50
168	598.96	893,600.01	917,885.20	20+72.78	-25.46
FAYETTE					
169	599.23	893,609.51	917,882.03	53+76.31	44.00
170	599.76	893,618.60	917,877.82	53+71.91	35.00

SOUTHEAST QUADRANT - RAMP C					
POINT	ELEVATION	NORTHING	EASTING	ROADWAY STATION	ROADWAY OFFSET
FAYETTE - RAMP C					
171	597.55	893,553.80	917,912.70	20+32.79	10.49
172	597.68	893,562.54	917,917.56	20+42.30	13.56
173	597.79	893,570.59	917,923.47	20+51.35	17.80
174	597.87	893,577.85	917,930.35	20+59.81	23.13
175	597.92	893,584.19	917,938.07	20+67.53	29.47
FAYETTE					
176	597.95	893,589.53	917,946.52	54+41.20	62.62
177	597.95	893,594.20	917,955.36	54+49.95	57.76
178	597.93	893,598.42	917,964.42	54+58.92	53.35
179	597.87	893,602.18	917,973.69	54+68.10	49.40
180	597.80	893,605.47	917,983.13	54+77.47	45.91
181	597.69	893,608.29	917,992.72	54+87.00	42.89
182	597.56	893,610.62	918,002.45	54+96.68	40.35
183	597.40	893,612.47	918,012.27	55+06.46	38.29
184	597.23	893,613.82	918,022.18	55+16.34	36.73

STA. 54+14.96 FAYETTE AVE. =
STA. 21+31.51 RAMP C