

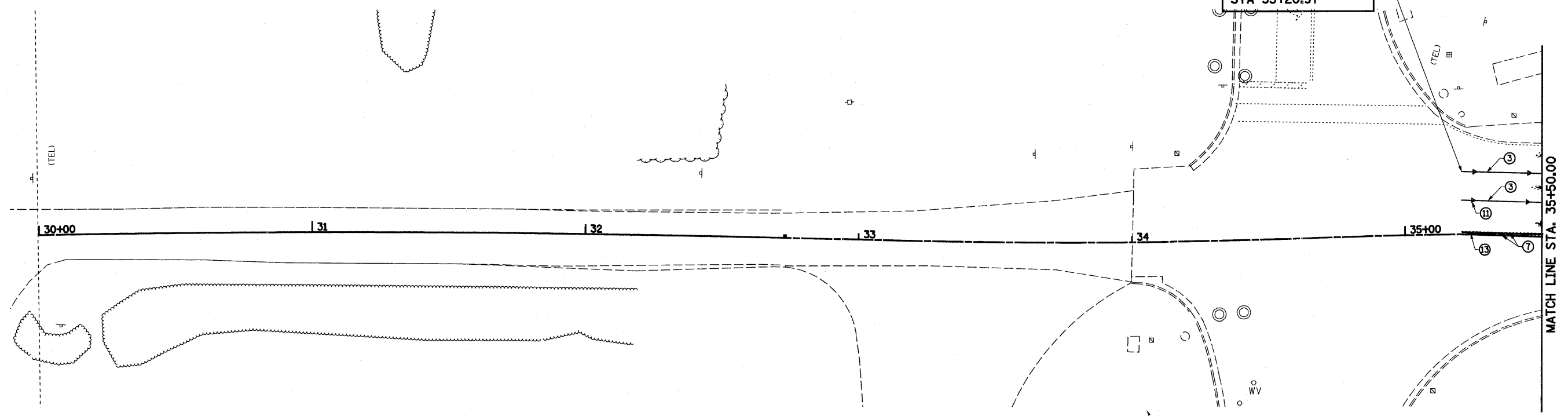

PAVEMENT MARKING  
BEGINS  
STA 35+20.97



SECTION (25-3)I-6  
BEGINS  
STA 37+85.10

PAVEMENT MARKING  
LINE 4" (YELLOW)  
SKIP DASH  
SEE DETAIL A

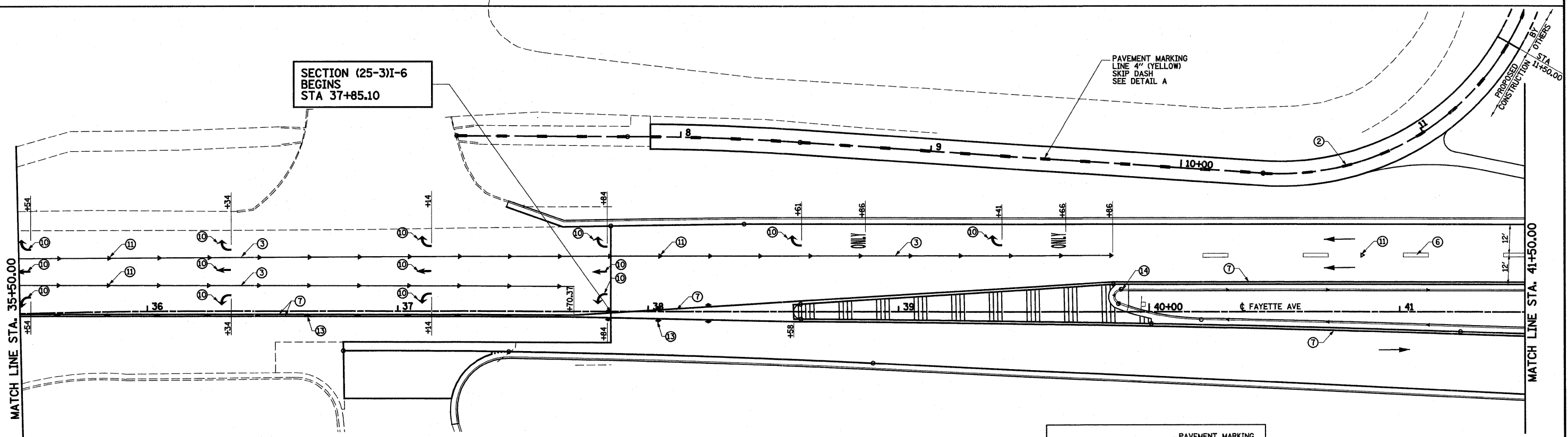

- ① URETHANE PAVEMENT MARKING LINE - 4" SOLID WHITE
- ② URETHANE PAVEMENT MARKING LINE - 4" SKIP DASH YELLOW
- ③ URETHANE PAVEMENT MARKING LINE - 6" SOLID WHITE
- ④ URETHANE PAVEMENT MARKING LINE - 12" SOLID WHITE
- ⑤ URETHANE PAVEMENT MARKING LINE - 24" SOLID WHITE
- ⑥ URETHANE PAVEMENT MARKING LINE - 6" SKIP DASH WHITE
- ⑦ URETHANE PAVEMENT MARKING LINE - 4" SOLID YELLOW
- ⑧ URETHANE PAVEMENT MARKING LINE - 12" SOLID YELLOW
- ⑨ URETHANE PAVEMENT MARKING LINE - 8" SOLID WHITE
- ⑩ URETHANE PAVEMENT MARKING - LETTERS AND SYMBOLS
- ⑪ RAISED REFLECTIVE PAVEMENT MARKERS - CRYSTAL, ONE-WAY
- ⑫ RAISED REFLECTIVE PAVEMENT MARKERS - AMBER, ONE-WAY
- ⑬ RAISED REFLECTIVE PAVEMENT MARKERS - AMBER, TWO-WAY
- ⑭ PRISMATIC CURB REFLECTORS

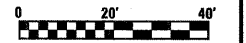
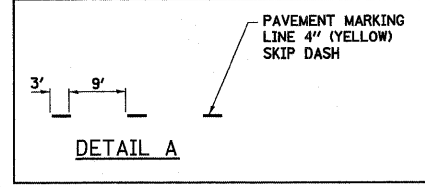

FILE NAME = S:\Projects\403-00072-ST-70\dm\Fayette\pavk_shts.dwg	USER NAME = paul	DESIGNED - JWS	REVISED -	<b>STATE OF ILLINOIS DEPARTMENT OF TRANSPORTATION</b>	<b>PAVEMENT MARKING, FAYETTE AVENUE</b>	F.A.I. RTE. 57/70	SECTION (25-3)I-6	COUNTY EFFINGHAM	TOTAL SHEETS 839	SHEET NO. 204	
PLOT SCALE = 40,0000' / IN.		CHECKED - BRM	REVISED -		SCALE: 1"=20'	SHEET NO. 1 OF 13 SHEETS	STA. 32+71.37 TO STA. 41+50.00		CONTRACT NO. 74293		
PLOT DATE = 6/28/2010		DATE - 4-23-08	REVISED -		FED. ROAD DIST. NO. ILLINOIS FED. AID PROJECT						
ILLINOIS FED. AID PROJECT											