

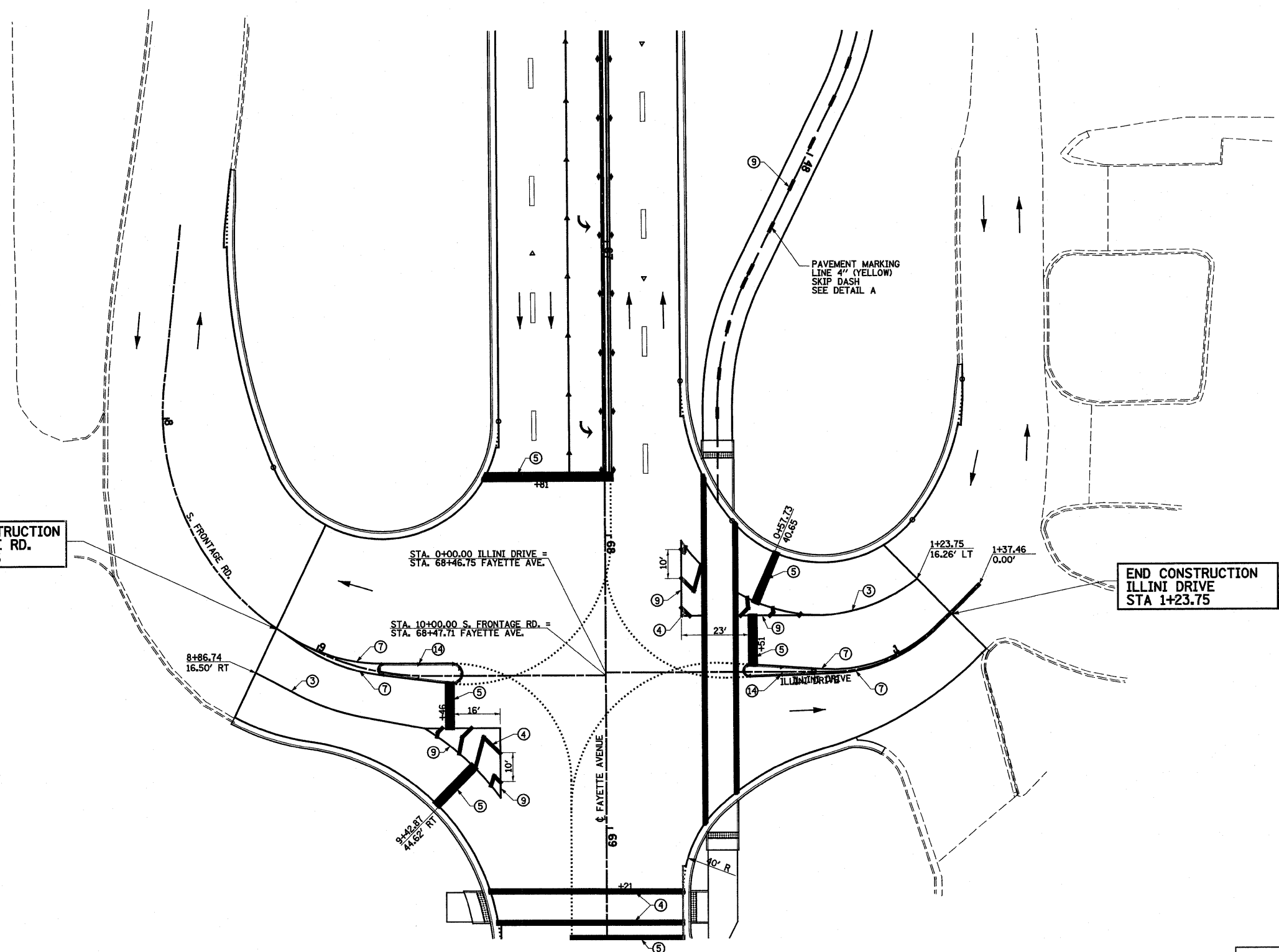

**BEGIN CONSTRUCTION  
S. FRONTAGE RD.  
STA 8+84.46**

**END CONSTRUCTION  
ILLINI DRIVE  
STA 1+23.75**



- |  |   |
|--|---|
| ① URETHANE PAVEMENT MARKING LINE - 4" SOLID WHITE      | ⑧ URETHANE PAVEMENT MARKING LINE - 12" SOLID YELLOW     |
| ② URETHANE PAVEMENT MARKING LINE - 4" SKIP DASH YELLOW | ⑨ URETHANE PAVEMENT MARKING LINE - 8" SOLID WHITE       |
| ③ URETHANE PAVEMENT MARKING LINE - 6" SOLID WHITE      | ⑩ URETHANE PAVEMENT MARKING - LETTERS AND SYMBOLS       |
| ④ URETHANE PAVEMENT MARKING LINE - 12" SOLID WHITE     | ⑪ RAISED REFLECTIVE PAVEMENT MARKERS - CRYSTAL, ONE-WAY |
| ⑤ URETHANE PAVEMENT MARKING LINE - 24" SOLID WHITE     | ⑫ RAISED REFLECTIVE PAVEMENT MARKERS - AMBER, ONE-WAY   |
| ⑥ URETHANE PAVEMENT MARKING LINE - 6" SKIP DASH WHITE  | ⑬ RAISED REFLECTIVE PAVEMENT MARKERS - AMBER, TWO-WAY   |
| ⑦ URETHANE PAVEMENT MARKING LINE - 4" SOLID YELLOW     | ⑭ PRISMATIC CURB REFLECTORS                             |

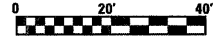
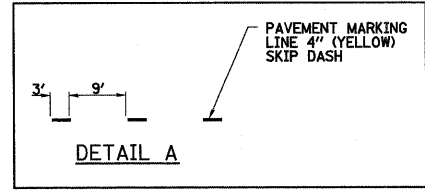

FILE NAME =	USER NAME = paul	DESIGNED - JWS	REVISED -	<b>STATE OF ILLINOIS DEPARTMENT OF TRANSPORTATION</b>	<b>PAVEMENT MARKING, FAYETTE AVENUE</b>			F.A.I. RTE.	SECTION	COUNTY	TOTAL SHEETS	SHEET NO.
S:\Projects\1403-00072-57-70\cgn\Fayette\pmk.dwg		DRAWN - PDB	REVISED -		SCALE: 1"=20'	SHEET NO. 6 OF 13 SHEETS	STA. 64+00.00 TO STA. 73+81.75	57/70	(25-3)-6	EFFINGHAM	839	209
PLOT SCALE = 40.0000 / IN.		CHECKED - BRM	REVISED -					<b>CONTRACT NO. 74293</b>				
PLOT DATE = 6/28/2010		DATE - 4-23-08	REVISED -					FED. ROAD DIST. NO. ILLINOIS FED. AID PROJECT				