

See Sheet 3 of 3
 "Illini Drive -Signal Layout"

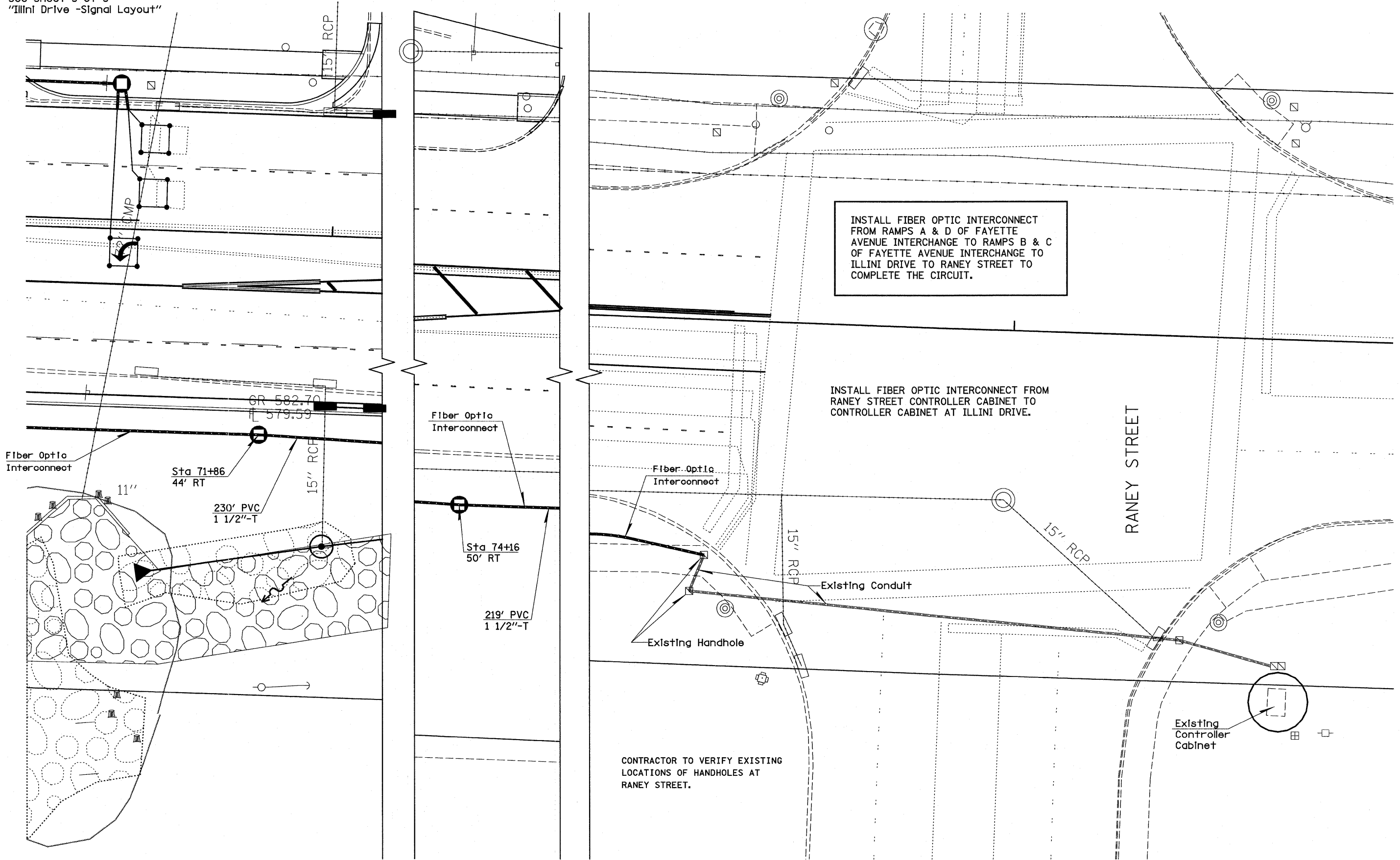

INSTALL FIBER OPTIC INTERCONNECT FROM RAMPS A & D OF FAYETTE AVENUE INTERCHANGE TO RAMPS B & C OF FAYETTE AVENUE INTERCHANGE TO ILLINI DRIVE TO RANEY STREET TO COMPLETE THE CIRCUIT.

INSTALL FIBER OPTIC INTERCONNECT FROM RANEY STREET CONTROLLER CABINET TO CONTROLLER CABINET AT ILLINI DRIVE.

CONTRACTOR TO VERIFY EXISTING LOCATIONS OF HANDHOLES AT RANEY STREET.

FILE NAME =	USER NAME = paul	DESIGNED -	REVISED -	STATE OF ILLINOIS DEPARTMENT OF TRANSPORTATION	ILLINI DRIVE TO RANEY STREET FIBER OPTICS INTERCONNECT	F.A.I. RTE.	SECTION	COUNTY	TOTAL SHEETS	SHEET NO.	
#FILEL#		DRAWN -	REVISED -			70	(25-311-6 & (25-311-2)B	EFFINGHAM	839	259	
		CHECKED -	REVISED -			CONTRACT NO. 74293					
		DATE -	REVISED -			ILLINOIS FED. AID PROJECT					
				SCALE:	SHEET NO. OF SHEETS	STA.	TO STA.				