

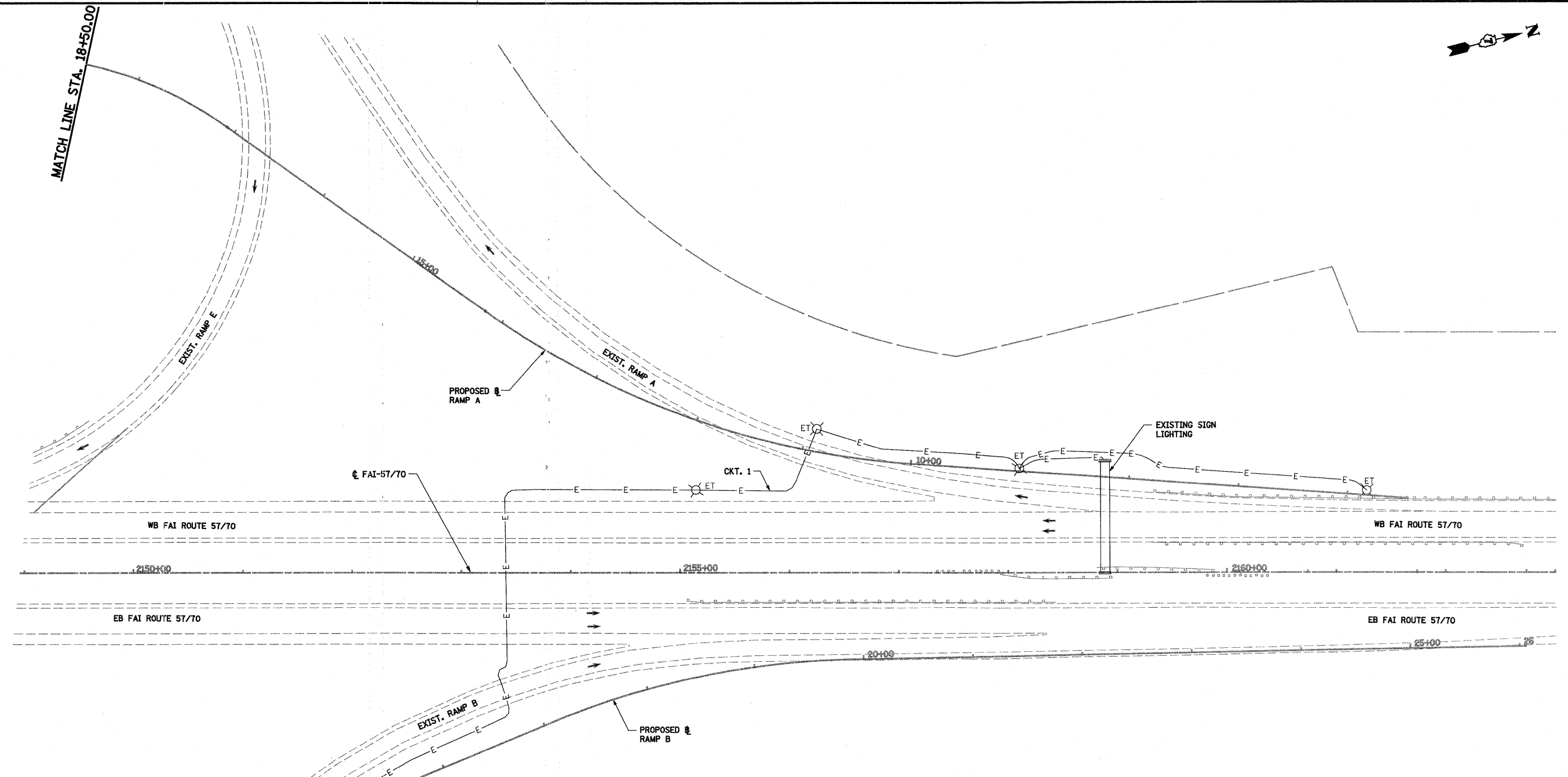

MATCH LINE STA. 18+50.00

MATCH LINE STA. 19+00.00



LEGEND

- EXISTING LIGHTING UNIT TO BE REMOVED
- EXISTING LIGHTING UNIT USED AS TEMPORARY
- TEMPORARY WOOD POLE, 55 FEET, CLASS 4
- EXISTING LIGHTING CONTROLLER
- TEMPORARY WOOD POLE, 55 FEET, CLASS 4 WITH 250W HPS LUMINAIRE, 45 FEET MOUNTING HEIGHT, ARROW INDICATES LUMINAIRE AIMING DIRECTION
- EXISTING UNIT DUCT OR CABLE IN CONDUIT
- AERIAL CABLE, 2-1/C NO. 4 UNLESS OTHERWISE NOTED WITH MESSENGER WIRE
- TEMPORARY UNIT DUCT, 2-1/C NO. 6, 1/C NO. 8 GROUND, OXP-TYPE USE, 1" DIA. POLYETHYLENE, UNLESS NOTED OTHERWISE
- WORK AREA THIS STAGE
- STAGE 1B CONSTRUCTION
- TEMPORARY PCC PAVEMENT

NOTES:

1. THE LOCATIONS OF EXISTING UNIT DUCT AS SHOWN ON THE PLANS ARE APPROXIMATE. THE CONTRACTOR SHALL VERIFY THE EXACT LOCATION IN THE FIELD PRIOR TO CONSTRUCTION.
2. ALL EXISTING CABLE IS TO BE ABANDONED WHEN NO LONGER REQUIRED FOR LIGHTING.
3. TEMPORARY LIGHTING SHOWN IN STAGE 1 IS TO BE CONSTRUCTED IN PRE-STAGE 1 AND ILLUMINATED IN STAGE 1.
4. TEMPORARY WOOD POLES TO BE INSTALLED OUTSIDE THE CLEAR ZONE AT A 30 FT SETBACK MINIMUM FROM EXISTING, TEMPORARY OR PROPOSED ROADWAY EDGE OF PAVEMENT OR 4 FT BEHIND THE GUARDRAIL OR BARRIER UNLESS NOTED OTHERWISE.
5. TEMPORARY WOOD POLES SHALL BE TALLER THAN 55 FEET AS NEEDED TO MAINTAIN REQUIRED GROUND CLEARANCE OF AERIAL CABLES AND 45 FEET LUMINAIRE MOUNTING HEIGHT.

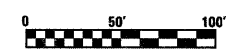

FILE NAME =	USER NAME = paul	DESIGNED -	REVISED -	STATE OF ILLINOIS DEPARTMENT OF TRANSPORTATION	EXISTING LIGHTING REMOVAL AND TEMPORARY LIGHTING FAYETTE AVENUE RAMPS STAGE 1	F.A.I. RTE.	SECTION	COUNTY	TOTAL SHEETS	SHEET NO.
S:\Projects\403-00072-57-70\dgn\FayetteLighting.ras	FayetteLighting.dgn	DRAWN -	REVISED -			57/70	(23-3)I-6	EFFINGHAM	839	268
PLOT SCALE = 1/8" = 1' IN.		CHECKED -	REVISED -			CONTRACT NO. 74293				
PLOT DATE = 6/23/2018		DATE -	REVISED -			ILLINOIS FED. AID PROJECT				
				SCALE: 1"=50'		SHEET NO. 6 OF 24 SHEETS		STA. 2155+00.00 TO STA. 2169+00.00		