

Bench Mark: Chiseled "□" on east crash wall under Fayette Avenue on North Bound of I-57/70 Sta. 2146+48.00 65 Rt.
Elev. 583.44

STATE OF ILLINOIS
DEPARTMENT OF TRANSPORTATION

Existing Structure: #025-0023 Built in 1960 as F.A.I. Route 7 Section 25-3HB-1 & 25-3HF-1. 251'-0" Bk. to Bk. of abutments and 65'-8" Out to Out Width. The structure consists of an R.C. deck on WF beams with 2 spans continuous and 2 simple end spans supported on pile bent spill through abutments and on reinforced concrete columns with spread footing. Traffic to be maintained at all times utilizing stage construction.

** See Sheet 3 of 38 for Transverse Limits of Protective Shield.

No salvage.

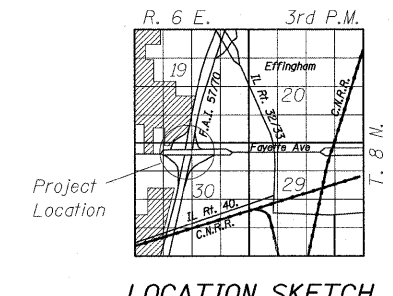
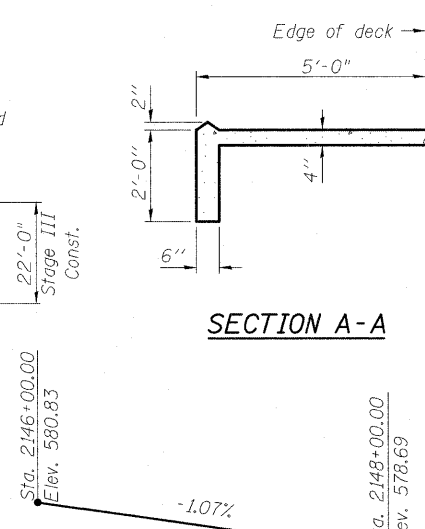
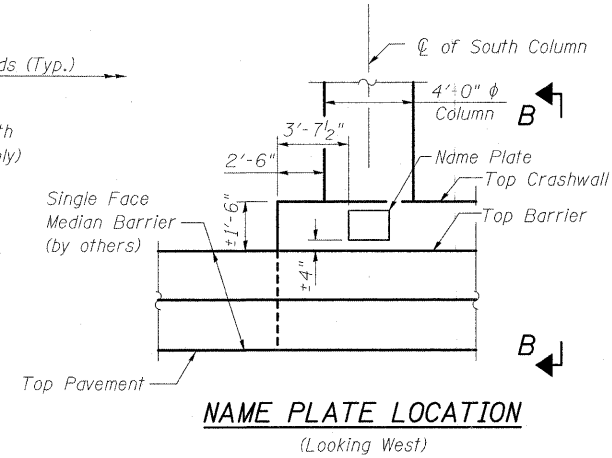
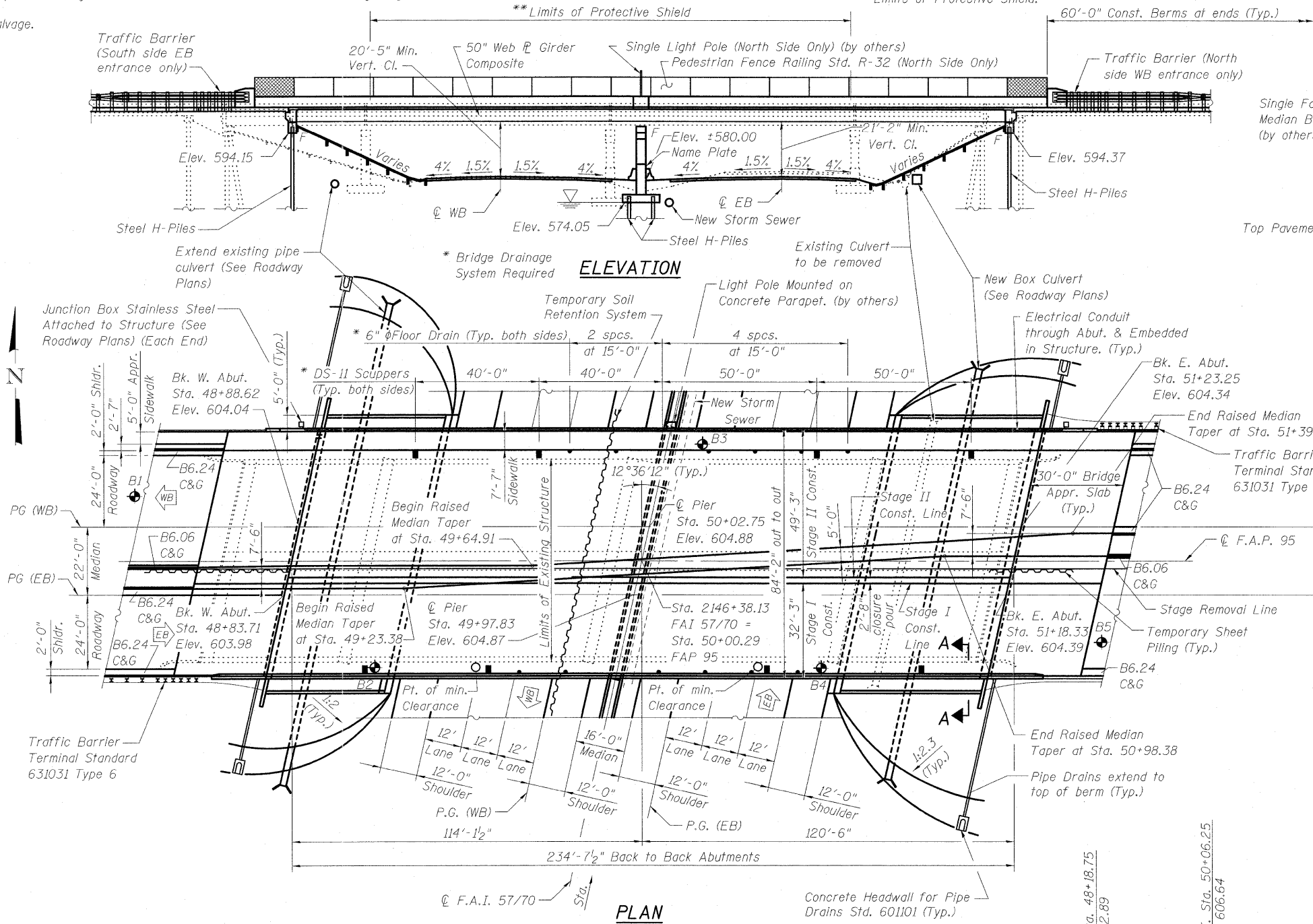

INDEX OF SHEETS

1. General Plan & Elevation
2. General Data
3. Stage Construction Details
4. Temporary Shoring Details
5. Temporary Concrete Barrier for Stage Construction
- 6.-11. Top of Slab Elevations
12. West Approach Pavement Top of Slab Elevations
13. East Approach Pavement Top of Slab Elevations
- 14.-15. Superstructure
- 16.-17. Superstructure Details
18. Bridge Fence Railing Parapet Mounted
19. Concrete Parapet Slipforming Option
20. Drainage Scupper, DS-II
- 21.-22. Drainage System
23. West Bridge Approach Slab Details
24. East Bridge Approach Slab Details
25. Bridge Approach Slab Details
26. West Abutment Diaphragm Details
27. East Abutment Diaphragm Details
28. Structural Steel
29. Structural Steel & Bearing Details
- 29B. Structural Steel Crossframe Details
30. West Abutment Details
31. East Abutment Details
- 32.-32B. Pier Details
33. HP Pile Details
34. Bar Splicer Assembly & Mechanical Splicer Details
- 35.-38. Boring Logs

LOADING HL-93

Allow 50#/sq. ft. for future wearing surface.

DESIGN SPECIFICATIONS

2007 AASHTO LRFD Bridge Design Specifications
4th edition with 2008 and 2009 Interims

DESIGN STRESSES

FIELD UNITS

- $f'_c = 3,500$ psi
- $f_y = 60,000$ psi (Reinforcement)
- $f_y = 50,000$ psi (M270 Grade 50) primary members
- $f_y = 36,000$ psi (M270 Grade 36)

SEISMIC DATA

Seismic Performance Zone (SPZ) = 1
Design Spectral Acceleration at 1.0 sec. (S_{D1}) = 0.15
Design Spectral Acceleration at 0.2 sec. (S_{D5}) = 0.36
Soil Site Class = C

STATION 2146+38.13
BUILT 20__ BY
STATE OF ILLINOIS
F.A.I. 57/70 SEC. (25-3HB-2)B
LOADING HL-93
STR. NO. 025-0106

NAME PLATE

See Std. 515001

GENERAL PLAN & ELEVATION

FAYETTE AVENUE OVER

F.A.I. ROUTE 57/70

F.A.P.-95 SECTION (25-3B-2)B

EFFINGHAM COUNTY

STATION 2146+38.13

STRUCTURE NO. 025-0106

APPROVED
FOR STRUCTURAL ADEQUACY ONLY

Robert E. Andersen (T)P
ENGINEER OF BRIDGES AND STRUCTURES

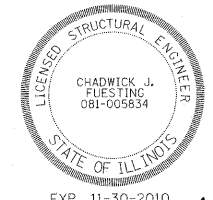

EXP. 11-30-2010
Chadwick J. Flesting
8/12/2010

DESIGNED	A.C.S.
CHECKED	B.B.
DRAWN	W.J.S.
CHECKED	C.J.F.

SECTION B-B

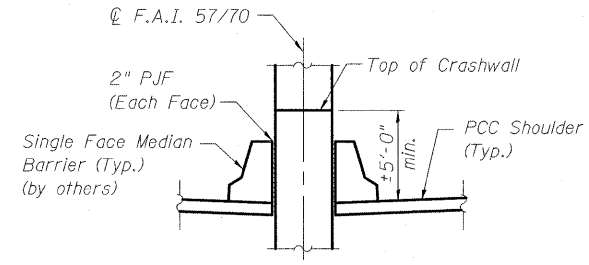

PROFILE GRADE

(EB & WB Fayette Avenue)
(Along Edge of Median)

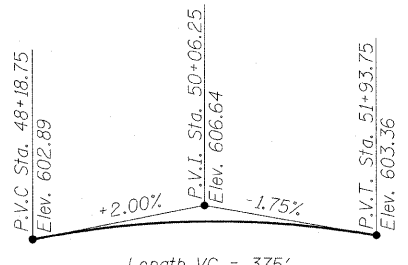

Illinois Design Firm Number 184.001670

BERNARDIN
LOCHMUELLER &
ASSOCIATES, INC.

3 Oak Drive
Maryville, IL 62432-5655
Local (618) 338-4665
Fax 618-338-4666

SHEET NO. 1	F.A.I. RTE. 57/70	SECTION (25-3HB-2)B	COUNTY EFFINGHAM	TOTAL SHEETS 839	SHEET NO. 330
38 SHEETS	SN 025-0106		CONTRACT NO. 74293		
FED. ROAD DIST. NO. 7 ILLINOIS FED. AID PROJECT					