

STATE OF ILLINOIS
DEPARTMENT OF TRANSPORTATION

EDGE OF SIDEWALK

Location	Station	Offset from $\text{\textcircled{C}}$ F.A.P. 95	Theoretical Grade Elevations
End of West Approach	48+66.13	-44.58	603.39
A	48+76.13	-44.58	603.54
B	48+86.13	-44.58	603.68
Back of West Abutment	48+96.13	-44.58	603.81

NORTH EDGE OF SHOULDER

Location	Station	Offset from $\text{\textcircled{C}}$ F.A.P. 95	Theoretical Grade Elevations
End of West Approach	48+64.43	-37.00	603.16
A	48+74.43	-37.00	603.31
B	48+84.43	-37.00	603.45
Back of West Abutment	48+94.43	-37.00	603.58

NORTH EDGE OF PAVEMENT

Location	Station	Offset from $\text{\textcircled{C}}$ F.A.P. 95	Theoretical Grade Elevations
End of West Approach	48+63.99	-35.00	603.19
A	48+73.99	-35.00	603.34
B	48+83.99	-35.00	603.48
Back of West Abutment	48+93.99	-35.00	603.61

PROFILE GRADE (W.B.)

Location	Station	Offset from $\text{\textcircled{C}}$ F.A.P. 95	Theoretical Grade Elevations
End of West Approach	48+58.62	-11.00	603.61
A	48+68.62	-11.00	603.76
B	48+78.62	-11.00	603.91
Back of West Abutment	48+88.62	-11.00	604.04

$\text{\textcircled{C}}$ F.A.P. 95

Location	Station	Offset from $\text{\textcircled{C}}$ F.A.P. 95	Theoretical Grade Elevations
End of West Approach	48+56.16	0.00	603.74
A	48+66.16	0.00	603.90
B	48+76.16	0.00	604.05
Back of West Abutment	48+86.16	0.00	604.18

STAGE I CONST. LINE

Location	Station	Offset from $\text{\textcircled{C}}$ F.A.P. 95	Theoretical Grade Elevations
End of West Approach	48+54.74	6.33	603.62
A	48+64.74	6.33	603.78
B	48+74.74	6.33	603.93
Back of West Abutment	48+84.74	6.33	604.07

PROFILE GRADE (E.B.)

Location	Station	Offset from $\text{\textcircled{C}}$ F.A.P. 95	Theoretical Grade Elevations
End of West Approach	48+53.71	11.00	603.53
A	48+63.71	11.00	603.69
B	48+73.71	11.00	603.84
Back of West Abutment	48+83.71	11.00	603.98

SOUTH EDGE OF PAVEMENT

Location	Station	Offset from $\text{\textcircled{C}}$ F.A.P. 95	Theoretical Grade Elevations
End of West Approach	48+48.33	35.00	602.94
A	48+58.33	35.00	603.10
B	48+68.33	35.00	603.26
Back of West Abutment	48+78.33	35.00	603.40

SOUTH EDGE OF SHOULDER

Location	Station	Offset from $\text{\textcircled{C}}$ F.A.P. 95	Theoretical Grade Elevations
End of West Approach	48+47.89	37.00	602.89
A	48+57.89	37.00	603.06
B	48+67.89	37.00	603.21
Back of West Abutment	48+77.89	37.00	603.36

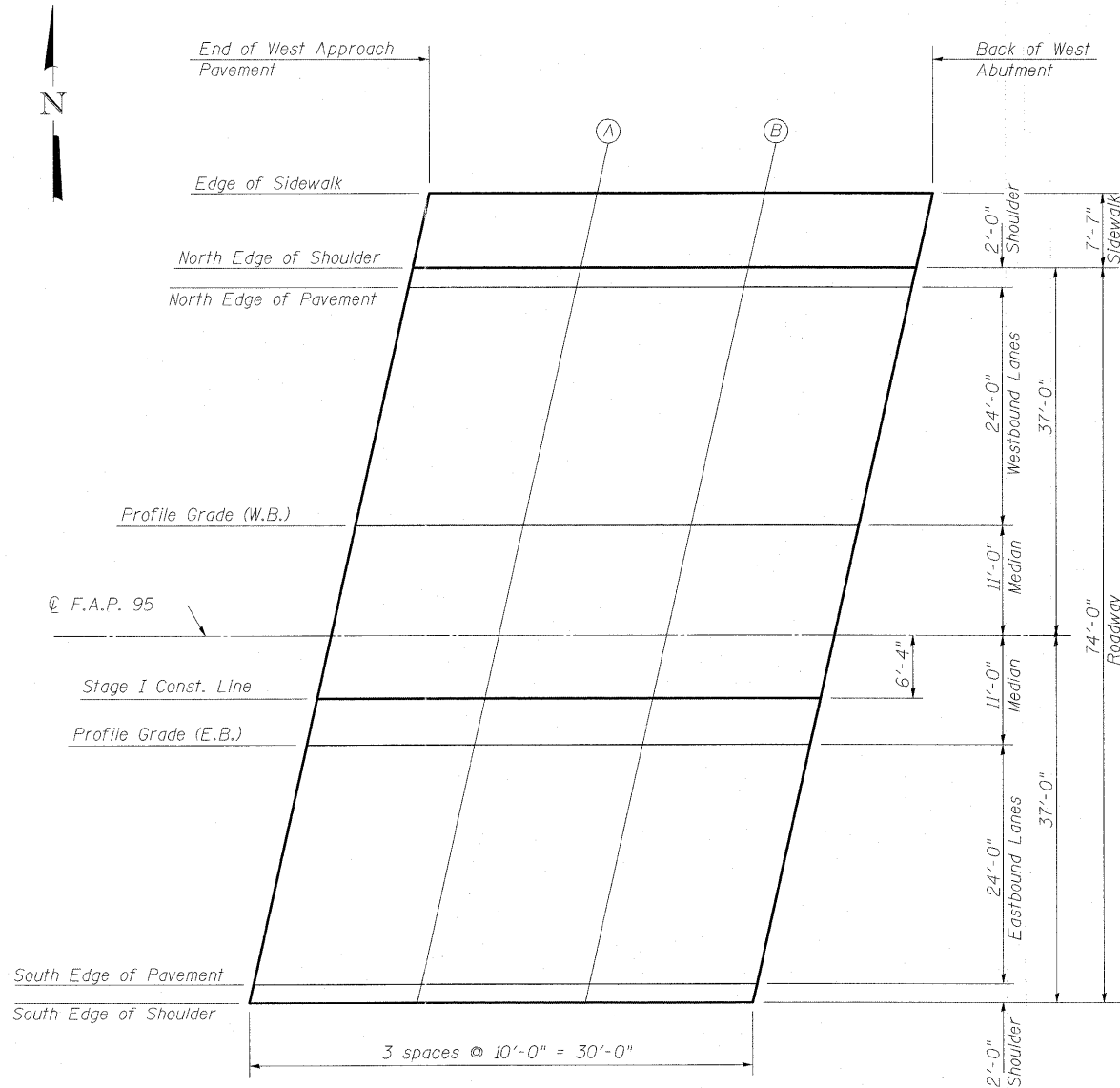

PLAN WEST APPROACH

DESIGNED	A.C.S.
CHECKED	B.B.
DRAWN	W.J.S.
CHECKED	C.J.F.

WEST APPROACH TOP OF SLAB ELEVATIONS
STRUCTURE NO. 025-0106

BERNARDIN LOCHMUELLER & ASSOCIATES, INC.
3 Oak Drive
Maryville, IL 62442-9655
Local (618) 398-4995
Fax 618-288-4996

SHEET NO. 12	F.A.I. RTE. 57/70	SECTION (25-3HB-2)B	COUNTY EFFINGHAM	TOTAL SHEETS 839	SHEET NO. 341
38 SHEETS	SN 025-0106		CONTRACT NO. 74293		
FED. ROAD DIST. NO. 7 ILLINOIS FED. AID PROJECT					

10/25/05 AM 8/12/2010 10:25:05 AM for sth12.dgn