

BY: _____ DATE: _____
 SURVEYED _____
 PLOTTED _____
 TEMPLATE _____
 NOTE BOOK _____
 AREAS CHECKED _____
 NO. _____

BY: _____ DATE: _____
 SURVEYED _____
 PLOTTED _____
 TEMPLATE _____
 NOTE BOOK _____
 AREAS CHECKED _____
 NO. _____

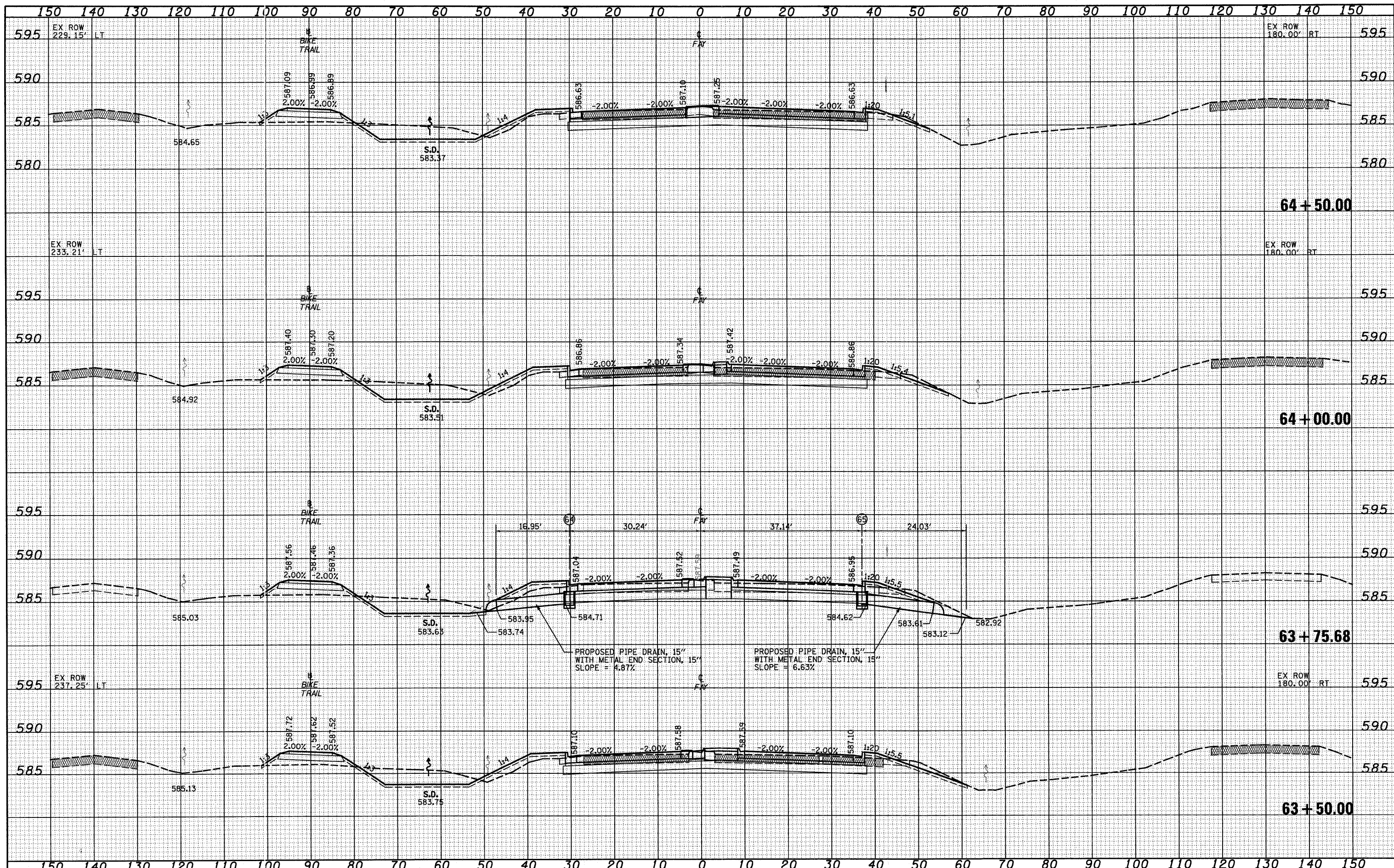

FILE NAME = 30Projects\03-00072-57-70.dgn\Fayette\ssd\H.dgn	USER NAME = lnda	DESIGNED - JWS	REVISED -	STATE OF ILLINOIS DEPARTMENT OF TRANSPORTATION	CROSS SECTIONS, FAYETTE AVE.			F.A. RT. 57/70	SECTION (25-3)-6	COUNTY EFFINGHAM	TOTAL SHEETS 839	SHEET NO. 401
	PLOT SCALE = 20,0000' / IN.	DRAWN - LEC	REVISED -		SCALE: 1"=10'	SHEET NO. 32 OF 43 SHEETS	STA. 63+50.00 TO STA. 64+50.00	FED. ROAD DIST. NO.	ILLINOIS FED. AID PROJECT	CONTRACT NO. 74293		
	PLOT DATE = 6/24/2010	CHECKED - BRM	REVISED -									
		DATE - 11-05-07	REVISED -									