

DATE	
BY	
FINAL SURVEY	
SURVEYED	
NOTE BOOK	
NO.	
AREAS CHECKED	

DATE	
BY	
ORIGINAL SURVEY	
SURVEYED	
NOTE BOOK	
NO.	
AREAS CHECKED	

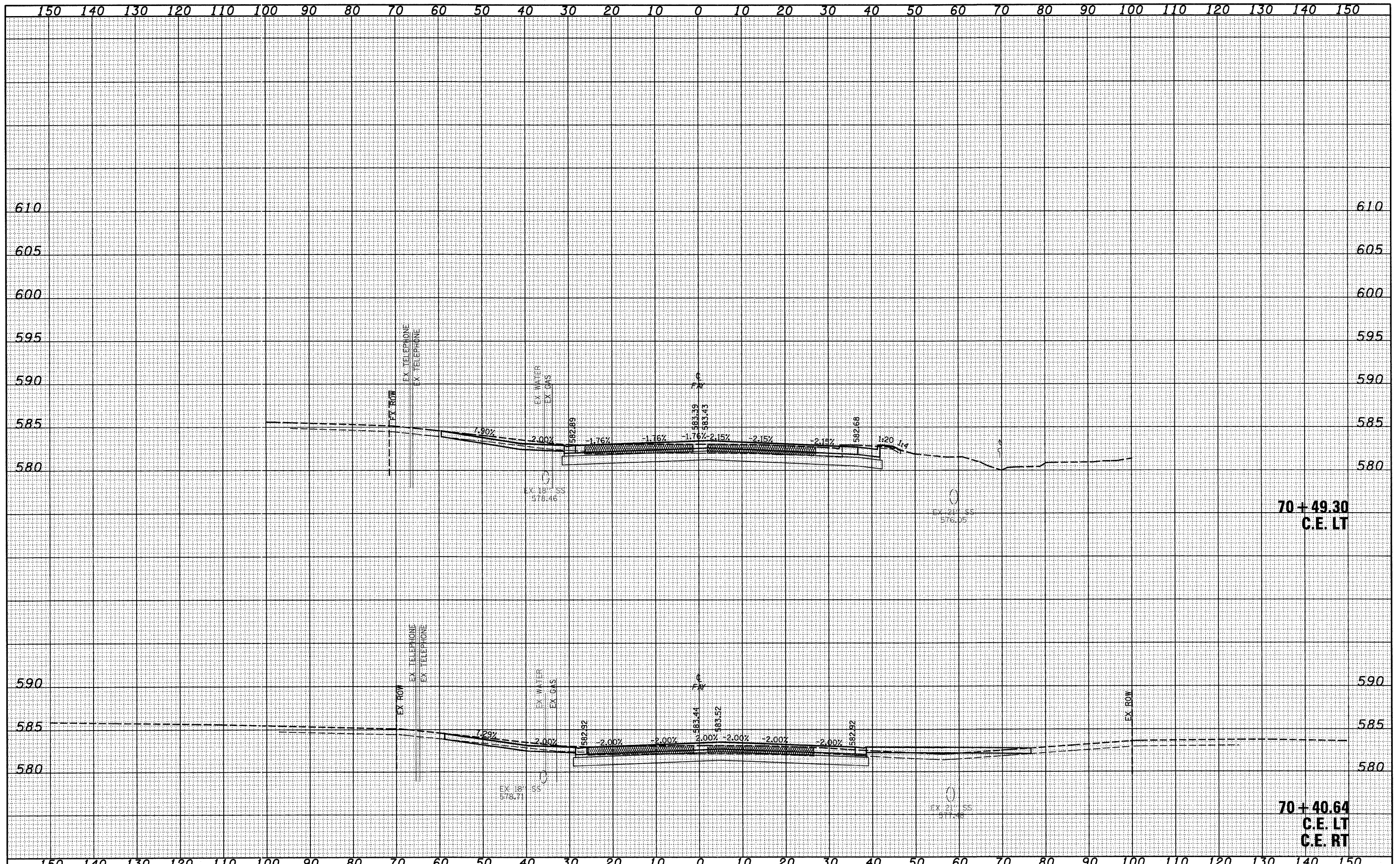

FILE NAME =	USER NAME = paul	DESIGNED - JWS	REVISED -	STATE OF ILLINOIS DEPARTMENT OF TRANSPORTATION	CROSS SECTIONS, FAYETTE AVE.			F.A. RT.	SECTION	COUNTY	TOTAL SHEETS	SHEET NO.
S:\Projects\1102\1102-57-70\1102-57-70.dgn		DRAWN - LEC	REVISED -		57/70	(25-3)-6	EFFINGHAM	839	407			
PLOT SCALE = 20.0000' / IN.		CHECKED - BRM	REVISED -		SCALE: 1"=10'	SHEET NO. 38 OF 43 SHEETS	STA. 70+40.64 TO STA. 70+49.30	CONTRACT NO. 74293				
PLOT DATE = 6/28/2010		DATE - 11-05-07	REVISED -		FED. ROAD DIST. NO.		ILLINOIS FED. AID PROJECT					