

DATE	
BY	
FINAL SURVEY	
PLANNED	
TEMPLATE	
NO. BOOK	
AREAS CHECKED	
NO.	

DATE	
BY	
ORIGINAL SURVEY	
PLANNED	
TEMPLATE	
NO. BOOK	
AREAS CHECKED	
NO.	

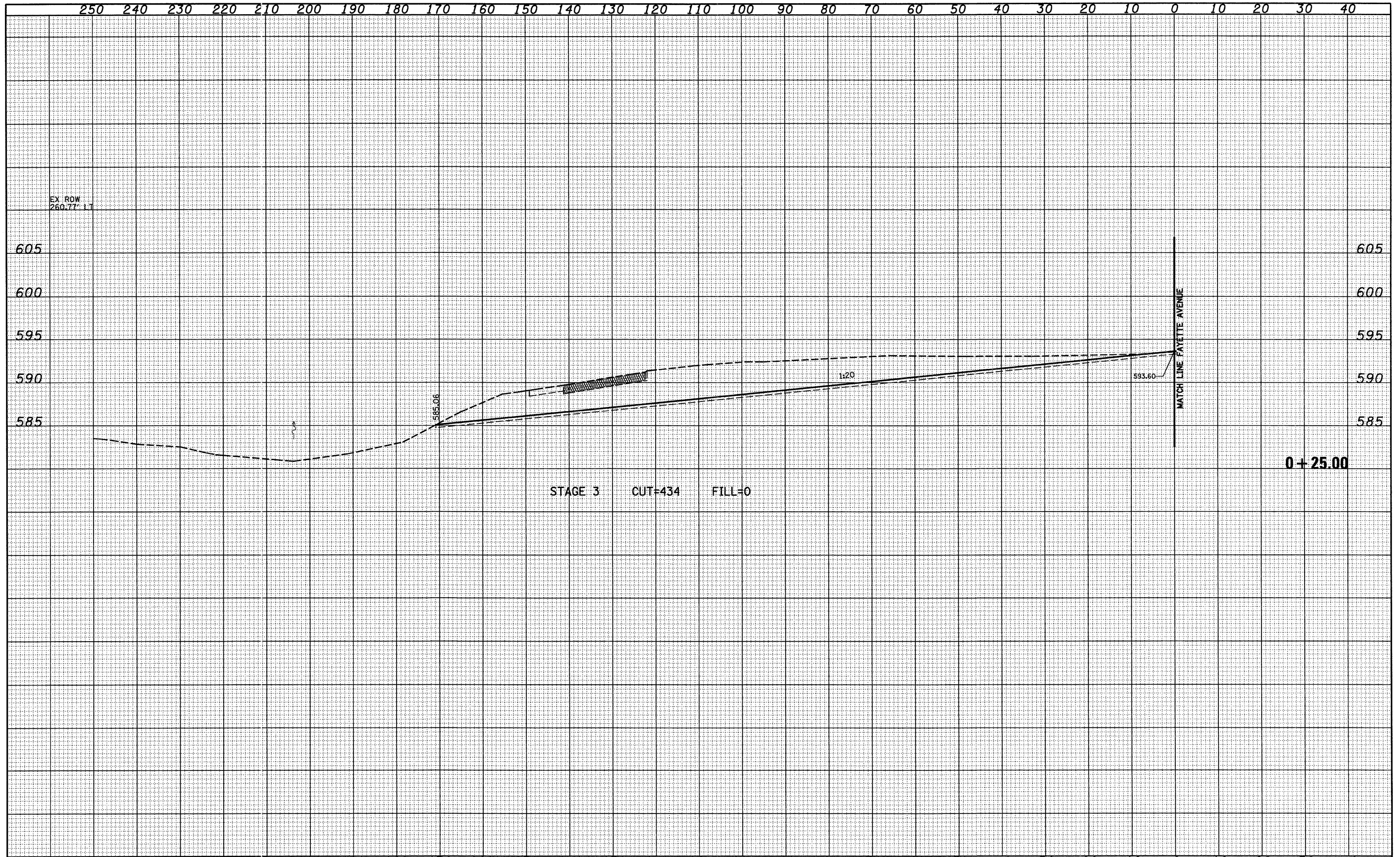

FILE NAME = S:\Projects\40-880\25-70\04\Fayette\04\FR2.dgn
 USER NAME = linda

DESIGNED -	JWS	REVISED -	
DRAWN -	LEC	REVISED -	
CHECKED -	BRM	REVISED -	
DATE -	11-05-07	REVISED -	

PLOT SCALE = 20.0000' / IN.
 PLOT DATE = 6/24/2010

**STATE OF ILLINOIS
 DEPARTMENT OF TRANSPORTATION**

CROSS SECTIONS, OUTFIELD GRADING, FAYETTE AVE. - RAMP B

SCALE: 1"=10' SHEET NO. 1 OF 5 SHEETS STA. 0+25.00 TO STA. 0+25.00

F.A. RTE.	SECTION	COUNTY	TOTAL SHEETS	SHEET NO.
57/70	(25-31)-6	EFFINGHAM	839	488
FED. ROAD DIST. NO.		ILLINOIS FED. AID PROJECT		
		CONTRACT NO. 74293		