

DATE	BY
SURVEYED	
PLOTTED	
NOTE BOOK	
AREAS CHECKED	
NO.	

DATE	BY
SURVEYED	
PLOTTED	
NOTE BOOK	
AREAS CHECKED	
NO.	

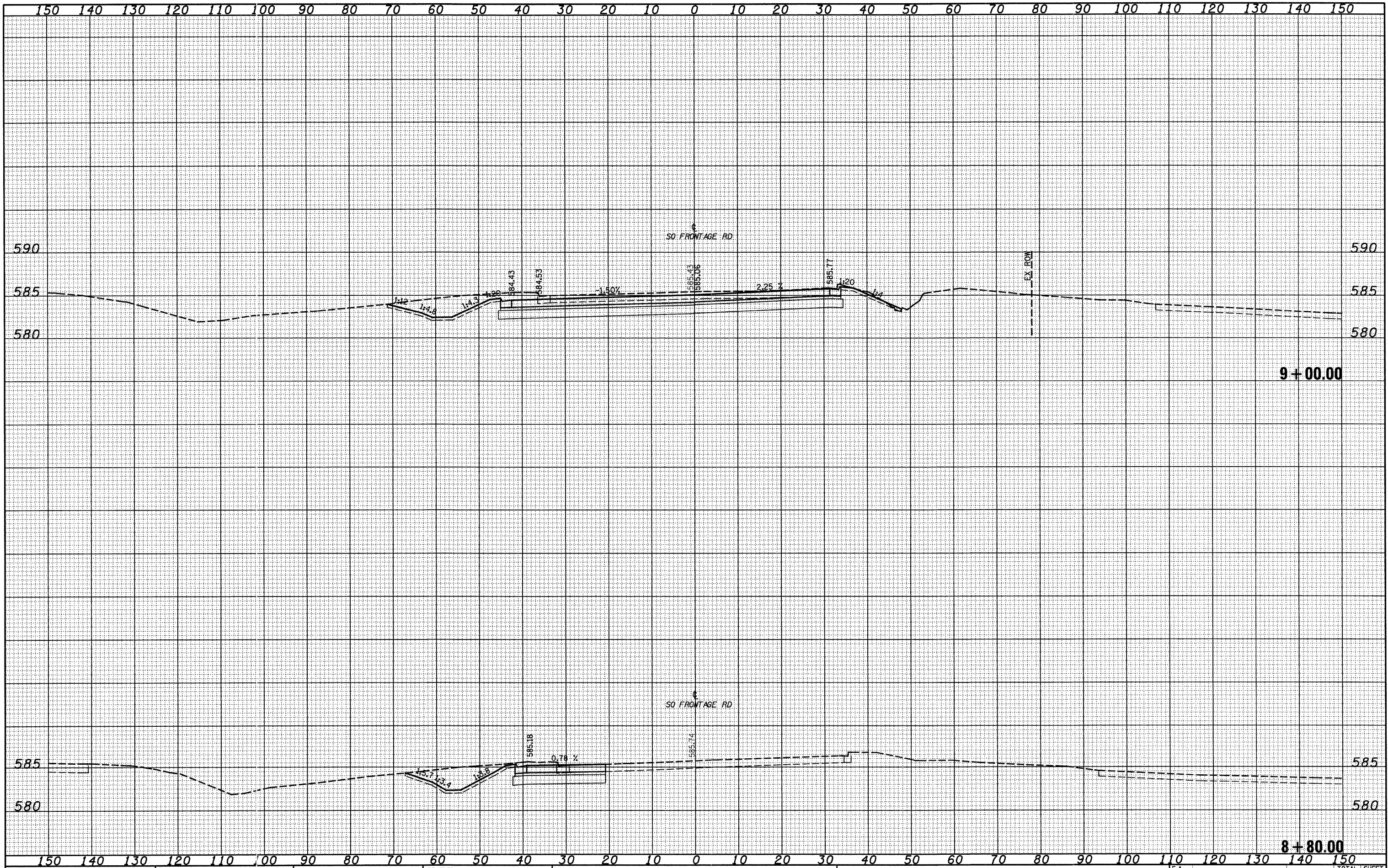

FILE NAME =	USER NAME =	DESIGNED - JWS	REVISED -	<b>STATE OF ILLINOIS</b> <b>DEPARTMENT OF TRANSPORTATION</b>	<b>CROSS SECTIONS, I57/70 - SOUTH FRONTAGE ROAD</b>	F.A. RTE.	SECTION	COUNTY	TOTAL SHEETS	SHEET NO.	
S:\Projects\403-00072-57-70\dgn\Foyette\ssah.llnls.dgn		DRAWN - LEC	REVISED -			57/70	(25-3)1-6	EFFINGHAM	839	532	
PLOT SCALE = 20,000.00' / IN.		CHECKED - BRM	REVISED -			CONTRACT NO. 74293					
PLOT DATE = 5/18/2010		DATE - 11-05-07	REVISED -			FED. ROAD DIST. NO. [ILLINOIS] FED. AID PROJECT					
SCALE: 1"=10'						SHEET NO. 3 OF 4 SHEETS		STA. 8+80.00 TO STA. 9+00.00			