

EXIST. CURVE DOUGRA-1
 P.I. STA. = 6+47.69
 $\Delta = 39^{\circ} 45' 04''$ (RT)
 $R = 763.94'$
 T.M.P.I. - T.R. = 216.18'
 = 48.39'
 S.E. RUN = 530.01'
 P.C. STA. = 3+71.52
 P.T. STA. = 9+01.53

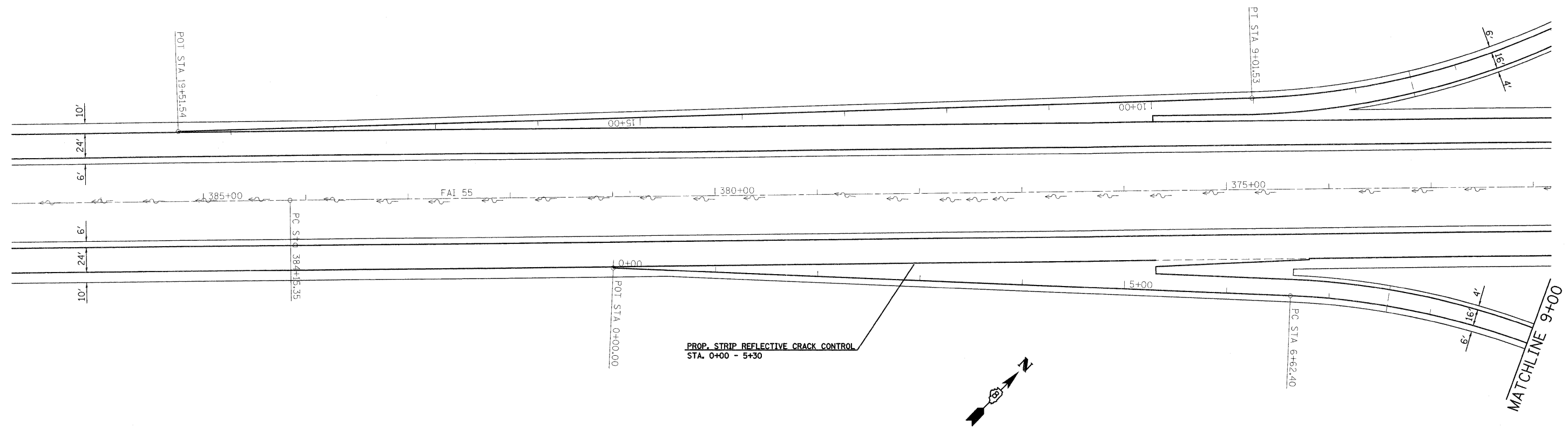

PROP. STRIP REFLECTIVE CRACK CONTROL
 STA. 0+00 - 5+30

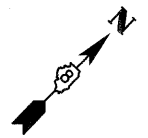

MATCHLINE 9+00

EXIST. CURVE
 P.I. STA. = 6+47.69
 $\Delta = 39^{\circ} 45' 04''$ (RT)
 R = 763.94'

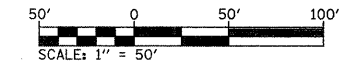

FILE NAME = c:\p\work\p\midot\conoverpj\d0128605\d8	USER NAME = conoverpj 6601-sht-plan.dgn	DESIGNED - DRAWN -	REVISED - REVISED -	STATE OF ILLINOIS DEPARTMENT OF TRANSPORTATION	PLAN SHEETS - RAMP D	F.A.I. RTE. 55	SECTION 60-3RS-1,60-(3HB,3HB-1I)	COUNTY MADISON	TOTAL SHEETS 123	SHEET NO. 45	
PLOT SCALE = 50.0000 ' / IN.	CHECKED -	REVISED -	SCALE: _____			SHEET NO. 26 OF 27 SHEETS	STA. 0+00 TO STA. 9+00	CONTRACT NO. 76601			
PLOT DATE = 6/23/2010	DATE -	REVISED -	FED. ROAD DIST. NO. - ILLINOIS FED. AID PROJECT								