 - RUBBLIZE THE EXISTING P.C.C. PAVEMENT (USING METHOD 1)

EXIST. CURVE C20
 PI STA. = 1043+36.51
 $\Delta = 16^\circ 39' 45''$ (LT)
 $D = 1^\circ 00' 00''$
 $R = 5,729.58'$
 $T = 839.05'$
 $L = 1,666.26'$
 $E = 61.11'$
 $e = 0.02$ ft./ft.

PROPOSED CURVE DATA
 $e = 0.033$ ft./ft.
 $T.R. = 45'$
 $S.E. RUN = 99'$
 ATTAINED: STA. 1033+86.46 TO STA. 1035+30.46
 REMOVED: STA. 1051+30.72 TO STA. 1052+74.72

P.C. STA. = 1034+97.46
 P.T. STA. = 1051+63.72
 ATTAINED: STA. 1034+84 TO STA. 1035+84
 REMOVED: STA. 1051+40 TO STA. 1052+40

REMOVE EXISTING CABLE BARRIER AND 2' OF HMA MOW STRIP.
 PROPOSED HIGH TENSION CABLE BARRIER SYSTEM,
 10' (MIN.) FROM CENTERLINE FAI RTE. 55
 (SEE TYPICAL SECTION)

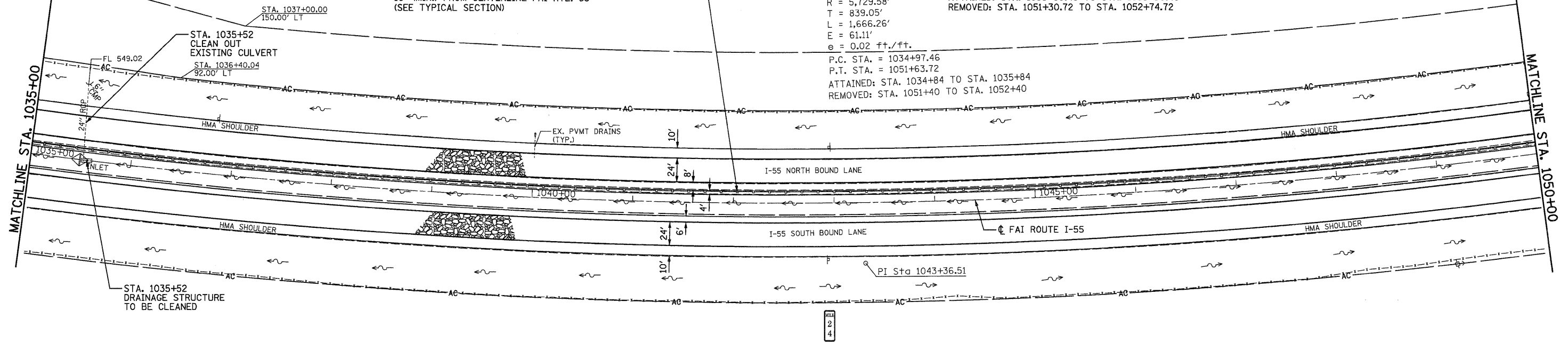

BM #6 - CUT SQUARE ON HDWL
 75' LT., STA. 1035+49 ELEV. 551.841'

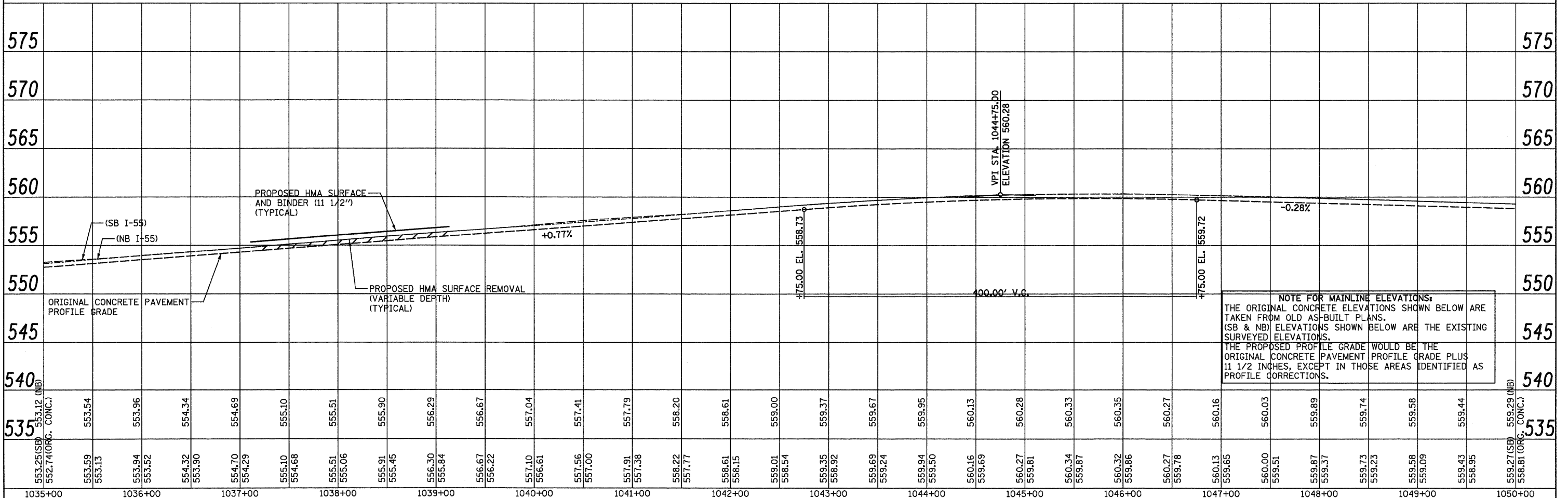
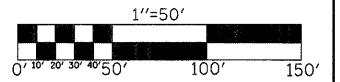

NOTE FOR MAINLINE ELEVATIONS:
 THE ORIGINAL CONCRETE ELEVATIONS SHOWN BELOW ARE
 TAKEN FROM OLD AS-BUILT PLANS.
 (SB & NB) ELEVATIONS SHOWN BELOW ARE THE EXISTING
 SURVEYED ELEVATIONS.
 THE PROPOSED PROFILE GRADE WOULD BE THE
 ORIGINAL CONCRETE PAVEMENT PROFILE GRADE PLUS
 1 1/2 INCHES, EXCEPT IN THOSE AREAS IDENTIFIED AS
 PROFILE CORRECTIONS.

535	535.25(SB) 552.74(ORG. CONC.)	535.54	535.96	554.34	554.69	555.10	555.51	555.90	556.29	556.67	557.04	557.41	557.79	558.20	558.61	559.00	559.37	559.67	559.95	560.13	560.28	560.33	560.35	560.27	560.16	560.03	559.89	559.74	559.58	559.44	559.27(SB) 558.81(ORG. CONC.)	535	
1035+00	1036+00	1037+00	1038+00	1039+00	1040+00	1041+00	1042+00	1043+00	1044+00	1045+00	1046+00	1047+00	1048+00	1049+00	1050+00																		

FILE NAME = ...
 USER NAME = SJS
 DESIGNED -
 DRAWN -
 CHECKED -
 DATE -

DESIGNED -
 DRAWN -
 CHECKED -
 DATE -

DESIGNED -
 DRAWN -
 CHECKED -
 DATE -

STATE OF ILLINOIS
 DEPARTMENT OF TRANSPORTATION
 FAI ROUTE 55 (I-55)
 SCALE: 1"=50'
 SHEET NO. OF SHEETS STA. 1035+00 TO STA. 1050+00

F.A.I. SECTION COUNTY TOTAL SHEETS SHEET NO.
 55 60-(1,2)RS-2 MADISON 156 62
 CONTRACT NO. 76C93
 ILLINOIS FED. AID PROJECT

DATE	
BY	
PLAN	
NO.	
DATE	
BY	
PROFILE	
NO.	

DATE	
BY	
PROFILE	
NO.	

