

DATE	
BY	
SURVEYED	
ALIGNED	
CHECKED	
RT. OF WAY CHECKED	
NO. FILE NAME	
PLAN	
NOTE BOOK	
NO.	

DATE	
BY	
SURVEYED	
GRADES CHECKED	
NO. NOTED	
STRUCTURE NOTATIONS	
PROFILE	
NOTE BOOK	
NO.	

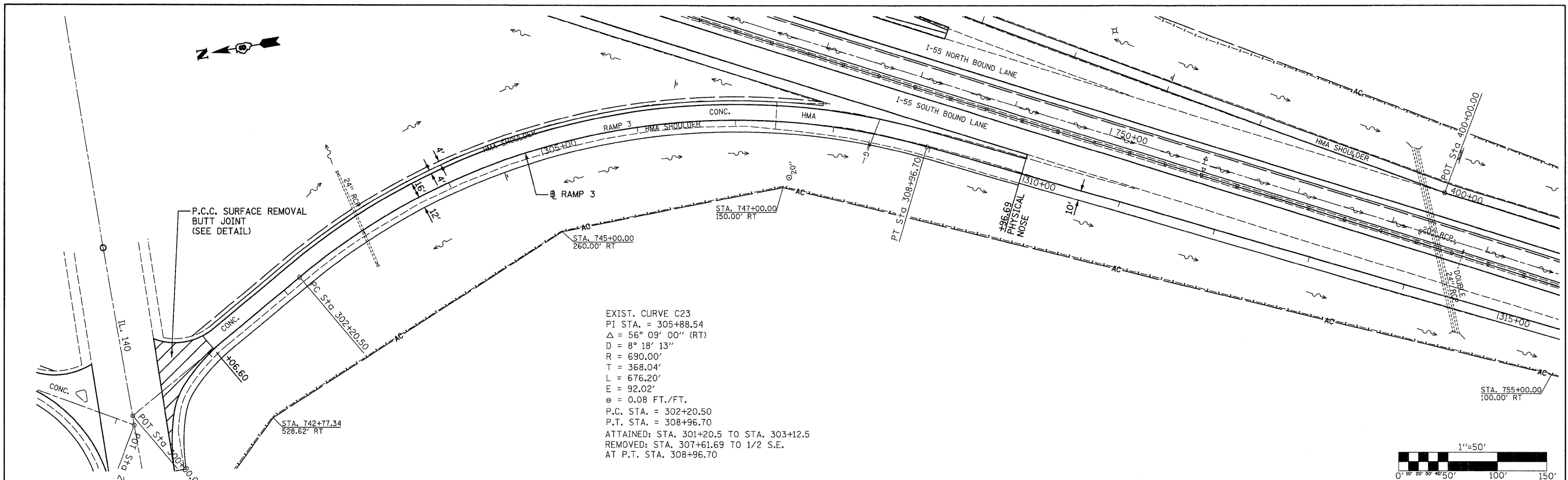

EXIST. CURVE C23
 PI STA. = 305+88.54
 $\Delta = 56^\circ 09' 00''$ (RT)
 $D = 8^\circ 18' 13''$
 $R = 690.00'$
 $T = 368.04'$
 $L = 676.20'$
 $E = 92.02'$
 $e = 0.08$ FT./FT.
 P.C. STA. = 302+20.50
 P.T. STA. = 308+96.70
 ATTAINED: STA. 301+20.5 TO STA. 303+12.5
 REMOVED: STA. 307+61.69 TO 1/2 S.E.
 AT P.T. STA. 308+96.70

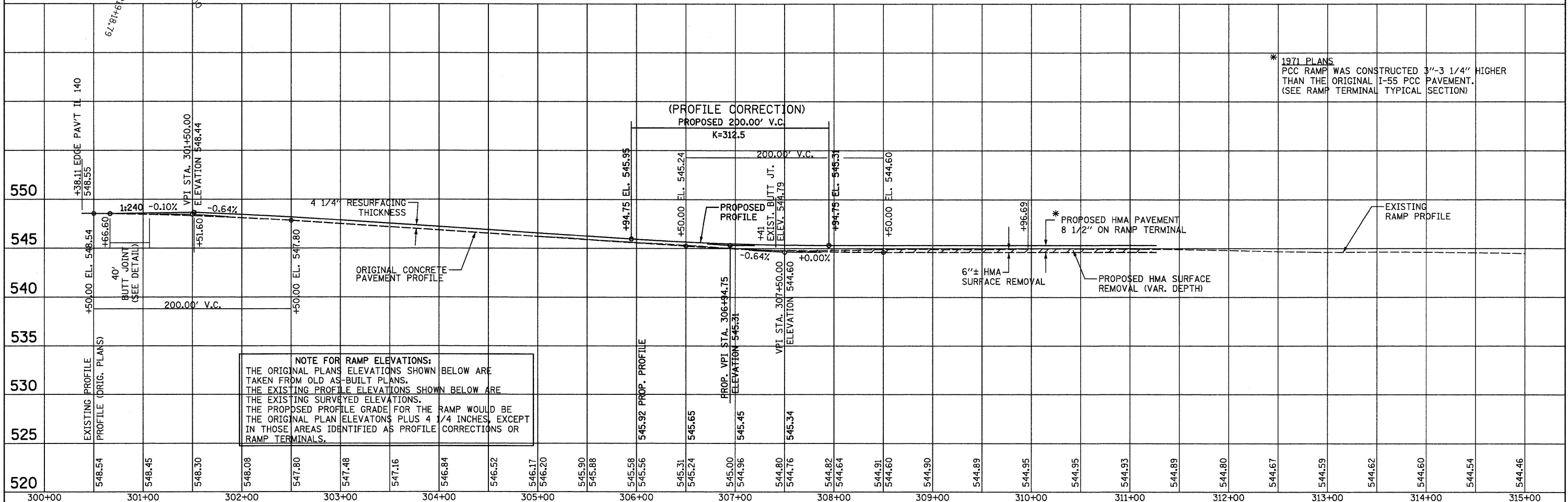

NOTE FOR RAMP ELEVATIONS:
 THE ORIGINAL PLANS ELEVATIONS SHOWN BELOW ARE TAKEN FROM OLD AS-BUILT PLANS.
 THE EXISTING PROFILE ELEVATIONS SHOWN BELOW ARE THE EXISTING SURVEYED ELEVATIONS.
 THE PROPOSED PROFILE GRADE FOR THE RAMP WOULD BE THE ORIGINAL PLAN ELEVATIONS PLUS 4 1/4 INCHES, EXCEPT IN THOSE AREAS IDENTIFIED AS PROFILE CORRECTIONS OR RAMP TERMINALS.

* 1971 PLANS PCC RAMP WAS CONSTRUCTED 3"-3 1/4" HIGHER THAN THE ORIGINAL I-55 PCC PAVEMENT. (SEE RAMP TERMINAL TYPICAL SECTION)

FILE NAME =	USER NAME = SJS	DESIGNED -	REVISED -	STATE OF ILLINOIS DEPARTMENT OF TRANSPORTATION	SB ENTRANCE RAMP 3 (IL 140)				F.A.I. RTE.	SECTION	COUNTY	TOTAL SHEETS	SHEET NO.
...oad\0876C93-ah-p1nrf2.dgn		DRAWN -	REVISED -		55	60-(1,2)RS-2	MADISON	156	80				
Johnson, Depp & Quisenberry CONSULTING ENGINEERS Springfield, Illinois	PLOT SCALE = 58.0000' / IN.	CHECKED -	REVISED -		CONTRACT NO. 76C93								
	PLOT DATE = 06/23/2010 15:33:48	DATE	REVISED		SCALE:	SHEET NO.	OF SHEETS	STA.	TO STA.	ILLINOIS FED. AID PROJECT			