

PLAN	SURVEYED	DATE
	ALIGNED	BY
	CHECKED	
	RT. OF WAY	
	CHECKED	
	NO.	
	NO.	

PROFILE	SURVEYED	DATE
	GRADES	BY
	CHECKED	
	B.M. NOTED	
	STRUCTURE	
	NOTATIONS	
	CHFD	

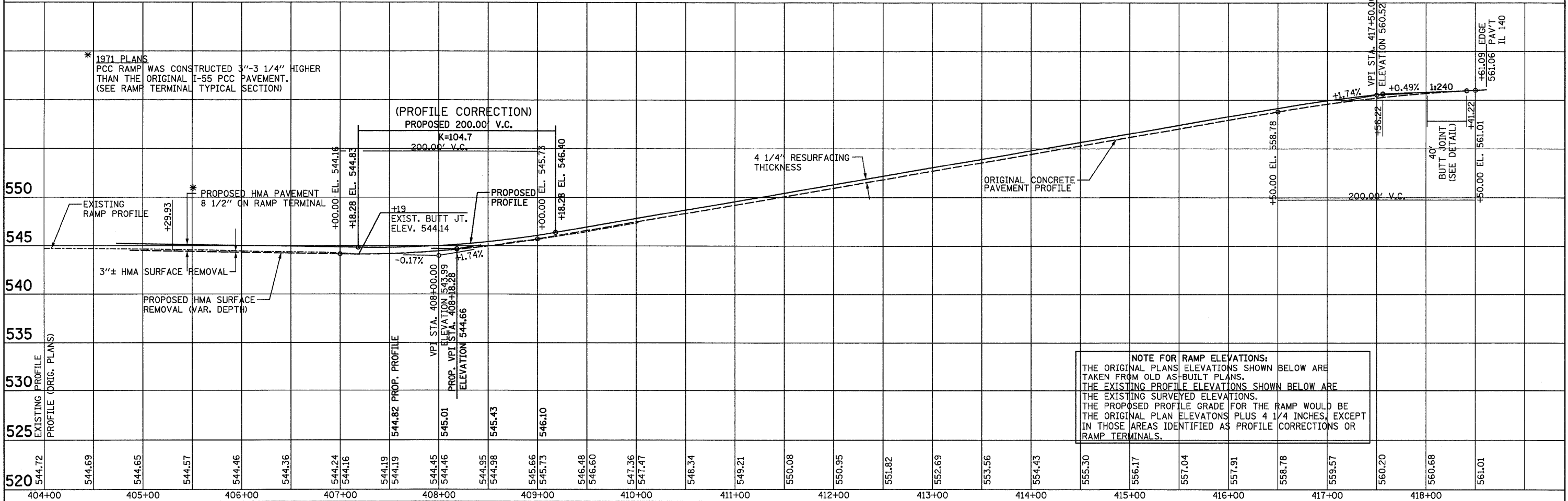
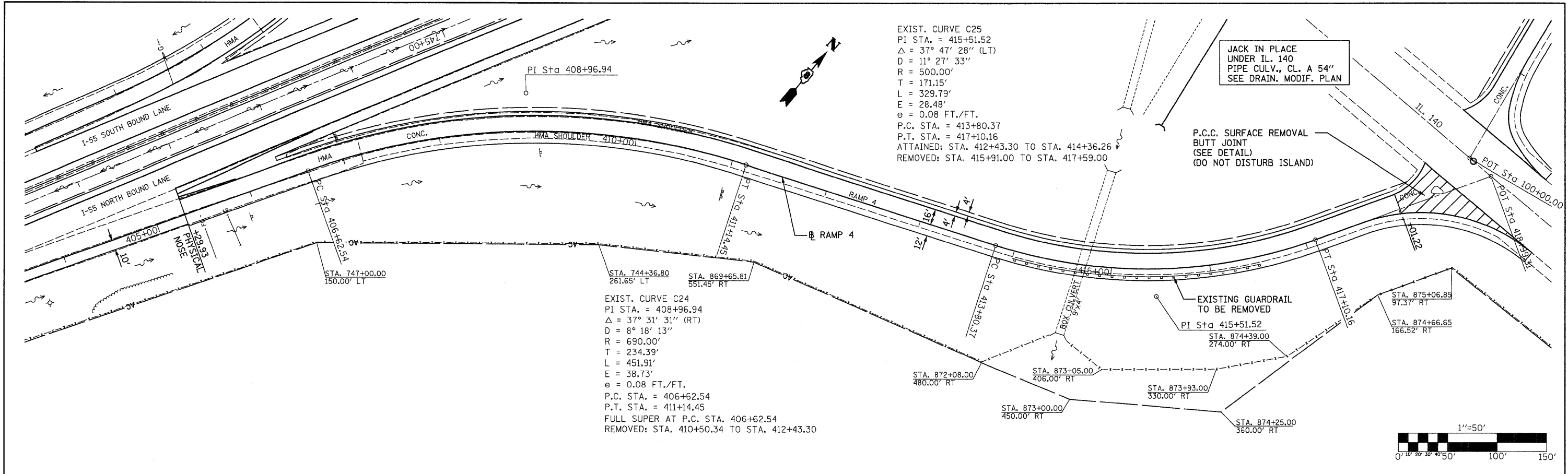

**NOTE FOR RAMP ELEVATIONS:**  
 THE ORIGINAL PLANS ELEVATIONS SHOWN BELOW ARE TAKEN FROM OLD AS-BUILT PLANS.  
 THE EXISTING PROFILE ELEVATIONS SHOWN BELOW ARE THE EXISTING SURVEYED ELEVATIONS.  
 THE PROPOSED PROFILE GRADE FOR THE RAMP WOULD BE THE ORIGINAL PLAN ELEVATIONS PLUS 4 1/4 INCHES, EXCEPT IN THOSE AREAS IDENTIFIED AS PROFILE CORRECTIONS OR RAMP TERMINALS.

FILE NAME =	USER NAME = SJS	DESIGNED -	REVISED -	<b>STATE OF ILLINOIS DEPARTMENT OF TRANSPORTATION</b>	<b>NB EXIT RAMP 4 (IL 140)</b>			F.A.I. RTE.	SECTION	COUNTY	TOTAL SHEETS	SHEET NO.
...\\cadd\0876C93-shr-plnprf2.dgn		DRAWN -	REVISED -					55	60-1,2RS-2	MADISON	156	81
		CHECKED -	REVISED -					CONTRACT NO. 76C93				
		DATE -	REVISED -					ILLINOIS FED. AID PROJECT				
								SCALE:	SHEET NO.	OF	SHEETS	STA.