

DATE	
BY	
REVISIONS	
PLANNED	
NOTED	
CHECKED	
DESIGNED	
NO.	

DATE	
BY	
REVISIONS	
PLANNED	
NOTED	
CHECKED	
DESIGNED	
NO.	

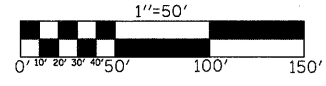
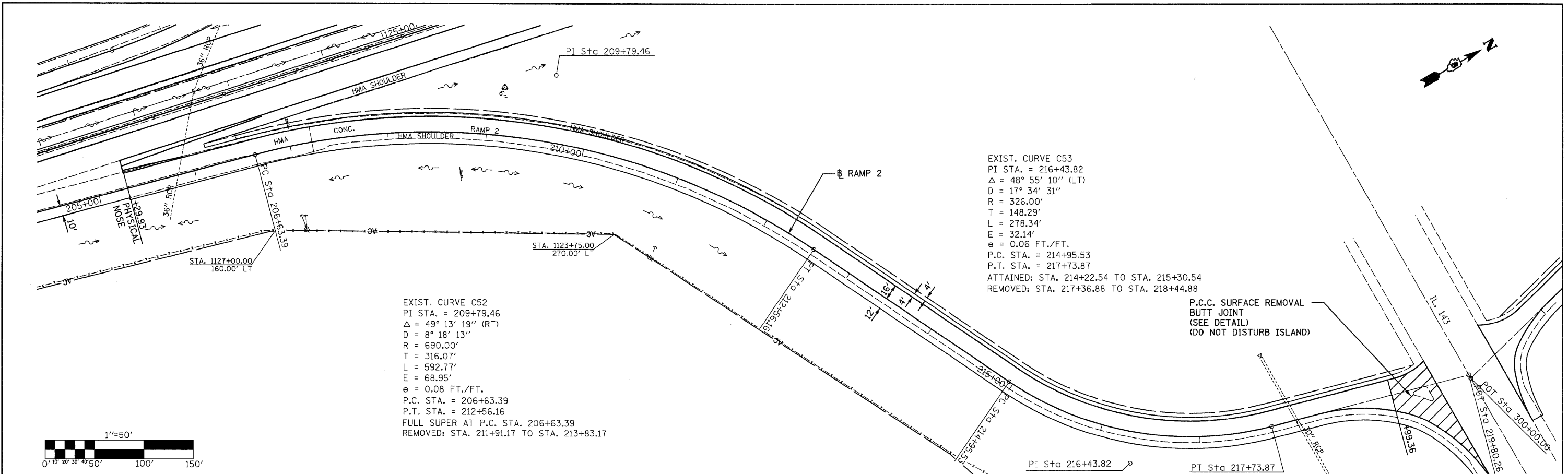

EXIST. CURVE C52
 PI STA. = 209+79.46
 $\Delta = 49^\circ 13' 19''$ (RT)
 $D = 8^\circ 18' 13''$
 $R = 690.00'$
 $T = 316.07'$
 $L = 592.77'$
 $E = 68.95'$
 $e = 0.08$ FT./FT.
 P.C. STA. = 206+63.39
 P.T. STA. = 212+56.16
 FULL SUPER AT P.C. STA. 206+63.39
 REMOVED: STA. 211+91.17 TO STA. 213+83.17

EXIST. CURVE C53
 PI STA. = 216+43.82
 $\Delta = 48^\circ 55' 10''$ (LT)
 $D = 17^\circ 34' 31''$
 $R = 326.00'$
 $T = 148.29'$
 $L = 278.34'$
 $E = 32.14'$
 $e = 0.06$ FT./FT.
 P.C. STA. = 214+95.53
 P.T. STA. = 217+73.87
 ATTAINED: STA. 214+22.54 TO STA. 215+30.54
 REMOVED: STA. 217+36.88 TO STA. 218+44.88

P.C.C. SURFACE REMOVAL
 BUTT JOINT
 (SEE DETAIL)
 (DO NOT DISTURB ISLAND)

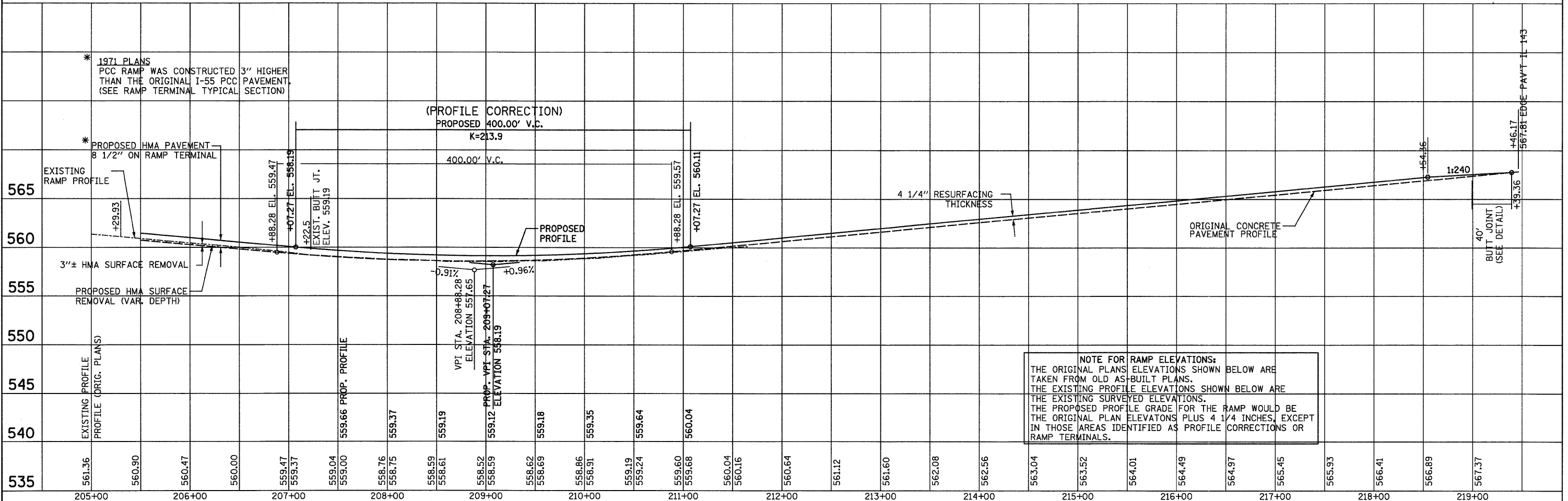

NOTE FOR RAMP ELEVATIONS:
 THE ORIGINAL PLANS ELEVATIONS SHOWN BELOW ARE TAKEN FROM OLD AS-BUILT PLANS. THE EXISTING PROFILE ELEVATIONS SHOWN BELOW ARE THE EXISTING SURVEYED ELEVATIONS. THE PROPOSED PROFILE GRADE FOR THE RAMP WOULD BE THE ORIGINAL PLAN ELEVATIONS PLUS 4 1/4 INCHES, EXCEPT IN THOSE AREAS IDENTIFIED AS PROFILE CORRECTIONS OR RAMP TERMINALS.

FILE NAME = ...ceadd\0876C93-shr-p1nprf2.dgn	USER NAME = SJS	DESIGNED -	REVISED -	STATE OF ILLINOIS DEPARTMENT OF TRANSPORTATION	NB EXIT RAMP 2 (IL 143)			F.A.T. RTE. = 55	SECTION = 60-(1,2)RS-2	COUNTY = MADISON	TOTAL SHEETS = 156	SHEET NO. = 87
PLOT SCALE = 5/8" = 1' IN.	PLOT DATE = 08/23/2010 15:33:53	DRAWN -	REVISED -		SCALE:	SHEET NO.	OF SHEETS	STA.	TO STA.	ILLINOIS FED. AID PROJECT		
		CHECKED -	REVISED -							CONTRACT NO. 76C93		
		DATE -	REVISED -									