



STAGE III - PHASE 2 CONSTRUCTION

- 1) REMOVE SIDE ROAD DETOUR - WESTBOUND E MAIN ST
- 2) CONSTRUCT THE REMAINING ROADWAY SECTIONS AT THE INTERSECTIONS ON THE WEST LEGS OF E CLAY ST, E MAIN ST, E JOHNSON ST, AND ALLEY 156+02 SOUTH OF E MAIN ST
- 3) AT LEAST ONE LANE SHALL REMAIN OPEN AT ALL TIMES ON E CLAY ST, E MAIN ST AND ALLEY 156+02
- 4) THE CONTRACTOR SHALL MAINTAIN TWO WAY TRAFFIC ON E JOHNSON ST OVERNIGHT. MAY REDUCE TO ONE LANE DURING CONSTRUCTION OPERATIONS
- 5) STOP SIGNS AND STREET SIGNS INCLUDING NO LEFT/RIGHT TURN SIGNS AT SIDE ROADS SHALL BE ADJUSTED AND MAINTAINED BY THE CONTRACTOR
- 6) PROPER DRAINAGE SHALL BE MAINTAINED BY THE CONTRACTOR

LEGEND

DIRECTION OF TRAFFIC	
CONSTRUCTION	
TEMPORARY HMA PAVEMENT	
TRAFFIC DRUM WITH STEADY BURNING LIGHT	

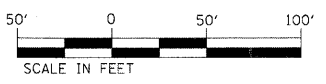
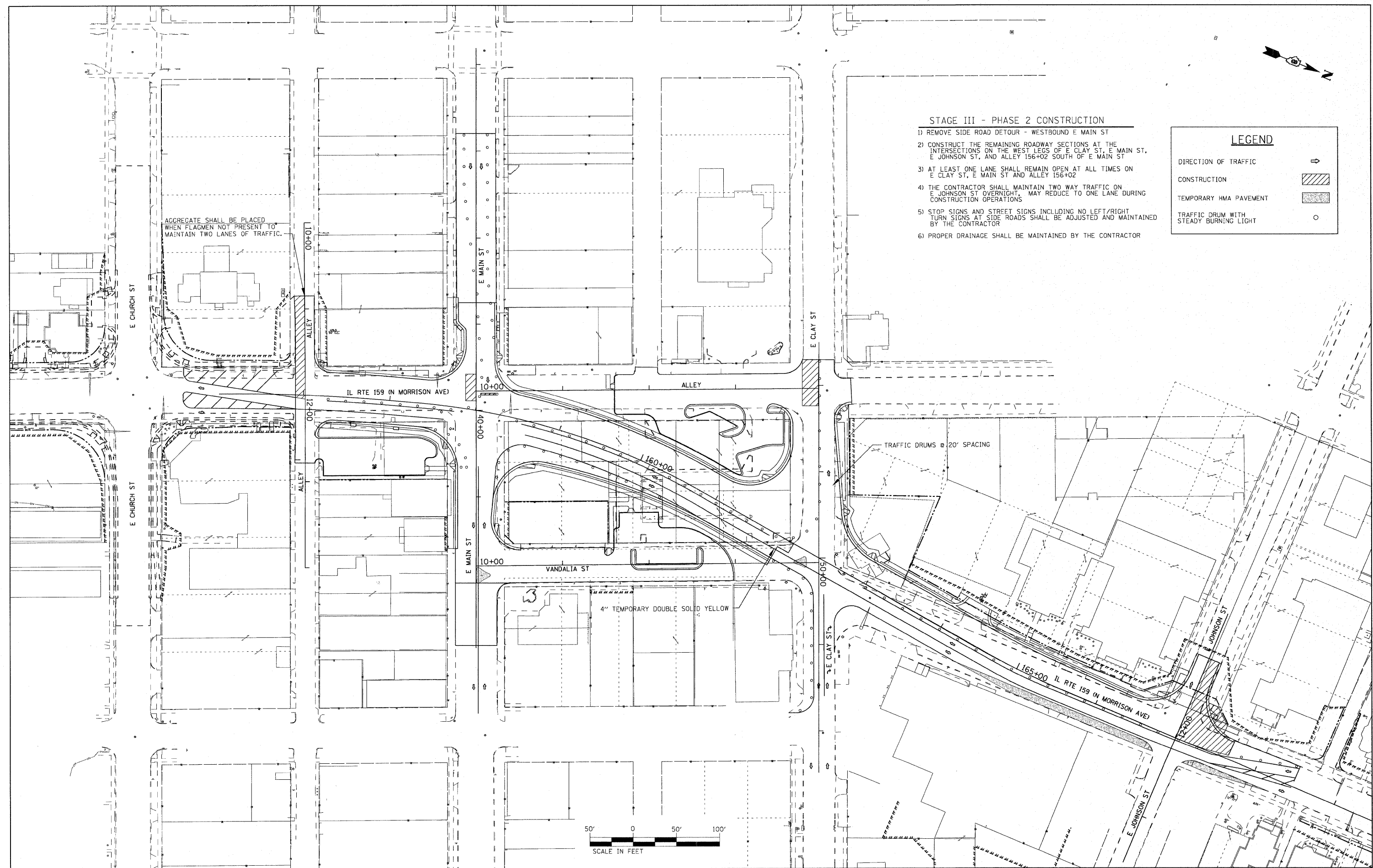

FILE NAME =	USER NAME = default	DESIGNED -	REVISED -
P:\Projects\613581\CAD\VDGN\0876054-sht	staging.dgn	DRAWN -	REVISED -
	PLOT SCALE = 50.0000' / IN.	CHECKED -	REVISED -
	PLOT DATE = 6/16/2010	DATE -	REVISED -

**STATE OF ILLINOIS
DEPARTMENT OF TRANSPORTATION**

**SUGGESTED STAGES OF CONSTRUCTION AND TRAFFIC CONTROL
STAGE 3 - PHASE 2**

SCALE: 1" = 50' SHEET NO. 7 OF 9 SHEETS STA. N/A TO STA. N/A

F.A.P. RTE.	SECTION	COUNTY	TOTAL SHEETS	SHEET NO.
600	60-(30,31,128)-N-1	MADISON	152	82
				CONTRACT NO. 76054
ILLINOIS FED. AID PROJECT				