

INDEX OF SHEETS

- SHEET 1. COVER SHEET
- SHEET 2. TYPICAL CROSS SECTION, SUMMARY OF QUANTITIES, BUTT JOINT DETAIL, BITUMINOUS MIXTURE TABLE
- SHEET 3. TYPICAL ENTRANCE DETAIL, MAILBOX DETAILS, SIDE ROAD RETURN, GENERAL NOTES

STANDARDS

- 701301-03 LANE CLOSURE 2 LANE, 2 WAY, SHORT TIME OPERATIONS
- 701306-02 LANE CLOSURE 2 LANE, 2 WAY, SLOW MOVING OPERATIONS - DAY ONLY FOR SPEEDS \geq 45 MPH
- 701311-03 LANE CLOSURE 2 LANE, 2 WAY, MOVING OPERATIONS - DAY ONLY
- 701901-01 TRAFFIC CONTROL DEVICES
- 780001-02 TYPICAL PAVEMENT MARKINGS

STATE OF ILLINOIS
DEPARTMENT OF TRANSPORTATION

**PLANS FOR
PROPOSED LOCAL AGENCY IMPROVEMENT
FEDERAL-AID SECONDARY PROJECT**

C.H. 26

F.A.S. ROUTE 340 SECTION 10-00112-00-RS FORD COUNTY
PROJECT RS- 0340(104)
JOB NO. C-93-085-10

FAS NO.	SECTION	COUNTY	TOTAL SHEETS	SHEET NO.
340	10-00112-00-RS		3	1
PROJECT RS - 0340(104) CONTRACT # 87454				

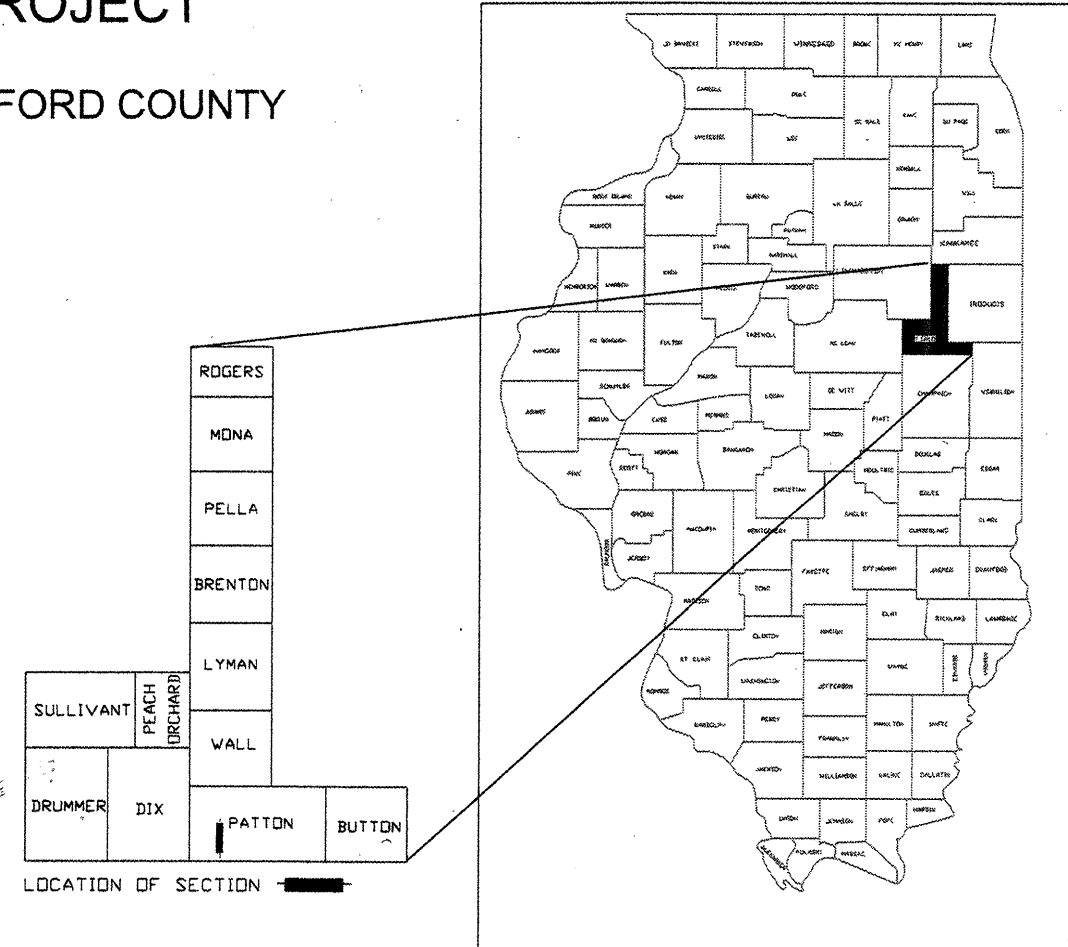
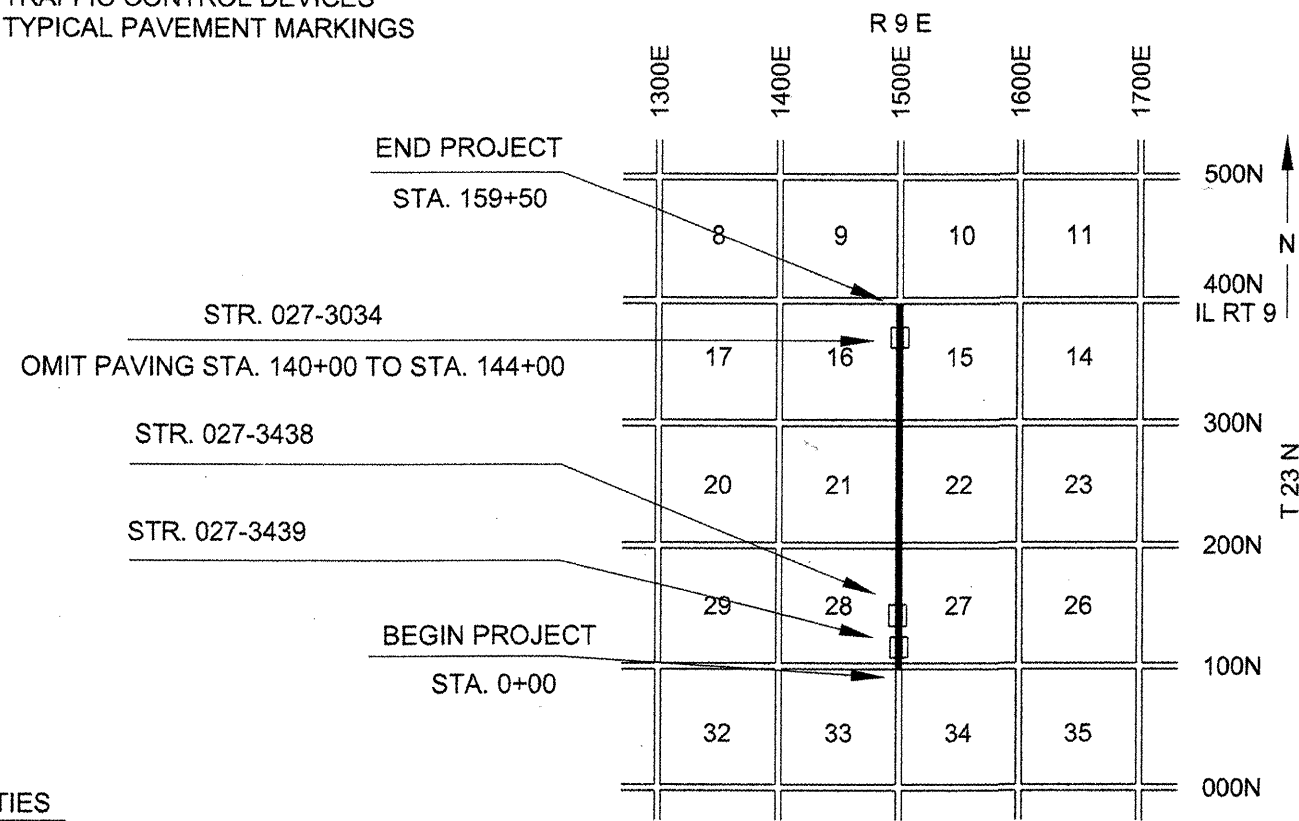

UTILITIES

UTILITIES ON THIS SECTION AT VARIOUS LOCATIONS INCLUDES TO THE BEST OF OUR KNOWLEDGE:

VERIZON TELEPHONE COMPANY (UNDERGROUND)
OVERHEAD POWER - EASTERN ILLINI

CONTRACTORS OR SUBCONTRACTORS SHALL CONTACT J.U.L.I.E. (1-800-892-0123) AT LEAST 72 HOURS PRIOR TO ANY EXCAVATION OR DRIVING FOR UTILITIES LOCATION

JOB NO. C-93-085-10
CONTRACT NO. 87454

GROSS LENGTH = 15,950' = 3.02 MI.
NET LENGTH = 15,550' = 2.95 MI.

THE PLANS FOR THIS SECTION WERE APPROVED BY THE DEPARTMENT AS SECTION 41-Q, SECTION 82-00041-00-RS, SECTION 10-00112-00-RS
FUNCTIONAL CLASSIFICATION: MAJOR COLLECTOR

Gregory L. Perkinson
ILLINOIS PROFESSIONAL NO. 062-035801

EXPIRES 11-30-2011

CURRENT (2010) ADT = 225 - 88% PC
9% SU
3% MU
DESIGN ADT (2020) = 300
DESIGN SPEED = 50 MPH

THE ACCEPTANCE OF THIS PROJECT IS BASED ON THE MINIMUM DESIGN CRITERIA UNDER 3R GUIDELINES.



APPROVED	<u>4/09/2010</u> <i>Gregory L. Perkinson</i> FORD COUNTY, COUNTY ENGINEER
PASSED	<u>4-9-10</u> <i>Gregory L. Perkinson</i> DISTRICT 3 IMPLEMENTATION ENGINEER
Releasing for Bid Based on Limited Review	<u>4-9-10</u> <i>Boye Hyman</i> DEPUTY DIRECTOR OF HIGHWAYS, REGION 2 ENGINEER STATE OF ILLINOIS DEPARTMENT OF TRANSPORTATION

FAS NO.	SECTION	COUNTY	TOTAL SHEETS	SHEET NO.
340	10-00112-00-RS		3	2
PROJECT RS-0340(104)				
CONTRACT # 87454				

TYPICAL CROSS SECTION
SECTION 10-00112-00-RS (STEVE'S ROAD)
STATION 0+00 TO 159+50
** OMIT STA. 140+00 TO STA. 144+00 **

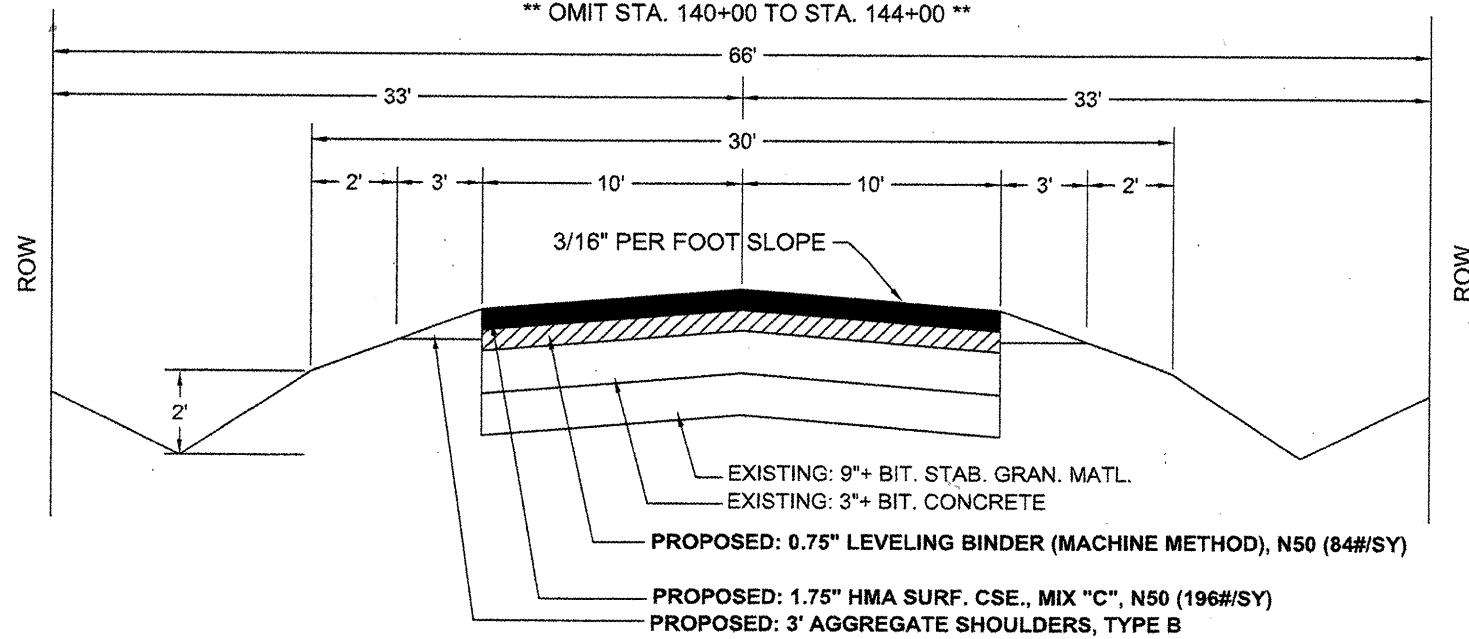

SUMMARY OF QUANTITIES

CONSTRUCTION TYPE CODE 1000

CODE NO.	ITEM	UNIT	QUANTITY
* 40600100	BITUMINOUS MATERIALS (PRIME COAT)	GALLON	2655
* 40600300	AGGREGATE (PRIME COAT)	TON	35
* 40600625	LEVELING BINDER (MACHINE METHOD), N50	TON	1510
* 40600982	HOT-MIX ASPHALT SURFACE REMOVAL - BUTT JOINT	SQ YD	330
* 40600990	TEMPORARY RAMP	SQ YD	85
* 40603310	HOT- MIX ASPHALT SURFACE COURSE, MIX "C", N50	TON	3440
* 40800050	INCIDENTAL HOT-MIX ASPHALT SURFACING	TON	20
* 48101200	AGGREGATE SHOULDERS, TYPE B	TON	1185
67100100	MOBILIZATION	L SUM	1
* 70100460	TRAFFIC CONTROL AND PROTECTION, STANDARD 701306	L SUM	1
* 70300100	SHORT- TERM PAVEMENT MARKING	FOOT	3190
Δ * 78001110	PAINT PAVEMENT MARKING - LINE 4"	FOOT	3990

* INDICATES SEE SPECIAL PROVISIONS

Δ **SPECIALTY ITEMS**

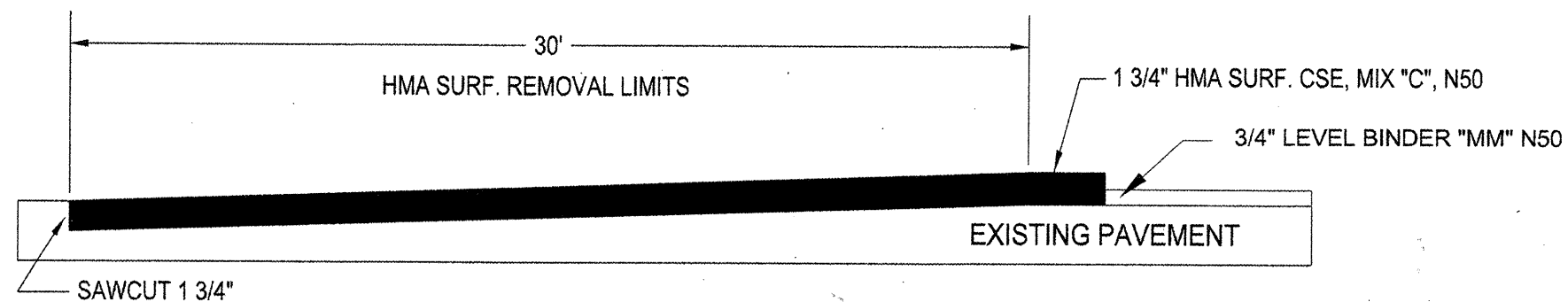

BUTT JOINT DETAIL

4 LOCATIONS
STA. 0+00 TO STA. 0+30
STA. 139+70 TO STA. 140+00
STA. 144+00 TO STA. 144+30
STA. 159+20 TO STA. 159+50

BITUMINOUS MIXTURE TABLE

	LEVEL BINDER	HMA SURFACE
PG GRADE **	PG 64-22	PG 64-22
DESIGN AIR VOIDS	4.0 % @ N50	4.0 % @ N50
MIX COMPOSITION	IL-9.5	IL 9.5 or IL 12.5
FRICTION AGGREGATE		MIXTURE "C"
DENSITY CONTROL METHOD	SATISFACTION OF ENG.	CORRELATION

** WHEN MORE THAN 20% RAP IS USED, A SOFTER ASPHALT BINDER (PG58-22) MAY BE REQUIRED AS DETERMINED BY THE ENGINEER.

FAS NO.	SECTION	COUNTY	TOTAL SHEETS	SHEET NO.
340	10-00112-00-RS		3	3
PROJECT RS-0340(104)				
CONTRACT # 87454				

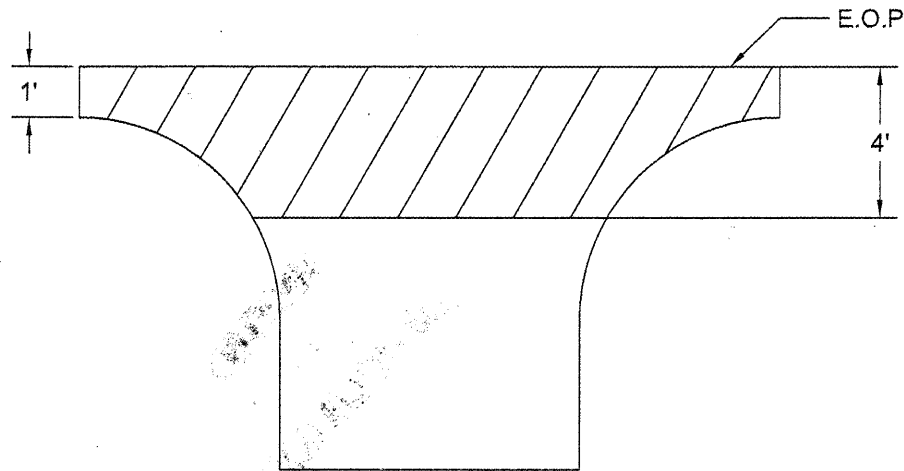

TYPICAL FIELD & PRIVATE ENTRANCE

32 EACH

LT. STA.	LT. STA.	RT. STA.	RT. STA.
6+95	65+75	6+55	67+65
9+65	72+70	9+30	93+25
13+30	77+00	13+30	106+55
20+40	80+30	29+10	138+10
21+30	96+85	31+80	143+72
26+80	98+95	63+00	156+05
29+50	114+95		
32+15	131+85		
50+90	140+35		
63+30	151+40		

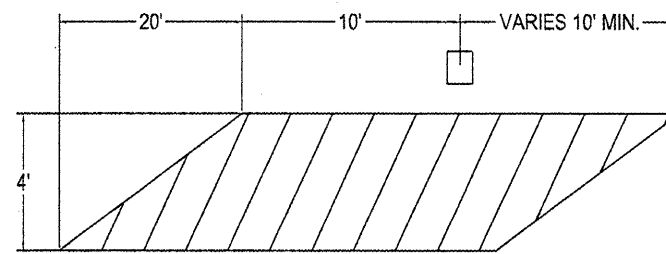

TYPICAL MAILBOX FOLLOWING

1 EACH
STA. 98+80 LT

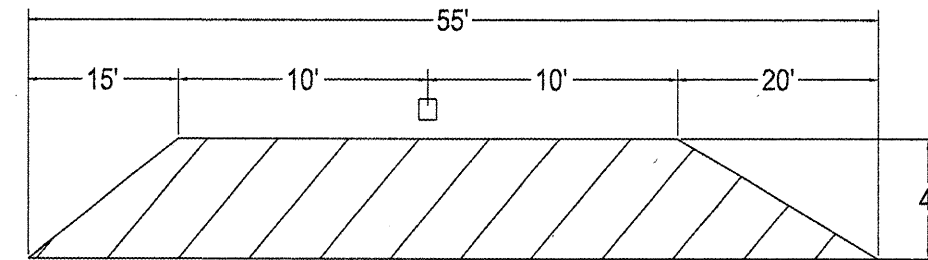

TYPICAL MAILBOX TURN OUT

1 EACH
STA. 77+55 LT

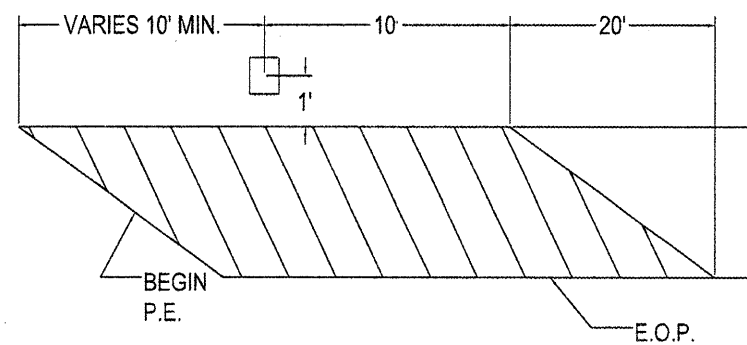

TYPICAL MAILBOX LEAD IN

0 EACH



AREA TO BE PAID AS
INCIDENTAL BITUMINOUS SURFACING

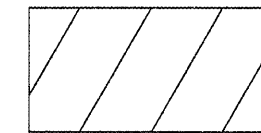

AREA TO BE CONSTRUCTED
DURING MAINLINE PAVING OPERATIONS
SLOPE = 3/4" PER FOOT

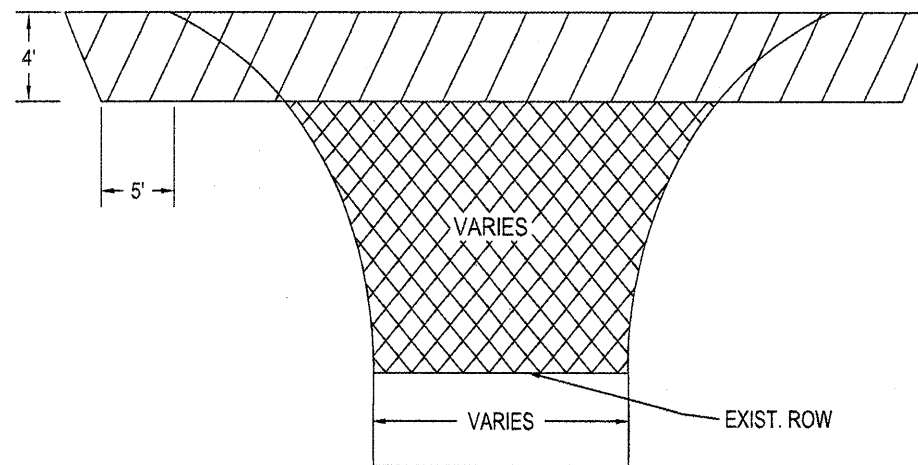

TYPICAL SIDE ROAD RETURN

2 EACH
STA. 53+35 RT & LT

NOTES

1. USE SAME MAINLINE MATERIAL FOR SIDE ROAD RETURNS, FIELD & PRIVATE ENTRANCES, AND MAILBOXES.
2. AGGREGATE SHOULDERS TO BE PLACED BEHIND SIDE ROAD RETURNS, FIELD & PRIVATE ENTRANCES, AND MAILBOXES AS DIRECTED BY THE ENGINEER.
3. SHORT TERM PAVEMENT MARKINGS TO BE REMOVED BY FORD COUNTY PERSONNEL.
4. THE FOLLOWING APPLICATION RATES HAVE BEEN ASSUMED IN CALCULATING QUANTITIES:

GRANULAR MATERIALS	2.00 TON / CU YD
BIT MATL (PR CT)	0.075 GAL / SQ YD
AGGREGATE (PR CT)	0.001 TON / SQ YD
BIT CONC	112 # / SQ YD / INCH
SHORT TERM PVMT MKING	4 FT / 40 FT OF APPL.