

STATE OF ILLINOIS
DEPARTMENT OF TRANSPORTATION

WEST EDGE OF SHOULDER

Location	Station	Offset (ft.)	Theoretical Grade Elevations
S. End South Appr. Slab	38+77.25	-15.00	658.54
A1	38+87.25	-15.00	658.54
A2	38+97.25	-15.00	658.54
N. End South Appr. Slab	39+07.25	-15.00	658.54

WEST EDGE OF PAVEMENT

Location	Station	Offset (ft.)	Theoretical Grade Elevations
S. End South Appr. Slab	38+77.25	-12.00	658.60
A1	38+87.25	-12.00	658.60
A2	38+97.25	-12.00	658.60
N. End South Appr. Slab	39+07.25	-12.00	658.60

℄ ROADWAY & P.G.

Location	Station	Offset (ft.)	Theoretical Grade Elevations
S. End South Appr. Slab	38+77.25	0.00	658.85
A1	38+87.25	0.00	658.85
A2	38+97.25	0.00	658.85
N. End South Appr. Slab	39+07.25	0.00	658.85

EAST EDGE OF PAVEMENT

Location	Station	Offset (ft.)	Theoretical Grade Elevations
S. End South Appr. Slab	38+77.25	12.00	658.60
A1	38+87.25	12.00	658.60
A2	38+97.25	12.00	658.60
N. End South Appr. Slab	39+07.25	12.00	658.60

EAST EDGE OF SHOULDER

Location	Station	Offset (ft.)	Theoretical Grade Elevations
S. End South Appr. Slab	38+77.25	15.00	658.54
A1	38+87.25	15.00	658.54
A2	38+97.25	15.00	658.54
N. End South Appr. Slab	39+07.25	15.00	658.54

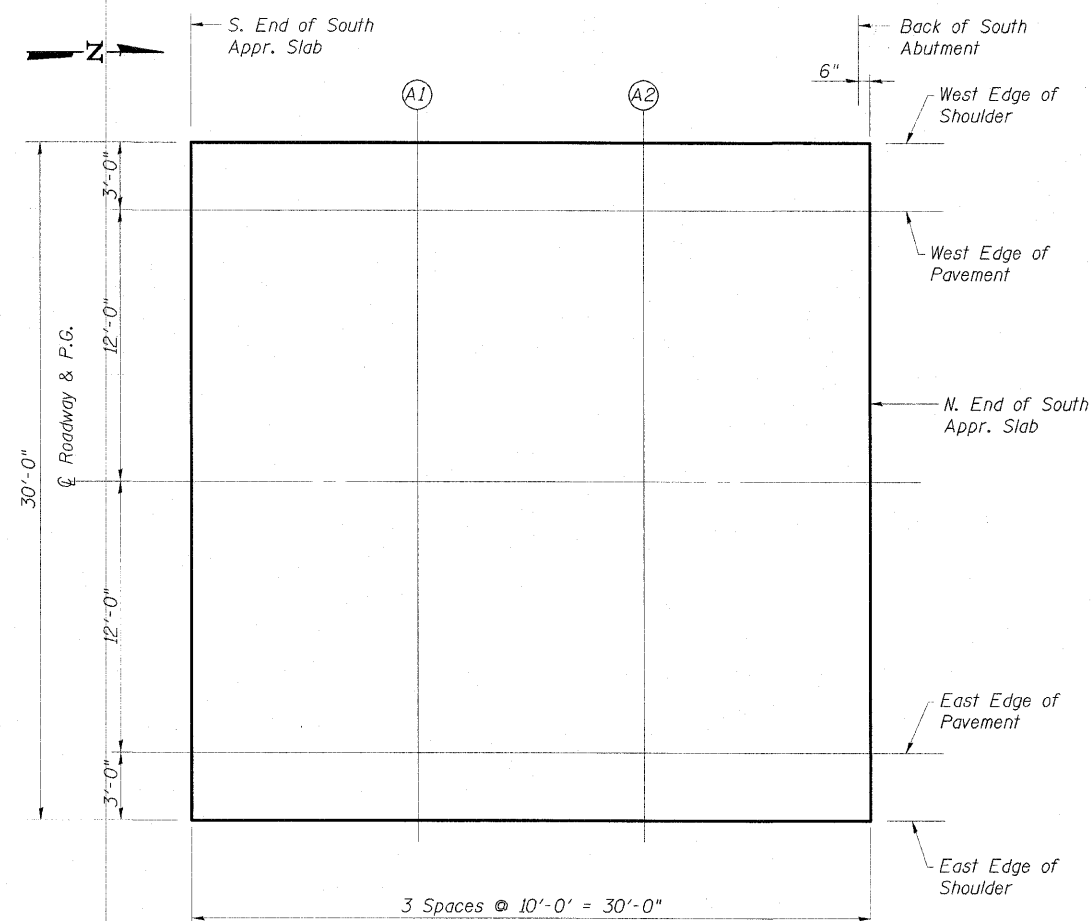

PLAN

TOP OF SOUTH
APPROACH SLAB ELEVATIONS
STRUCTURE NO. 074-0085

SHEET NO.	F.A.S. RTE.	SECTION	COUNTY	TOTAL SHEETS	SHEET NO.
6	535	08-00255-00-BR	PIATT	62	30
CONTRACT NO. 91436					
FED. ROAD DIST. NO. ILLINOIS FED. AID PROJECT					

ESCA
CONSULTANTS, INC.

DESIGNED BY:	FMA/MTD	10/09
DRAWN BY:	DWH/HAS	11/09
CHECKED BY:	MTD	11/09
APPROVED BY:	RDP	05/10

E-AS 11-1-09

0234428637096-dgn 5/25/2010 8:03:04 AM HAS