

STATE OF ILLINOIS
DEPARTMENT OF TRANSPORTATION

RTE	SECTION	COUNTY	TOTAL SHEETS	SHEET NO
VARIOUS	D 7 HT PVMNT MRK APR 22-13	VARIOUS	12	1
		ILLINOIS	CONTRACT NO. 46577	

FOR INDEX OF SHEETS, SEE SHEET NO. 2

PROPOSED HIGHWAY PLANS

VARIOUS ROUTES
SECTION D 7 HT PVMNT MRK RPR 22-13
PROJECT HIGH TYPE PAVEMENT MARKING
VARIOUS COUNTIES
M-60-013-22

M-60-013-22

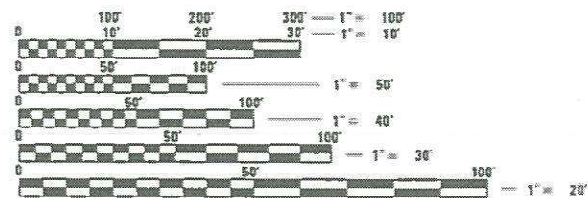
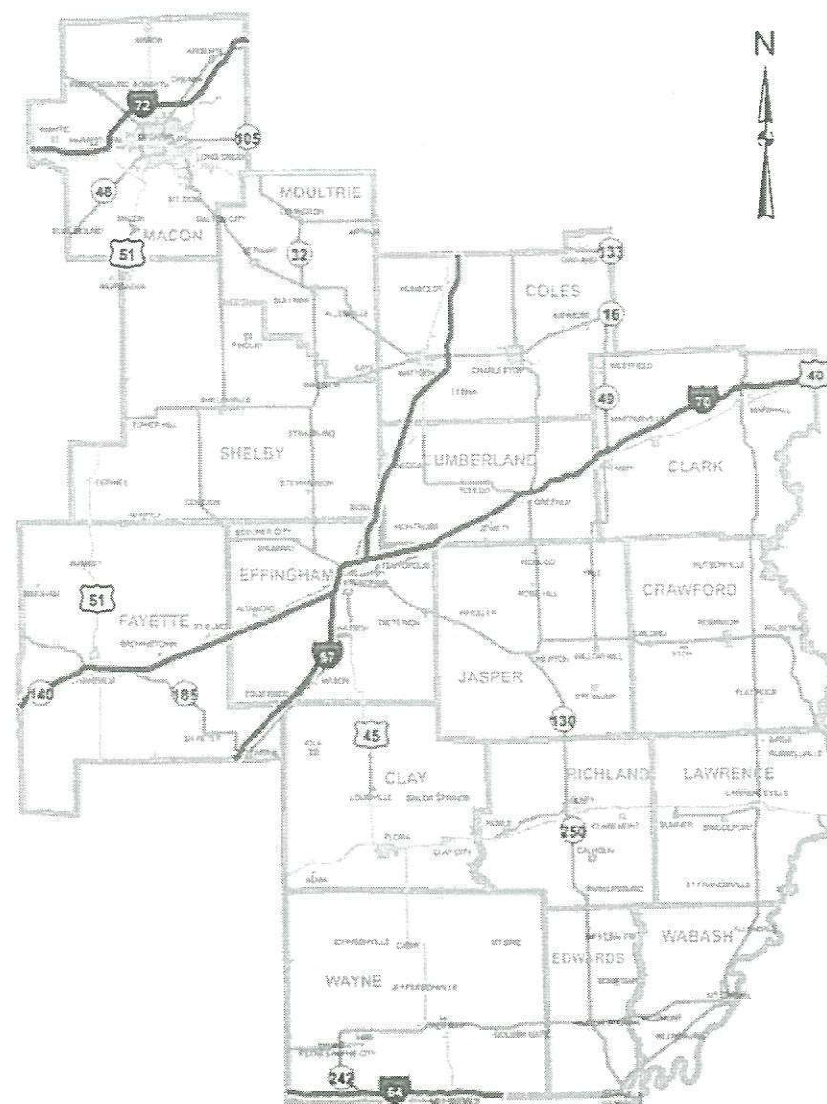
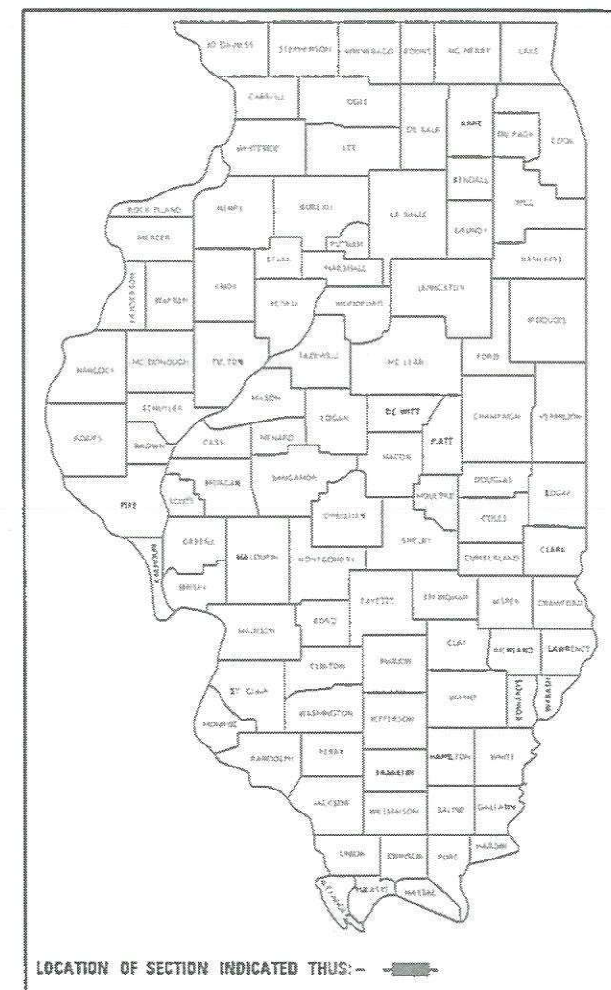

FULL SIZE PLANS HAVE BEEN PREPARED USING STANDARD ENGINEERING SCALES. REDUCED SIZED PLANS WILL NOT CONFORM TO STANDARD SCALES. IN MAKING MEASUREMENTS ON REDUCED PLANS, THE ABOVE SCALES MAY BE USED.

J.U.L.I.E.
JOINT UTILITY LOCATION INFORMATION FOR EXCAVATORS
1-800-892-0123
OR 811

PROJECT ENGINEER DEWAYNE SEACHRIST
PROJECT MANAGER ROBERT GREUEL

CONTRACT NO. 46577

STATE OF ILLINOIS
DEPARTMENT OF TRANSPORTATION

SUBMITTED March 25 20 21
Jeffrey P. Mignoles
REGIONAL ENGINEER

August 13, 2021
Scott A. Etkin
ENGINEER OF DESIGN AND ENVIRONMENT

August 13, 2021
James J. ...
DIRECTOR OF HIGHWAYS PROJECT IMPLEMENTATION

PRINTED BY THE AUTHORITY
OF THE STATE OF ILLINOIS

INDEX OF SHEETS

1	COVER SHEET
2	INDEX AND STANDARDS
3 - 4	SUMMARY OF QUANTITIES
5 - 6	EXAMPLE OF WORK SHEETS
7 -12	DISTRICT 7 DETAIL NO. 78000001 & 78000002

STANDARDS

701006-05	OFF-ROAD OPERATIONS 2L, 2W, 15' (4.5 m) TO 24" (600 mm) FROM PAVEMENT EDGE
701011-04	OFF-ROAD MOVING OPERATIONS, 2L, 2W, DAY ONLY
701101-05	OFF-ROAD OPERATIONS, MULTILANE, 15' (4.5 m) TO 24" (600 mm) FROM PAVEMENT EDGE
701106-02	OFF-ROAD OPERATIONS, MULTILANE, MORE THAN 15' (4.5m) AWAY
701201-05	LANE CLOSER, 2L, 2W, DAY ONLY, FOR SPEEDS ≥ 45 MPH
701301-04	LANE CLOSER, 2L, 2W, SHORT TIME OPERATIONS
701311-03	LANE CLOSURE 2L, 2W MOVING OPERATIONS - DAY ONLY
701400-10	APPROACH TO LANE CLOSURE, FREEWAY/EXPRESSWAY
701401-12	LANE CLOSURE, FREEWAY/EXPRESSWAY
701406-12	LANE CLOSURE, FREEWAY/EXPRESSWAY, DAY OPERATIONS ONLY
701411-09	LANE CLOSURE, MULTILANE, AT ENTRANCE OR EXIT RAMP FOR SPEEDS ≥ 45 MPH
701426-09	LANE CLOSURE, MULTILANE INTERMITTENT OR MOVING OPERATION, FOR SPEEDS ≥ 45 MPH
701427-05	LANE CLOSURE, MULTILANE INTERMITTENT OR MOVING OPERATION, FOR SPEEDS ≤ 40 MPH
701428-01	TRAFFIC CONTROL, SETUP AND REMOVAL, FREEWAY / EXPRESSWAY
701456-05	PARTIAL EXIT RAMP CLOSURE FREEWAY / EXPRESSWAY
701501-06	URBAN LANE CLOSURE, 2L,2W, UNDIVIDED
701502-09	URBAN LANE CLOSURE, 2L, 2W, WITH BIDIRECTIONAL LEFT TURN LANE
701601-09	URBAN LANE CLOSURE, MULTILANE, 1W OR 2W WITH NONTRAVERSABLE MEDIAN
701602-10	URBAN LANE CLOSURE, MULTILANE, 2W WITH BIDIRECTIONAL LEFT TURN LANE
701606-10	URBAN SINGLE LANE CLOSURE, MULTILANE, 2W WITH MOUNTABLE MEDIAN
701701-10	URBAN LANE CLOSURE, MULTILANE INTERSECTION
701901-08	TRAFFIC CONTROL DEVICES
000001-08	STANDARD SYMBOLS, ABBREVIATIONS AND PATTERNS
001006	DECIMAL OF AN INCH AND OF A FOOT
780001-05	TYPICAL PAVEMENT MARKINGS

REV. - MS

MODEL: Default
 FILE: Mainfile.plt
 PLOT: plottersroom.dwt
 ILLINOIS.gov: I:\MIDOT\Documents\DOT_Offices\District_7\Projects\46577\CADD\DATA\CAD\Sheet\46577-shc-genote.dgn

USER NAME = GREUCLRJ	DESIGNED -	REVISED -	STATE OF ILLINOIS DEPARTMENT OF TRANSPORTATION	INDEX OF SHEETS STANDARDS				RTE.	SECTION	COUNTY	TOTAL SHEETS	SHEET NO.
	DRAWN -	REVISED -		Various	D 7 HT PVMNT MRK RPR 22-13	VARIOUS	12	2				
PLOT SCALE = 100.0000' / in.	CHECKED -	REVISED -						CONTRACT NO. 46577				
PLOT DATE = 3/23/2021	DATE -	REVISED -		SCALE:	SHEET	OF	SHEETS	STA.	TO	STA.	ILLINOIS FED. AID PROJECT	

100%
STATE

SUMMARY OF QUANTITIES			TOTAL QUANTITIES	CONSTRUCTION TYPE CODE		
CODE NO	ITEM	UNIT		0021		
78000100	THERMOPLASTIC PAVEMENT MARKING - LETTERS AND SYMBOLS	SO FT	5000	5000		
78000200	THERMOPLASTIC PAVEMENT MARKING - LINE 4"	FOOT	150000	150000		
78000400	THERMOPLASTIC PAVEMENT MARKING - LINE 6"	FOOT	150000	150000		
78000500	THERMOPLASTIC PAVEMENT MARKING - LINE 8"	FOOT	5000	5000		
78000600	THERMOPLASTIC PAVEMENT MARKING - LINE 12"	FOOT	10000	10000		
78000650	THERMOPLASTIC PAVEMENT MARKING - LINE 24"	FOOT	5000	5000		
78003100	PREFORMED PLASTIC PAVEMENT MARKING, TYPE B - LETTERS AND SYMBOLS	SO FT	100	100		
78003110	PREFORMED PLASTIC PAVEMENT MARKING, TYPE B - LINE 4"	FOOT	3000	3000		
78003130	PREFORMED PLASTIC PAVEMENT MARKING, TYPE B - LINE 6"	FOOT	10000	10000		
78003140	PREFORMED PLASTIC PAVEMENT MARKING, TYPE B - LINE 8"	FOOT	100	100		
78003150	PREFORMED PLASTIC PAVEMENT MARKING, TYPE B - LINE 12"	FOOT	500	500		

100%
STATE

SUMMARY OF QUANTITIES			TOTAL QUANTITIES	CONSTRUCTION TYPE CODE		
CODE NO	ITEM	UNIT		0021		
78003180	PREFORMED PLASTIC PAVEMENT MARKING, TYPE B - LINE 24"	FOOT	100	100		
78009000	MODIFIED URETHANE PAVEMENT MARKING - LETTERS AND SYMBOLS	SO FT	3000	3000		
78009004	MODIFIED URETHANE PAVEMENT MARKING - LINE 4"	FOOT	50000	50000		
78009006	MODIFIED URETHANE PAVEMENT MARKING - LINE 6"	FOOT	50000	50000		
78009008	MODIFIED URETHANE PAVEMENT MARKING - LINE 8"	FOOT	5000	5000		
78009012	MODIFIED URETHANE PAVEMENT MARKING - LINE 12"	FOOT	1500	1500		
78009024	MODIFIED URETHANE PAVEMENT MARKING - LINE 24"	FOOT	2000	2000		
78300201	PAVEMENT MARKING REMOVAL - GRINDING	SO FT	5000	5000		
X7800815	HOT SPRAY THERMOPLASTIC PAVEMENT MARKING LINE - 4 INCH	FOOT	300000	300000		
X7800835	HOT SPRAY THERMOPLASTIC PAVEMENT MARKING LINE - 6 INCH	FOOT	500000	500000		
X7800845	HOT SPRAY THERMOPLASTIC PAVEMENT MARKING LINE - 8 INCH	FOOT	10000	10000		

MODEL: Default
 FILE NAME: p:\pub\harronm\dot.illinois.gov\PIWDOT\Documents\DOT_Offices\District 7\Projects\46577\CAAD\Drawings\46577-SP-500.dwg

USER NAME = GREVELRJ	DESIGNED -	REVISED -
	DRAWN -	REVISED -
PLOT SCALE = 100,0000' / in.	CHECKED -	REVISED -
PLOT DATE = 3/23/2021	DATE -	REVISED -

**STATE OF ILLINOIS
DEPARTMENT OF TRANSPORTATION**

SUMMARY OF QUANTITIES

SCALE: SHEET OF SHEETS STA. TO STA.

ROUTE	SECTION	COUNTY	TOTAL SHEETS	SHEET NO.
VARIOUS	D 7 HT PVMNT MRK RPR 22-13	VARIOUS	12	3
			CONTRACT NO. 46577	
		ILLINOIS	FED. AID PROJECT	

WORK ORDER

Districts 7 High-Type Pavement Marking Repair 2021-22

WORK ORDER NO. _____

DATE OF ISSUE _____

ROUTE _____

LOCATION DESCRIPTION _____

CONTRACT NO.: 46577 _____

JOB NO.: M-60-013-22

CODE NUMBER	ITEM	UNIT	QUANTITY	UNIT PRICE	ITEM COST
78000100	THERMOPLASTIC PAVEMENT MARKING - LETTERS AND SYMBOLS	SQ FT	5,000.00		
78000200	THERMOPLASTIC PAVEMENT MARKING - LINE 4"	FOOT	150,000.00		
78000400	THERMOPLASTIC PAVEMENT MARKING - LINE 6"	FOOT	150,000.00		
78000500	THERMOPLASTIC PAVEMENT MARKING - LINE 8"	FOOT	5,000.00		
78000600	THERMOPLASTIC PAVEMENT MARKING - LINE 12"	FOOT	10,000.00		
78000650	THERMOPLASTIC PAVEMENT MARKING - LINE 24"	FOOT	5,000.00		
78003100	PREFORMED PLASTIC PAVEMENT MARKING - TYPE B - LETTERS AND SYMBOLS	SQ FT	100.00		
78003110	PREFORMED PLASTIC PAVEMENT MARKING - TYPE B - LINE 4"	FOOT	3,000.00		
78003130	PREFORMED PLASTIC PAVEMENT MARKING - TYPE B - LINE 6"	FOOT	10,000.00		
78003140	PREFORMED PLASTIC PAVEMENT MARKING - TYPE B - LINE 8"	FOOT	100.00		
78003150	PREFORMED PLASTIC PAVEMENT MARKING - TYPE B - LINE 12"	FOOT	500.00		
78003180	PREFORMED PLASTIC PAVEMENT MARKING - TYPE B - LINE 24"	FOOT	100.00		
78009000	MODIFIED URETHANE PAVEMENT MARKING - LETTERS AND SYMBOLS	SQ FT	3,000.00		
78009004	MODIFIED URETHANE PAVEMENT MARKING - LINE 4"	FOOT	50,000.00		
78009006	MODIFIED URETHANE PAVEMENT MARKING - LINE 6"	FOOT	50,000.00		
78009008	MODIFIED URETHANE PAVEMENT MARKING - LINE 8"	FOOT	5,000.00		
78009012	MODIFIED URETHANE PAVEMENT MARKING - LINE 12"	FOOT	1,500.00		
78009024	MODIFIED URETHANE PAVEMENT MARKING - LINE 24"	FOOT	2,000.00		
78300201	PAVMENT MARKING REMOVAL - GRINDING	SQ FT	5,000.00		
X7800815	HOT SPRAY THERMOPLASTIC PAVEMENT MARKING LINE - 4"	FOOT	300,000.00		
X7800835	HOT SPRAY THERMOPLASTIC PAVEMENT MARKING LINE - 6"	FOOT	500,000.00		
X7800845	HOT SPRAY THERMOPLASTIC PAVEMENT MARKING LINE - 8"	FOOT	10,000.00		
X7830068	GROOVING FOR RECESSED PAVEMENT MARKING, LETTERS, NUMBERS AND SYMBOLS	SQ FT	100.00		
X7830070	GROOVING FOR RECESSED PAVEMENT MARKING 5"	FOOT	3,000.00		
X7830074	GROOVING FOR RECESSED PAVEMENT MARKING 7"	FOOT	10,000.00		
X7830076	GROOVING FOR RECESSED PAVEMENT MARKING 9"	FOOT	100.00		
X7830078	GROOVING FOR RECESSED PAVEMENT MARKING 13"	FOOT	500.00		
X7830090	GROOVING FOR RECESSED PAVEMENT MARKING 25"	FOOT	100.00		

DISTRICT CONTACT

NAME: Phil Boyer

TELEPHONE: 217-342-8291

CELL PHONE: 217-500-7139

SUBMITTED BY: _____
Deputy Director of Highways, Regional Engineer

DATE: _____

APPROVED BY: _____
Engineer of Operations

DATE: _____

MODEL: Default
FILE NAME: \\paulhammon.dot.ilinois.gov\PIWDOT\Documents\DOT_Offices\District_7\Projects\46577\CADD\DATA\CAD\Projects\DOT\46577-510-detaile.dgn

USER NAME = GREUELJ	DESIGNED -	REVISED -	STATE OF ILLINOIS DEPARTMENT OF TRANSPORTATION	EXAMPLE OF WORK ORDERS				RTE.	SECTION	COUNTY	TOTAL SHEETS	SHEET NO.
	DRAWN -	REVISED -						VARIOUS	D 7 HT PVMNT MRK RPR 22-13	VARIOUS	12	6
PLOT SCALE = 100,0000' / in.	CHECKED -	REVISED -						CONTRACT NO. 46577				
PLOT DATE = 3/23/2021	DATE -	REVISED -						ILLINOIS FED. AID PROJECT				
			SCALE:		SHEET OF SHEETS		STA.		TO STA.			

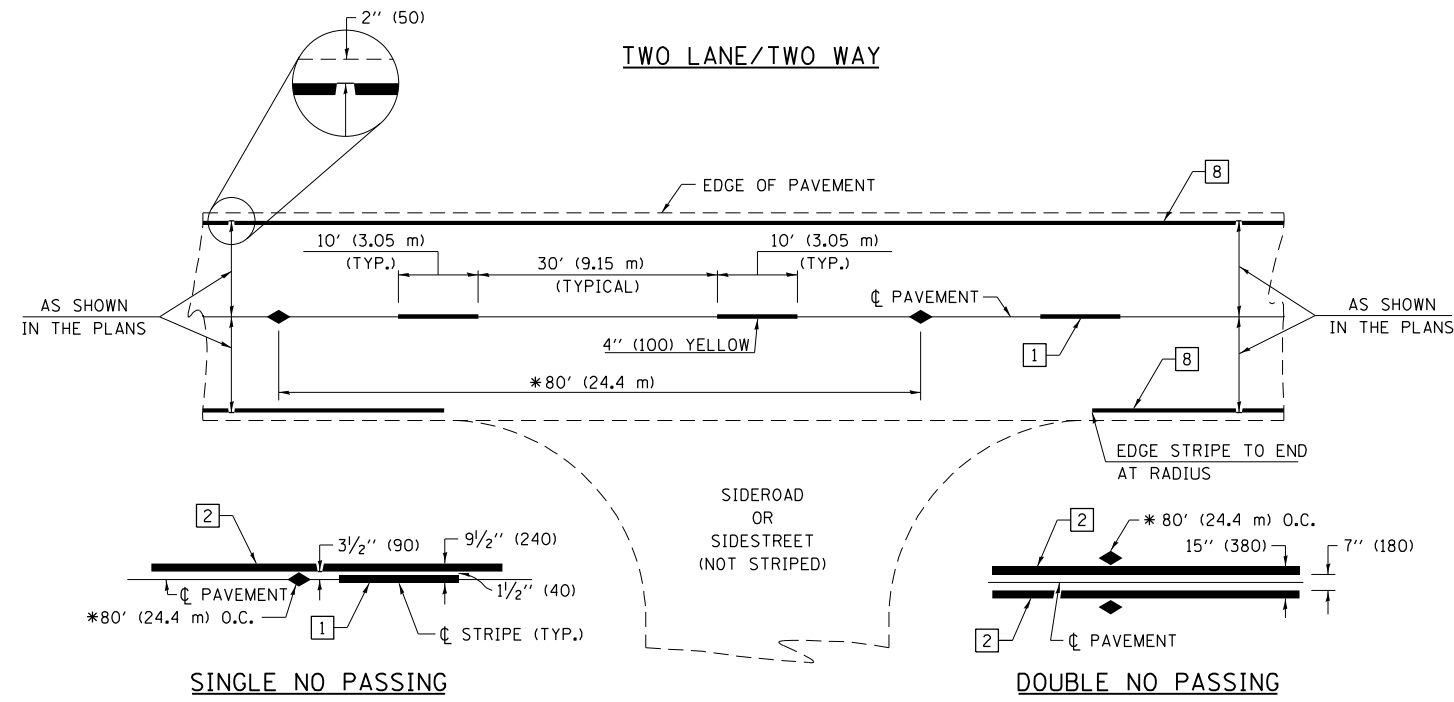

PAVEMENT MARKING LEGEND

- 1 4" (100) SKIP-DASH (YELLOW)
- 2 4" (100) SOLID (YELLOW)
- 3 12" (300) DIAGONAL (YELLOW)
- 4 4" (100) DOUBLE YELLOW (NARROW)
- 5 12" (300) SOLID WHITE
- 6 RESERVED
- 7 6" (150) SKIP-DASH (WHITE)
- 8 4" (100) SOLID (WHITE)
- 9 12" (300) DIAGONAL (WHITE)
- 10 6" (150) SOLID (WHITE)
- 11 24" (600) STOP BAR (WHITE)
- 12 8" (200) SOLID (WHITE)
- 13 4" (100) PARKING WHITE

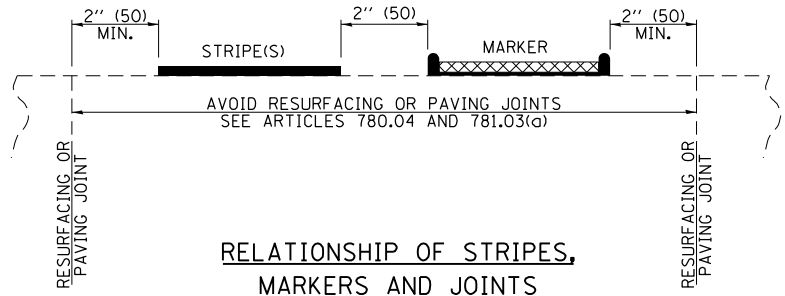

TYPICAL PAVEMENT MARKERS LEGEND

- ◆ TWO-WAY AMBER MARKER
- ▶ ONE-WAY AMBER MARKER
- ▷ ONE-WAY CRYSTAL MARKER

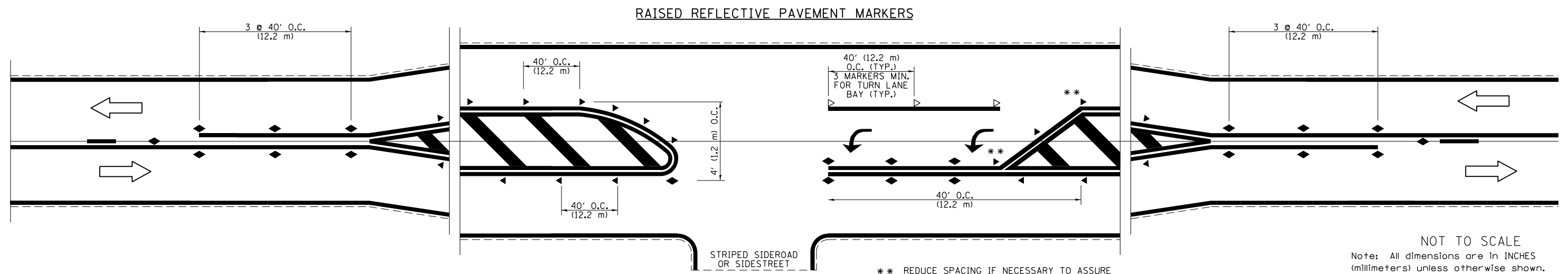

NOT TO SCALE
 Note: All dimensions are in INCHES (millimeters) unless otherwise shown.

DISTRICT 7 DETAIL NO. 7800001

MODEL: Default
 FILE NAME: p:\pub\baronon.dwg
 PROJECT: 7800001.DISTRICT 7
 OFFICE: DISTRICT 7
 DATE: 3/23/2021

USER NAME = steffemk	DESIGNED -	REVISED -
	DRAWN -	REVISED -
PLOT SCALE = 100,0000' / in.	CHECKED -	REVISED -
PLOT DATE = 3/23/2021	DATE -	REVISED -

STATE OF ILLINOIS
 DEPARTMENT OF TRANSPORTATION

PAVEMENT MARKING AND RAISED REFLECTIVE PAVEMENT MARKERS
 (RURAL & URBAN APPLICATIONS)

SCALE: SHEET OF SHEETS STA. TO STA.

RTE.	SECTION	COUNTY	TOTAL SHEETS	SHEET NO.
VARIOUS	D 7 HT PVMNT MRK RPR 22-13	VARIOUS	12	7
			CONTRACT NO. 46577	
		ILLINOIS	FED. AID PROJECT	

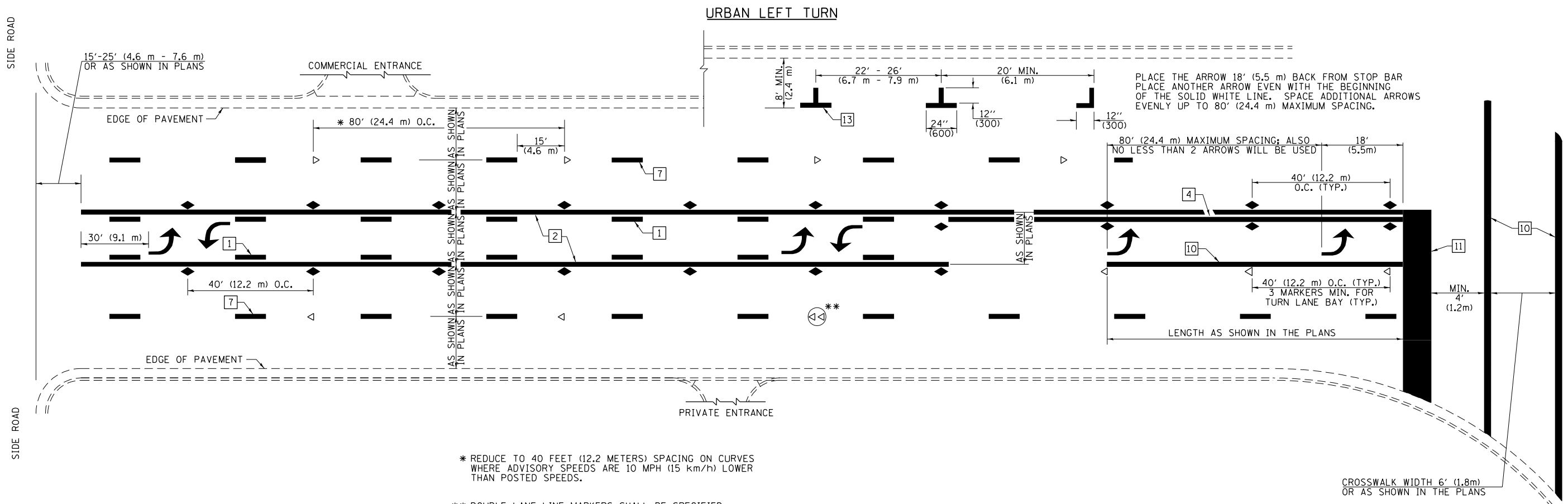

* REDUCE TO 40 FEET (12.2 METERS) SPACING ON CURVES WHERE ADVISORY SPEEDS ARE 10 MPH (15 km/h) LOWER THAN POSTED SPEEDS.

** DOUBLE LANE LINE MARKERS SHALL BE SPECIFIED AND SPACED AS SHOWN IN HIGHWAY STANDARD 781001 FOR MULTI-LANE DIVIDED AND UNDIVIDED HIGHWAYS.

PAVEMENT MARKING LEGEND

- 1 4" (100) SKIP-DASH (YELLOW)
- 2 4" (100) SOLID (YELLOW)
- 3 12" (300) DIAGONAL (YELLOW)
- 4 4" (100) DOUBLE YELLOW (NARROW)
- 5 12" (300) SOLID WHITE
- 6 RESERVED
- 7 6" (150) SKIP-DASH (WHITE)
- 8 4" (100) SOLID (WHITE)
- 9 12" (300) DIAGONAL (WHITE)
- 10 6" (150) SOLID (WHITE)
- 11 24" (600) STOP BAR (WHITE)
- 12 8" (200) SOLID (WHITE)
- 13 4" (100) PARKING WHITE

GENERAL NOTES

1. TURN ARROW PAIRS SHALL BE PLACED AT 250' (75 m) INTERVALS AND SHALL BE EVENLY SPACED BETWEEN BOTH ENDS OF THE BIDIRECTIONAL LEFT TURN LANE. USE A MINIMUM OF TWO PAIRS PER BLOCK.
2. THE SOLID YELLOW PAVEMENT MARKINGS [2] SHOULD GENERALLY START OR END NEAR THE RADIUS POINT OF EACH STREET RETURN EXCEPT WHERE ONE OR BOTH ENDS WOULD INCLUDE STOP BARS.
3. THE SKIP-DASH PAVEMENT MARKINGS [1] OR [7] SHOULD BE CENTERED BETWEEN BOTH ENDS OF EACH CITY BLOCK AND SHALL BE PLACED SO THEY LINE UP ACROSS FROM EACH OTHER.
4. USE LARGE ARROW SIZE FOR BOTH RURAL AND URBAN LOCATIONS. (SEE LAST PAGE OF SECTION 780x FOR SYMBOLS TABLE)
5. LANE LINE EXTENSIONS SHALL BE THE SAME COLOR AND WIDTH AS THE LANE LINE BEING EXTENDED.

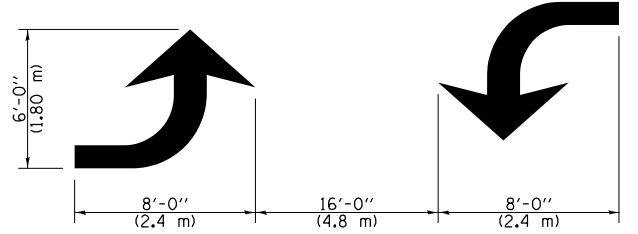
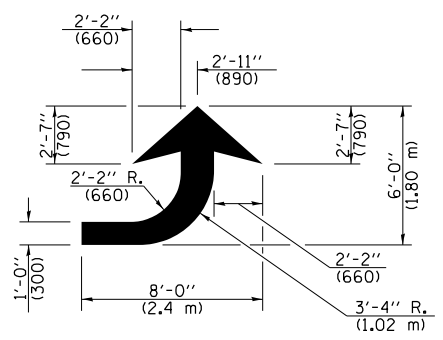
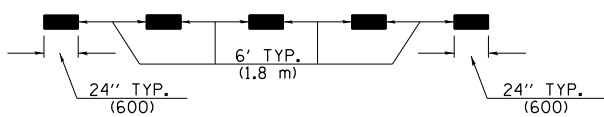
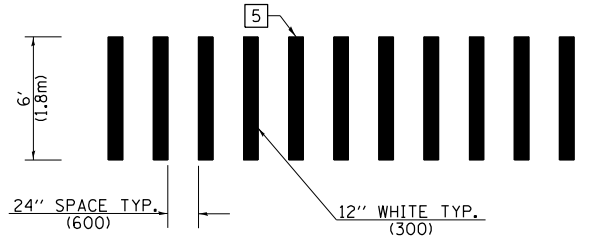

TYPICAL DOUBLE TURN ARROWS (WHITE)

LEFT ARROW
REVERSE FOR RIGHT ARROW
AREA = 15.6 SQ. FT. (1.47 m²)
(WHITE)

NOT TO SCALE

Note: All dimensions are in INCHES (millimeters) unless otherwise shown.

DISTRICT 7 DETAIL NO. 7800001

USER NAME = steffemk	DESIGNED -	REVISED -
PLOT SCALE = 100,0000' / in.	DRAWN -	REVISED -
PLOT DATE = 3/23/2021	CHECKED -	REVISED -
	DATE -	REVISED -

**STATE OF ILLINOIS
DEPARTMENT OF TRANSPORTATION**

**PAVEMENT MARKING AND RAISED REFLECTIVE PAVEMENT MARKERS
(RURAL & URBAN APPLICATIONS)**

SCALE: SHEET OF SHEETS STA. TO STA.

RTE.	SECTION	COUNTY	TOTAL SHEETS	SHEET NO.
VARIOUS	D 7 HT PVMNT MRK RPR 20-19	VARIOUS	12	8
CONTRACT NO. 46577			ILLINOIS FED. AID PROJECT	

MODEL: Default
 FILE NAME: p:\pub\baronm.dwt
 PROJECT: 46577-CA00DataCAD\Project\7800001.dwg
 PROJECT: 46577-CA00DataCAD\Project\7800001.dwg

ISLAND

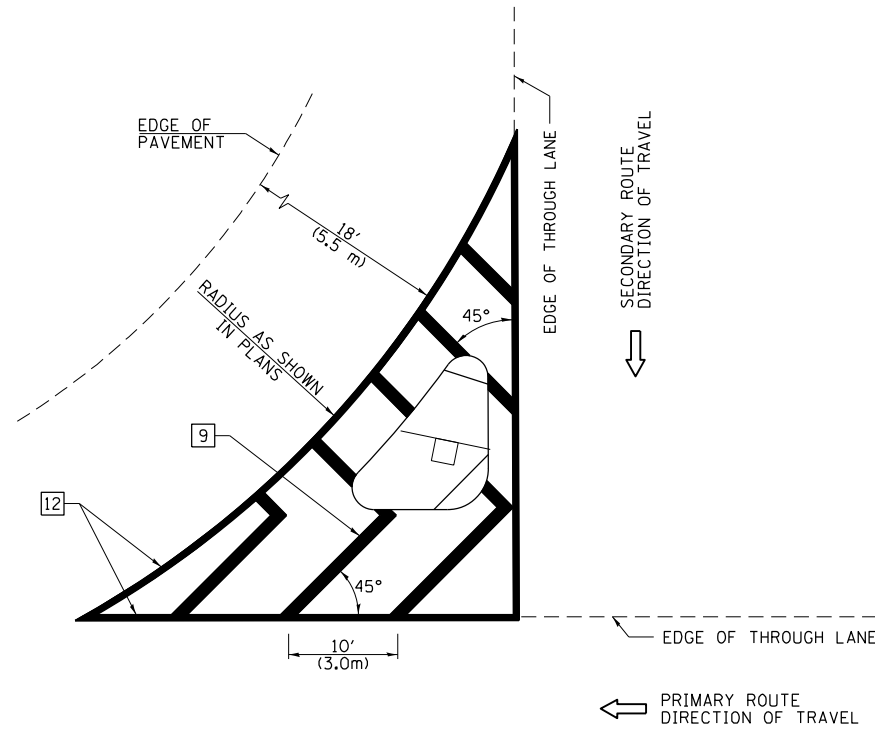

GENERAL NOTES

1. RAISED AND CORRUGATED MEDIANS SHALL BE OUTLINED WITH [2] IF PRESENT.
2. SOME OF THE INFORMATION INCLUDED WITH THIS DETAIL MAY NOT BE APPLICABLE TO THIS IMPROVEMENT.
3. PAVEMENT MARKINGS ARE TO BE EXTENDED THROUGH OMISSIONS WHEN APPLICABLE.
4. FINAL PAVEMENT MARKINGS SHALL BE IN PLACE PRIOR TO PLACING ANY RAISED REFLECTIVE PAVEMENT MARKERS.
5. THE FOLLOWING CRITERIA SHALL BE USED FOR SELECTING THE DIAGONAL PAVEMENT MARKING SPACING:

< 30 MPH (< 50 km/h)	15' (4.5 m)
30-45 MPH (50-75 km/h)	20' (6.0 m)
> 45 MPH (> 75 km/h)	30' (9.0 m)

PAVEMENT MARKING LEGEND

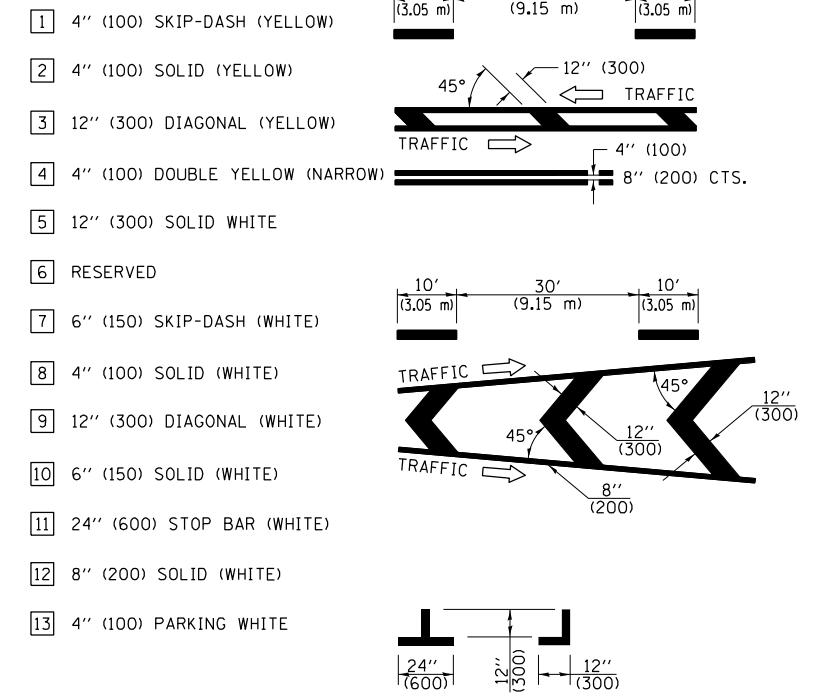

RURAL LEFT TURN STRIPING

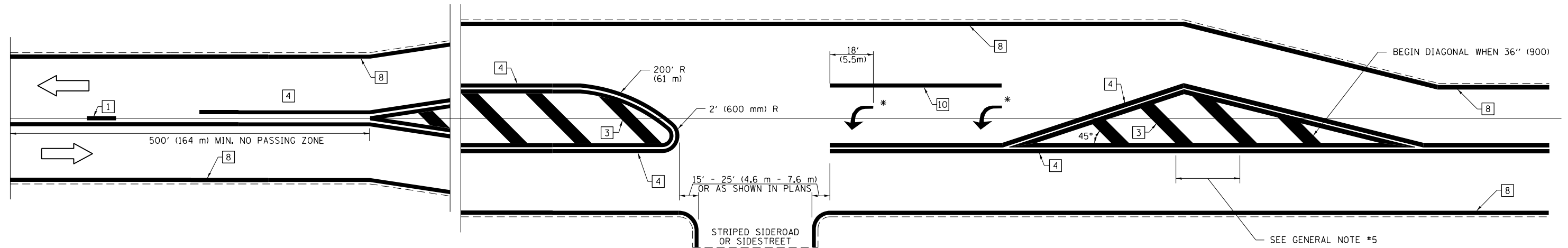

* PLACE AN ARROW 18' (5.5 m) BACK FROM STOP BAR. PLACE ANOTHER ARROW EVEN WITH THE BEGINNING OF THE SOLID WHITE LINE. SPACE ADDITIONAL ARROWS EVENLY UP TO 80' (24.4 m) MAXIMUM SPACING. USE MINIMUM OF 2 ARROWS.

NOT TO SCALE
Note: All dimensions are in INCHES (millimeters) unless otherwise shown.

DISTRICT 7 DETAIL NO. 78000001

**STATE OF ILLINOIS
DEPARTMENT OF TRANSPORTATION**

**PAVEMENT MARKING AND RAISED REFLECTIVE PAVEMENT MARKERS
(RURAL & URBAN APPLICATIONS)**

RTE.	SECTION	COUNTY	TOTAL SHEETS	SHEET NO.
VARIOUS	D 7 HT PVMNT MRK RPR 20-19	VARIOUS	12	9
CONTRACT NO. 46577				
ILLINOIS FED. AID PROJECT				

SCALE: SHEET OF SHEETS STA. TO STA.

MODEL: Default
 FILE NAME: p:\pub\harronm.dwt\illinois.gov\PIWDOT\Documents\DOT_Offices\District 7\Projects\46577\CADD\DATA\46577-SP\cityplan.dwg

USER NAME = steffenmk	DESIGNED -	REVISED -
PLOT SCALE = 100,0000' / in.	DRAWN -	REVISED -
PLOT DATE = 3/23/2021	CHECKED -	REVISED -
	DATE -	REVISED -

PAVEMENT MARKINGS AT RAILROAD-HIGHWAY GRADE CROSSING

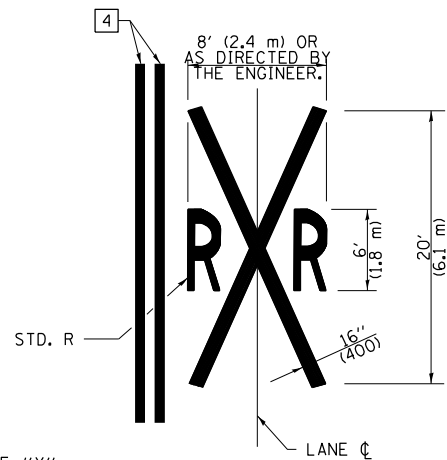
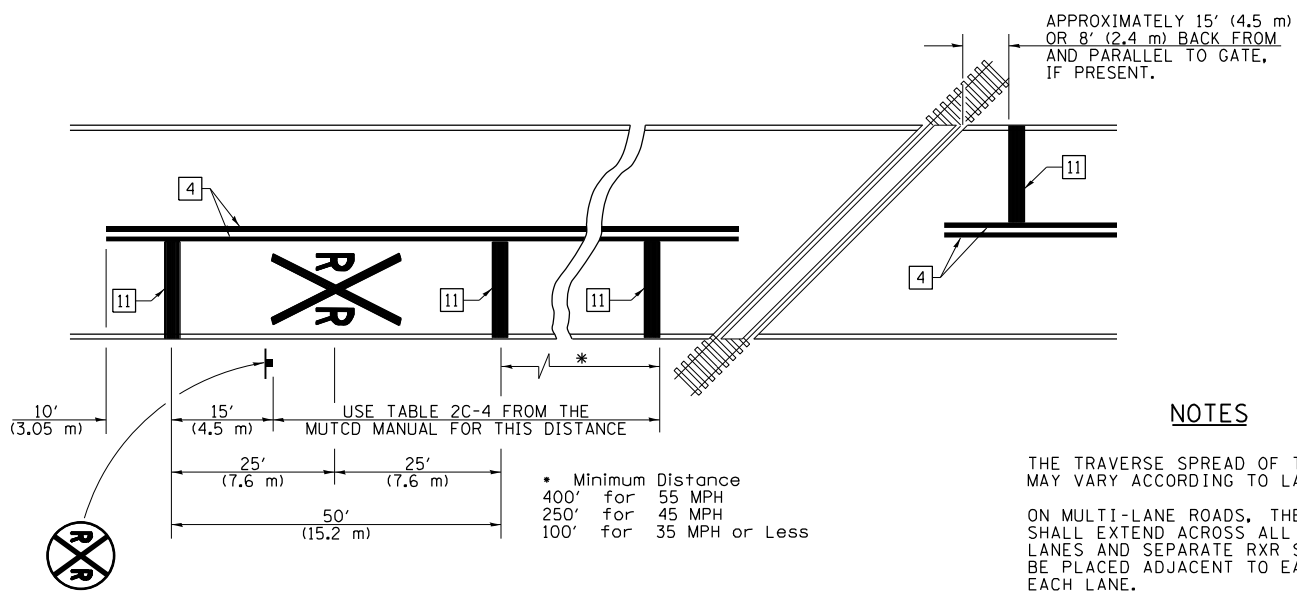

NOTES

THE TRAVERSE SPREAD OF THE "X" MAY VARY ACCORDING TO LANE WIDTH.

ON MULTI-LANE ROADS, THE STOP LINES SHALL EXTEND ACROSS ALL APPROACH LANES AND SEPARATE RXR SYMBOLS SHALL BE PLACED ADJACENT TO EACH OTHER IN EACH LANE.

WHEN THE PAVEMENT MARKING SYMBOL IS USED, A PORTION OF THE SYMBOL SHOULD BE LOCATED DIRECTLY ADJACENT TO THE ADVANCE WARNING SIGN (W10-1) AS PLACED BY TABLE II-1, CONDITION B OF THE MUTCD.

PAVEMENT MARKING LEGEND

- 1 4" (100) SKIP-DASH (YELLOW)
 - 2 4" (100) SOLID (YELLOW)
 - 3 12" (300) DIAGONAL (YELLOW)
 - 4 4" (100) DOUBLE YELLOW (NARROW)
 - 5 12" (300) SOLID WHITE
 - 6 RESERVED
 - 7 6" (150) SKIP-DASH (WHITE)
 - 8 4" (100) SOLID (WHITE)
 - 9 12" (300) DIAGONAL (WHITE)
 - 10 6" (150) SOLID (WHITE)
 - 11 24" (600) STOP BAR (WHITE)
 - 12 8" (200) SOLID (WHITE)
 - 13 4" (100) PARKING WHITE
-

RAILROAD CROSSING WITH INTERCONNECT ONLY

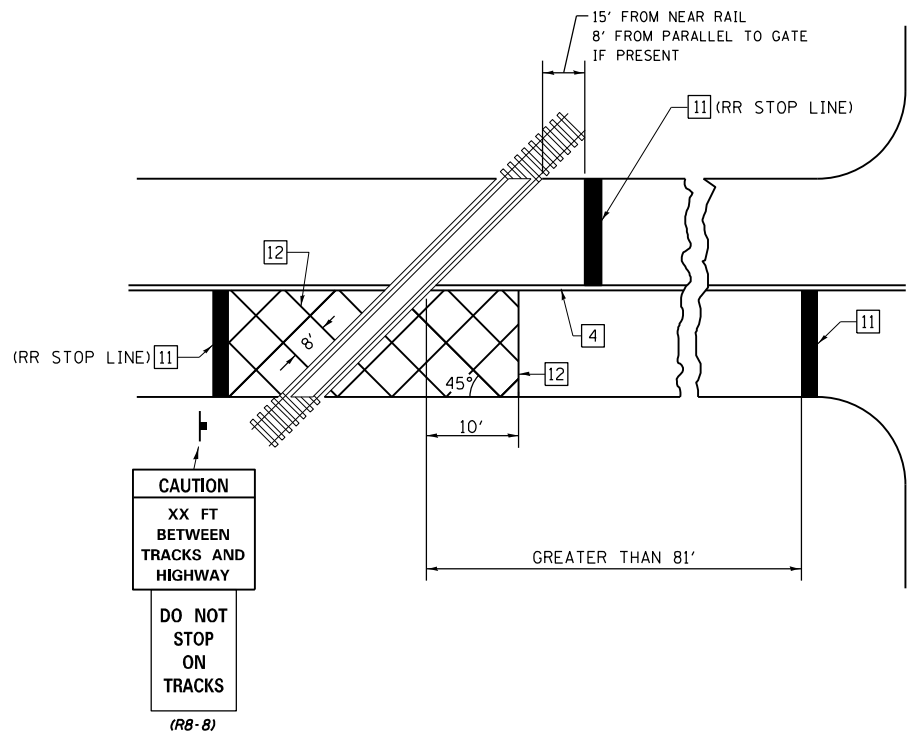

RAILROAD CROSSING WITH INTERCONNECT AND PRE-SIGNALS

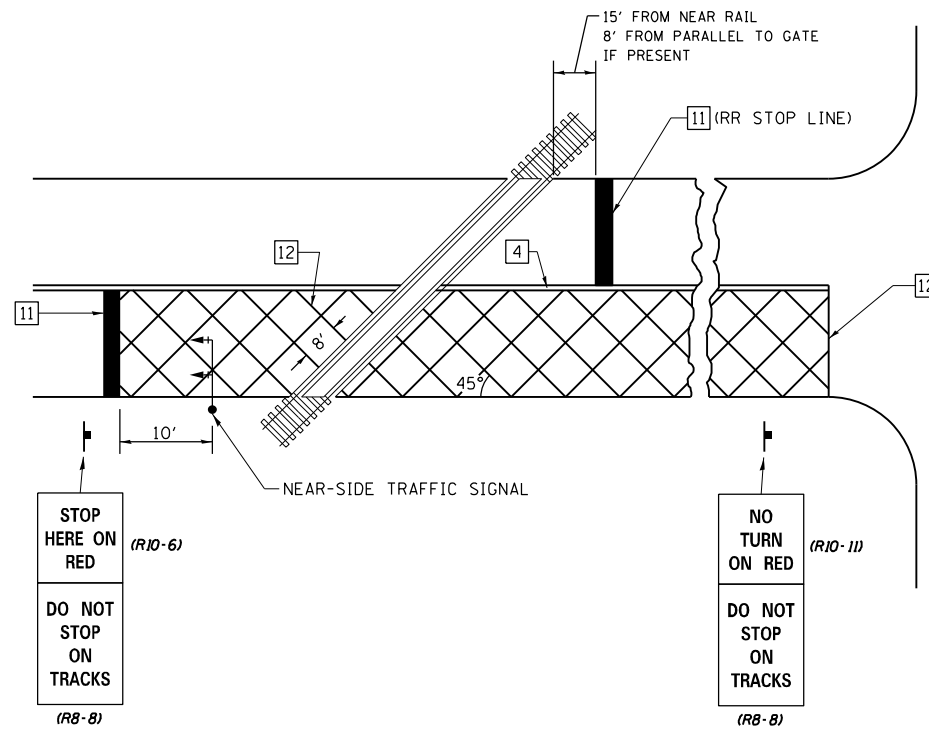

SUPPLEMENTAL PAVEMENT MARKING TREATMENT FOR RAILROAD-HIGHWAY GRADE CROSSING

GENERAL NOTES

- SUPPLEMENTAL PAVEMENT MARKINGS TO BE INSTALLED ONLY ON APPROACHES TO INTERSECTIONS CONTROLLED BY TRAFFIC SIGNALS WHICH ARE INTERCONNECTED WITH THE RAILROAD WARNING SIGNALS.
- EXTEND PAVEMENT MARKINGS TO THE INTERSECTION ONLY WHERE NEAR-SIDE TRAFFIC SIGNALS ARE USED.

NOT TO SCALE

Note: All dimensions are in INCHES (millimeters) unless otherwise shown.

DISTRICT 7 DETAIL NO. 78000001

MODEL: Default
FILE NAME: p:\pub\harronm.dwg
PROJECT: 146577-CADD\DATA\CADD\PROJECTS\146577-SPC\PLAN\PLA-01.dwg

USER NAME = stefenmk	DESIGNED -	REVISED -
	DRAWN -	REVISED -
PLOT SCALE = 100,0000' / in.	CHECKED -	REVISED -
PLOT DATE = 3/23/2021	DATE -	REVISED -

STATE OF ILLINOIS
DEPARTMENT OF TRANSPORTATION

PAVEMENT MARKING AND RAISED REFLECTIVE PAVEMENT MARKERS
(RURAL AND URBAN APPLICATIONS)

SCALE: SHEET OF SHEETS STA. TO STA.

RTE.	SECTION	COUNTY	TOTAL SHEETS	SHEET NO.
VARIOUS	D 7 HT PVMNT MRK RPR 20-19	VARIOUS	12	10
CONTRACT NO. 46577				
ILLINOIS FED. AID PROJECT				

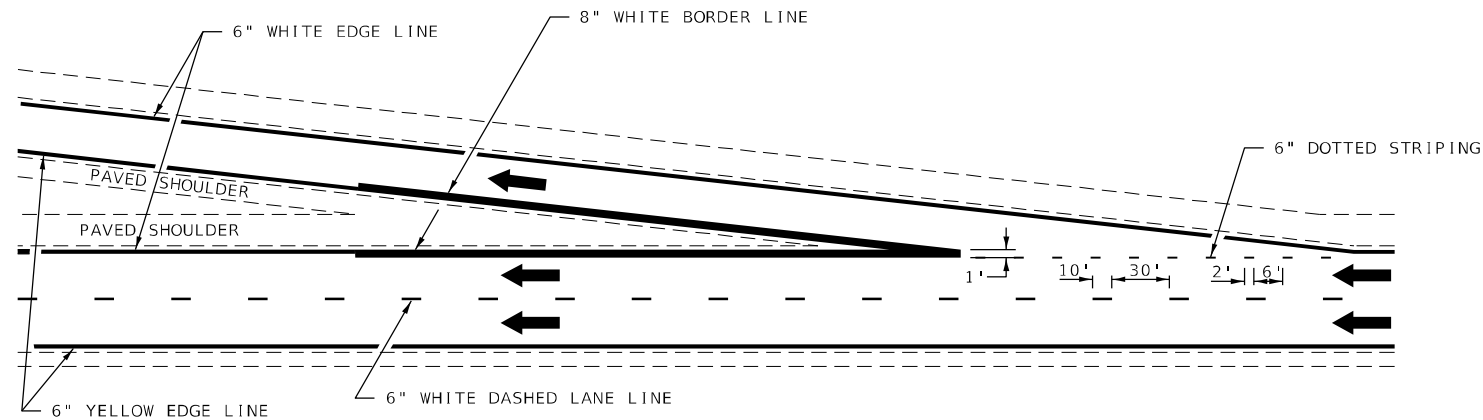

TYPICAL EXIT RAMP MARKING

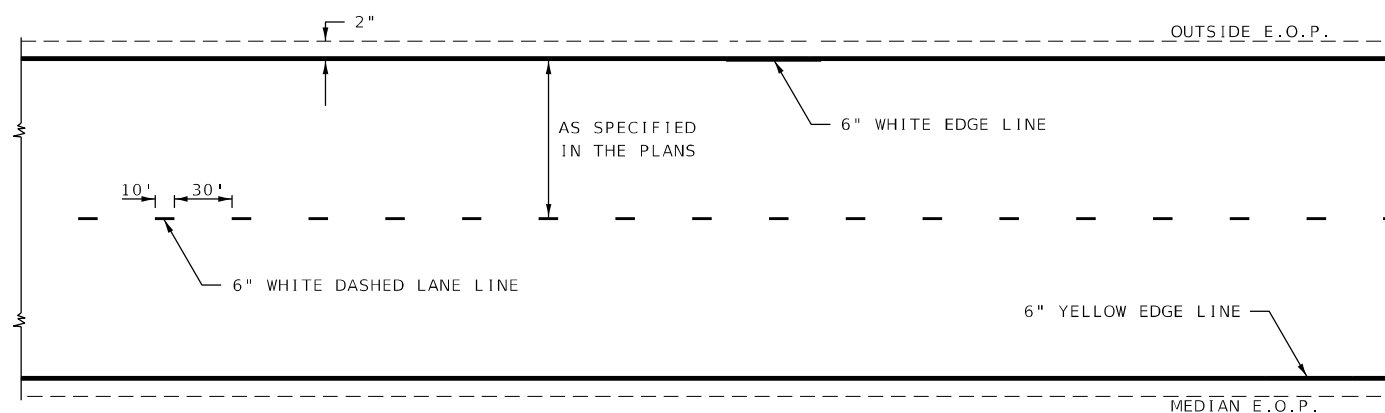

TYPICAL CENTERLING & EDGELINE MARKINGS

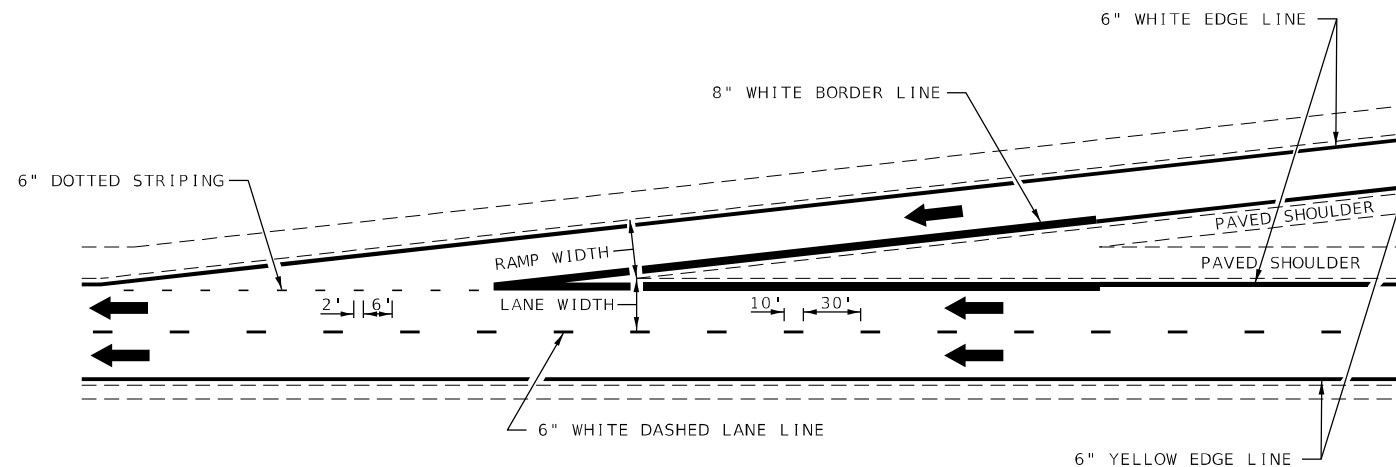

TYPICAL ENTRANCE RAMP MARKING

NOT TO SCALE

DISTRICT 7 DETAIL NO. 78000002

MODEL: Default
FILE NAME: p:\pub\harronm.dwt\illinois.gov\PIWDOT\Documents\IDOT_Offices\District 7\Projects\46577\CADD\Drawings\46577-std\typical.dgn

USER NAME = steffenmk	DESIGNED -	REVISED -
	DRAWN -	REVISED -
PLOT SCALE = 100,0000' / in.	CHECKED -	REVISED -
PLOT DATE = 3/23/2021	DATE -	REVISED -

STATE OF ILLINOIS
DEPARTMENT OF TRANSPORTATION

TYPICAL APPLICATIONS OF INTERSTATE PAVEMENT MARKING

SCALE: SHEET OF SHEETS STA. TO STA.

RTE.	SECTION	COUNTY	TOTAL SHEETS	SHEET NO.
VARIOUS	D 7 HT PVMNT MRK RPR 20-19	VARIOUS	12	11
			CONTRACT NO. 46577	
ILLINOIS FED. AID PROJECT				

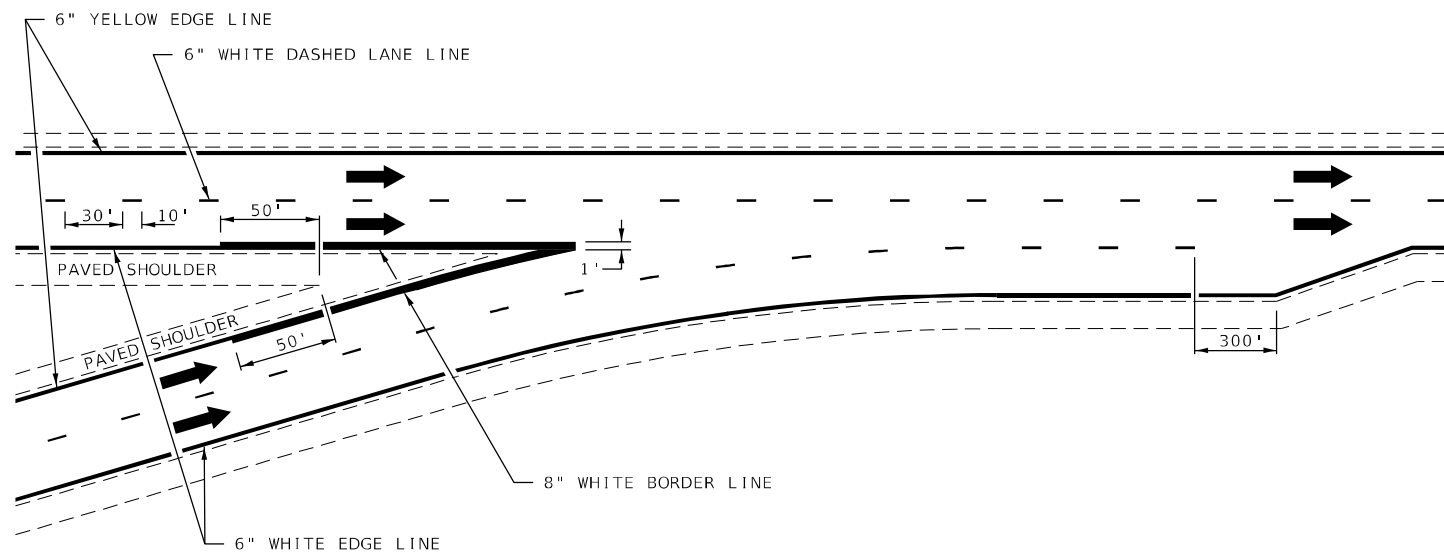

TYPICAL CONVERGENCE MARKING

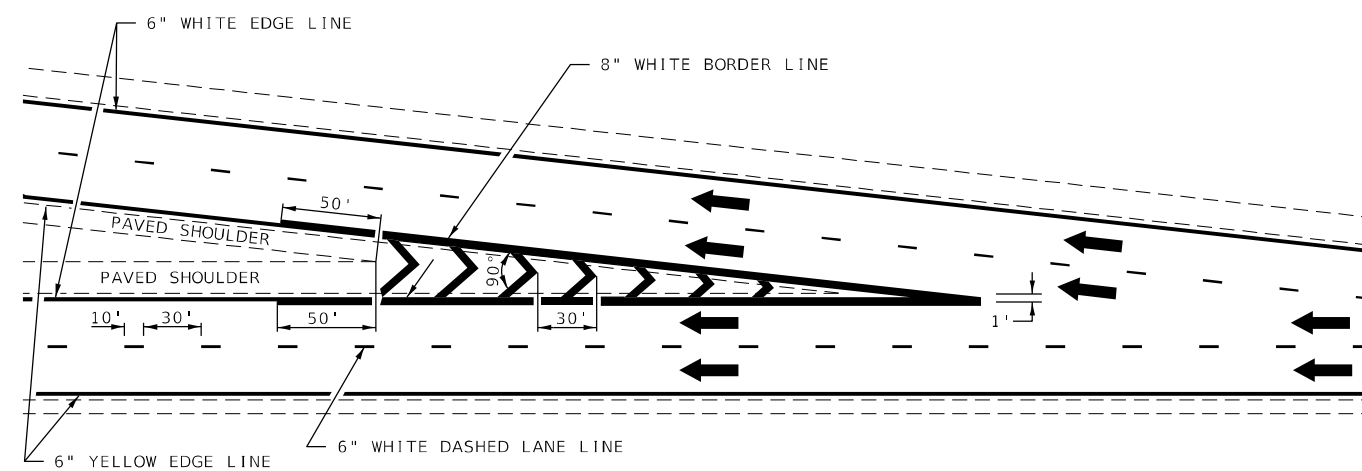

TYPICAL DIVERGENCE MARKING

AERIAL SPEED CHECK ZONES

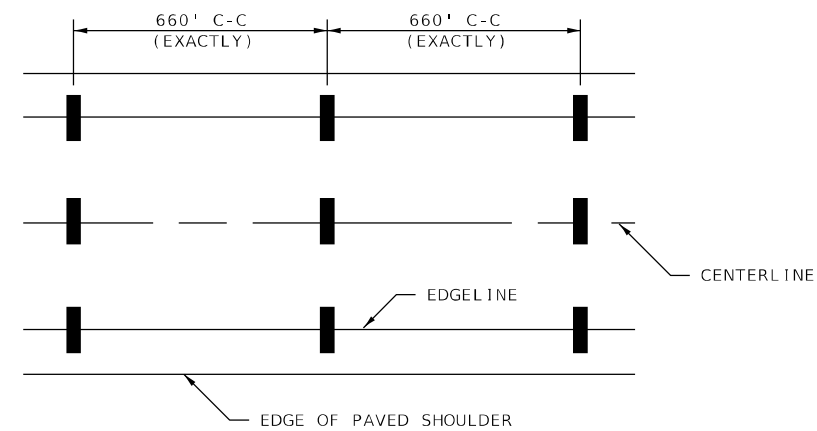

IT WILL BE NECESSARY TO HAVE A REPRESENTATIVE OF THE STATE POLICE PRESENT SO THAT THE ACCURACY OF MEASUREMENT CAN BE ATTESTED TO IN COURT.

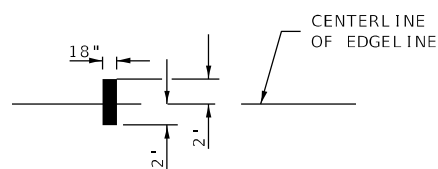

NOT TO SCALE

DISTRICT 7 DETAIL NO. 78000002

STATE OF ILLINOIS
DEPARTMENT OF TRANSPORTATION

TYPICAL APPLICATIONS OF INTERSTATE PAVEMENT MARKING

RTE.	SECTION	COUNTY	TOTAL SHEETS	SHEET NO.
VARIOUS	D 7 HT PVMNT MRK RPR 20-19	VARIOUS	12	12
			CONTRACT NO. 46577	
ILLINOIS FED. AID PROJECT				

SCALE: SHEET OF SHEETS STA. TO STA.

MODEL: Default
 FILE NAME: p:\pub\harronm.dwt\illinois.gov\PIVDOT\Documents\IDOT_Offices\District_7\Projects\46577\CADD\Drawings\46577-std\typical.dgn

USER NAME = steffenmk	DESIGNED -	REVISED -
	DRAWN -	REVISED -
PLOT SCALE = 100,0000' / in.	CHECKED -	REVISED -
PLOT DATE = 3/23/2021	DATE -	REVISED -