

STATE OF ILLINOIS
DEPARTMENT OF TRANSPORTATION

F.A. RTE.	SECTION	COUNTY	TOTAL SHEETS	SHEET NO.
*	HSIP 2021-1	**	14	1
ILLINOIS			CONTRACT NO. 70F64	

*FAI-55 & FAI-57
**CHAMPAIGN, DOUGLAS, MCLEAN

P-95-026-24

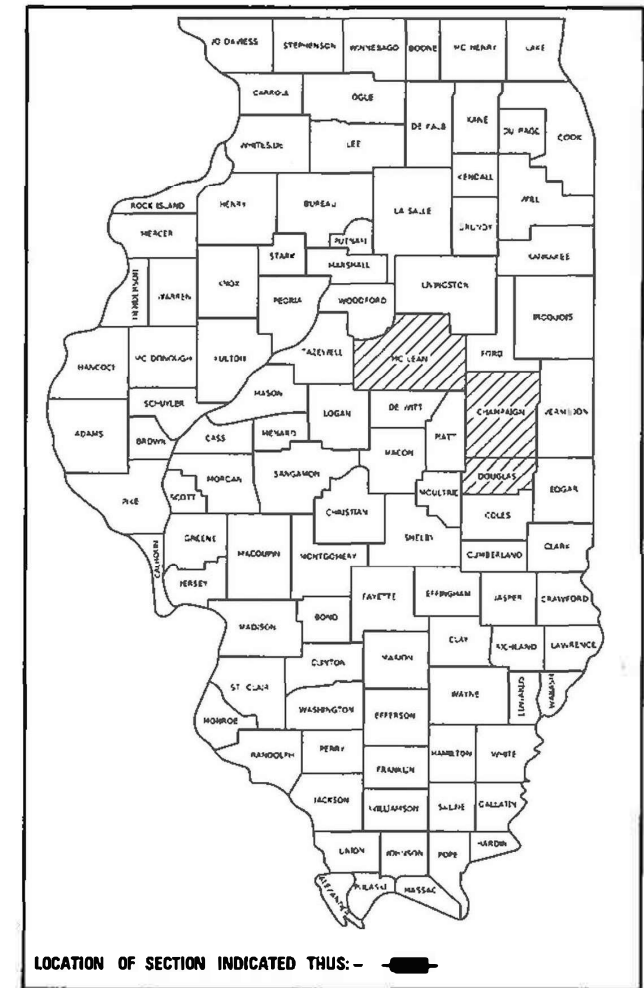

PROPOSED HIGHWAY PLANS

ROUTES FAI 55 & FAI 57 (I-55 & I-57)
SECTION HSIP 2021-1
PROJECT HSIP-QJVH(682)
PAVEMENT MARKING
CHAMPAIGN, DOUGLAS, MCLEAN COUNTIES

C-95-074-21

FOR INDEX OF SHEETS, SEE SHEET NO. 2
FOR SUMMARY OF QUANTITIES, SEE SHEET NO. 6

FULL SIZE PLANS HAVE BEEN PREPARED USING STANDARD
ENGINEERING SCALES. REDUCED SIZED PLANS WILL NOT
CONFORM TO STANDARD SCALES. IN MAKING MEASUREMENTS
ON REDUCED PLANS, THE ABOVE SCALES MAY BE USED.

AVERAGE DAILY TRAFFIC
DOUGLAS COUNTY - 23,500
CHAMPAIGN COUNTY - 26,100
MCLEAN COUNTY - 39,600

J.U.L.I.E.
JOINT UTILITY LOCATION INFORMATION FOR EXCAVATORS
1-800-892-0123
OR 811
ARCOLA TOWNSHIP, TUSCOLA TOWNSHIP,
PESOTUM TOWNSHIP, TOLONO TOWNSHIP,
CHAMPAIGN TOWNSHIP, HENSLEY TOWNSHIP,
SOMER TOWNSHIP, RANTOUL TOWNSHIP,
LUDLOW TOWNSHIP, NORMAL TOWNSHIP

FOR LOCATION MAPS, SEE SHEETS 3 - 5

PROJECT ENGINEER: JASON STULTS
PROJECT DESIGNER: KEVIN KNOEPFEL
PHONE: (217)465-4181
CONTRACT NO. 70F64

GROSS LENGTH = 315,689 FT. = 59.79 MILES
NET LENGTH = 230,687 FT. = 43.69 MILES

STATE OF ILLINOIS
DEPARTMENT OF TRANSPORTATION

SUBMITTED June 22, 2021
[Signature]
REGIONAL ENGINEER

August 13, 2021 [Signature]
ENGINEER OF DESIGN AND ENVIRONMENT

August 13, 2021 [Signature]
DIRECTOR OF HIGHWAYS PROJECT IMPLEMENTATION

PRINTED BY THE AUTHORITY
OF THE STATE OF ILLINOIS

INDEX OF SHEETS

SHEET NO	DESCRIPTION
1	COVER SHEET
2	INDEX OF SHEETS / HIGHWAY STANDARDS
2	GENERAL NOTES
3-5	LOCATION MAPS
6	SUMMARY OF QUANTITIES
7-13	SCHEDULE OF QUANTITIES
14	DETAIL - PAVEMENT MARKINGS (INTERSTATE & MULTI-LANE APPLICATIONS)

GENERAL NOTES

G.N.-100A
ELECTRONIC FILES AND/OR ELECTRONIC SURVEY INFORMATION INCLUDING CADD FILES WILL NOT BE AVAILABLE TO THE CONTRACTOR.

NO COMMITMENTS

HIGHWAY STANDARDS

STANDARD NO.	DESCRIPTION
000001-08	STANDARD SYMBOLS, ABBREVIATIONS, AND PATTERNS
001006	DECIMAL OF AN INCH AND OF A FOOT
701426-09	LANE CLOSURE, MULTI-LANE, INTERMITTENT OR MOVING OPERATION, FOR SPEEDS >=45 MPH
701901-08	TRAFFIC CONTROL DEVICES
780001-05	TYPICAL PAVEMENT MARKINGS

MODEL: \\MODEL\MAME
 FILE NAME: \\p14m100m02.dwg
 PROJECT: \\PROJECTS\DOT - Office\Bartlett - Projects\DOT\Documents\DOT - Office\Bartlett - Projects\DOT\70F64\70F64-RT-GenNotes.dgn

*FAI-55 & FAI-57
 **CHAMPAIGN, DOUGLAS, MCLEAN

USER NAME = plersonbr DESIGNED - DRAWN - PLOT SCALE = 40,0000 */ in. CHECKED - REVISIED - PLOT DATE = 6/22/2021 DATE - REVISED -	STATE OF ILLINOIS DEPARTMENT OF TRANSPORTATION	INDEX OF SHEETS, LIST OF STANDARDS & GENERAL NOTES	F.A. RTE. SECTION COUNTY TOTAL SHEETS SHEET NO.	** CONTRACT NO. 70F64	SCALE: NONE SHEET 1 OF 1 SHEETS STA. TO STA. ILLINOIS FED. AID PROJECT
--	---	---	---	--------------------------	---

LOCATION MAP - DOUGLAS COUNTY

LOCATION #1

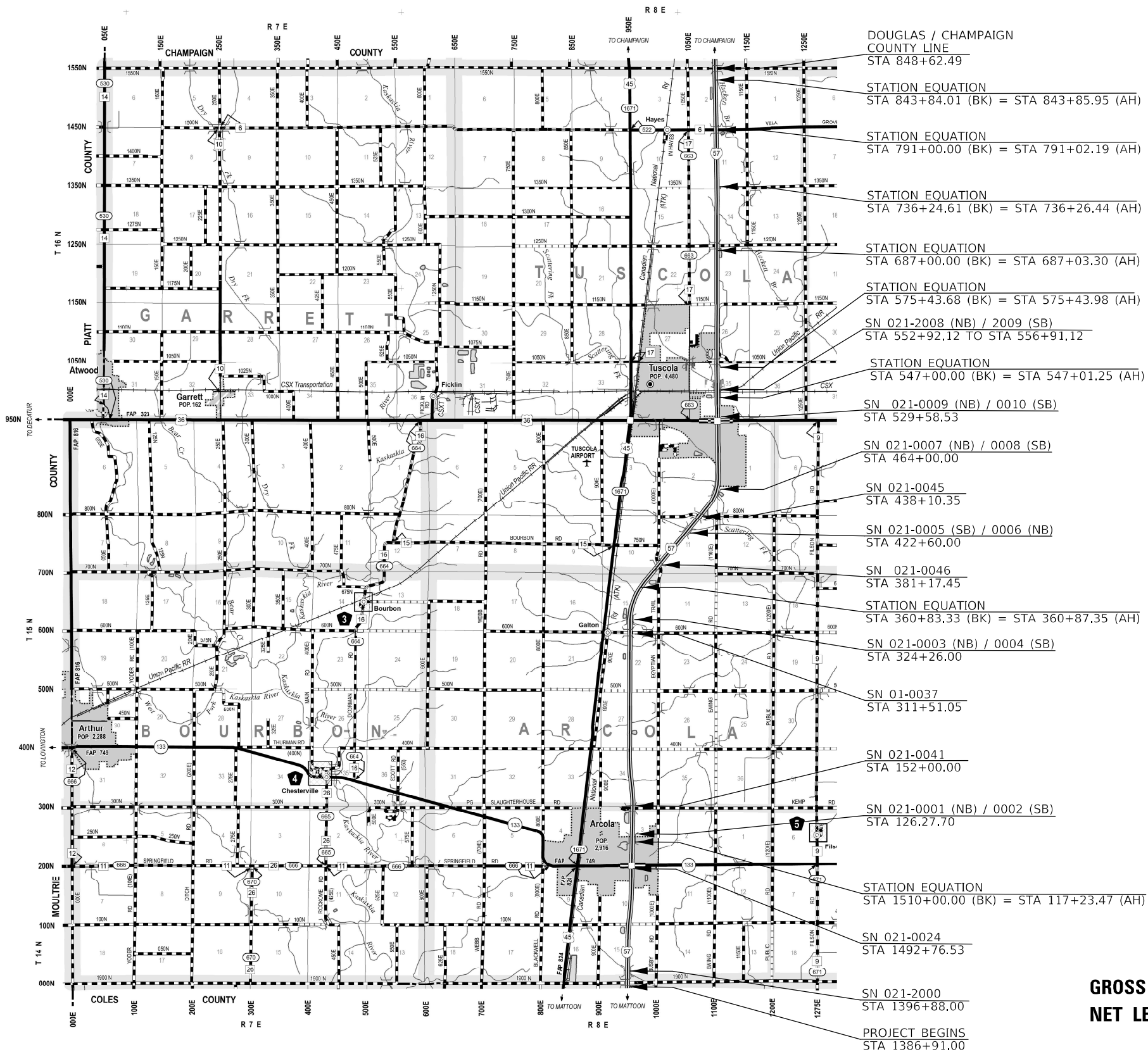

GROSS LENGTH 85,433 FT = 16.18 MILES
NET LENGTH 85,433 FT = 16.18 MILES

*FAI-55 & FAI-57
**CHAMPAIGN, DOUGLAS, MCLEAN

MODEL: I:\MODEL\MAME
FILE NAME: P:\pub\mtoom\mtoom\dot\Documents\DOT_Office\District_5\Projects\0570F64\CAD\DOT\CAD\Faces\0570F64\PL-Location_Map.rvt

USER NAME = plersonbr	DESIGNED -	REVISED -
	DRAWN -	REVISED -
PLOT SCALE = 40,0000 */ in.	CHECKED -	REVISED -
PLOT DATE = 6/22/2021	DATE -	REVISED -

STATE OF ILLINOIS
DEPARTMENT OF TRANSPORTATION

LOCATION #1
DOUGLAS COUNTY

SCALE: SHEET 1 OF 3 SHEETS STA. TO STA.

F.A. RTE.	SECTION	COUNTY	TOTAL SHEETS	SHEET NO.
-	HSIP 2021-1	**	14	3
			CONTRACT NO. 70F64	
ILLINOIS FED. AID PROJECT				

LOCATION MAP - CHAMPAIGN COUNTY

LOCATION MAP #2

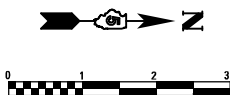

SOUTH BOUND REST AREA
STA 151+08 TO STA 124+00

NORTH BOUND REST AREA
STA 184+10 TO 214+00

SN 010-0198 (NB) / 0199 (SB)
STA 118+50

STATION EQUATION
STA 945+52.78 (BK) =
STA 104+50.00 (AH)

STATION EQUATION
STA 881+68.05 (BK) =
STA 881+68.75 (AH)

DOUGLAS / CHAMPAIGN
COUNTY LINE
STA 848+62.49

SN 010-0009 (NB) / 0010 (SB)
STA 456+43.07

SN 010-0103
STA 403+34.43

STATION EQUATION
STA 373+56.20 (BK) =
STA 373+62.04 (AH)

SN 010-0006 (NB) / 0005 (SB)
STA 362+47.00

SN 010-0272
STA 297+20.45

SN 010-0105 STA 244+06.15
URBAN LIMITS BEGIN / RURAL LIMITS END

SN 010-0128
STA 136+57.00

STATION EQUATION
STA 526+63.25 (BK) =
STA 83+43.82 (AH)

SN 010-0002 (NB) / 0001 (SB)
STA 397+59.81

STA 961+34
URBAN LIMITS BEGIN
RURAL LIMITS END

SN 010-0185
STA 765+63.45

STATION EQUATION
STA 764+96.99 (BK) =
STA 765+00.00 (AH)

STA 694+44
URBAN LIMITS END
RURAL LIMITS BEGIN

SN 010-0254
STA 650+71.03

SN 010-0018 / 0019
STA 597+78.22

SN 010-0034 / 0035
STA 481+41.98

SN 010-0013 (NB)
STA 1274+42.94 TO 1276+42.86

SN 010-0012 (SB)
STA 1274+49.09 TO 1276+49.01

SN 010-0164
STA 1235+45.33

SN 010-0165
STA 1128+67.19

SN 010-0156
STA 1016+78.72

STATION EQUATION
STA 966+67.89 (BK)
STA 966+67.62 (AH)

PROJECT ENDS
NB STA 1649+71.37
SB STA 1649+86.00

STATION EQUATION
STA 1502+40.24 (BK) =
STA 1502+35.17 (AH)

SN 010-0192 (SB)
STA 1314+85.15 TO 1316+37.26

SN 010-0191 (NB)
STA 1315+08.34 TO 1316+65.58

STA 1292+92
URBAN LIMITS END
RURAL LIMITS BEGIN

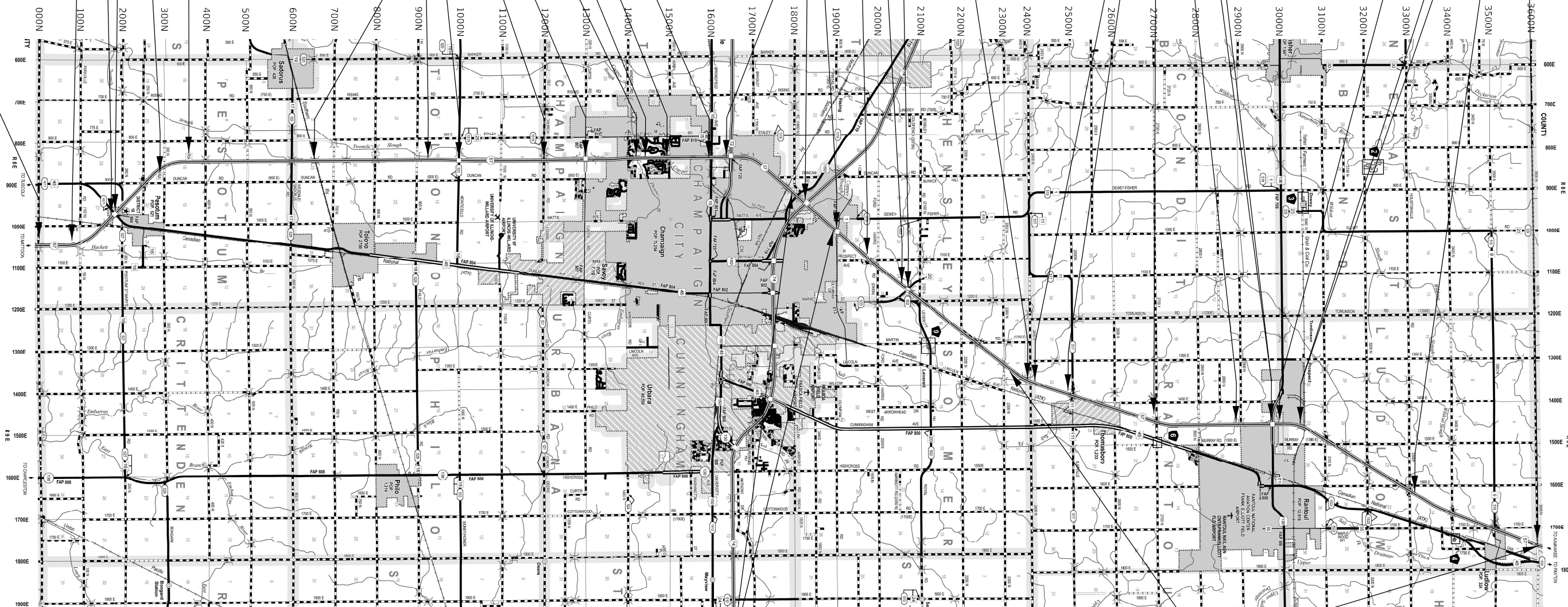

GROSS LENGTH 208,541 FT = 39.50 MILES
NET LENGTH 123,539 FT = 23.40 MILES

OMISSION LIMITS:
STA. 545+00 TO STA. 648+00.00

OMISSION LIMITS:
STA. 902+84.00 TO STA. 1649+86.00

*FAI-55 & FAI-57
**CHAMPAIGN, DOUGLAS, MCLEAN

STATE OF ILLINOIS
DEPARTMENT OF TRANSPORTATION

LOCATION #2
CHAMPAIGN COUNTY

SCALE: SHEET 2 OF 3 SHEETS STA. TO STA.

F.A. RTE.	SECTION	COUNTY	TOTAL SHEETS	SHEET NO.
-	HSIP 2021-1	**	14	4
CONTRACT NO. 70F64				
ILLINOIS FED. AID PROJECT				

MODEL: \\MODEL\NAME: FILE: NAME: P:\pub\mcomon.dwg PROJECT: D:\57064\CHAMPAIGN\CAD\PROJECTS\57064\PLT-Location_Maps.dwg

SUMMARY OF QUANTITIES

LOCATION OF WORK ROUTES COUNTIES FUNDING BREAK OUT	LOCATION 1 FAI - 57 DOUGLAS 90% FED 10 % STATE RURAL 0021	LOCATION 2 FAI - 57 CHAMPAIGN 90% FED 10 % STATE RURAL 0021	LOCATION 2 FAI - 57 CHAMPAIGN 90% FED 10 % STATE URBAN 0021	LOCATION 3 FAI - 55 MCLEAN 90% FED 10 % STATE URBAN 0021
---	---	---	---	--

CONSTRUCTION TYPE CODE

CODE NO	PAY ITEM	UNIT	TOTAL QUANTITY				
67100100	MOBILIZATION	L SUM	1	0.3	0.3	0.1	0.3
78008330	POLYUREA PAVEMENT MARKING TYPE II - LINE 6"	FOOT	1,046,481	367,360	368,138	191,302	119,681
78008340	POLYUREA PAVEMENT MARKING TYPE II - LINE 8"	FOOT	41,977	6,431	16,241	9,541	9,764
78300202	PAVEMENT MARKING REMOVAL - WATER BLASTING	SQ FT	10,763				10,763
X0320100	GROOVING FOR RECESSED PAVEMENT MARKING 10"	FOOT	22,577				22,577
X2700025	PREFORMED PLASTIC PAVEMENT MARKING, TYPE D - LINE 9"	FOOT	22,577				22,577
X7830074	GROOVING FOR RECESSED PAVEMENT MARKING 7"	FOOT	1,046,481	367,360	368,138	191,302	119,681
X7830076	GROOVING FOR RECESSED PAVEMENT MARKING 9"	FOOT	9,764				9,764

MODEL: \\MODEL\MAR\FE
 FILE NAME: \\p1414m\com\dot.illinois.gov\PIWDOT\Documents\DOT_Offices\District 5\Projects\0570F64\CADD\BIB\CADD\FreeCS\0570F64_rpt_S00.dgn

*FAI-55 & FAI-57
 **CHAMPAIGN, DOUGLAS, MCLEAN

USER NAME = plersonbr	DESIGNED -	REVISED -	STATE OF ILLINOIS DEPARTMENT OF TRANSPORTATION	SUMMARY OF QUANTITIES				F.A. RTE.	SECTION	COUNTY	TOTAL SHEETS	SHEET NO.
	DRAWN -	REVISED -		SCALE: NONE	SHEET	OF	SHEETS	STA.	TO STA.	**	14	6
PLOT SCALE = 40,0000 * / in.	CHECKED -	REVISED -		CONTRACT NO. 70F64								
PLOT DATE = 6/23/2021	DATE -	REVISED -		ILLINOIS FED. AID PROJECT								

PAVEMENT MARKING SCHEDULE

STATION	TO	STATION	LENGTH	POLYUREA PAVEMENT MARKING LINE TYPE II - LINE 6" YELLOW	POLYUREA PAVEMENT MARKING LINE TYPE II - LINE 6" YELLOW	POLYUREA PAVEMENT MARKING LINE TYPE II - LINE 6" WHITE	POLYUREA PAVEMENT MARKING LINE TYPE II - LINE 6" WHITE	POLYUREA PAVEMENT MARKING LINE TYPE II - LINE 6" WHITE-SKIP	POLYUREA PAVEMENT MARKING LINE TYPE II - LINE 6" WHITE-SKIP	POLYUREA PAVEMENT MARKING LINE TYPE II - LINE 8" WHITE	POLYUREA PAVEMENT MARKING LINE TYPE II - LINE 8" WHITE	GROOVING FOR RECESSED PAVEMENT MARKING 7"	GROOVING FOR RECESSED PAVEMENT MARKING 7"	
				FOOT	FOOT	FOOT	FOOT	FOOT	FOOT	FOOT	FOOT	FOOT	FOOT	FOOT
				(78008330)	(78008330)	(78008330)	(78008330)	(78008330)	(78008330)	(78008340)	(78008340)	X7830074	X7830074	
				RURAL	URBAN	RURAL	URBAN	RURAL	URBAN	RURAL	URBAN	RURAL	URBAN	
RAMPS (RURAL)														
TUSCOLA NB OFF RAMP (M.L.)														
529+15.00		534+46.00	531.00											
TUSCOLA NB OFF RAMP C														
200+00.00		218+19.00	1,819.00	1,373.83		2,350.00				781.00		3,723.83		
TUSCOLA NB ON RAMP D														
300+00.00		320+11.00	2,011.00	1,429.60		2,011.00				1,020.00		3,440.6		
TUSCOLA SB OFF RAMP (M.L.)														
524+70.00		528+35.17	365.17											
TUSCOLA SB OFF RAMP B														
100+00.00		118+24.69	1,824.69	1,360.14		2,189.86				815.00		3,550.00		
TUSCOLA SB ON RAMP A														
00+00.00		29+61.49	2,961.49	2,388.64		2,961.49				1,005.00		5,350.13		
STR (RURAL)														
STR 021-0009 NB														
528+33.59		530+77.40	243.81						60.95			60.95		
STR 021-0009 SB														
528+35.17		530+78.85	243.68						60.92			60.92		
STR 021-0008 NB														
552+92.12		556+91.12	399.00						99.75			99.75		
STR 021-0009 SB														
552+92.12		556+91.12	399.00						99.75			99.75		
STR 021-0010 NB														
560+45.13		563+05.65	260.52						65.13			65.13		
STR 021-0011 SB														
560+95.13		563+55.29	260.16						65.04			65.04		
STR 021-0043 (NB & SB)														
686+68.32		689+46.05	277.73						138.86			138.86		
STR 021-0034 (NB & SB)														
791+67.85		794+42.85	275.00						137.50			137.50		
SUBTOTAL			11,871.25	6,552.21		9,512.35			727.91		3,621.00	16,792.46		
DOUGLAS COUNTY TOTALS				184,206.48		182,018.39			1,135.04		6,431.00	367,358.89		
TOTAL						367,360.00					6,431.00			

MODEL: \\MODEL\MARF5
 FILE NAME: \\p14\m1\com\dot\illinois\gov\PIWDOT\Documents\IDOT_Offices\Bartlett_3\Projects\0570F64\CAD\03\03\CAD\Faces\0570F64.rpt-Schedule.dgn

*FAI-55 & FAI-57
 **CHAMPAIGN, DOUGLAS, MCLEAN

USER NAME = plersonbr	DESIGNED -	REVISED -
	DRAWN -	REVISED -
PLOT SCALE = 40,0000 * / in.	CHECKED -	REVISED -
PLOT DATE = 6/23/2021	DATE -	REVISED -

**STATE OF ILLINOIS
 DEPARTMENT OF TRANSPORTATION**

SCHEDULE OF QUANTITIES

SCALE: NONE SHEET 2 OF 7 SHEETS STA. TO STA.

F.A. RTE.	SECTION	COUNTY	TOTAL SHEETS	SHEET NO.
-	HSIP 2021-1	**	14	8
CONTRACT NO. 70F64				
ILLINOIS		FED. AID PROJECT		

PAVEMENT MARKING SCHEDULE

STATION	TO	STATION	LENGTH	POLYUREA	POLYUREA	POLYUREA	POLYUREA	POLYUREA	POLYUREA	POLYUREA	POLYUREA	GROOVING	GROOVING
				PAVEMENT	PAVEMENT	PAVEMENT	PAVEMENT	PAVEMENT	PAVEMENT	PAVEMENT	FOR	FOR	
				MARKING	MARKING	MARKING	MARKING	MARKING	MARKING	MARKING	RECESSED	RECESSED	
				LINE TYPE II -	LINE TYPE II -	LINE TYPE II -	LINE TYPE II -	LINE TYPE II -	LINE TYPE II -	LINE TYPE II -	PAVEMENT	PAVEMENT	
YELLOW	YELLOW	WHITE	WHITE	WHITE-SKIP	WHITE-SKIP	WHITE	MARKING 7"	MARKING 7"					
FOOT	FOOT	FOOT	FOOT	FOOT	FOOT	FOOT	FOOT	FOOT					
(78008330)	(78008330)	(78008330)	(78008330)	(78008330)	(78008330)	(78008340)	(78008340)	X7830074	X7830074				
RURAL	URBAN	RURAL	URBAN	RURAL	URBAN	RURAL	URBAN	RURAL	URBAN				
I-57 MAINLINE													
DOUGLAS / CHAMPAIGN CO LINE													
MP 217.66													
CHAMPAIGN COUNTY													
848+62.49		881+68.05	3,305.56	6,611.12		6,611.12						13,222.24	
STATION EQUATION													
881+68.75		945+52.78	6,384.03	12,768.06		12,768.06						25,536.12	
STATION EQUATION													
104+50.00		350+00.00	24,550.00	49,100.00		42,839.44						91,939.44	
RAMPS (RURAL)													
PESOTUM NB OFF RAMP BD													
00+00.00		06+72.59	672.59										
STATION EQUATION													
46+72.59		55+48.22	875.63	825.62		1,548.22			780.00			2,373.84	
PESOTUM NB ON RAMP DA													
61+00.00		70+30.30	930.30										
STATION EQUATION													
00+00.00		09+49.95	949.95	872.61		1,880.25			552.00			2,752.86	
PESOTUM SB OFF RAMP AC													
00+00.00		15+48.22	1,548.22	895.11		1,548.22			723.00			2,443.33	
PESOTUM SB ON RAMP CB													
20+00.00		30+44.39	1,044.39										
STATION EQUATION													
00+00.00		09+49.95	949.95	714.97		1,994.34			841.00			2,709.31	
STR (RURAL)													
STR 021-0200 NB													
937+96.63		943+38.50	541.87					135.47				135.47	
STR 021-0201 SB													
937+30.00		942+70.80	540.80					135.20				135.20	
STR 021-0198 NB													
117+31.11		118+57.87	126.76					31.69				31.69	
STR 021-0199 SB													
117+38.84		118+65.60	126.76					31.69				31.69	
STR 021-0145 NB													
168+50.79		171+25.79	275.00					68.75				68.75	
STR 021-0145 SB													
169+44.19		171+19.19	175.00					43.75				43.75	
RAMPS (RURAL)													
NB REST AREA OFF RAMP													
184+27.52		194+90.00	1,062.48	377.88		1,062.48			780.00			1,440.36	
NB REST AREA ON RAMP													
205+50.00		220+83.13	1,533.13	590.49		1,533.13			552.00			2,123.62	
SB REST AREA OFF RAMP													
155+00.00		144+37.00	1,063.00	367.89		1,063.00			723.00			1,430.89	
SB REST AREA ON RAMP													
132+50.00		118+75.85	1,374.15	287.78		1,374.15			841.00			1,661.93	
STR (RURAL)													
STR 021-0181 (NB & SB)													
257+43.32		260+18.32	275.00					137.50				137.50	
SUBTOTAL													
			48,304.57	73,411.53		74,222.41		584.05		5,792.00		148,218.00	

MODEL: I:\MODEL\MARKS
 FILE: MARKS_PAVEMENT\CHAMPAIGN\DOT\Office\Drawings\Project\057066\CAD\Process\057066\PAVEMENT\PAVEMENT_Schedule.dgn

*FAI-55 & FAI-57
 **CHAMPAIGN, DOUGLAS, MCLEAN

USER NAME = plersonbr	DESIGNED -	REVISED -
	DRAWN -	REVISED -
PLOT SCALE = 40,0000 * 1/ in.	CHECKED -	REVISED -
PLOT DATE = 6/22/2021	DATE -	REVISED -

**STATE OF ILLINOIS
 DEPARTMENT OF TRANSPORTATION**

SCHEDULE OF QUANTITIES

SCALE: NONE SHEET 3 OF 7 SHEETS STA. TO STA.

F.A. RTE.	SECTION	COUNTY	TOTAL SHEETS	SHEET NO.
-	HSIP 2021-1	**	14	9
CONTRACT NO. 70F64				
ILLINOIS FED. AID PROJECT				

PAVEMENT MARKING SCHEDULE

STATION	TO	STATION	LENGTH	POLYUREA PAVEMENT MARKING LINE TYPE II - LINE 6" YELLOW	POLYUREA PAVEMENT MARKING LINE TYPE II - LINE 6" YELLOW	POLYUREA PAVEMENT MARKING LINE TYPE II - LINE 6" WHITE	POLYUREA PAVEMENT MARKING LINE TYPE II - LINE 6" WHITE	POLYUREA PAVEMENT MARKING LINE TYPE II - LINE 6" WHITE-SKIP	POLYUREA PAVEMENT MARKING LINE TYPE II - LINE 6" WHITE-SKIP	POLYUREA PAVEMENT MARKING LINE TYPE II - LINE 8" WHITE	POLYUREA PAVEMENT MARKING LINE TYPE II - LINE 8" WHITE	GROOVING FOR RECESSED PAVEMENT MARKING 7"	GROOVING FOR RECESSED PAVEMENT MARKING 7"
				FOOT	FOOT	FOOT	FOOT	FOOT	FOOT	FOOT	FOOT	FOOT	FOOT
				(78008330)	(78008330)	(78008330)	(78008330)	(78008330)	(78008330)	(78008340)	(78008340)	X7830074	X7830074
				RURAL	URBAN	RURAL	URBAN	RURAL	URBAN	RURAL	URBAN	RURAL	URBAN
MP 224.13 TO MP 236.22													
350+00.00		526+63.25	17,663.25	35,326.50		32,097.73						67,424.23	
STATION EQUATION													
83+43.82		244+06.15	16,062.33	32,124.66		32,124.66						64,249.32	
URBAN LIMITS BEGIN / RURAL LIMITS END													
244+06.15		545+00.00	30,093.85		60,187.70		58,769.99						118,957.7
RAMPS (RURAL)													
NB MONTECELLO RD OFF RAMP 1-A													
00+00.00		19+58.14	1,958.14	1,550.59		1,958.14				715.00		3,508.73	
NB MONTECELLO RD ON RAMP 1-D													
21+93.49		00+00.00	2,193.49	1,857.19		2,193.49				590.00		4,050.68	
SB MONTECELLO RD OFF RAMP 1-C													
00+00.00		19+59.44	1,959.44	1,527.38		1,959.44				758.00		3,486.82	
SB MONTECELLO RD ON RAMP 1-B													
21+93.34		00+00.00	2,193.34	1,858.18		2,193.34				588.00		4,051.52	
STR (RURAL)													
STR 010-0124 (NB & SB)													
365+29.97		369+89.97	460.00					230.00				230.00	
STR 010-0002 NB													
396+67.15		398+70.60	203.45					50.86				50.86	
STR 010-0001 SB													
396+45.88		398+49.27	203.39					50.85				50.86	
RAMPS (URBAN)													
NB CURTIS RD OFF RAMP B													
05+00.00		27+81.35	2,281.35		1,829.91		2,281.35			792.00		4,111.26	
NB CURTIS RD ON RAMP A													
37+06.40		10+00.00	2,706.40		2,141.53		2,706.40			991.00		4,847.93	
NB CURTIS RD OFF RAMP D													
20+00.00		42+84.06	2,284.06		1,875.94		2,284.06			716.00		4,160.0	
NB CURTIS RD ON RAMP C													
57+07.95		30+00.00	2,707.95		2,253.09		2,707.95			798.00		4,961.04	
NB I-72 OFF RAMP G													
00+00.00		06+62.40	662.40										
STATION EQUATION													
206+62.40		222+76.00	1,613.60		1,942.55		2,276.00			585.00		4,218.55	
NB I-72 ON RAMP B													
32+64.00		47+98.99	1,534.99		1,357.72		1,534.99			311.00		2,892.71	
NB I-72 OFF RAMP C													
60+00.00		71+14.00	1,114.00		874.60		874.60			420.00		1,749.20	
NB I-72 ON RAMP H													
247+88.00		262+71.58	1,483.58										
STATION EQUATION													
00+00.00		09+48.34	948.34		2,054.58		2,431.92			662.00		4,486.50	
SB I-72 OFF RAMP E													
00+00.00		06+64.32	664.32										
STATION EQUATION													
126+62.40		140+84.00	1,421.60		1,800.92		2,085.92			500.00		3,886.84	
SB I-72 ON RAMP D													
92+62.00		107+98.14	1,536.14		1,381.10		1,536.14			272.00		2,917.24	
SB I-72 OFF RAMP A													
00+00.00		11+13.00	1,113.00		1,004.70		1,113.00			190.00		2,117.70	
SB I-72 ON RAMP F													
167+24.00		182+71.63	1,547.63										
STATION EQUATION													
00+00.00		09+50.24	950.24		2,497.87		2,497.87			700.00		4,995.75	
SUBTOTAL													
			97,560.28	74,244.50	81,202.21	72,526.80	83,100.19	331.71		2,651.00	6,937.00	147,103.00	164,302.40

*FAI-55 & FAI-57
**CHAMPAIGN, DOUGLAS, MCLEAN

MODEL: I:\MODEL\NAME FILE: NAME: PROJECT: I:\PROJECTS\0570F64\CAD\DATA\CAD\FRCS\0570F64.rpt-Schedule.dgn

USER NAME = plersonbr	DESIGNED -	REVISED -
	DRAWN -	REVISED -
PLOT SCALE = 40,0000 * / in.	CHECKED -	REVISED -
PLOT DATE = 6/22/2021	DATE -	REVISED -

**STATE OF ILLINOIS
DEPARTMENT OF TRANSPORTATION**

SCHEDULE OF QUANTITIES

SCALE: NONE SHEET 4 OF 7 SHEETS STA. TO STA.

F.A. RTE.	SECTION	COUNTY	TOTAL SHEETS	SHEET NO.
-	HSIP 2021-1	**	14	10
CONTRACT NO. 70F64				
		ILLINOIS	FED. AID PROJECT	

PAVEMENT MARKING SCHEDULE

STATION	TO	STATION	LENGTH	POLYUREA PAVEMENT MARKING LINE TYPE II - LINE 6" YELLOW	POLYUREA PAVEMENT MARKING LINE TYPE II - LINE 6" YELLOW	POLYUREA PAVEMENT MARKING LINE TYPE II - LINE 6" WHITE	POLYUREA PAVEMENT MARKING LINE TYPE II - LINE 6" WHITE	POLYUREA PAVEMENT MARKING LINE TYPE II - LINE 6" WHITE-SKIP	POLYUREA PAVEMENT MARKING LINE TYPE II - LINE 6" WHITE-SKIP	POLYUREA PAVEMENT MARKING LINE TYPE II - LINE 8" WHITE	POLYUREA PAVEMENT MARKING LINE TYPE II - LINE 8" WHITE	GROOVING FOR RECESSED PAVEMENT MARKING 7"	GROOVING FOR RECESSED PAVEMENT MARKING 7"
				FOOT	FOOT	FOOT	FOOT	FOOT	FOOT	FOOT	FOOT	FOOT	FOOT
				(78008330)	(78008330)	(78008330)	(78008330)	(78008330)	(78008330)	(78008340)	(78008340)	X7830074	X7830074
				RURAL	URBAN	RURAL	URBAN	RURAL	URBAN	RURAL	URBAN	RURAL	URBAN
STR (URBAN)													
STR 010-0291 NB													
349+09.96		351+59.96	250.00						62.50				62.50
STR 010-0005 SB													
361+38.88		363+11.88	173.00						43.25				43.25
STR 010-0006 NB													
361+71.14		363+39.44	168.30						42.08				42.08
STR 010-0007 SB													
399+46.19		401+02.65	156.46						39.11				39.11
STR 010-0008 NB													
399+65.37		401+21.95	156.58						39.14				39.14
STR 010-0103 SB													
402+09.43		404+59.43	250.00						62.50				62.50
STR 010-0109 NB													
452+91.69		458+53.85	562.16						140.54				140.54
STR 010-0110 SB													
452+92.93		458+56.10	563.17						140.79				140.79
STR 010-0034 / 010-0035 NB													
480+16.98		482+66.98	250.00						125.00				125.00
SUBTOTAL			2,529.67						694.92				694.92

MODEL: \\MODEL\NAME
 FILE NAME: \\P\ADMIN\COMMON\DOT\ILLINOIS\DOT\Documents\DOT_Office\Drawings\Projects\0570F64\CADD\03\03\CAD\Process\0570F64-01-Schedule.dgn

*FAI-55 & FAI-57
 **CHAMPAIGN, DOUGLAS, MCLEAN

USER NAME = plersonbr	DESIGNED -	REVISED -
	DRAWN -	REVISED -
PLOT SCALE = 40,0000 * / in.	CHECKED -	REVISED -
PLOT DATE = 6/22/2021	DATE -	REVISED -

**STATE OF ILLINOIS
DEPARTMENT OF TRANSPORTATION**

SCHEDULE OF QUANTITIES

SCALE: NONE SHEET 5 OF 7 SHEETS STA. TO STA.

F.A. RTE.	SECTION	COUNTY	TOTAL SHEETS	SHEET NO.
-	HSIP 2021-1	**	14	11
CONTRACT NO. 70F64				
		ILLINOIS	FED. AID PROJECT	

PAVEMENT MARKING SCHEDULE

STATION	TO	STATION	LENGTH	POLYUREA PAVEMENT MARKING LINE TYPE II - LINE 6" YELLOW	POLYUREA PAVEMENT MARKING LINE TYPE II - LINE 6" YELLOW	POLYUREA PAVEMENT MARKING LINE TYPE II - LINE 6" WHITE	POLYUREA PAVEMENT MARKING LINE TYPE II - LINE 6" WHITE	POLYUREA PAVEMENT MARKING LINE TYPE II - LINE 6" WHITE-SKIP	POLYUREA PAVEMENT MARKING LINE TYPE II - LINE 6" WHITE-SKIP	POLYUREA PAVEMENT MARKING LINE TYPE II - LINE 8" WHITE	POLYUREA PAVEMENT MARKING LINE TYPE II - LINE 8" WHITE	GROOVING FOR RECESSED PAVEMENT MARKING 7"	GROOVING FOR RECESSED PAVEMENT MARKING 7"	
				FOOT	FOOT	FOOT	FOOT	FOOT	FOOT	FOOT	FOOT	FOOT	FOOT	FOOT
				(78008330)	(78008330)	(78008330)	(78008330)	(78008330)	(78008330)	(78008340)	(78008340)	X7830074	X7830074	
				RURAL	URBAN	RURAL	URBAN	RURAL	URBAN	RURAL	URBAN	RURAL	URBAN	
MP 237.9 (EXIT 238 OLYMPIAN DR.) TO NB MP 243.05 / SB MP 243.35														
637+51.03		694+44.00	5,692.97		5,692.97		8,279.94							
URBAN LIMITS END / RURAL LIMITS BEGIN														
694+44.00		764+96.99	7,052.99	7,052.99		14,105.98						21,158.97		
STATION EQUATION														
765+00.00		902+84.00	13,784.00	13,784.00		24,500.00						38,284.00		
RAMPS (URBAN)														
NB OLYMPIAN DR. OFF RAMP B														
07+00.00		24+90.00	1,790.00	1,295.81		1,790.00				867.00		3,085.81		
NB OLYMPIAN DR. ON RAMP A														
10+88.00		27+48.09	1,660.09	1,371.10		1,660.09				507.00		3,031.19		
SB OLYMPIAN DR. OFF RAMP D														
27+48.09		10+40.00	1,708.09	1,306.81		1,708.09				704.00		3,014.90		
SB OLYMPIAN DR. ON RAMP C														
27+50.00		10+00.00	1,750.00	1,450.18		1,750.00				526.00		3,200.18		
RAMPS (RURAL)														
NB MARKET ST OFF RAMP A														
00+00.00		09+00.00	900.00											
STATION EQUATION														
310+00.00		317+71.58	771.58	1,229.83		1,671.58				775.00		2,901.41		
NB MARKET ST ON RAMP B														
320+00.00		333+61.36	1,361.36											
STATION EQUATION														
00+00.00		08+50.00	850.00	1,927.50		2,211.36				498.00		4,138.86		
SB MARKET ST OFF RAMP C														
00+00.00		06+62.40	662.40											
STATION EQUATION														
366+62.40		376+52.19	989.79	1,236.09		1,652.19				730.00		2,888.28		
SB MARKET ST ON RAMP D														
380+00.00		390+22.97	1,022.97											
STATION EQUATION														
00+00.00		08+40.00	840.00	1,581.96		1,862.97				493.00		3,444.93		
SUBTOTAL														
			40,836.24	26,812.37	11,116.87	46,004.08	15,188.12			2,496.00	2,604.00	72,816.45	26,304.99	
EST. TOTAL FOR SECTION (RURAL)				174,468.40		192,753.30				16,241.00	9,541.00			
EST. TOTAL FOR SECTION (URBAN)					92,319.08		98,288.31							

MODEL: \\MODEL\MARF5
 FILE NAME: \\p14\m1\com\dot\illinois\gov\PIWDOT\Documents\IDOT_Offices\Bartlett_3\Projects\0570F64\CD\Drawings\CD\Process\0570F64_rpt_Schedule.dgn

*FAI-55 & FAI-57
 **CHAMPAIGN, DOUGLAS, MCLEAN

USER NAME = plersonbr	DESIGNED -	REVISED -
	DRAWN -	REVISED -
PLOT SCALE = 40,0000 * / in.	CHECKED -	REVISED -
PLOT DATE = 6/22/2021	DATE -	REVISED -

**STATE OF ILLINOIS
 DEPARTMENT OF TRANSPORTATION**

SCHEDULE OF QUANTITIES

SCALE: NONE SHEET 6 OF 7 SHEETS STA. TO STA.

F.A. RTE.	SECTION	COUNTY	TOTAL SHEETS	SHEET NO.
-	HSIP 2021-1	**	14	12
CONTRACT NO. 70F64				
ILLINOIS FED. AID PROJECT				

PAVEMENT MARKING SCHEDULE

STATION	TO	STATION	LENGTH	POLYUREA PAVEMENT MARKING LINE TYPE II LINE 6" YELLOW	POLYUREA PAVEMENT MARKING LINE TYPE II LINE 6" WHITE	POLYUREA PAVEMENT MARKING LINE TYPE II LINE 8" WHITE	PREFORMED PLASTIC PAVEMENT MARKING TYPE D LINE 9" WHITE - SKIP	PAVEMENT MARKING REMOVAL WATER BLASTING	GROOVING FOR RECESSED PAVEMENT MARKING 7"	GROOVING FOR RECESSED PAVEMENT MARKING 10"	GROOVING FOR RECESSED PAVEMENT MARKING 9" WHITE	
							*					
				FOOT (78008330) URBAN	FOOT (78008330) URBAN	FOOT (78008340) URBAN	FOOT (X2700025) URBAN	SF (78300202) URBAN	FOOT (X7830074) URBAN	FOOT (X0320100) URBAN	FOOT (X7830076) URBAN	
I- 55 MAIN LINE												
20+37.79		237+52.00	21,715	43,430	43,430		21,715	10,763	86,860	21,715		
I-39 RAMPS												
SW LOOP NB						498					498	
US ROUTE 51												
I-55 NB RAMP TO US 51 SB						295					295	
I-55 NB RAMP TO US 51 NB						480					480	
US 51 RAMP TO I-55 NB						426					426	
SB US 51 RAMP SB 55						2270					2270	
SB SHORT SKIP DASH							288			288		
NB SHORT SKIP DASH							574			574		
VETERANS PARKWAY RAMPS												
SB-55 TO VET				2326	1535	1115			3861		1115	
SB-55 FROM VET NB				1384	3431	990			4815		990	
SB-55 I-55 FROM SB VET				4789	2723	1037			7512		1037	
NB I-55 TO SB VET				2602	1936	800			4538		800	
NB I-55 FROM SB VET				1607	3625	970			5232		970	
NB I-55 FROM NB VET				2572	4291	883			6863		883	
TOTAL FOR MCLEAN COUNTY				58,710	60,971	9,764	22,577	10,763	119,681	22,577	9,764	
				119,681								

* ALL SKIP DASH LINES ARE TO BE CONTRAST TAPE

MODEL: \\MODEL\MARF5
FILE NAME: \\p141m\com\dot\illinois.gov\PIWIDOT\Documents\IDOT_Office\Bartlett_3\Projects\0570F64\CADD\BIB\CAD\FreeCAD\FreeCAD\Project\0570F64_rpt_Schedule.dgn

*FAI-55 & FAI-57
**CHAMPAIGN, DOUGLAS, MCLEAN

USER NAME = plersonbr	DESIGNED -	REVISED -
	DRAWN -	REVISED -
PLOT SCALE = 40,0000 * / in.	CHECKED -	REVISED -
PLOT DATE = 6/22/2021	DATE -	REVISED -

**STATE OF ILLINOIS
DEPARTMENT OF TRANSPORTATION**

SCHEDULE OF QUANTITIES

SCALE: NONE SHEET 7 OF 7 SHEETS STA. TO STA.

F.A. RTE.	SECTION	COUNTY	TOTAL SHEETS	SHEET NO.
-	HSIP 2021-1	**	14	13
CONTRACT NO. 70F64				
ILLINOIS		FED. AID PROJECT		

