

STATE OF ILLINOIS
DEPARTMENT OF TRANSPORTATION

Benchmark : Benchmark #1 - cut "□" in top of northwest wingall.
Assumed Elevation = 100.00'

Existing Structure: S.N. 016-2514 built in 1978 as a single span 27"x36" PPC Deck Beam bridge with 2" bituminous wearing surface on closed abutments on spread footings. The structure measures 59'-6" back to back abutments and 87'-5" out to out deck. Bridge was rehabilitated in 2004 with partial beam replacement. Traffic is to be maintained utilizing stage construction. One lane for each direction shall be provided.

Salvage: None

STATION 495+60.00
REBUILT 20_ _ BY
STATE OF ILLINOIS
F.A.U. ROUTE 1320 SEC 581B-1
LOADING HL-93
STRUCTURE NO. 016-2514

NAME PLATE
See Std. 515001

LOADING HL-93

Allow 50 psf for future wearing surface

DESIGN SPECIFICATIONS

2007 AASHTO LRFD 4th Edition

DESIGN STRESSES

FIELD UNITS

f'c = 3,500 psi
f'c = 5000 psi (Concrete Wearing Surface)
fy = 60000 psi (Reinforcement)

PRECAST PRESTRESSED UNITS

f'c = 6000 psi
f'ci = 5000 psi
f's = 270,000 psi (1/2" ϕ low lax. strands)
f'si = 201,900 psi (1/2" ϕ low lax. strands)

SEISMIC DATA

Seismic Performance Category (SPC) = A
Bedrock acceleration coefficient (A) = .04
Site Coefficient (S) = 1.2

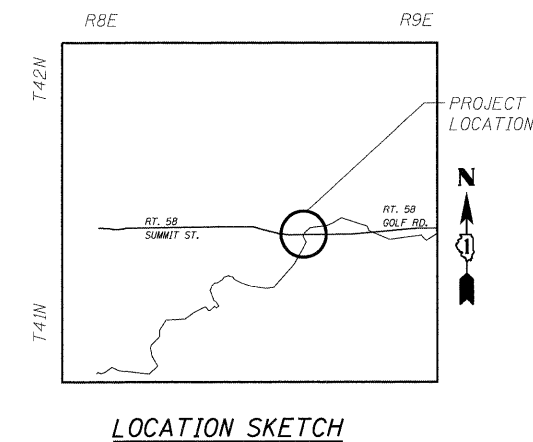
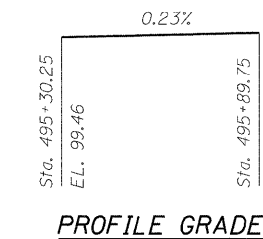
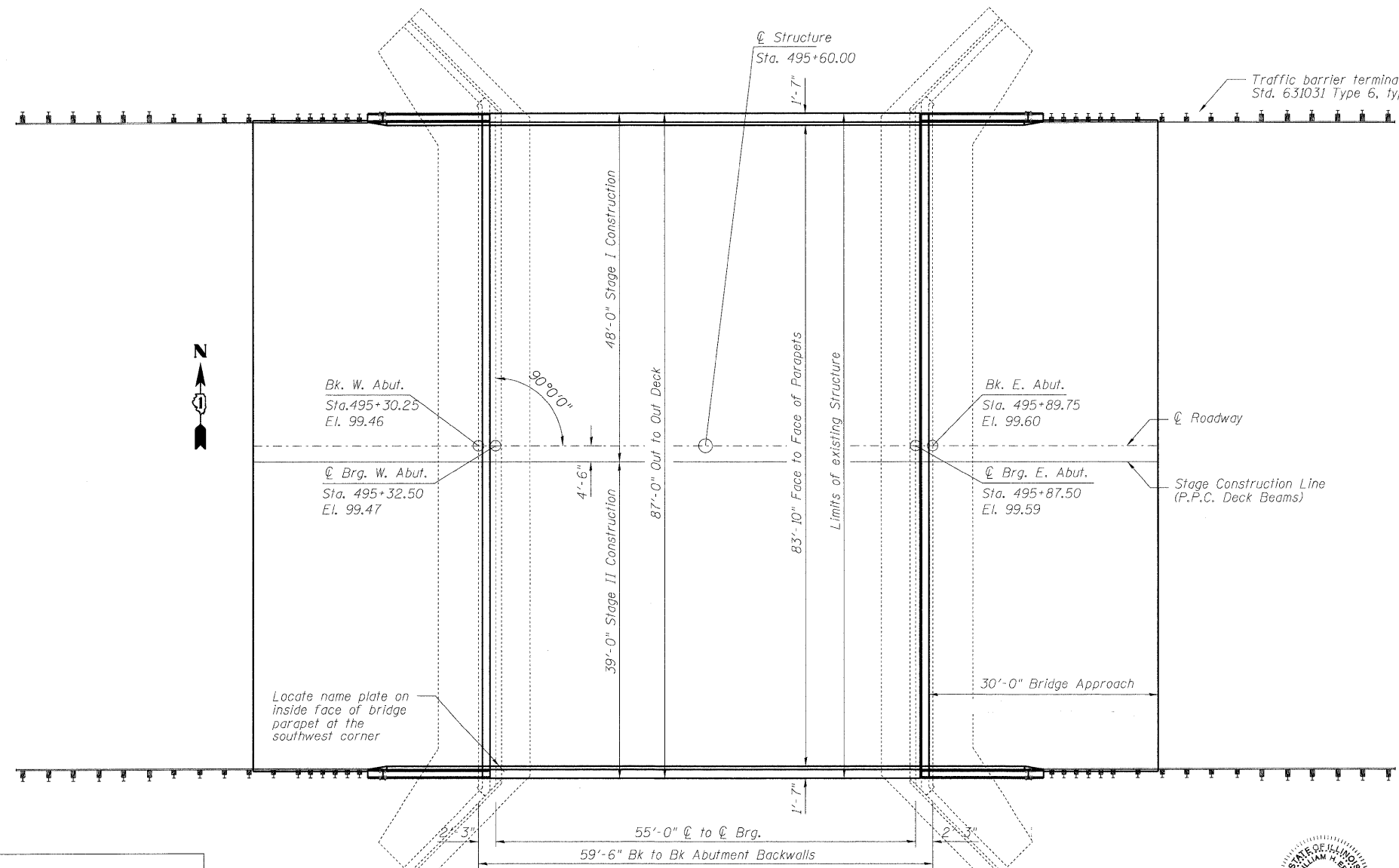
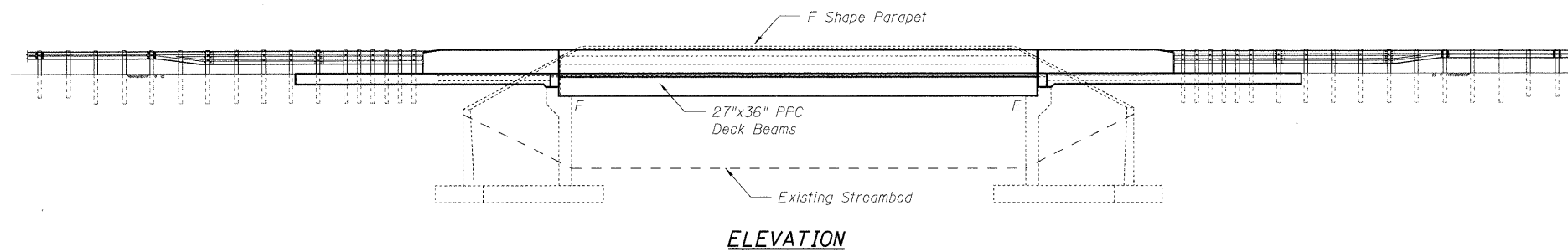

GENERAL PLAN AND ELEVATION
IL RTE 58 OVER POPLAR CREEK
F.A.U. RT. 1320
SECTION 581B-1
COOK COUNTY
STA. 495+60.00
STRUCTURE NO. 016-2514

DESIGNED	SLV
CHECKED	MJM
DRAWN	SLV
CHECKED	MJM

LONCO, INC.
CONSULTING ENGINEERS
1560 WALL ST, SUITE 222
NAPERVILLE, ILLINOIS 60563 PH: (630) 577-9100

APPROVED
FOR STRUCTURAL ADEQUACY ONLY

Ralph E. Anderson (TS) ENGINEER OF BRIDGES AND STRUCTURES

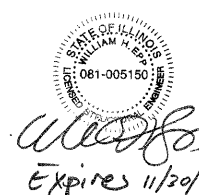

SHEET NO. S1 OF S15 SHEETS	F.A.U. RTE.	SECTION	COUNTY	TOTAL SHEETS	SHEET NO.
	1320	581 B-1	COOK	33	12
D-91-288-09			CONTRACT NO. 60F91		
FED. ROAD DIST. NO. _ ILLINOIS FED. AID PROJECT					