

TRAFFIC SIGNAL LEGEND

	PROPOSED	EXISTING
DETECTOR LOOP	□	□
SIGNAL HEAD	—	⊕
G.S. CONDUIT IN TRENCH OR PUSHED	---	---
SIGNAL HEAD WITH BACKPLATE	—	⊕
RACEWAY FOR MAGNETIC DETECTOR, TYPE I OR II	—	— "E"
VEHICLE DETECTOR, NON-COMPENSATED MAGNETIC TYPE	□	□

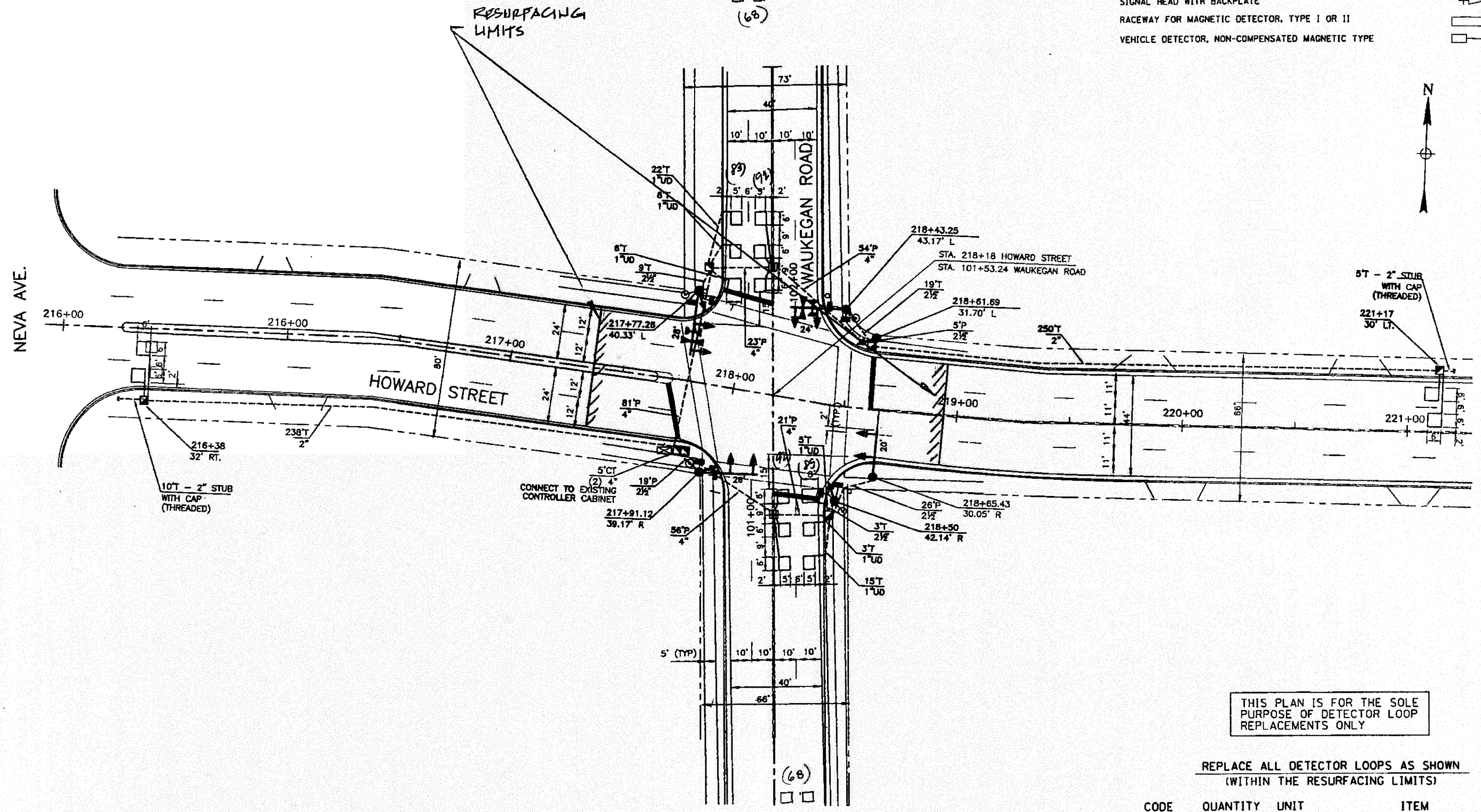

THIS PLAN IS FOR THE SOLE PURPOSE OF DETECTOR LOOP REPLACEMENTS ONLY

REPLACE ALL DETECTOR LOOPS AS SHOWN (WITHIN THE RESURFACING LIMITS)

CODE	QUANTITY	UNIT	ITEM
86600600	488	FOOT	DETECTOR LOOP, REPLACEMENT

FILE NAME	USER NAME = kanchaphisak	DESIGNED - BCK	REVISED
...	...	DRAWN - BCK	REVISED
...	...	CHECKED - DAD	REVISED
...	...	DATE	REVISED

**STATE OF ILLINOIS
DEPARTMENT OF TRANSPORTATION**

**DISTRICT ONE - DETECTOR LOOP REPLACEMENT
WAUKEGAN RD. @ HOWARD ST.**

F.A.P. RTE.	SECTION	COUNTY	TOTAL SHEETS	SHEET NO.
348	3271A-RS-3	COOK	29	14
CONTRACT NO. 60H56		CONTRACT NO.		
FED. ROAD DIST. NO.		ILLINOIS FED. AID PROJECT		