

F.A.P. RTE.	SECTION	COUNTY	TOTAL SHEETS	SHEET NO.
338	N-RS-2	LAKE	27	1
FED. ROAD DIST. NO. 1	ILLINOIS	CONTRACT NO. 60H60		

STATE OF ILLINOIS  
DEPARTMENT OF TRANSPORTATION  
DIVISION OF HIGHWAYS

**PROPOSED  
HIGHWAY PLANS**

F.A.P. ROUTE 338 /ILL 59  
ILL 22 TO LAKE-COOK ROAD  
SECTION: N-RS-2  
RESURFACING  
PROJECT: **ESP-0338(039)**  
LAKE COUNTY  
C-91-758-09

FOR INDEX OF SHEETS, SEE SHEET NO. 2

PROJECT IS LOCATED IN THE  
VILLAGE OF BARRINGTON

D-91-758-09

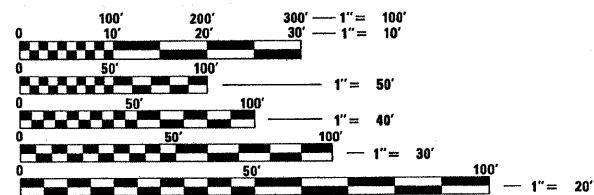
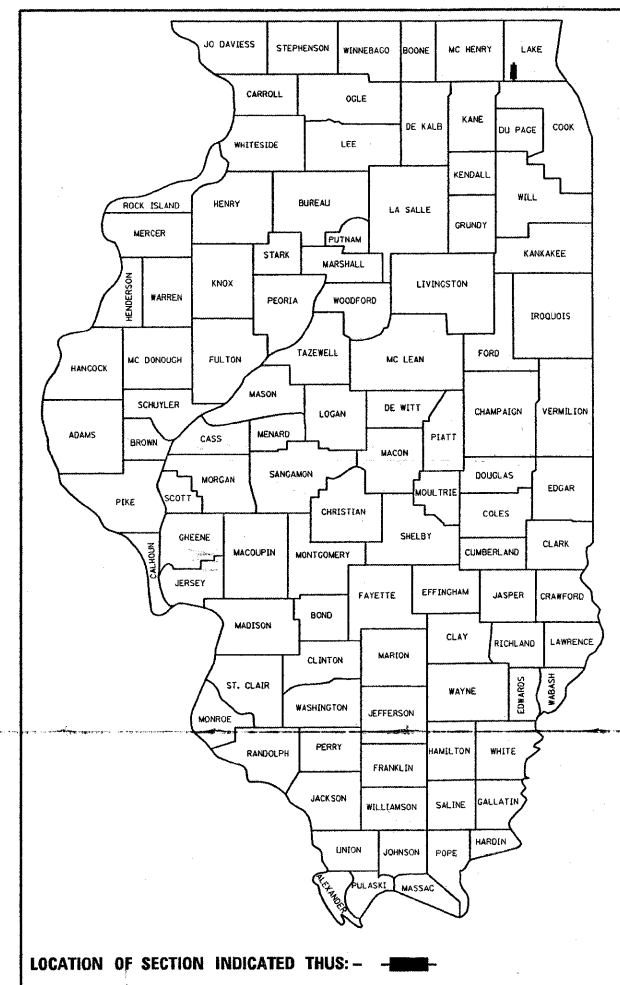

FULL SIZE PLANS HAVE BEEN PREPARED USING STANDARD ENGINEERING SCALES. REDUCED SIZED PLANS WILL NOT CONFORM TO STANDARD SCALES. IN MAKING MEASUREMENTS ON REDUCED PLANS, THE ABOVE SCALES MAY BE USED.

J.U.L.I.E.  
JOINT UTILITY LOCATION INFORMATION FOR EXCAVATION  
1-800-892-0123  
OR 811

PROJECT ENGINEER: DAN WILGREEN (847) 705-4240  
PROJECT MANAGER: KEN ENG

CONTRACT NO. 60H60

OMISSION:  
FROM STA. 20+83 TO STA. 21+09  
FROM STA. 35+24 TO STA. 35+38

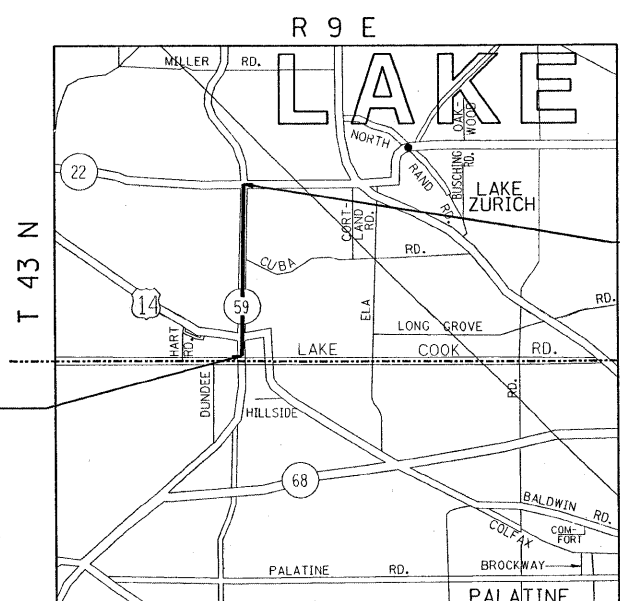

CUBA TOWNSHIP

PROJECT ENDS STA. 150+04

TRAFFIC DATA  
SPEED LIMIT: 25 MPH TO 50 MPH  
2007 ADT: 19,100

STATE OF ILLINOIS  
DEPARTMENT OF TRANSPORTATION  
DIVISION OF HIGHWAYS

SUBMITTED June 22, 20 09

*Dino D'Agostino*  
DEPUTY DIRECTOR OF HIGHWAYS, REGION ENGINEER

August 14, 20 09  
*Charles G. Ingersoll*  
ENGINEER OF DESIGN AND ENVIRONMENT

August 14, 20 09  
*Christine M. Reed*  
DIRECTOR OF HIGHWAYS, CHIEF ENGINEER

**PRINTED BY THE AUTHORITY  
OF THE STATE OF ILLINOIS**

GROSS LENGTH OF PROJECT = 13,011 FEET (2.46 MILES)  
NET LENGTH OF PROJECT = 12,971 FEET ( 2.45 MILES)