

PROPOSED HMA SURFACE REMOVAL, 2 1/4"
 PROPOSED POLYMERIZED LEVELING BINDER, (MM), IL-4.75, N50, 3/4"
 PROPOSED HMA SURFACE COURSE, MIX "D", N70, 1 1/2"

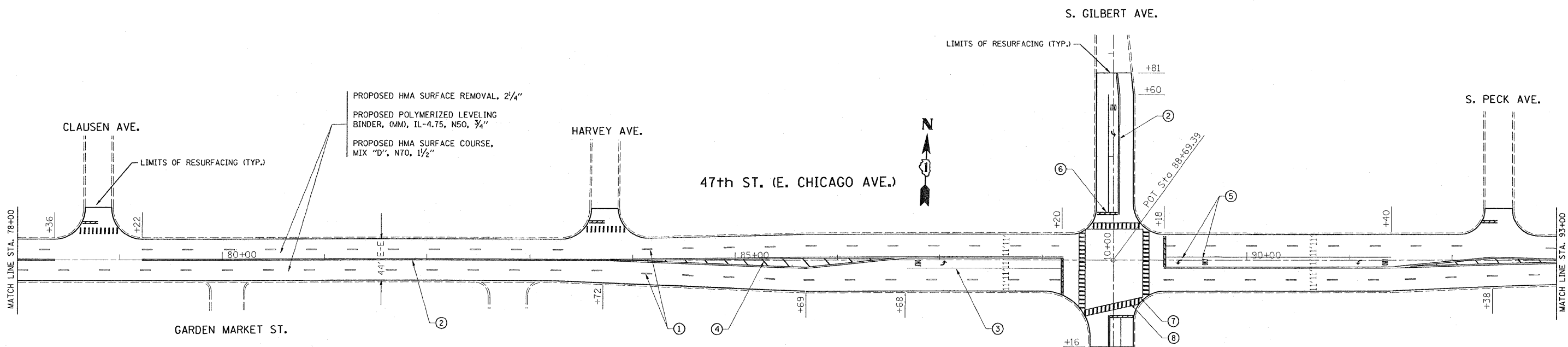

PROPOSED HMA SURFACE REMOVAL, 2 1/4"
 PROPOSED POLYMERIZED LEVELING BINDER, (MM), IL-4.75, N50, 3/4"
 PROPOSED HMA SURFACE COURSE, MIX "D", N70, 1 1/2"

LEGEND:

- ① PROPOSED THERMOPLASTIC PAVEMENT MARKING LINE 4", SKIP DASH @ 30' SKIP AND 10' DASH, WHITE (TYP.)
- ② PROPOSED THERMOPLASTIC PAVEMENT MARKING LINE 4", DOUBLE LINE @ 11" C-C, YELLOW (TYP.)
- ③ PROPOSED THERMOPLASTIC PAVEMENT MARKING LINE 6", TURN LANE, WHITE (TYP.)
- ④ PROPOSED THERMOPLASTIC PAVEMENT MARKING LINE 12", DIAGONALS @ 45°, YELLOW (TYP.)
- ⑤ PROPOSED THERMOPLASTIC PAVEMENT MARKING LETTERS AND SYMBOLS, WHITE (TYP.)
- ⑥ PROPOSED THERMOPLASTIC PAVEMENT MARKING LINE 24", STOP BAR, WHITE (TYP.)
- ⑦ PROPOSED THERMOPLASTIC PAVEMENT MARKING LINE 6", CROSSWALK @ 6' APART, WHITE (TYP.)
- ⑧ PROPOSED THERMOPLASTIC PAVEMENT MARKING LINE 12", LONGITUDINAL BARS @ 90°, 2' APART, WHITE (TYP.)
- ⑨ PROPOSED THERMOPLASTIC PAVEMENT MARKING LINE 24", TRANSVERSE LINES, RAILROAD CROSSING WHITE (TYP.)

NOTE:

ALL PERMANENT PAVEMENT MARKINGS SHALL BE THERMOPLASTIC UNLESS OTHERWISE NOTED. SEE "DISTRICT ONE TYPICAL PAVEMENT MARKINGS" DETAIL (TC-13).

RAISED REFLECTIVE PAVEMENT MARKERS SHALL BE USED THROUGH THE IMPROVEMEN LIMITS. SEE "DISTRICT ONE TYPICAL APPLICATIONS RAISED REFLECTIVE PAVEMENT MARKERS" DETAIL (TC-11).

LIMIT OF RESURFACING ON SIDE ROADS AND STREETS SHALL BE TO THE RADIUS OF RETURN UNLESS OTHERWISE NOTED OR AS DIRECTED BY THE RESIDENT ENGINEER.

FILE NAME =	USER NAME = shuranb	DESIGNED -	REVISED -	STATE OF ILLINOIS DEPARTMENT OF TRANSPORTATION	ROADWAY AND PAVEMENT MARKING PLAN 47TH STREET / DUPAGE COUNTY LINE TO EAST AVE.	F.A.U. RTE.	SECTION	COUNTY	TOTAL SHEETS	SHEET NO.	
6709-sht-plan.dgn	PLOT SCALE = 50.0000' / IN.	DRAWN -	REVISED -			1488	3212 RS-3	COOK	27	7	
PLOT DATE = 6/27/2009	DATE -	CHECKED -	REVISED -			CONTRACT NO. 60H69					
						ILLINOIS FED. AID PROJECT					