

TRAFFIC SIGNAL LEGEND

	PROPOSED	EXISTING
DETECTOR LOOP		
SIGNAL HEAD		
G.S. CONDUIT IN TRENCH OR PUSHED		
SIGNAL HEAD WITH BACKPLATE		
RACEWAY FOR MAGNETIC DETECTOR, TYPE I OR II		
VEHICLE DETECTOR, NON-COMPENSATED MAGNETIC TYPE		

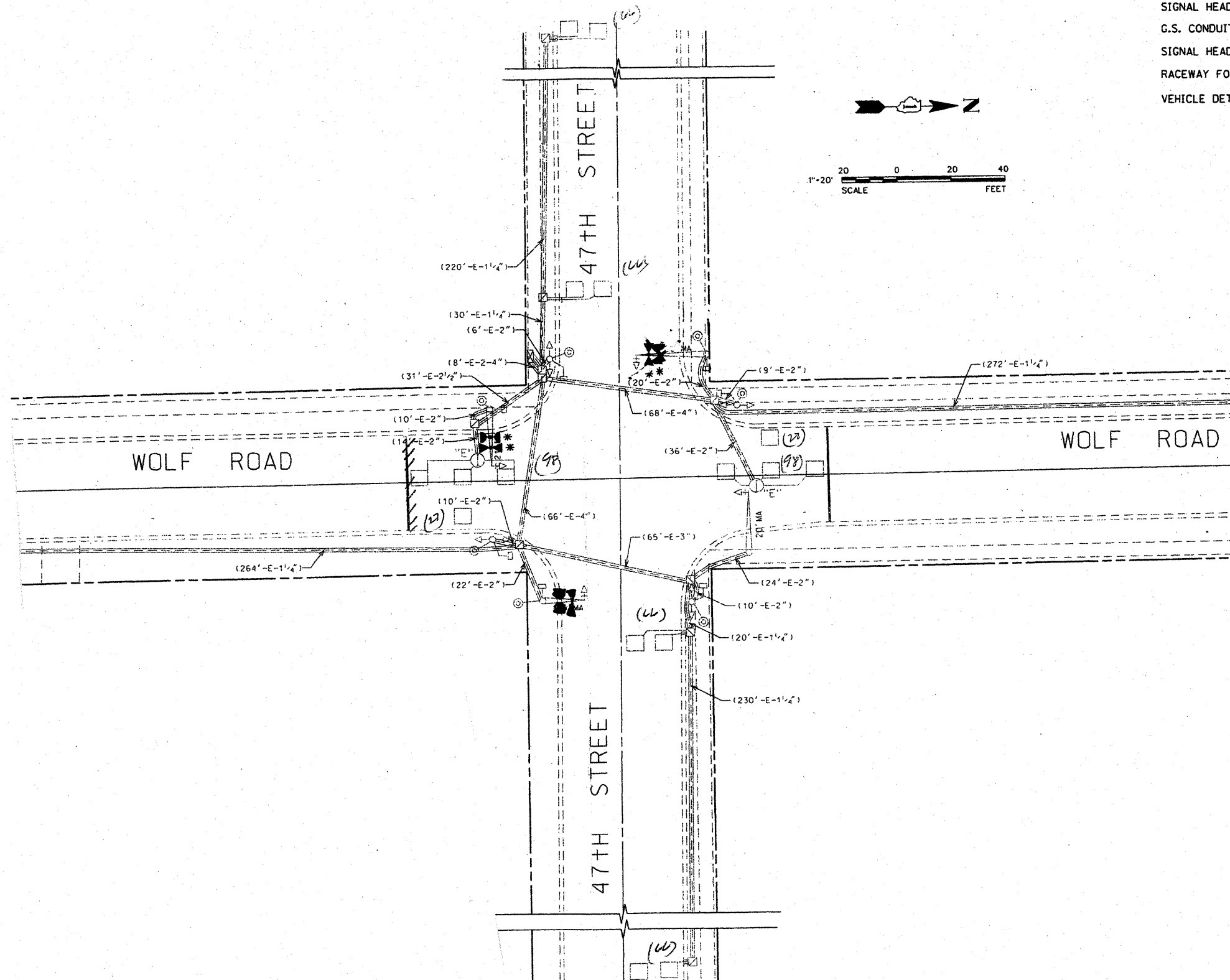
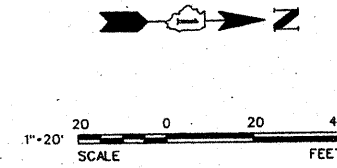

THIS PLAN IS FOR THE SOLE PURPOSE OF DETECTOR LOOP REPLACEMENTS ONLY

REPLACE ALL DETECTOR LOOPS AS SHOWN (WITHIN THE RESURFACING LIMITS)

CODE	QUANTITY	UNIT	ITEM
86600600	514	FOOT	DETECTOR LOOP, REPLACEMENT

FILE NAME =	USER NAME = kanthaphixaybc	DESIGNED - BCK	REVISED -
ci:\pwwork\pwwid\KANTHAPHIXAYBC\01126	4\tr\offic\legend_v7.dgn	DRAWN - BCK	REVISED -
	PLOT SCALE = 3/4\"/>		
	DATE -	CHECKED - DAD	REVISED -
		DATE -	REVISED -

**STATE OF ILLINOIS
DEPARTMENT OF TRANSPORTATION**

DISTRICT ONE - DETECTOR LOOP REPLACEMENT
47TH STREET @ WOLF ROAD

SCALE: NONE	SHEET NO. OF SHEETS	STA. TO STA.	F.A.U. RTE. 1488	SECTION 3212 RS-3	COUNTY Cook	TOTAL SHEETS 27	SHEET NO. 12
			FED. ROAD DIST. NO.		ILLINOIS FED. AID PROJECT		