

TRAFFIC SIGNAL LEGEND

	PROPOSED	EXISTING
DETECTOR LOOP		
SIGNAL HEAD		
G.S. CONDUIT IN TRENCH OR PUSHED		
SIGNAL HEAD WITH BACKPLATE		
RACEWAY FOR MAGNETIC DETECTOR, TYPE I OR II		
VEHICLE DETECTOR, NON-COMPENSATED MAGNETIC TYPE		

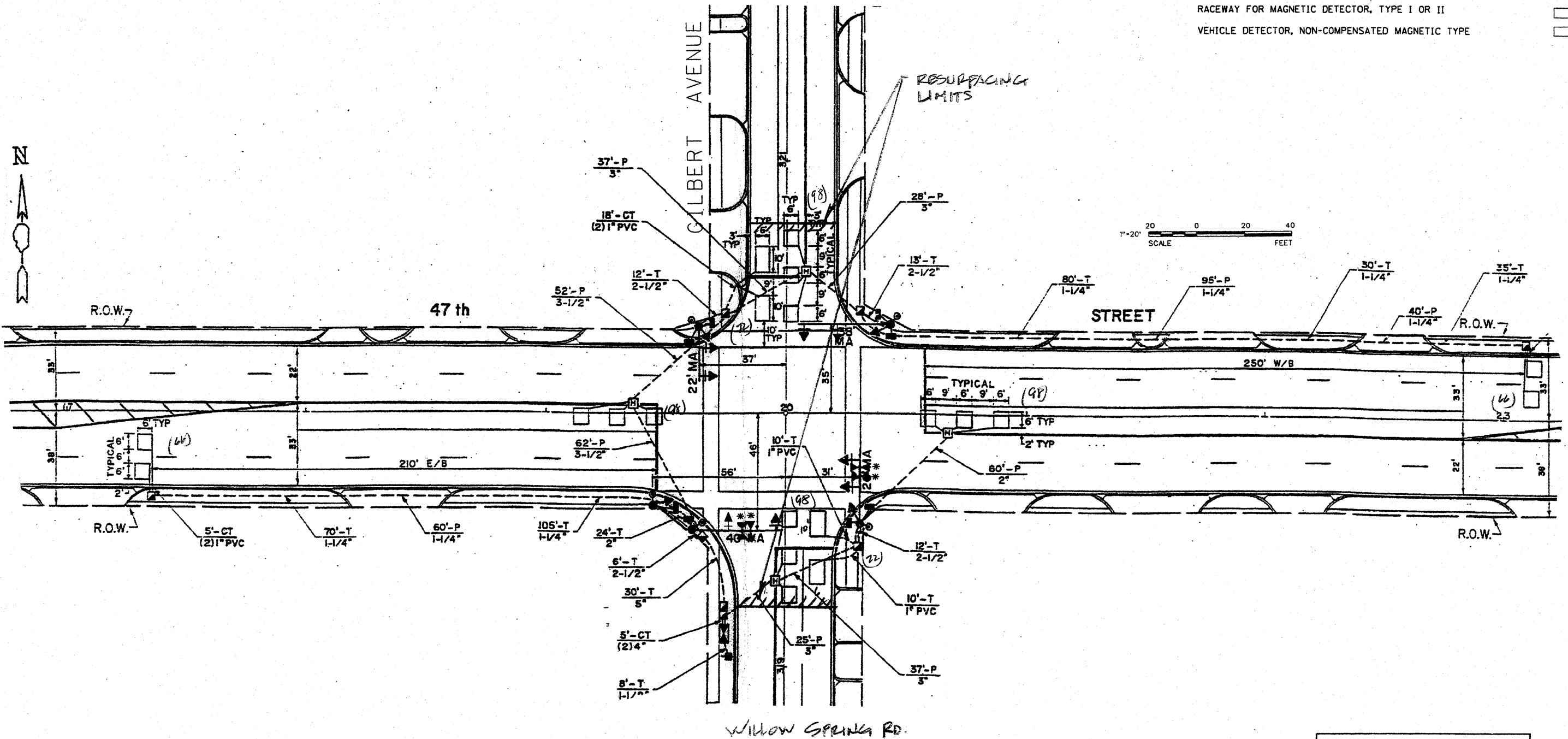

THIS PLAN IS FOR THE SOLE PURPOSE OF DETECTOR LOOP REPLACEMENTS ONLY

REPLACE ALL DETECTOR LOOPS AS SHOWN (WITHIN THE RESURFACING LIMITS)

CODE	QUANTITY	UNIT	ITEM
86600600	668	FOOT	DETECTOR LOOP, REPLACEMENT

FILE NAME = c:\pwwork\pwwid001\KANTHAPHIXAYBC\d01126	USER NAME = kanthaphixaybc 4\tr-af\fic_legend_v7.dgn	DESIGNED - BCK DRAWN - BCK	REVISED - REVISED - REVISED - REVISED -	STATE OF ILLINOIS DEPARTMENT OF TRANSPORTATION	DISTRICT ONE - DETECTOR LOOP REPLACEMENT 47TH ST @ GILBERT/WILLOW SPRING	F.A.I. RTE. 1488	SECTION 3212 RS-3	COUNTY Cook	TOTAL SHEETS 27	SHEET NO. 13
	PLOT SCALE = 3/4" = 1' IN. PLOT DATE = 4/3/2009	CHECKED - DAD DATE -	SCALE: NONE			SHEET NO. OF SHEETS STA. TO STA.	FED. ROAD DIST. NO. ILLINOIS FED. AID PROJECT	CONTRACT NO.		