

LEGEND

- | | | |
|--|---|---|
| 1 THERMOPLASTIC PAVEMENT MARKING - LINE 4" YELLOW SOLID | 5 THERMOPLASTIC PAVEMENT MARKING - LINE 6" WHITE 2' DASH, 6' SKIP | 9 THERMOPLASTIC PAVEMENT MARKING - LINE 12" WHITE @ 45 DEGREE |
| 2 THERMOPLASTIC PAVEMENT MARKING - LINE 4" WHITE SOLID | 6 THERMOPLASTIC PAVEMENT MARKING - LINE 12" YELLOW @ 45 DEGREE | 10 THERMOPLASTIC PAVEMENT MARKING - LETTERS & SYMBOLS |
| 3 THERMOPLASTIC PAVEMENT MARKING - LINE 4" YELLOW SKIP DASH - 10' DASH, 30' SKIP | 7 THERMOPLASTIC PAVEMENT MARKING - LINE 6" WHITE | 11 THERMOPLASTIC PAVEMENT MARKING - LINE 24" WHITE |
| 4 THERMOPLASTIC PAVEMENT MARKING - LINE 4" YELLOW, 2 @ 11" C-C W/2 AMBER 2 WAY RPM'S | 8 THERMOPLASTIC PAVEMENT MARKING - LINE 4" (WHITE 10' DASH, 30' SKIP W/ 2 CRYSTAL/OPAQUE RPM'S) | 12 THERMOPLASTIC PAVEMENT MARKING - LINE 8" WHITE |

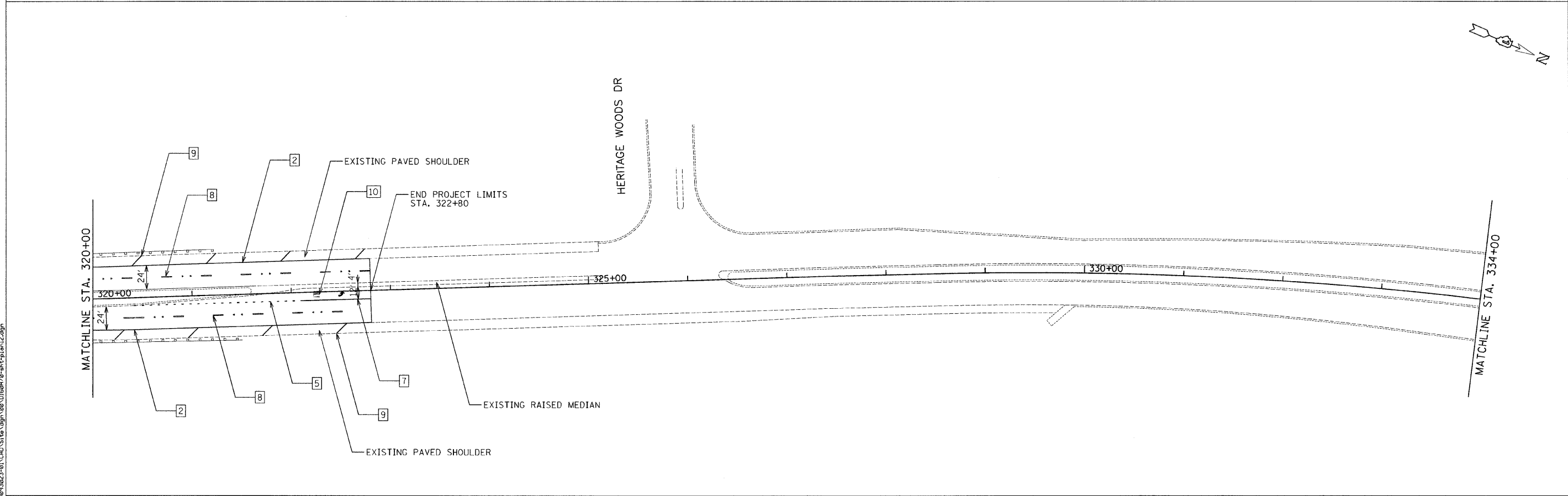

FILE NAME =	USER NAME = _USER_	DESIGNED -	REVISED -	STATE OF ILLINOIS DEPARTMENT OF TRANSPORTATION	IL 59 - IL 64 TO BATAVIA ROAD ROADWAY AND PAVEMENT MARKING PLANS	F.A.P. RTE.	SECTION	COUNTY	TOTAL SHEETS	SHEET NO.	
	PLOT SCALE = 50.0000' / IN.	CHECKED -	REVISED -			338	(111 & 112) RS-8	DUPAGE	42	19	
	PLOT DATE = 6/24/2009	DATE -	REVISED -			CONTRACT NO. 60H70					
					SCALE: 50	SHEET NO. 12 OF 13 SHEETS		STA. 306+00 TO STA. 334+00			ILLINOIS FED. AID PROJECT

H:_jobs\2009\1200913023-01\CADD\State\ dgn\108\1168476-01\p12.dgn