

**TEMPORARY CABLE PLAN LEGEND**

- R TEMPORARY TRAFFIC SIGNAL SECTION OR PEDESTRIAN SIGNAL SECTION 12'
- X TEMPORARY CONTROLLER CABINET
- + TEMPORARY SERVICE INSTALLATION
- 5 INDICATES NUMBER OF CONDUCTORS IN CABLE. ALL CONDUCTORS TO BE NUMBER 14 AWG WIRE UNLESS OTHERWISE NOTED.
- EMERGENCY VEHICLE LIGHT DETECTOR
- CONFIRMATION BEACON
- VEHICLE DETECTOR, INDUCTION LOOP
- PEDESTRIAN PUSHBUTTON DETECTOR
- PEDESTRIAN SIGNAL HEAD
- VIDEO DETECTION CAMERA
- B UNINTERRUPTIBLE POWER SUPPLY (UPS)

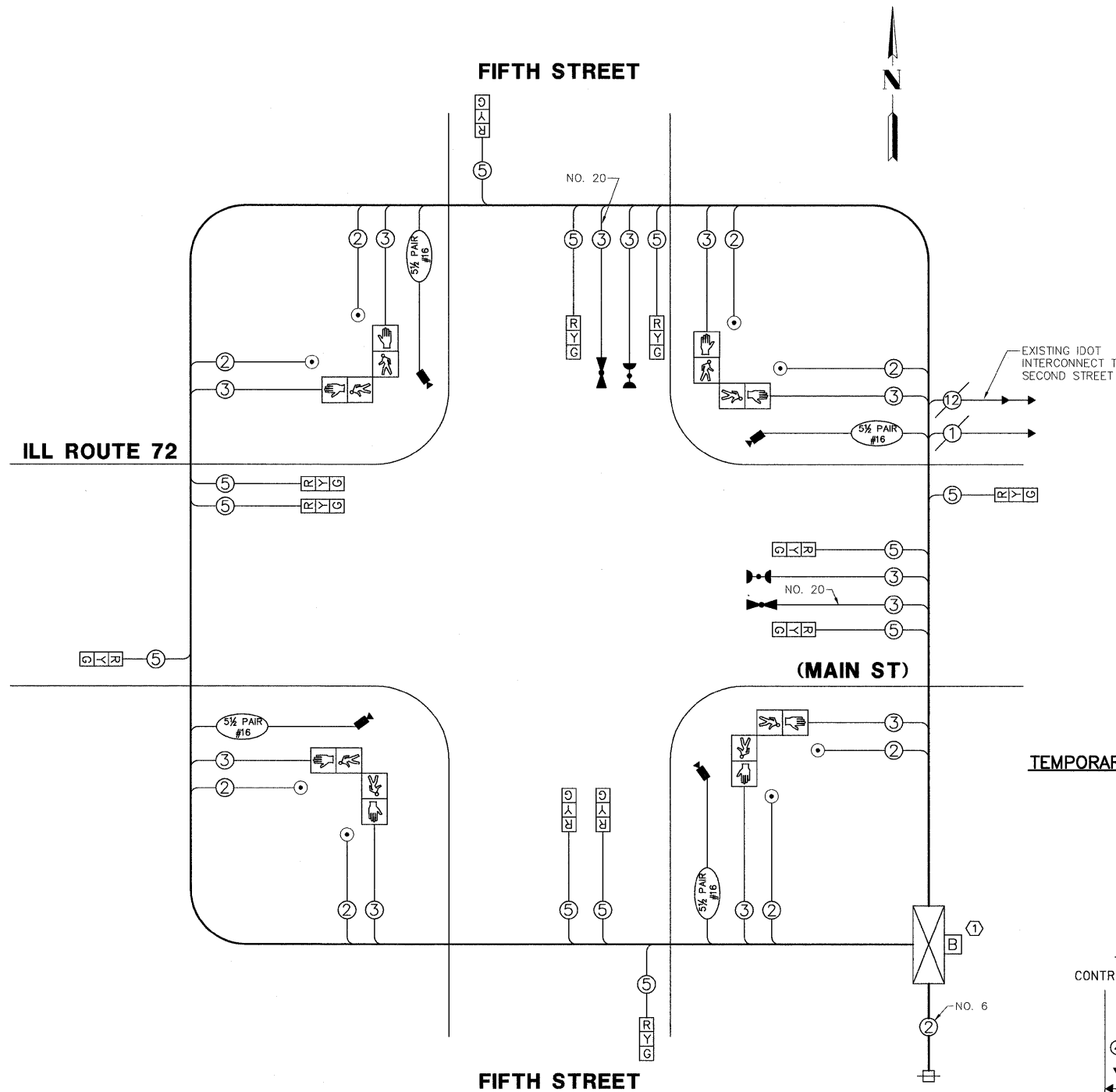

**CONSTRUCTION NOTES:**

① AN UNINTERRUPTIBLE POWER SUPPLY (UPS) SHALL BE INSTALLED WITH THE TEMPORARY CONTROLLER CABINET AND SHALL BE CONSIDERED INCIDENTAL TO THE PAY ITEM "TEMPORARY TRAFFIC SIGNAL INSTALLATION".

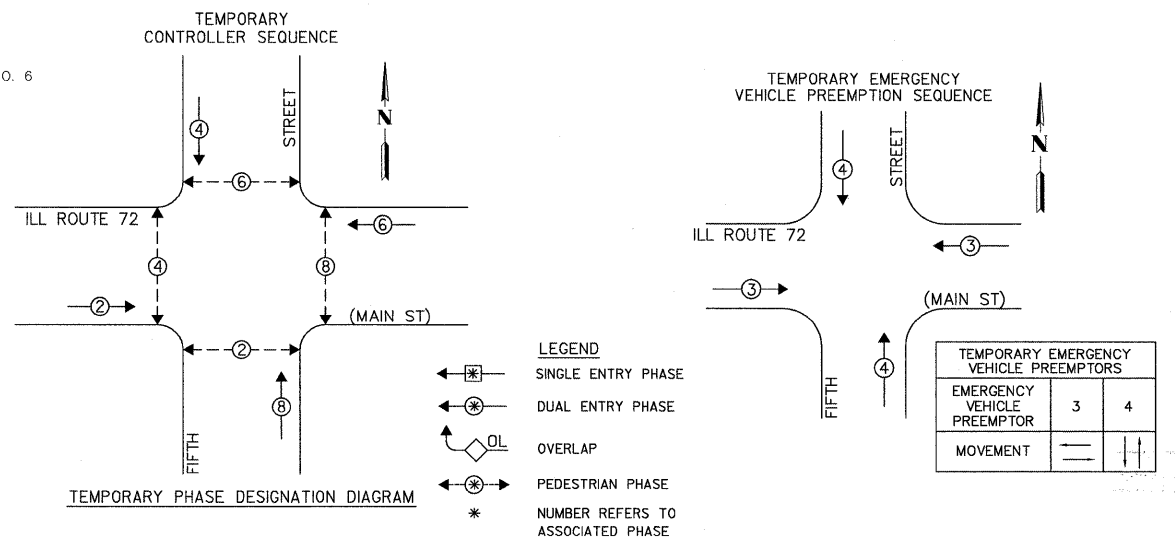

**LEGEND**

- SINGLE ENTRY PHASE
- DUAL ENTRY PHASE
- OVERLAP
- PEDESTRIAN PHASE
- NUMBER REFERS TO ASSOCIATED PHASE

TEMPORARY EMERGENCY VEHICLE PREEMPTORS	
EMERGENCY VEHICLE PREEMPTOR	3 4
MOVEMENT	—

I.D.O.T. TRAFFIC SIGNAL INSTALLATION ELECTRICAL SERVICE REQUIREMENTS					TOTAL WATTAGE
TYPE	NO LAMPS	WATTAGE INCAND.	L.E.D. % OPERATION		
SIGNAL (RED)	12	135	17	0.50	102.0
SIGNAL (YELLOW)	12	135	25	0.25	75.0
SIGNAL (GREEN)	12	135	15	0.25	45.0
ARROW	-	135	12	0.10	-
PED.SIGNAL	8	90	25	1.00	200.0
CONTROLLER	1	100	100	1.00	100.0
LUMINAIRE	-	150	250	0.50	-
L.E.D. ST. NAME SIGN	-	-	64	0.50	-
VIDEO SYSTEM	-	150	150	1.00	150.0
BATTERY BACKUP	-	-	25	1.00	25.0
TOTAL =					697.0

THE TRAFFIC SIGNAL CONTROL EQUIPMENT FOR THIS PROJECT SHALL BE "EAGLE" TO MATCH THE EXISTING ADJACENT SYSTEM.

ENERGY COSTS - BILLED TO: VILLAGE OF WEST DUNDEE  
 (ADDRESS) 702 S. 2ND STREET  
 (ADDRESS) WEST DUNDEE, IL  
 ENERGY SUPPLY - CONTACT: NEW BUSINESS  
 PHONE: 1-888-639-3552  
 COMPANY: COMED - FLGIN

FILE NAME = 4085.850-TR1.dwg	USER NAME =	DESIGNED - JRD	REVISED -
		DRAWN - PJS	REVISED -
		CHECKED - KLB	REVISED -
		DATE - 6-24-2009	REVISED -

**STATE OF ILLINOIS  
DEPARTMENT OF TRANSPORTATION**

**TEMPORARY CABLE PLAN AND TEMPORARY PHASE DESIGNATION DIAGRAM  
ILL RTE 72 (MAIN ST) AND FIFTH STREET**

F.A.P. RTE. 341	SECTION 2009-081TS	COUNTY KANE	TOTAL SHEETS 13	SHEET NO. 8
CONTRACT #:				60120
ILLINOIS FED. AID PROJECT				