

F.A. RTE.	SECTION	COUNTY	TOTAL SHEETS	SHEET NO.
2843	3249B-R	COOK	64	57
STA.		TO STA.		
FED. ROAD DIST. NO.	ILLINOIS	FED. AID PROJECT		

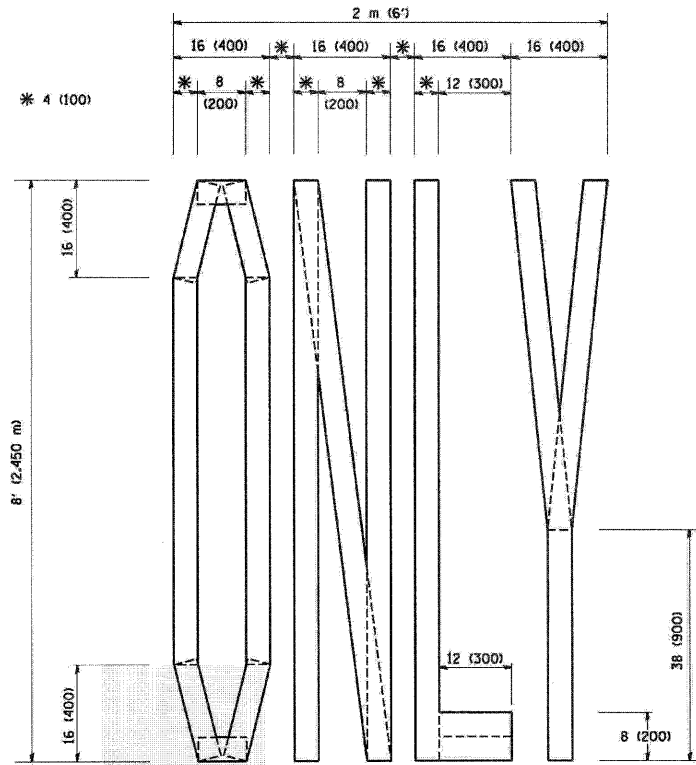

QUANTITY
 4 (100) LINE = 64.1 ft. (19.7 m)
 21.1 sq. ft. (1.97 sq. m)

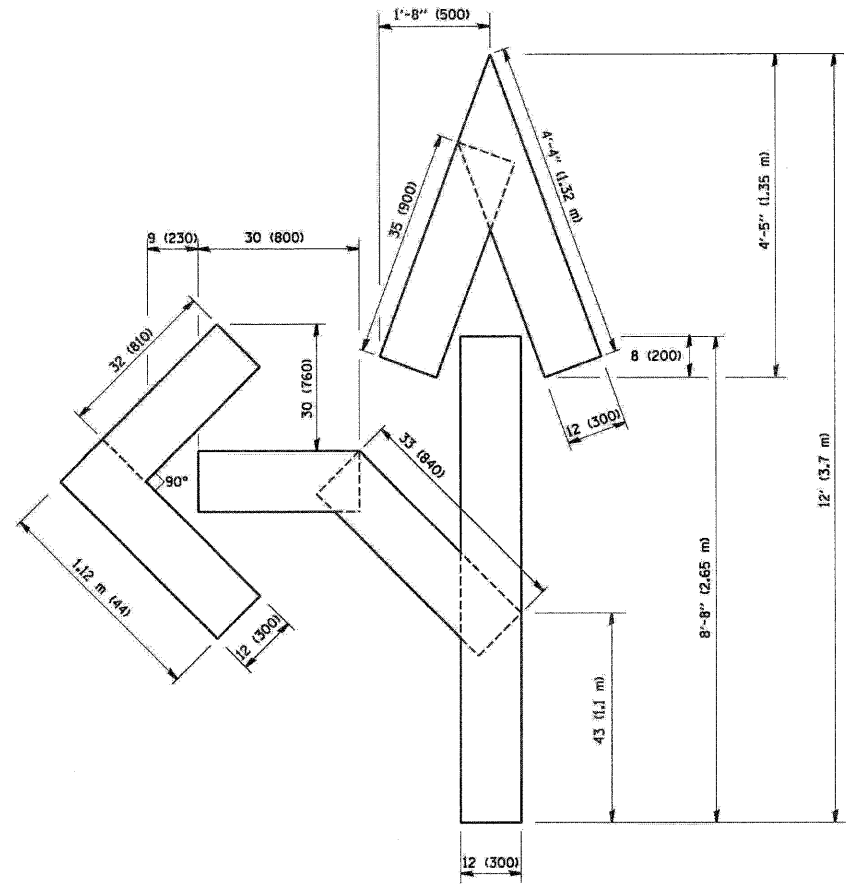

QUANTITY
 4 (100) LINE = 82.5 ft. (25.3 m)
 27.5 sq. ft. (2.53 sq. m)

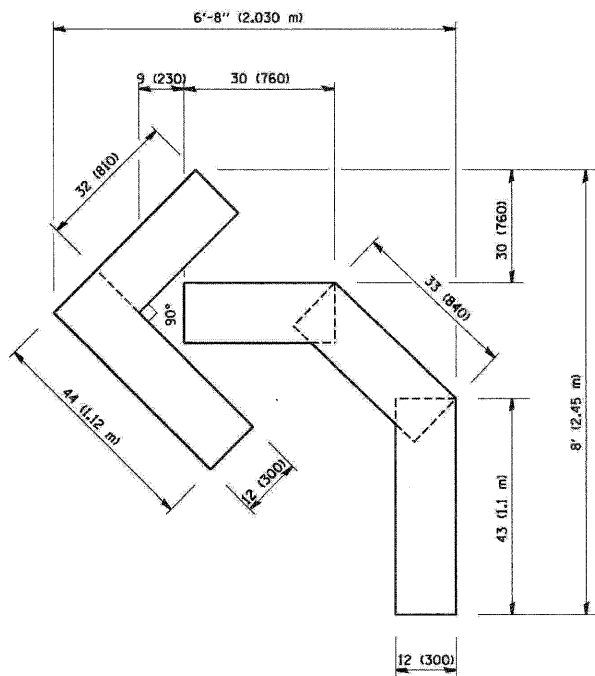

QUANTITY
 4 (100) LINE = 45.5 ft. (13.9 m)
 15.2 sq. ft. (1.39 sq. m)

All dimensions are in inches (millimeters) unless otherwise shown.

REVISIONS	
NAME	DATE
T. RAMMACHER	09/18/94
J. OBERLE	06/01/96
T. RAMMACHER	06/05/96
T. RAMMACHER	11/04/97
T. RAMMACHER	03/02/98
E. GOMEZ	08/28/00

ILLINOIS DEPARTMENT OF TRANSPORTATION
 P.A.U. 2843 DIXIE HWY over BUTTERFIELD CREEK

**PAVEMENT MARKING
 LETTERS AND SYMBOLS
 FOR TRAFFIC STAGING**

SCALE: NONE
 DRAWN BY CADD
 CHECKED BY

PLOT DATE = 3/7/2007
 FILE NAME = K:\dists\pav\sig\pdm
 PLOT SCALE = 8/8/8000 / 1/16
 USER NAME = bauerd