

F.A.U. RTE.	SECTION	COUNTY	TOTAL SHEETS	SHEET NO.
2578	532B-1	DUPAGE	117	42
STA.	TO STA.			
FED. ROAD DIST. NO.	ILLINOIS	FED. AID PROJECT		

CONTRACT # 62881

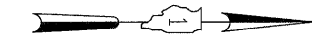

TEMPORARY TRAFFIC SIGNAL LEGEND

EXISTING	PROPOSED	
⊗	←	TEMPORARY TRAFFIC SIGNAL HEAD SPAN WIRE MOUNTED ORIGINAL LOCATION
⊗	⊗	TEMPORARY WOOD POLE (CLASS 5 OR BETTER) 60 FOOT (18.3m) MINIMUM
⊗	⊗	TEMPORARY CONTROLLER CABINET
⊗	⊗	TEMPORARY SPAN WIRE, TETHER WIRE, AND CABLE
⊗	⊗	TEMPORARY SERVICE INSTALLATION
⊗	⊗	EMERGENCY VEHICLE LIGHT DETECTOR
⊗	⊗	CONFIRMATION BEACON
⊗	⊗	G.S. CONDUIT IN GROUND
⊗	⊗	HANDHOLE
⊗	⊗	HEAVY DUTY HANDHOLE
⊗	⊗	DOUBLE HANDHOLE
⊗	⊗	VIDEO CAMERA ASSEMBLY
⊗	⊗	VEHICLE DETECTOR, INDUCTION LOOP

EXISTING EQUIPMENT TO BE REMOVED LEGEND

⊗	EXISTING SIGNAL TO BE REMOVED
⊗	EXISTING SERVICE INSTALLATION TO BE REMOVED
⊗	EXISTING CONTROLLER AND FOUNDATION TO BE REMOVED
⊗	EXISTING HANDHOLE TO BE REMOVED
⊗	EXISTING DOUBLE HANDHOLE TO BE REMOVED
⊗	EMERGENCY VEHICLE LIGHT DETECTOR TO BE REMOVED
⊗	CONFIRMATION BEACON TO BE REMOVED
⊗	EXISTING HEAVY DUTY HANDHOLE TO BE REMOVED
⊗	EXISTING WOOD POLE TO BE REMOVED

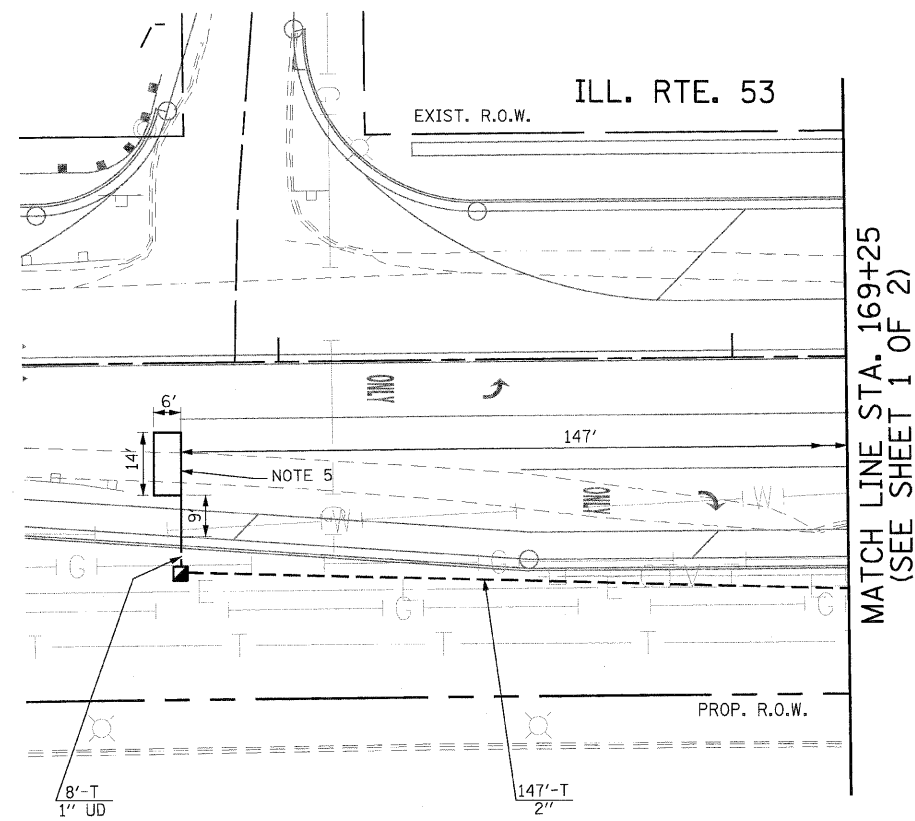

MATCH LINE STA. 169+25
(SEE SHEET 1 OF 2)

MATCH LINE STA. 173+40
(SEE SHEET 1 OF 2)

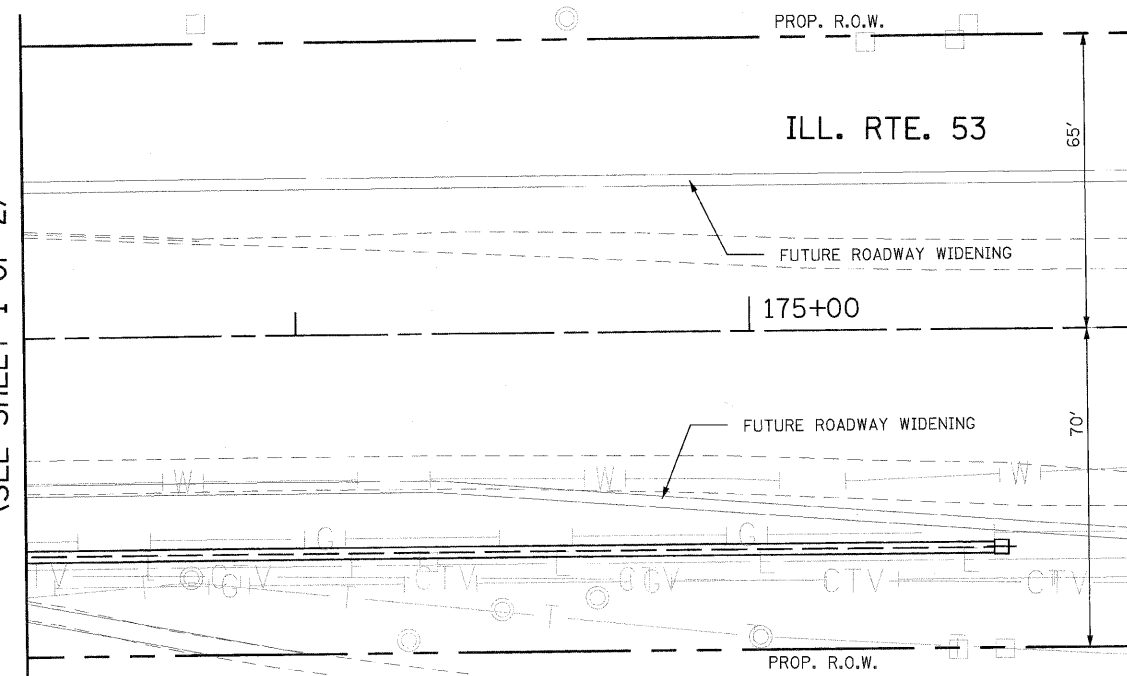

ILLINOIS DEPARTMENT OF TRANSPORTATION
 PARTIAL TEMPORARY TRAFFIC SIGNAL INSTALLATION
 REMOVE EXISTING TRAFFIC SIGNAL EQUIPMENT
 STAGE 1, STAGE 2, AND STAGE 3
 ILLINOIS ROUTE 53 AT
 SPRING LAKE DRIVE/MEDINAH DRIVE
 SHEET 2 OF 2

REVISIONS	
NAME	DATE

SCALE: 1"=20'
 DATE: 05/18/2007

DRAWN BY: KGP/RDP
 DESIGNED BY: PKG
 CHECKED BY:

GA GANDHI AND ASSOCIATES, INC.
 ENGINEERS AND PLANNERS
 6035 N. NORTHWEST HIGHWAY
 SUITE 306
 CHICAGO, ILLINOIS 60631 TEL. (773) 774-5900