

F.A. RTE.	SECTION	COUNTY	TOTAL SHEETS	SHEET NO.
1503	08-00260-01-PV	KANE	176	84
STA. 604+00		TO STA. 610+00		
FED. ROAD DIST. NO.		ILLINOIS FED. AID PROJECT		

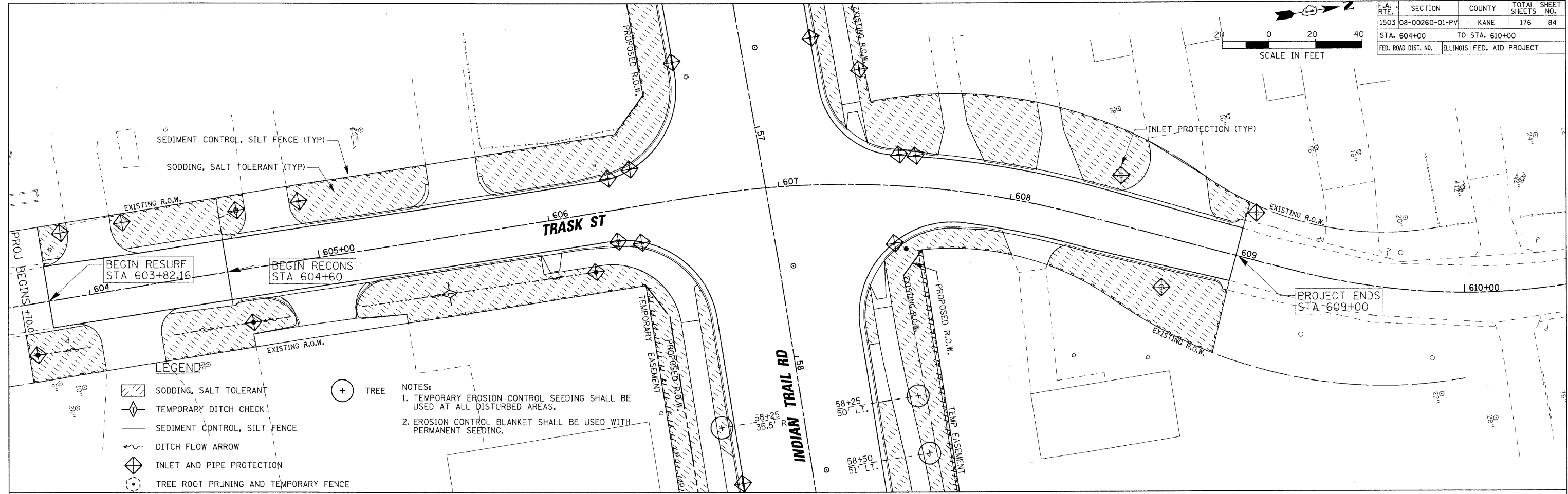
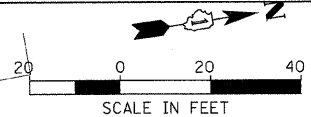

- LEGEND**
- SODDING, SALT TOLERANT
  - TEMPORARY DITCH CHECK
  - SEDIMENT CONTROL, SILT FENCE
  - DITCH FLOW ARROW
  - INLET AND PIPE PROTECTION
  - TREE ROOT PRUNING AND TEMPORARY FENCE

- NOTES:**
1. TEMPORARY EROSION CONTROL SEEDING SHALL BE USED AT ALL DISTURBED AREAS.
  2. EROSION CONTROL BLANKET SHALL BE USED WITH PERMANENT SEEDING.

PLOT DATE = 1/5/2009  
 FILE NAME = H:\Users\shasha\landerosus\_tr\_1.dgn  
 PLOT SCALE = 1"=20'  
 USER NAME = USER

REVISIONS	
NAME	DATE

ILLINOIS DEPARTMENT OF TRANSPORTATION

LANDSCAPING AND EROSION CONTROL  
 TRASK STREET  
 SHEET 5 OF 5

**RHAA**

Robert H. Anderson & Associates, Inc.  
 Consulting Engineers & Land Surveyors  
 License No. 194-005281  
 Phone No. 630-584-3530

SCALE: VERT. 1"=20'  
 HORIZ. 1"=20'  
 DATE 1/7/09

DRAWN BY TC  
 CHECKED BY TC/SBP