

PLOT DATE = 1/5/2009  
 FILE NAME = H:\Aurora\20059\_1\TPM1\Civil\SHA\MS-TR-050X  
 PLOT SCALE = 1"=40'  
 USER NAME = JUBERL

ORIGINAL SURVEY NO. \_\_\_\_\_  
 SURVEY DATE \_\_\_\_\_  
 NOTE BOOK NO. \_\_\_\_\_  
 TEMPLATE AREAS CHECKED \_\_\_\_\_

FINAL SURVEY NO. \_\_\_\_\_  
 SURVEY DATE \_\_\_\_\_  
 NOTE BOOK NO. \_\_\_\_\_  
 TEMPLATE AREAS CHECKED \_\_\_\_\_

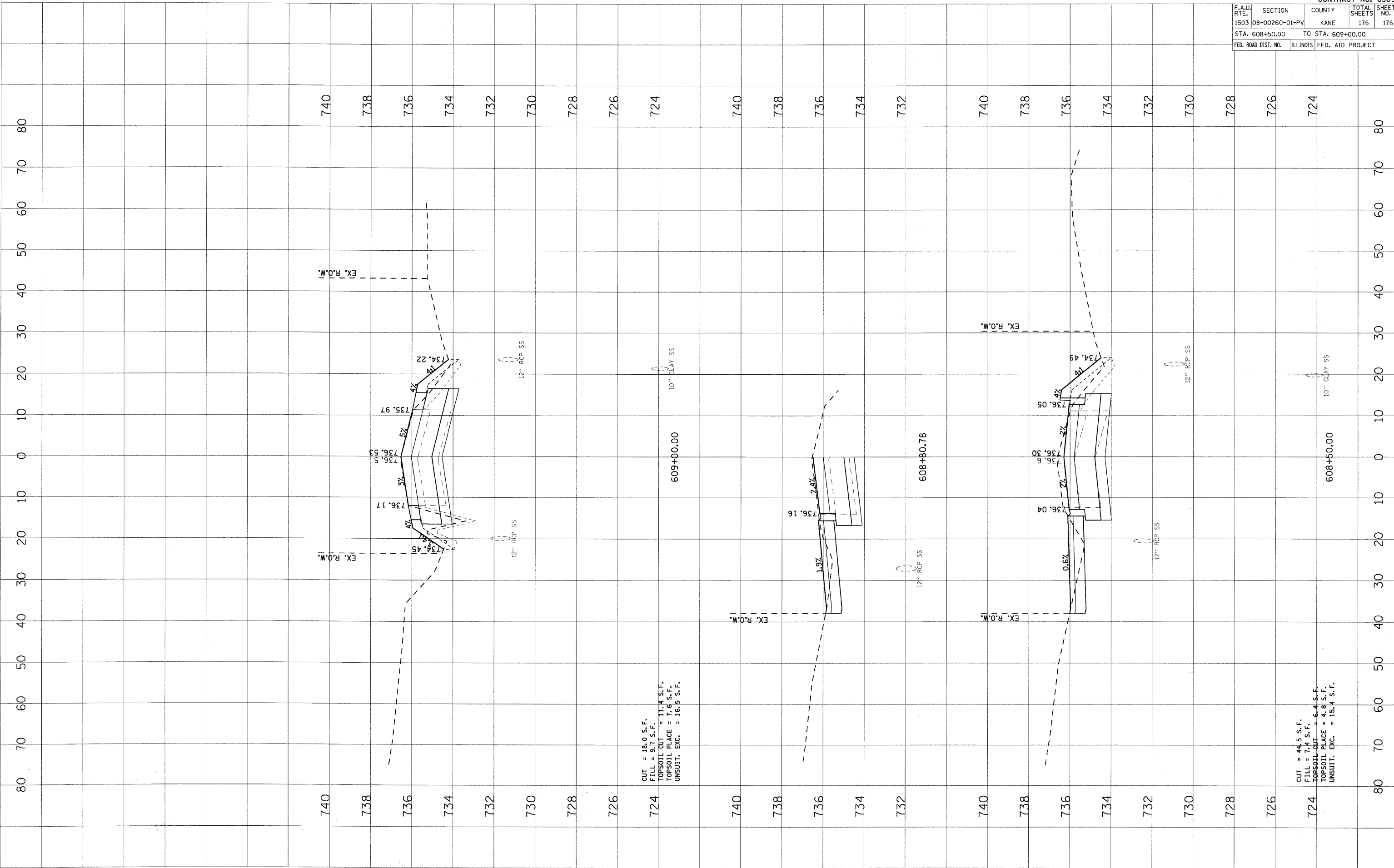

CUT = 18.0 S.F.  
 FILL = 9.7 S.F.  
 TOPSOIL CUT = 11.4 S.F.  
 TOPSOIL PLACE = 7.6 S.F.  
 UNSUIT. EXC. = 16.5 S.F.

CUT = 44.5 S.F.  
 FILL = 7.4 S.F.  
 TOPSOIL CUT = 6.4 S.F.  
 TOPSOIL PLACE = 4.8 S.F.  
 UNSUIT. EXC. = 15.4 S.F.

F.A.I.D. RTE.	SECTION	COUNTY	TOTAL SHEETS	SHEET NO.
1503	08-00260-01-PV	KANE	176	176
STA. 608+50.00		TO STA. 609+00.00		
FED. ROAD DIST. NO.	ILLINOIS	FED. AID PROJECT		

CONTRACT NO. 63095