

DATE	
BY	
PLAN	
NOTE BOOK	
NO.	
SURVEYED	
PLOTTED	
GRADES CHECKED	
STRUCTURE NOTATIONS OK'D	
ADD' FILE NAME	

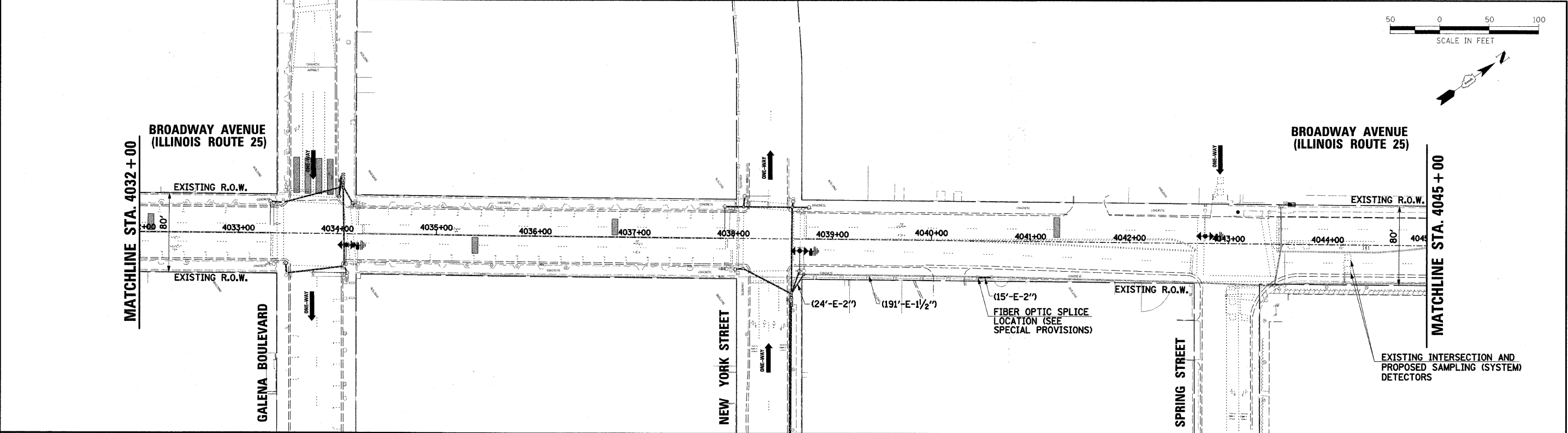

DATE	
BY	
PROFILE	
NOTE BOOK	
NO.	
SURVEYED	
PLOTTED	
GRADES CHECKED	
STRUCTURE NOTATIONS OK'D	

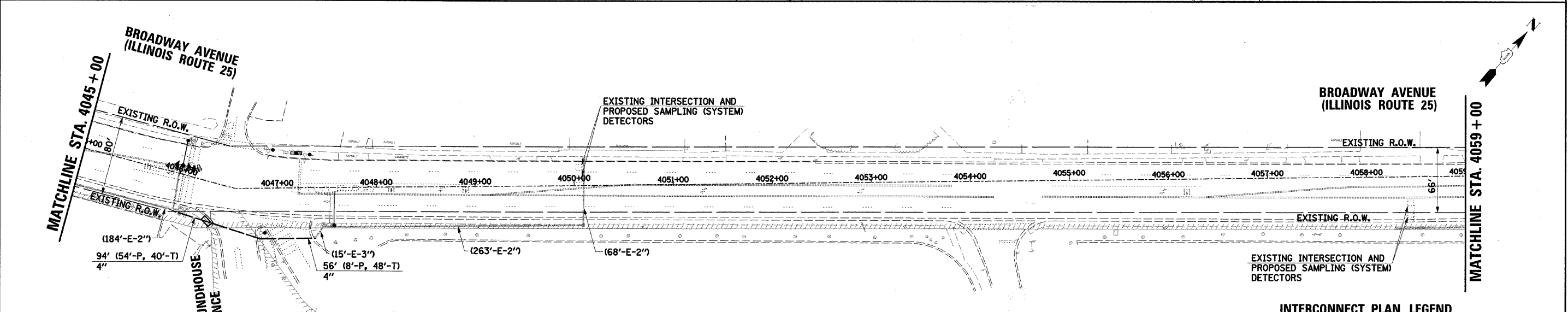

**INTERCONNECT PLAN LEGEND**

	PROPOSED	EXISTING
CONTROLLER		
HANDHOLE		
DOUBLE HANDHOLE		
HEAVY-DUTY HANDHOLE		
G.S. CONDUIT IN TRENCH (T) OR PUSHED (P)		
DETECTOR LOOP		
UNIT DUCT	UD	
SYSTEM	S	
INTERSECTION	IP	I
MAST ARM ASSEMBLY AND POLE, STEEL		
WIRELESS ANTENNA		
VIDEO DETECTION ZONE		

**NOTE:**  
THE PROPOSED TERMINAL SERVER AND ETHERNET SWITCH SHALL BE INSTALLED WITHIN THE EXISTING TRAFFIC SIGNAL CONTROLLER CABINET AT NEW YORK STREET (SEE SPECIAL PROVISIONS).

THE TRAFFIC SIGNAL CONTROL EQUIPMENT FOR THIS PROJECT SHALL BE "ECONOLITE" TO MATCH THE EXISTING ADJACENT SYSTEM.

**RESTORATION OF WORK AREA:**  
RESTORATION OF THE TRAFFIC SIGNAL WORK AREA SHALL BE INCIDENTAL TO THE RELATED PAY ITEM SUCH AS FOUNDATION, CONDUIT, HANDHOLE, TRENCH AND BACKFILL, ETC., AND NO EXTRA COMPENSATION SHALL BE ALLOWED UNLESS OTHERWISE NOTED. ALL ROADWAY SURFACES SUCH AS SHOULDERS, MEDIANS, SIDEWALKS, PAVEMENT, ETC. SHALL BE REPLACED IN KIND, ALL DAMAGE TO MOWED LAWNS SHALL BE REPLACED WITH AN APPROVED SOD, AND ALL DAMAGE TO UNMOWED FIELDS SHALL BE SEED IN ACCORDANCE WITH STANDARD SPECIFICATIONS 252 AND 250 RESPECTIVELY.

FILE NAME = #FILEL*	USER NAME = #USER*	DESIGNED -	REVISED -	<b>STATE OF ILLINOIS DEPARTMENT OF TRANSPORTATION</b>	<b>INTERCONNECT PLAN (SHEET 2 OF 3)</b>	F.A.U. RTE. 2503	SECTION 08-00272-00-TL	COUNTY KANE	TOTAL SHEETS 40	SHEET NO. 35		
	PLOT SCALE = #SCALE*	DRAWN BAH	REVISED -			SCALE:	SHEET NO. OF SHEETS STA. TO STA.	FED. ROAD DIST. NO.	ILLINOIS FED. AID PROJECT	CONTRACT NO. 63177		
	PLOT DATE = 6/8/2009	CHECKED APS	REVISED -									
		DATE JAN 16 2009	REVISED -									