

PLAN	SURVEYED	DATE
	PLOTTED	
	NOTE BOOK	
	NO.	
	BY	
	DATE	
	BY	
	DATE	

PROFILE	SURVEYED	DATE
	PLOTTED	
	NOTE BOOK	
	NO.	
	BY	
	DATE	
	BY	
	DATE	

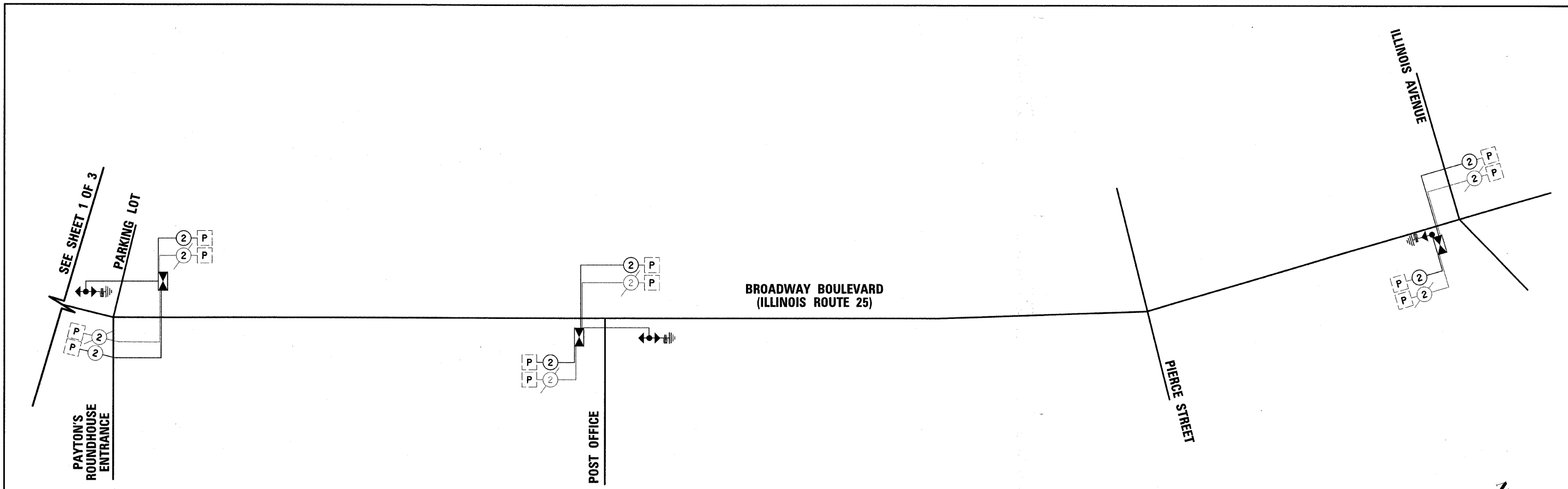

**INTERCONNECT SCHEMATIC LEGEND**

	EXISTING INTERSECTION CONTROLLER		EXISTING FIBER OPTIC CABLE IN CONDUIT, NO. 62.5/125, MM12F SM12F
	PROPOSED INTERSECTION CONTROLLER		PROPOSED FIBER OPTIC CABLE IN CONDUIT, NO. 62.5/125, MM12F SM12F
	EXISTING MASTER CONTROLLER		EXISTING INTERCONNECT CABLE - NO. 62.5/125 12F FIBER OPTIC CABLE
	PROPOSED MASTER CONTROLLER		PROPOSED INTERCONNECT CABLE - NO. 62.5/125 12F FIBER OPTIC CABLE
	MASTER MASTER CONTROLLER		EXISTING INTERCONNECT CABLE - NO. 18 3 PAIR TWISTED, SHIELDED
	EXISTING INTERSECTION & SAMPLING (SYSTEM) DETECTORS		PROPOSED INTERCONNECT CABLE - NO. 18 3 PAIR TWISTED, SHIELDED
	PROPOSED INTERSECTION & SAMPLING (SYSTEM) DETECTORS		EXISTING LOOP DETECTOR CABLE 2/C TWISTED, SHIELDED
	EXISTING INTERSECTION LOOP DETECTORS		PROPOSED LOOP DETECTOR CABLE 2/C TWISTED, SHIELDED
	PROPOSED SAMPLING (SYSTEM) DETECTORS		EXISTING ELECTRIC CABLE 1/C (AS SPECIFIED)
	EXISTING SAMPLING (SYSTEM) DETECTORS		PROPOSED ELECTRIC CABLE 1/C (AS SPECIFIED)
	PROPOSED SAMPLING (SYSTEM) DETECTORS		EXISTING TELEPHONE CONNECTION
	EXISTING SAMPLING (SYSTEM) DETECTORS PROPOSED INTERSECTION & SAMPLING (SYSTEM) DETECTORS		PROPOSED TELEPHONE CONNECTION
	EXISTING SAMPLING (SYSTEM) DETECTORS PROPOSED SAMPLING (SYSTEM) DETECTORS		EXISTING VIDEO DETECTION CAMERA
	EXISTING PREFORMED INTERSECTION & SAMPLING (SYSTEM) DETECTORS		PROPOSED VIDEO DETECTION CAMERA
	PROPOSED PREFORMED INTERSECTION & SAMPLING (SYSTEM) DETECTORS		EXISTING INTERSECTION AND PROPOSED SAMPLING (SYSTEM) VIDEO DETECTION ZONE
	EXISTING SAMPLING (SYSTEM) PREFORMED DETECTORS		PROPOSED SAMPLING (SYSTEM) VIDEO DETECTION ZONE
	PROPOSED SAMPLING (SYSTEM) PREFORMED DETECTORS		EXISTING WIRELESS ANTENNA
	PROPOSED CENTRALIZED TRANSPORTATION MANAGEMENT SYSTEM		
	PROPOSED WIRELESS ANTENNA		

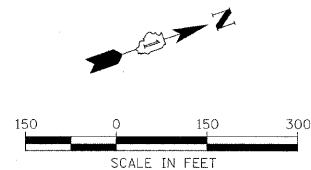

THE TRAFFIC SIGNAL CONTROL EQUIPMENT FOR THIS PROJECT SHALL BE "ECONOLITE" TO MATCH THE EXISTING ADJACENT SYSTEM.

FILE NAME = #FILE#	USER NAME = #USER#	DESIGNED -	REVISED -	<b>STATE OF ILLINOIS DEPARTMENT OF TRANSPORTATION</b>	<b>INTERCONNECT SCHEMATIC SHEET 2 OF 3</b>	F.A.U. RTE. 2503	SECTION 08-00272-00-TL	COUNTY KANE	TOTAL SHEETS 40	SHEET NO. 38
	PLLOT SCALE = #SCALE#	DRAWN BAH	REVISED -			CONTRACT NO. 63177				
	PLLOT DATE = 6/8/2009	CHECKED APS	REVISED -			SCALE:	SHEET NO. OF SHEETS	STA. TO STA.	FED. ROAD DIST. NO. ILLINOIS	FED. AID PROJECT
		DATE JAN 16 2009	REVISED -							