

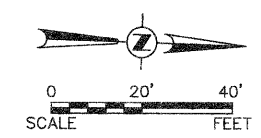

F.A.U. RTE.	SECTION	COUNTY	TOTAL SHEETS	SHEET NO.
1680	05-00038-00-PV	KANE/KENDALL	130	34
STA.		TO STA.		
FED. ROAD DIST. NO.		ILLINOIS	FED. AID PROJECT	

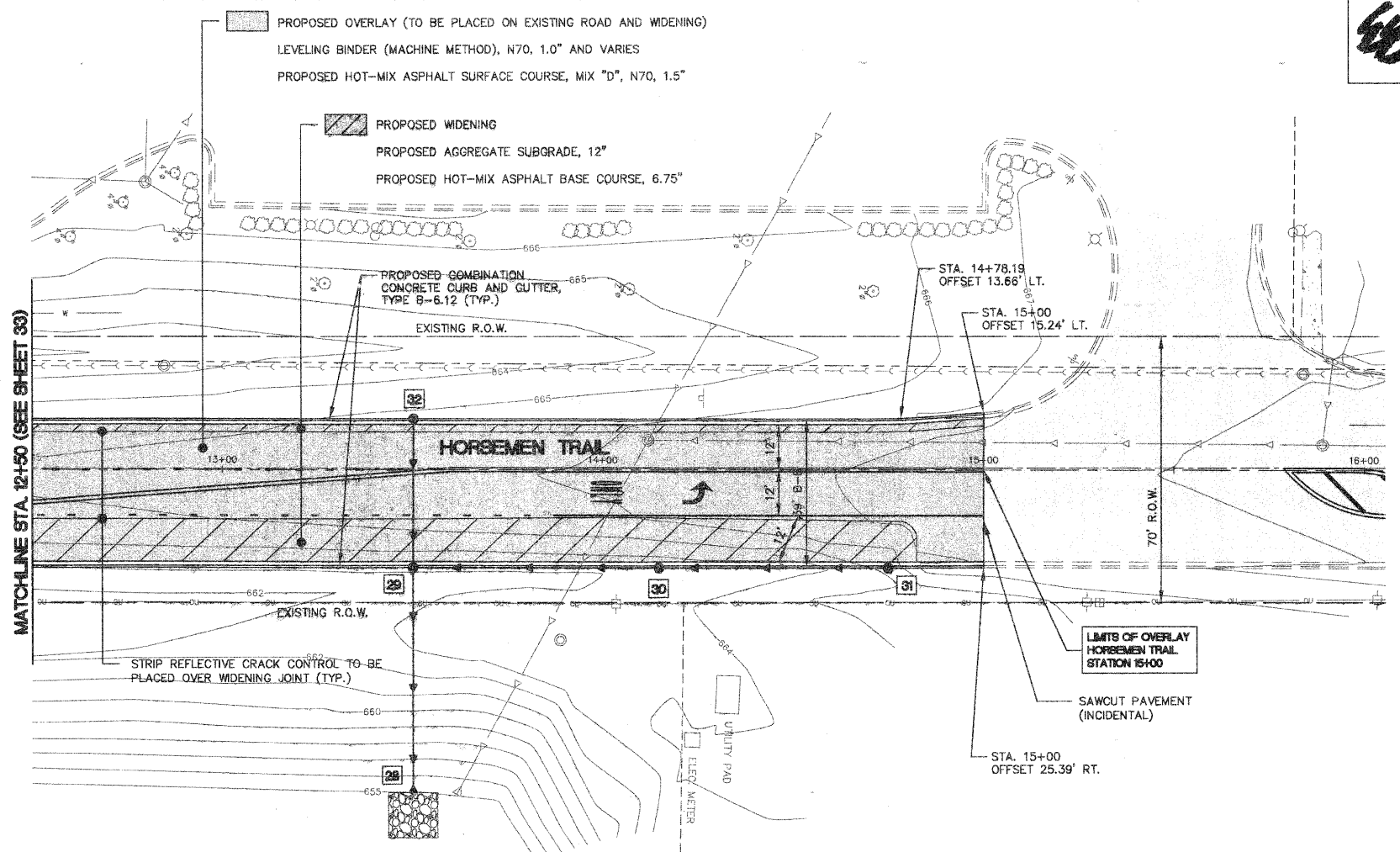

NOTE:
SEE STRIPING AND SIGNAGE
PLAN FOR CONTINUATION OF
CONSTRUCTION LIMITS.



SCALE:

HORIZONTAL	1" = 20'
VERTICAL	1" = 40'

PLAN

REVISION	BY	DATE

NO. _____

PROFILE

REVISION	BY	DATE

NO. _____

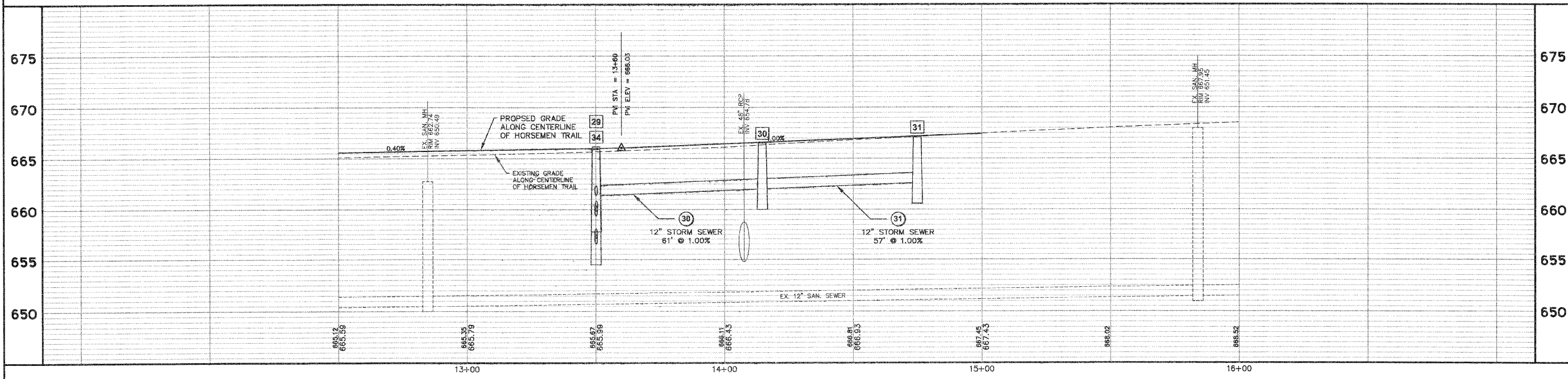

Plotted: June 26, 2008 @ 9:23 AM By: Kris Pung - Tab. 34 Horsemen 22x34

PATH: \\S05PROJ\00785\DWG\DWG_FINAL_ENG\00785-3P